



P/N: 15G065259001AK V1.0

Quick Installation Guide

Z690D4ID-2T/G5/X550 | W680D4ID-2T/G5/X550



www.asrockrack.com



Z690D4ID-2T/G5/X550



W680D4ID-2T/G5/X550

The server board User's Manual is available for download from the ASRock Rack's official website at <http://www.asrockrack.com>.

Take note of the following precautions before you install server board components or change any server board settings.

1. Unplug the power cord from the wall socket before touching any components.
2. To avoid damaging the server board's components due to static electricity, NEVER place your server board directly on the carpet or the like. Also remember to use a grounded wrist strap or touch a safety grounded object before you handle the components.
3. Hold components by the edges and do not touch the ICs.
4. Whenever you uninstall any component, place it on a grounded anti-static pad or in the bag that comes with the component.
5. When placing screws into the screw holes to secure the server board to the chassis, please do not over-tighten the screws! Doing so may damage the server board.

1 Install the Server Board

- 1 Insert the server board into the chassis.
- 2 Affix the screws clockwise into the mounting holes in all of the corners of the server board. Do not over-tighten the screws.

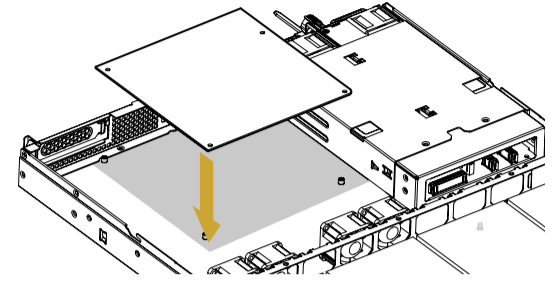

2 Motherboard Layout

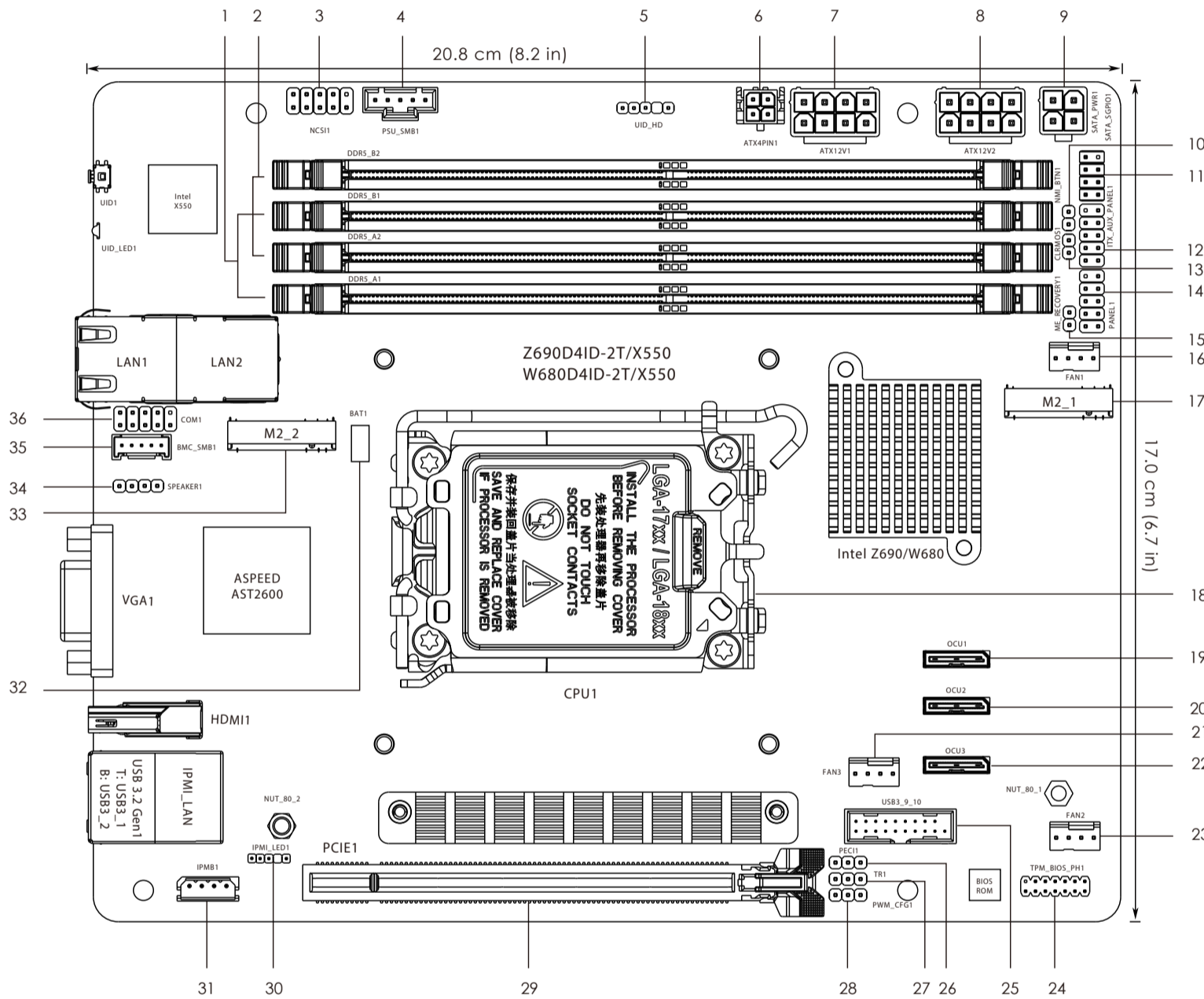

No.	Description
1	2 x 288-pin DDR5 DIMM Slots (DDR5_A1, DDR5_B1)
2	2 x 288-pin DDR5 DIMM Slots (DDR5_A2, DDR5_B2)
3	NCSI Header (NCSI1)
4	PSU SMBus Header (PSU_SMB1)
5	UID Header (UID_HD)
6	ATX 4-PIN Power Connector (ATX4PIN1 (ATX 24pin-to-4pin))
7	ATX 12V Power Connector (ATX12V1)
8	ATX 12V Power Connector (ATX12V2)
9	SATA Power Connector (SATA_PWR1)
10	Non Maskable Interrupt Button (NMI_BTN1)
11	SATA SGPIO Connector (SATA_SGPIO1)
12	Auxiliary Panel Header (ITX_AUX_PANEL1)
13	Clear CMOS Jumper (CLRMOS1)
14	System Panel Header (PANEL1)
15	ME Recovery Jumper (ME_RECOVERY1)
16	Chassis Fan Connector (FAN1)
17	M.2 Socket (M2_1) (Type 2280)
18	Single Socket LGA 1700 (CPU1)
19	OCuLink x4 Connector (OCU1)
20	OCuLink x4 Connector (OCU2)
21	Chassis Fan Connector (FAN3)
22	OCuLink x4 Connector (OCU3)
23	Chassis Fan Connector (FAN2)
24	SPI TPM Header (TPM_BIOS_PH1)
25	USB 3.2 Gen1 Header (USB3_9_10)
26	CPU PECE Mode Jumper (PECE1)
27	Thermal Sensor Header (TR1)
28	PWM Configuration Header (PWM_CFG1)
29	PCI Express 5.0 x16 Slot (PCIE7)
30	IPMI LED Header (IPMI_LED1)
31	Intelligent Platform Management Bus Header (IPMB1)
32	CMOS Battery Connector (BAT1)
33	M.2 Socket (M2_2) (Type 2280)
34	Chassis Speaker Header (SPEAKER1)
35	BMC SMBus Header (BMC_SMB1)
36	Serial Port Header (COM1)



The terms HDMI® and HDMI High-Definition Multimedia Interface, and the HDMI logo are trademarks or registered trademarks of HDMI Licensing LLC in the United States and other countries.

3 I/O Panel

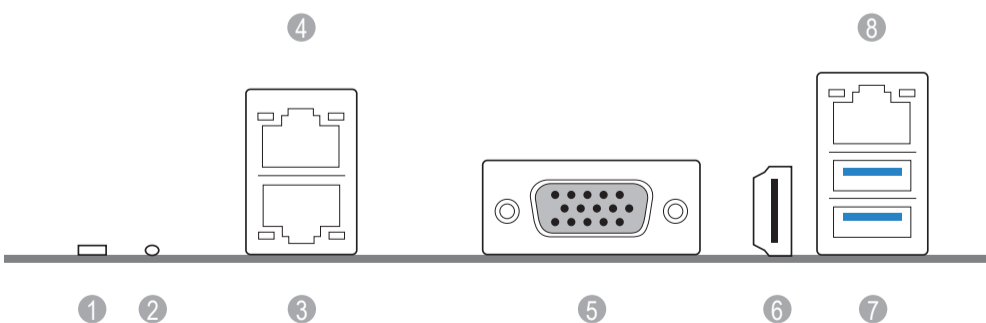

No.	Description	No.	Description
1	UID Switch (UID1)	5	VGA Port (VGA1)
2	UID LED	6	HDMI Port
3	10G LAN RJ-45 Port (LAN1)	7	USB 3.2 Gen1 Ports (USB3_1_2)
4	10G LAN RJ-45 Port (LAN2)	8	LAN RJ-45 Port (IPMI_LAN1)

4 LAN Port LED Indications

IPMI LAN Port

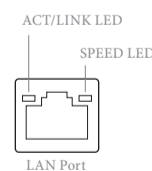

Activity / Link LED		Speed LED	
Status	Description	Status	Description
Off	No Link	Off	10M bps connection or no link
Blinking Yellow	Data Activity	Yellow	100M bps connection
On	Link	Green	1Gbps connection

10G LAN Port

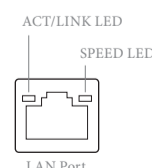

Activity / Link LED		Speed LED	
Status	Description	Status	Description
Off	No Link	Off	100Mbps connection or no link
Blinking Green	Data Activity	Yellow	1Gbps connection
On	Link	Green	10Gbps connection



5 Install the Processor

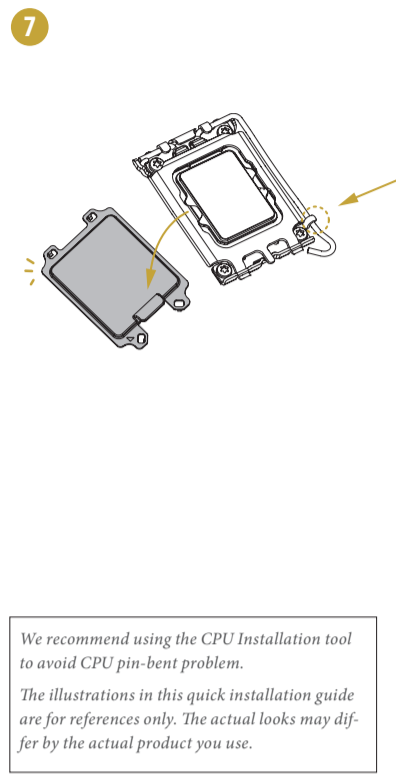
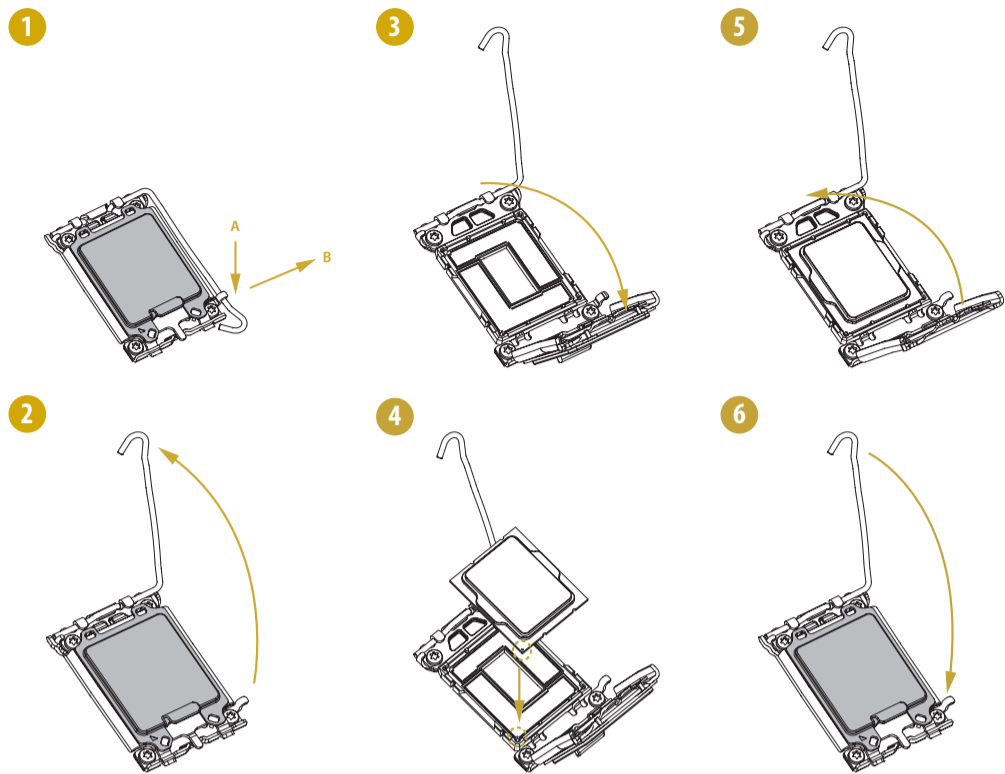

We recommend using the CPU Installation tool to avoid CPU pin-bent problem.
The illustrations in this quick installation guide are for references only. The actual looks may differ by the actual product you use.

6 Install the CPU Fan and Heatsink

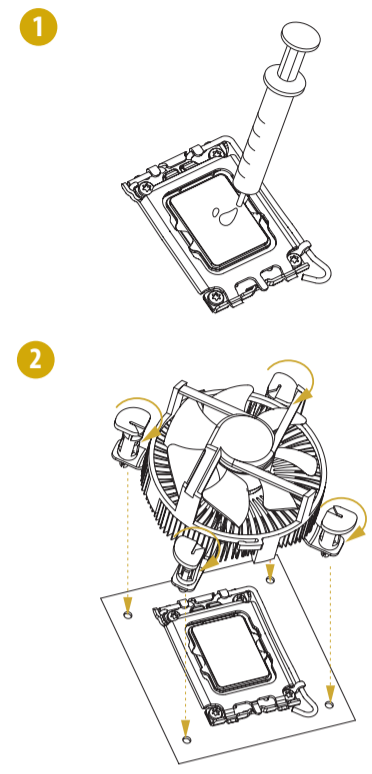

7 Install the PCIe Card

- 1 Remove the bracket facing the slot that you intend to use. Keep the screw for later use.
- 2 Align the card connector with the slot and press firmly until the card is completely seated on the slot.
- 3 Fasten the card to the chassis with the screw.

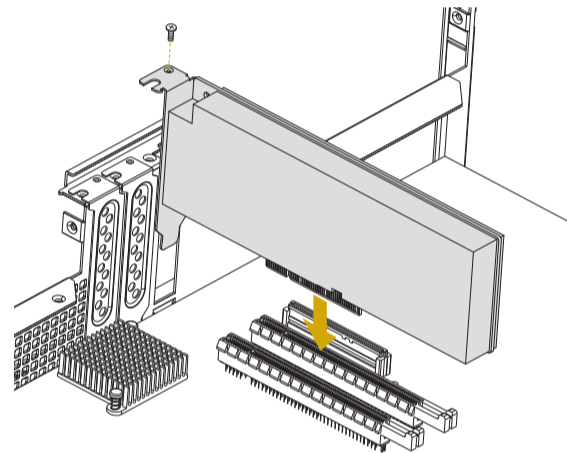

PCIe Slots

Slot	Generation	Mechanical	Electrical	Source
PCIe 7	5.0	x16	x16	CPU

8 Install the Memory

- 1 Unlock a DIMM slot by pressing the module clips outward.
- 2 Insert the memory module.
- 3 Lock the clips.

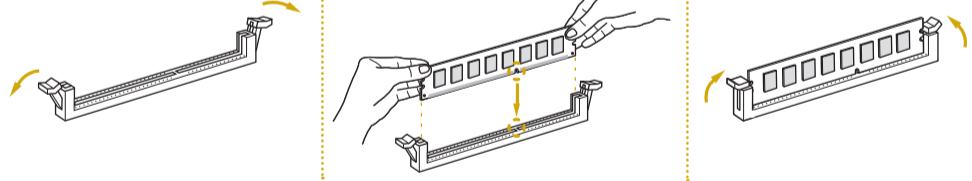

9 Jumper Cap On/Off

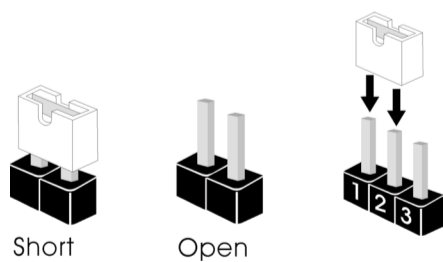

When the jumper cap is placed on the pins, the jumper is "Short". If no jumper cap is placed on the pins, the jumper is "Open".

The illustration shows a 3-pin jumper whose pin1 and pin2 are "Short" when a jumper cap is placed on these 2 pins.

10 Headers

System Panel		Auxiliary Panel	
GND	RESET#	LAN2_ACT#	SYSTEM_FAULT_LED_P
PWRBTN#	GND	LED_PWR	SYSTEM_FAULT_LED_N
PLED-	HDLED-	LED_PWR	GND
PLED+	HDLED+	LAN1_ACT#	CASEOPEN#

11 Install the Power Cables

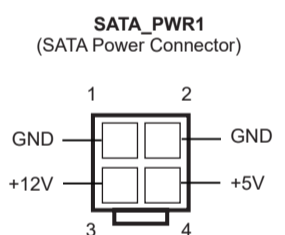
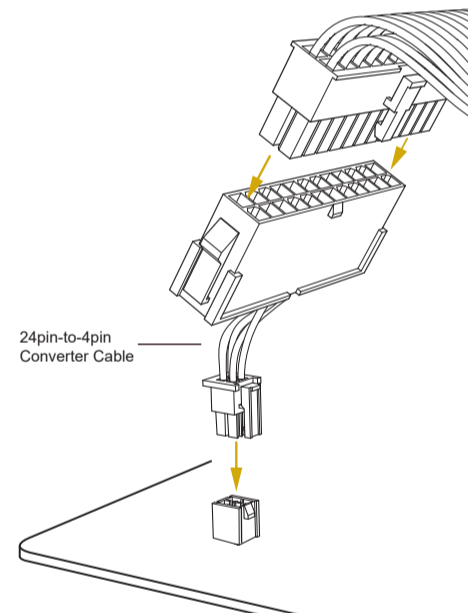
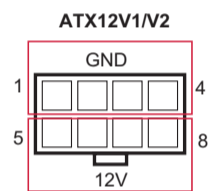
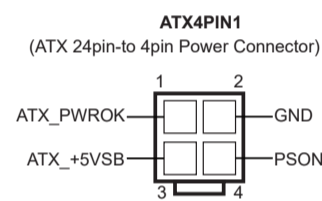

Caution: Misconnection between the ATX4PIN1 and the SATA_PWR1 connectors may permanently damage the motherboard.

12 M.2 SSD Module Installation

- 1 Prepare a M.2 SSD module and the screw.
- 2 Gently insert the M.2 SSD module into the M.2 slot. Please be aware that the M.2 SSD module only fits in one orientation.

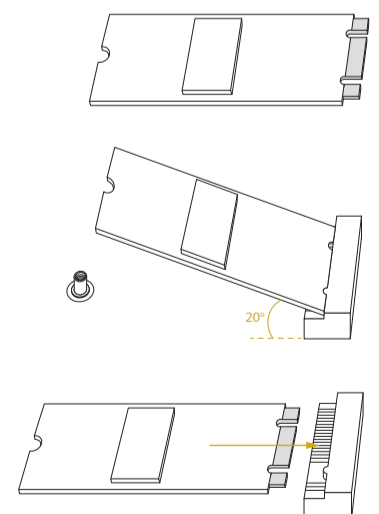

- 3 Tighten the screw with a screwdriver to secure the module into place. Please do not overtighten the screw as this might damage the module.

