

# SMOKE ALARM



## IONIZATION

Ionization sensing chamber. Generally more effective at detecting small particles produced by flaming fires. Sources may include paper or kitchen grease.

## SILENCE FEATURE

Silences nuisance alarms.

## TAMPER RESISTANT LOCKING PIN

Locks alarm cover to prevent removal of battery. Perfect for apartment, dormitory or hotel applications.

## 9V BATTERY INCLUDED

## END OF LIFE SIGNAL

Provides audible notice when alarm needs to be replaced after 10 years.

First Alert Model FG250A (Cat. 1039881) is a single station smoke alarm specifically designed for residential and institutional applications including sleeping rooms of hospitals, hotels, motels, dormitories, and other multifamily dwellings as defined in standard NFPA 101. Model FG250A has been fully tested and complies with, ULC S531, NFPA 72, and NFPA 101 and other agencies that model their codes after the above agencies. It meets building codes where DC with Silence smoke alarms are required and with model building codes published by the ICC.

First Alert FG250A is a state of the art smoke alarm designed to provide early warning of a fire. It features a fully insect screened ionization smoke sensing chamber, an 85dB horn, a supervised 9V battery power supply, a full function test switch, a silence feature to silence unwanted nuisance alarms, a red LED light that indicates DC power or alarm. It also features a tamper resistant locking pin that locks alarm cover to prevent removal of battery. Perfect for apartment, dormitory or hotel applications. The compact, low profile design complements any décor. Battery installation and removal can occur while the unit is mounted to the ceiling or wall via the hinged cover. To insure the battery is always replaced properly, the cover is designed to resist closing when the battery is missing. Designed for wall or ceiling mounting. Includes mounting anchors and screws.



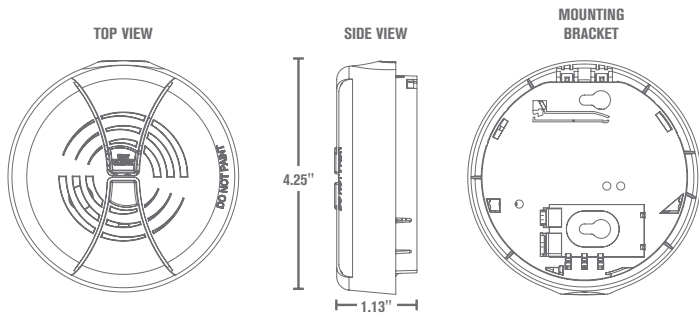

### ARCHITECTURAL AND ENGINEERING SPECS

The smoke alarm shall be a First Alert Model FG250A (Cat. 1039881) and shall provide at a minimum the following features and functions:

1. An ionization sensing chamber.
2. The unit shall be capable of self restoring.
3. A fully screened sensing chamber to resist entry of small insects thereby reducing the probability of unwanted alarms.
4. Powered by a supervised 9V battery and a solid state piezo horn rated at 85dB at 10 ft.
5. A visual LED power-on indicator to confirm unit is receiving power or is in alarm.
6. A full function test button. The test button should check all alarm functions by stimulating the chamber to simulate a smoke condition, causing the unit to alarm.
7. Silence feature - Temporarily silence unwanted nuisance alarms.
8. A tamper resistant locking pin that locks alarm cover to prevent removal of battery.
9. The unit shall be capable of operating between 40°F (4°C) and 100°F (38°C) and relative humidity between 10% and 90%.
10. The unit shall contain mounting hardware and shall be listed for wall or ceiling mounting.
11. The unit shall at a minimum meet the requirements of ULC S531, NFPA 72, NFPA 101, and ICC.
12. The unit shall have an "End of Life" signal.

### INSTALLATION OF ALARM

Installation of this smoke alarm must conform to NFPA 72. Always check your local building codes. Follow all instructions for placement as outlined in the user's manual in sections titled "Recommended Locations for Smoke Alarms" and "Locations to Avoid for Smoke Alarms."

### THE PARTS OF THIS ALARM

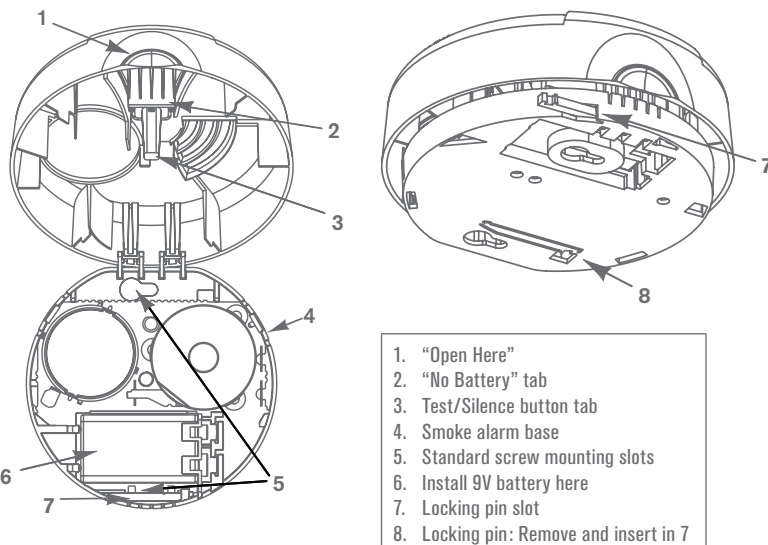

### TECHNICAL SPECS

Alarm Dimensions:	4.25" Dia. x 1.6" H
Weight:	4.8 oz
Operating Voltage:	9V Battery Powered
Temperature Range:	40°F (4°C) to 100°F (38°C)
Humidity Range:	10% to 95% relative humidity (RH)
Audio Alarm:	85dB at 10 feet
Test/Silence:	Electronically simulates smoke condition, causing the unit to alarm. Press and hold test/silence button.
Alarm Reset:	Automatic when smoke clears
Smoke Sensor:	Ionization
Indicator Lights/Sounds:	
DC Power:	Intermittent Red LED
Local Alarm:	Audio alarm and rapidly flashing Red LED
End of Life:	Horn sounds 5 chirps; pattern repeats once/minute
Listing:	Certified to ULC STD S531

### SHIPPING SPECS

Individual Carton Dimensions	2.6" L x 6.8" W x 8.5" H
Weight:	0.4 lbs.
Cube:	0.1 ft <sup>3</sup>
UPC:	0 29054 01924 0
Master Carton Dimensions	8.1" L x 7.0" W x 8.6" H
Master Pack:	3
Weight:	1.6 lbs.
Cube:	0.7 ft <sup>3</sup>
I2of5:	200 29054 01924 4
Pallet Information	
Cases per Layer	29
Number of Layers:	5
Cases per Pallet:	145
Units per Pallet:	435
Cube:	55.6 ft <sup>3</sup>
Weight:	265 lbs.