

TRENDnet[®]



Quick Installation Guide

TEW-921DAP / TEW-925DAP (V1)

Table of Contents

1 English

1. Before You Start
2. Quick Reference
3. Hardware Installation and Configuration

1. Before You Start

Package Contents

- TEW-921DAP
- Quick Installation Guide
- Network cable (1.5m / 5 ft.)
- Mounting plate

Minimum Requirements

- A computer with an available network LAN port and web browser
- A PoE+ Network switch with an available network LAN port connected to existing network

Optional Equipment

- TRENDnet TPE-115GI (PoE injector) for supplying both power and data over Ethernet to the access point if no PoE sourcing equipment is available such as a PoE switch
- Power drill/drill bits and Phillips bit or screwdriver for mounting

Note: The access point complies with the IEEE 802.3at Power over Ethernet (PoE) standard and can be used with 802.3 at PoE+ compliant devices such as PoE+ switches and PoE+ injectors to deliver both power and data to the access point through the network LAN port.

2. Quick Reference

Note: By default, the wireless network name/SSID and wireless encryption settings have been pre-configured for your convenience and can be located on the included preset wireless settings sticker or on the device label located on the back of the access point. By default, the access point web management configuration page can be accessed using the URL <http://tew-921dap> or using the default LAN IP address <http://192.168.10.100>. At default settings and initial setup, if the access point is connected to a network with a DHCP server providing IP address settings automatically, the access point will obtain IP address settings from the network DHCP server and if no DHCP server is available, the access point will use the default IP address settings 192.168.10.100 / 255.255.255.0. A network router is a typical DHCP server.

Preset Wireless Settings	
Wi-Fi Name/SSID (AX/AC/N) TRENDnet921_5GHz_XXXX (AX/N/B/G) TRENDnet921_2.4GHz_XXXX	
Wi-Fi Password XXXXXXXXXXXXXX	
Management Login http://tew-921dap username: admin password: admin	

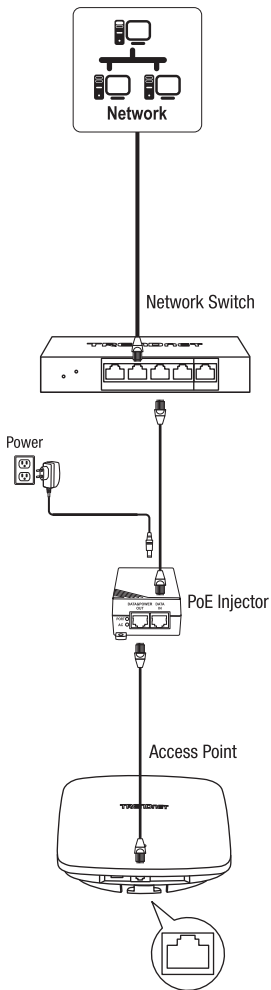

OR

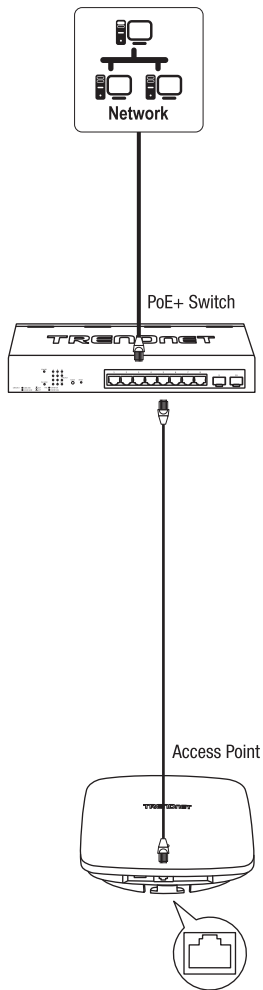

3. Hardware Installation and Configuration

Note: It is strongly recommended to configure the access point first before mounting.

1. Connect a network cable from a PoE+ Switch to your access point to your computer.

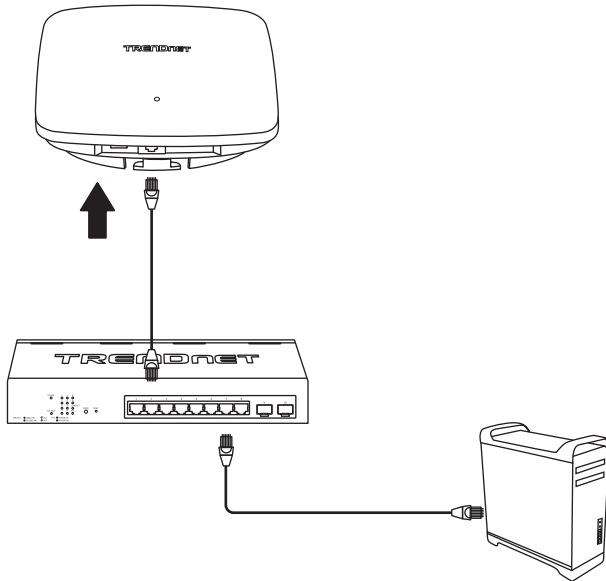

2. The Power will turn on to indicate that the access point is ready.

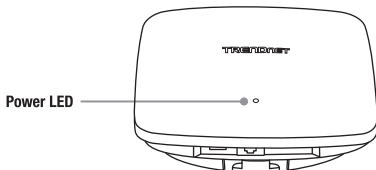

3. Assign a static IP address to your computer's network adapter in the subnet of **192.168.10.x** (e.g. 192.168.10.25) and subnet mask of **255.255.255.0**.

Note: For more information on assigning a static IP address to your computer's network adapter, please refer to item Q1 in the last section of the installation guide, Installation Tips and Troubleshooting.

4. Open your web browser, type the default URL <http://tew-921dap> or default IP address <http://192.168.10.100> of the wireless access point in the address bar, and then press **Enter**. The default IP address is **192.168.10.100**.



5. Select your language from the Language drop-down list and enter the User name and Password, and then click **Login**. By default:

User Name: **admin**

Password: **admin**

6. To change the administrator password used to access the wireless access point configuration page, in the Administrator Settings window, enter the new password in the **New Password** and **Verify Password** fields and click **Next**. Your new password settings will be applied and you will be prompted to log into the access point configuration using the new password settings. Log into the access point configuration using the new password.

Note: It is strongly recommended to change your access point configuration password.

7. To configure your wireless network name/SSID and wireless encryption settings, click the wireless band you would like to configure **Wireless 2.4GHz** or **Wireless 5GHz** and click on **Wireless Network**.

Note: By default, the wireless network name/SSID and wireless encryption has been pre-configured for your convenience and can be located on the included wireless settings sticker or on the device label located on the back of the access point. If you are modifying the wireless settings, you will need to connect to the access point with your WiFi clients using the new settings.



8. In the Current Profiles, click **Edit** next to the enabled entry.

Current Profiles			
Enable	SSID	Security Mode	Edit
<input checked="" type="checkbox"/>	TRENDnet921_2.4GHz_C9B4	WPA2-PSK AES	Edit

9. To change the wireless network name/SSID for the selected wireless band, under Wireless Settings, enter the new name in the **SSID** field. Click **Save** at the bottom of the page to temporarily save the settings.

Note: The wireless network name/SSID is the name your WiFi clients will need to search and discover when connecting to your access point wireless network.



10. To change the wireless encryption key for the selected wireless band, under WPA, enter the new encryption key in the **Pre-Shared Key** field. Click **Save** at the bottom of the page to temporarily save the settings.



The screenshot shows a configuration form for WPA. It includes a dropdown menu for 'WPA Cipher' set to 'AES', a text input field for 'Pre-Shared Key' with a 'Show Password' checkbox, and a 'Key Update Interval' set to '3600 seconds'. Below the form is a 'Save' button.

11. In the top left main menu, click **Apply/Discard Changes** and click on **Save & Apply** to save & commit the configuration changes.

Important Note: Configuration changes in the access point web management configuration are not applied until you permanently **Save & Apply** under **Apply/Discard Changes**. This allows you to make multiple configuration changes and applying multiple changes all at the same time. If there are pending changes that have not yet been permanently saved, the **Apply/Discard Changes** button will flash and the number will indicate the number of pending changes that have not yet been permanently saved.

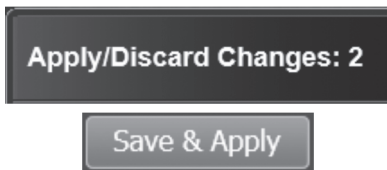

12. To configure your access point LAN IP address settings, click **System** and click **IP Settings**.

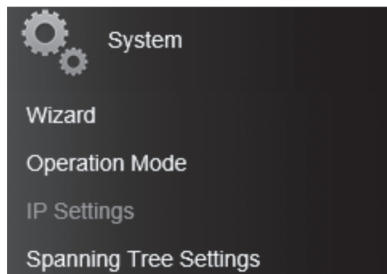

13. Under LAN Connection type, click the **Connection Type** drop-down list to select either **DHCP** (default setting) or **STATIC**. Selecting **DHCP** will set your access point to obtain IP address settings automatically from a DHCP server on your network and selecting **STATIC** will allow you to manually assign your access point IP address settings to meet the IP requirements of your network. If you select **STATIC**, enter the new IP address settings in the **IP Address**, **Subnet Mask**, **Default Gateway**, and **Primary/Secondary DNS Server** fields. After you have completed configuring the access point IP address settings, click **Save** at the bottom of the page to temporarily save the settings. To permanently save the configuration changes, click **Apply/Discard Changes** and click on **Save & Apply**.

The screenshot displays a configuration page for LAN settings. At the top, there is a section titled "LAN Connection Type" with a dropdown menu currently set to "STATIC". Below this is another section titled "LAN Interface Setting" containing three input fields: "IP Address" with the value "192.168.10.100", "Subnet Mask" with "255.255.255.0", and "Default Gateway" which is empty. Underneath is a "DNS Server Setting" section with two input fields: "Primary DNS Server" and "Secondary DNS Server", both of which are empty. At the bottom of the form area are three buttons: a "Save" button, a "Apply/Discard Changes: 2" button, and a "Save & Apply" button.

14. After you have completed access point configuration, reconfigure your computer's network adapter back to the original settings to obtain IP address settings automatically using DHCP, or enter the IP settings.

Note: For more information on reconfiguring your computer's network adapter to obtain IP address settings automatically using DHCP, please refer to item Q2 in the last section of the installation guide, Installation Tips and Troubleshooting.

15. To mount the access point, first route the network cable through the largest opening in the mounting plate and install the mounting plate to the desired wall or ceiling using the included drywall anchors and screws. Install the mounting plate with the clips facing away from the wall or ceiling. If wall mounting, install the mounting plate with the correct orientation. After the mounting plate is properly installed, connect the network cable to the network LAN port of the access point, align the access point mounting holes with the mounting plate clips and rotate the access point clockwise to lock into place. Finally, install the cable guard by sliding it onto the mounting plate until it locks into place.

Ceiling mounting

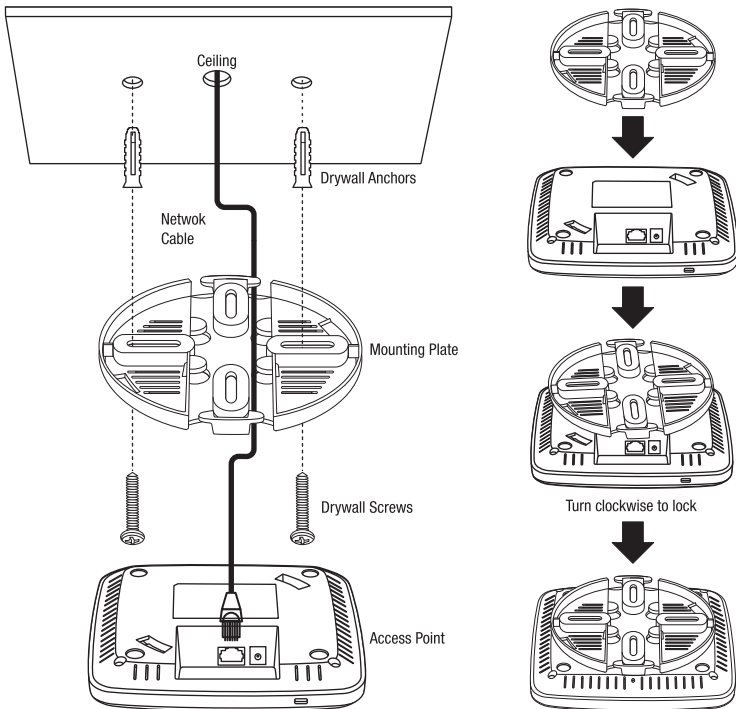

Mounting Plate (Orientation for wall mounting)

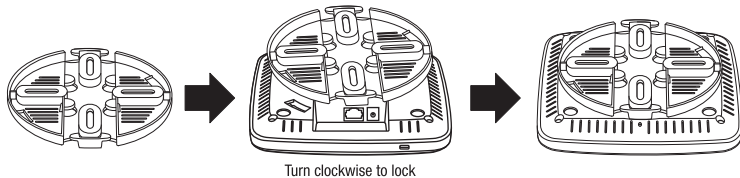
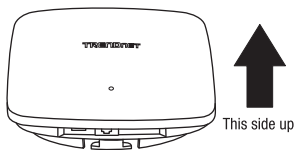

To download the latest version of the user's guide, please go to <http://www.trendnet.com/support> and select the **TEW-921DAP** H/W: v1.0R within the Product Download drop-down list.

Declaration of Conformity

TRENDnet[®]

Manufacturer's Name and Address

TRENDnet, Inc.
20675 Manhattan Place
Torrance, CA 90501 USA

Zwalsestraat 156 2587 WB
The Hague The Netherlands



Product Information

Model Number: TEW-921DAP/TEW-925DAP
Product Name: AX1800 Dual Band WiFi 6 PoE+ Access Point
AX5400 Dual Band WiFi 6 PoE+ Access Point
Trade Name: TRENDnet

TRENDnet hereby declare that the product is in compliance with the essential requirements and other relevant provisions under our sole responsibility.

Safety EN 62368-1:2014+A11:2017
EMC EN 55032:2015+A11:2020
EN 55024:2010+A1:2015
EN 55035:2017+A11:2020
EN 301 489-1 V2.2.3
EN 301 489-17 V3.1.1

Radio Spectrum & Health EN 300 328 V2.2.2
EN 301 893 V2.1.1
EN 62311:2008
EN 50385:2017

Energy Efficiency Regulation (EU) No. 1275/2008, No. 801/2013
This product is herewith confirmed to comply with the Directives.

Directives: EMC Directive 2014/30/EU
RoHS Directive 2011/65/EU
WEEE Directive 2012/19/EU
REACH Regulation (EU) No. 1907/2006
Low Voltage Directive 2014/35/EU
Radio Equipment Directive 2014/53/EU
Ecodesign Directive 2009/125/EU

Person responsible for this declaration.

Place of Issue: Torrance, California, USA

Date: April 23, 2021

Name: Sonny Su

Title: VP of Technology

Signature:

A handwritten signature in black ink, appearing to read 'Sonny Su', is written over a horizontal line.



Declaration of Conformity

TRENDnet®

Manufacturer's Name and Address

TRENDnet, Inc.
20675 Manhattan Place
Torrance, CA 90501 USA

Authorized Representative:
Office: +44 (0) 1635 887 399
Unit 4 Rivermead Business Park,
Pipers Way, Thatcham, RG19 4EP England



Product Information

Model Number: TEW-921DAP/ TEW-925DAP
Product Name: AX1800 Dual Band WiFi 6 PoE+ Access Point
AX5400 Dual Band WiFi 6 PoE+ Access Point

Trade Name: TRENDnet

TRENDnet hereby declare that the product is in compliance with the essential requirements and other relevant provisions under our sole responsibility.

Safety EN 62368-1:2014+A11:2017
EMC EN 55032:2015+A11:2020
EN 55024:2010+A1:2015
EN 55035:2017+A11:2020
EN 301 489-1 V2.2.3
EN 301 489-17 V3.1.1

Radio Spectrum & Health EN 300 328 V2.2.2
EN 301 893 V2.1.1
EN 62311:2008
EN 50385:2017

Energy Efficiency Regulation (EU) No. 1275/2008, No. 801/2013

This product is herewith confirmed to comply with the Directives.

Directives: Electromagnetic Compatibility Regulations 2016
The Restriction of the Use of Certain Hazardous Substances in Electrical and Electronic Equipment Regulations 2012
The Waste Electrical and Electronic Equipment Regulations 2013 (as amended)
The REACH Enforcement Regulations 2008 (as amended)
Electrical Equipment (Safety) Regulations 2016
Radio Equipment Regulations 2017
The Ecodesign for Energy-Related Products and Energy Information (Amendment) (EU Exit) Regulations 2019

Person responsible for this declaration.

Place of Issue: Torrance, California, USA

Date: April 23, 2021

Name: Sonny Su

Title: VP of Technology

Signature:

A handwritten signature in black ink, appearing to read 'Sonny Su', is written over a horizontal line.



Installation Tips and Troubleshooting

Q1: How do I configure my computer's network adapter with a static IP address?

Note: Please note that although the following procedures are provided to follow for your operating system network adapter settings to be used as general guidelines, however, it is strongly recommended that you consult your computer or operating system manufacturer directly for assistance on the proper procedure for configuring network settings. If you are experiencing difficulties, please contact your computer or operating system manufacturer for assistance.

Windows 2000/XP/Vista/7/8/8.1/10

1. On your keyboard, press **Windows Logo + R** keys simultaneously to bring up the Run dialog box.
2. In the dialog box, type **ncpa.cpl** to bring up the Network Connections window.
3. Right-click the **Local Area Connection** or **Ethernet** icon, click **Properties**, and double-click **Internet Protocol Version 4 (TCP/IPv4)**.
4. Then click **Use the following IP address** and assign your network adapter a static IP address. See example static IP address settings below.
 - IP address: 192.168.10.25
 - Subnet mask: 255.255.255.0
5. Click **OK** on both TCP/IPv4 Properties and Local Area Connection Properties windows.

MAC OS X

1. From the **Apple** drop-down list, select **System Preferences**.
2. Click the **Network** icon.
3. From the **Location** drop-down list, select **Automatic**.
4. Select and view your Ethernet connection.
 - For MAC OS 10.4, from the **Show** drop-down list, select **Built-in Ethernet** and select the **TCP/IP** tab
 - For MAC OS 10.5 and above, in the left column, select **Ethernet**.
5. Configure TCP/IP to use a static IP.
 - From the **Configure IPv4** or **Configure** drop-down list, select **Manually** and assign your network adapter a static IP address. Then click the **Apply** or **Apply Now** button. See example static IP address settings below.
 - IP address: 192.168.10.25
 - Subnet mask: 255.255.255.0
6. You may be prompted to restart your computer to apply the new IP address settings.

Q2: I configured my computer's network adapter with a static IP address, how do I reconfigure my computer's network adapter to default settings and obtain an IP address automatically using DHCP?

Note: Please note that although the following procedures are provided to follow for your operating system network adapter settings to be used as general guidelines, however, it is strongly recommended that you consult your computer or operating system manufacturer directly for assistance on the proper procedure for configuring network settings. If you are experiencing difficulties, please contact your computer or operating system manufacturer for assistance.

Windows 2000/XP/Vista/7/8/8.1/10

1. On your keyboard, press **Windows Logo + R** keys simultaneously to bring up the Run dialog box.
2. In the dialog box, type **ncpa.cpl** to bring up the Network Connections window.
3. Right-click the **Local Area Connection** or **Ethernet** icon, click **Properties**, and double-click **Internet Protocol Version 4 (TCP/IPv4)**.
4. Then click **Obtain an IP address automatically** and **Obtain DNS server address automatically**.
5. Click **OK** on both TCP/IPv4 Properties and Local Area Connection Properties windows.

MAC OS X

1. From the **Apple** drop-down list, select **System Preferences**.
2. Click the **Network icon**.
3. From the **Location** drop-down list, select **Automatic**.
4. Select and view your Ethernet connection.
 - In MAC OS 10.4, from the **Show** drop-down list, select **Built-in Ethernet** and select the **TCP/IP** tab.
 - In MAC OS 10.5 and above, in the left column, select **Ethernet**.
5. Configure TCP/IP to use a static IP.
 - From the **Configure IPv4** or **Configure** drop-down list, select **Using DHCP** and click the **Apply** or **Apply Now** button.
6. You may be prompted to restart your computer to apply the new IP address settings.

Q3: I typed http://192.168.10.100 in my Internet Browser Address Bar, but an error message says “The page cannot be displayed.” How can I access the wireless access point management page?

1. Double check all physical cable and port connections.
2. Make sure the PWR LED on the wireless access point front panel are on.
3. Make sure your computer's network adapter is configured with a static IP address. (Refer to Q1 for instructions on assigning a static IP address).
4. Make sure your computer is connected to the access point network LAN port and LAN LED is on.
5. Since the access point default IP address is 192.168.10.100, make sure there are no other network devices assigned an IP address of 192.168.10.100

Note: After checking all of the recommended items above, please attempt to access the wireless access point management page again.

Q4: I changed the IP address of the wireless access point, but I forgot it. How do I reset my wireless access point to factory default?

While the access point is powered up, use a paper clip, push and hold the reset button on the rear panel of the wireless access point and release after 15 seconds. The default IP address of the access point is 192.168.10.100. The default user name and password is “admin”.

Q5: How do I find the current IP address of my computer's network adapter?

Note: Please note that although the following procedures are provided to follow for your operating system network adapter settings to be used as general guidelines, however, it is strongly recommended that you consult your computer or operating system manufacturer directly for assistance on the proper procedure for configuring network settings. If you are experiencing difficulties, please contact your computer or operating system manufacturer for assistance.

Command Prompt Method

Windows 2000/XP/Vista/7/8/8.1/10

1. On your keyboard, press **Windows Logo + R** keys simultaneously to bring up the Run dialog box.
2. In the dialog box, type **cmd** to bring up the command prompt.
3. In the command prompt, type **ipconfig /all** to display your IP address settings.

MAC OS X

1. Navigate to your **Applications** folder and open **Utilities**.
2. Double-click on **Terminal** to launch the command prompt.
3. In the command prompt, type **ipconfig getifaddr <en0 or en1>** to display the wired or wireless IP address settings.

Note: **en0** is typically the wired Ethernet and **en1** is typically the wireless Airport interface.

Graphical Method

Windows XP/Vista/7/8/8.1/10

1. On your keyboard, press **Windows Logo + R** keys simultaneously to bring up the Run dialog box.
2. In the dialog box, type **ncpa.cpl** to bring up the Network Connections window.
3. Double-click the Local Area Connection icon and click the Details button to view the current IP address settings.

Note: The computer's network adapter must be enabled and connected to view the current IP address settings.

MAC OS X

1. From the **Apple** menu, select **System Preferences**.
2. In System Preferences, from the **View** menu, select **Network**.
3. In the Network preference window, click a network port (e.g., Ethernet, AirPort, modem). If you are connected, you'll see your IP address settings under "Status:"

Federal Communication Commission Interference Statement

This device complies with Part 15 of the FCC Rules. Operation is subject to the following two conditions: (1) This device may not cause harmful interference, and (2) this device must accept any interference received, including interference that may cause undesired operation.

This equipment has been tested and found to comply with the limits for a Class B digital device, pursuant to Part 15 of the FCC Rules. These limits are designed to provide reasonable protection against harmful interference in a residential installation. This equipment generates, uses and can radiate radio frequency energy and, if not installed and used in accordance with the instructions, may cause harmful interference to radio communications. However, there is no guarantee that interference will not occur in a particular installation. If this equipment does cause harmful interference to radio or television reception, which can be determined by turning the equipment off and on, the user is encouraged to try to correct the interference by one of the following measures:

- Reorient or relocate the receiving antenna.
- Increase the separation between the equipment and receiver.
- Connect the equipment into an outlet on a circuit different from that to which the receiver is connected.
- Consult the dealer or an experienced radio/TV technician for help.

FCC Caution: Any changes or modifications not expressly approved by the party responsible for compliance could void the user's authority to operate this equipment.

This transmitter must not be co-located or operating in conjunction with any other antenna or transmitter.

Operations in the 5.15-5.25GHz band are restricted to indoor usage only.

This device meets all the other requirements specified in Part 15E, Section 15.407 of the FCC Rules.

Radiation Exposure Statement:

This equipment complies with FCC radiation exposure limits set forth for an uncontrolled environment. This equipment should be installed and operated with minimum distance 20cm between the radiator & your body.

Note: The country code selection is for non-US model only and is not available to all US model. Per FCC regulation, all WiFi product marketed in US must fixed to US operation channels only.

TRENDNET®

Certifications

This device complies with Part 15 of the FCC Rules.

Operation is subject to the following two conditions:

- (1) This device may not cause harmful interference, and
- (2) This device must accept any interference received.

Including interference that may cause undesired operation.



Waste electrical and electronic products must not be disposed of with household waste. Please recycle where facilities exist. Check with your Local Authority or Retailer for recycling advice.

Technical Support

If you have any questions regarding the product installation, please contact our Technical Support.

Toll free US/Canada: **1-855-373-4741**

Regional phone numbers available at www.trendnet.com/support

TRENDnet

20675 Manhattan Place
Torrance, CA 90501
USA

Applies to PoE Products Only: This product is to be connected only to PoE networks without routing to the outside plant.

Note

The Manufacturer is not responsible for any radio or TV interference caused by unauthorized modifications to this equipment. Such modifications could void the user's authority to operate the equipment.

Advertencia

En todos nuestros equipos se mencionan claramente las características del adaptador de alimentación necesario para su funcionamiento. El uso de un adaptador distinto al mencionado puede producir daños físicos y/o daños al equipo conectado. El adaptador de alimentación debe operar con voltaje y frecuencia de la energía eléctrica domiciliar existente en el país o zona de instalación.

Note

The equipment power supply cord shall be connected to a socket-outlet with earthing connection.

Advertencia

Le cordon d'alimentation de l'appareil doit être raccordé à une prise de courant avec mise à la terre.

Product Warranty Registration

Please take a moment to register your product online. Go to TRENDnet's website at: www.trendnet.com/register