

SonicWall® NSa 4700

Quick Start Guide

For product information, use the QR code or go to [SonicWall Tech Docs for NSa](#)



Regulatory Model Number	Product Name
1RK53-115	NSa 4700



Copyright © 2023 SonicWall Inc. All rights reserved.

SonicWall is a trademark or registered trademark of SonicWall Inc. and/or its affiliates in the U.S.A. and/or other countries. All other trademarks and registered trademarks are property of their respective owners.

The information in this document is provided in connection with SonicWall Inc. and/or its affiliates' products. No license, express or implied, by estoppel or otherwise, to any intellectual property right is granted by this document or in connection with the sale of SonicWall products. EXCEPT AS SET FORTH IN THE TERMS AND CONDITIONS AS SPECIFIED IN THE LICENSE AGREEMENT FOR THIS PRODUCT, SONICWALL AND/OR ITS AFFILIATES ASSUME NO LIABILITY WHATSOEVER AND DISCLAIMS ANY EXPRESS, IMPLIED OR STATUTORY WARRANTY RELATING TO ITS PRODUCTS INCLUDING, BUT NOT LIMITED TO, THE IMPLIED WARRANTY OF MERCHANTABILITY, FITNESS FOR A PARTICULAR PURPOSE, OR NON-INFRINGEMENT. IN NO EVENT SHALL SONICWALL AND/OR ITS AFFILIATES BE LIABLE FOR ANY DIRECT, INDIRECT, CONSEQUENTIAL, PUNITIVE, SPECIAL OR INCIDENTAL DAMAGES (INCLUDING, WITHOUT LIMITATION, DAMAGES FOR LOSS OF PROFITS, BUSINESS INTERRUPTION OR LOSS OF INFORMATION) ARISING OUT OF THE USE OR INABILITY TO USE THIS DOCUMENT, EVEN IF SONICWALL AND/OR ITS AFFILIATES HAVE BEEN ADVISED OF THE POSSIBILITY OF SUCH DAMAGES. SonicWall and/or its affiliates make no representations or warranties with respect to the accuracy or completeness of the contents of this document and reserves the right to make changes to specifications and product descriptions at any time without notice. SonicWall Inc. and/or its affiliates do not make any commitment to update the information contained in this document.

For more information, visit <https://www.sonicwall.com/legal/>.

Legend

WARNING: A WARNING icon indicates a potential for property damage, personal injury, or death.

CAUTION: A CAUTION icon indicates potential damage to hardware or loss of data if instructions are not followed.

IMPORTANT, NOTE, TIP, MOBILE, or VIDEO: An information icon indicates supporting information.

To access the Support Portal, go to <https://www.sonicwall.com/support>.

SonicWall NSa 4700 Quick Start Guide
Updated - February 2023
232-005665-51 Rev A



1 Package Contents

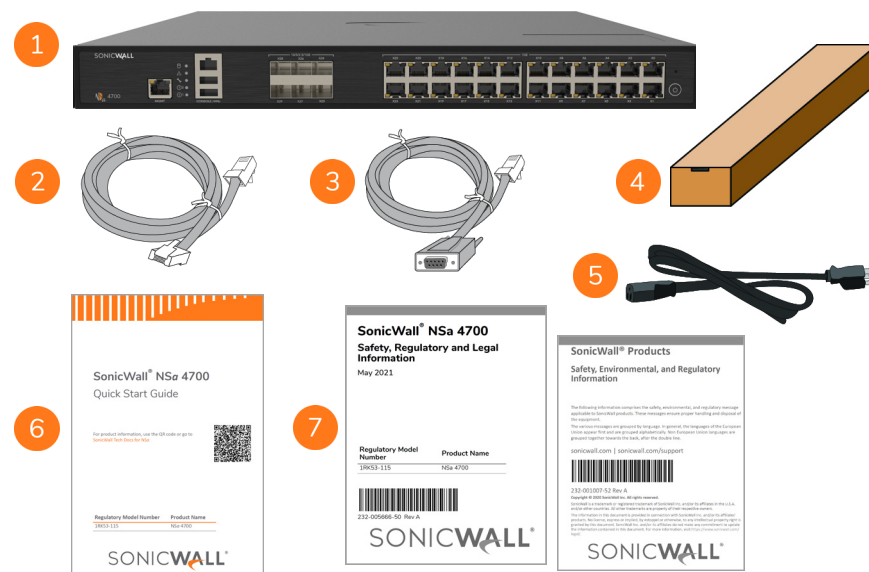

- 1 NSa 4700 appliance
- 2 Ethernet cable
- 3 Serial console cable (RJ45 to DB9)
- 4 Rack mount kit
- 5 Power cord (1)
- 6 SonicWall NSa 4700 Quick Start Guide
- 7 Safety, Environmental, and Regulatory information documents

NOTE: The included power cord is approved for use only in specific countries or regions. Before using a power cord, verify that it is rated and approved for use in your location. The power cord is for AC mains installation only. Refer to the *NSa 4700 Safety, Regulatory, and Legal Information* document for additional safety information.

メモ: 添付の電源コードに関して電気安全を確保するために、弊社製品にご使用いただく電源コードは必ず製品同梱の電源コードをご使用ください。この電源コードは他の製品では使用できません。

Items missing? Contact SonicWall Technical Support at: <https://www.sonicwall.com/support/contact-support>

- 8 **Test LED:** Red = Power down requested, Yellow = Initializing, Blinking Yellow = SafeMode / FIPS test in progress, Off = Normal
- 8 **Power LED:** 1 = Primary, 2 = Redundant
Blue = Powered on, Yellow = Defective redundant power supply

3 Rear Panel

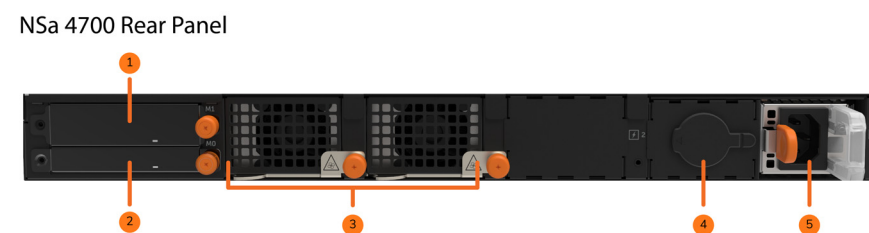

- 1 **M1 Slot for SSD:** Optional extended storage drive
- 2 **M0 Slot / M.2 Module:** Boot drive
- 3 **System Fans (2)**
- 4 **Redundant Power Input (with cover plate):** A redundant power supply can be ordered separately.
- 5 **Primary Power Input**

2 Front Panel



- 1 **MGMT** **MGMT Port - RJ45:** The MGMT port is a dedicated 1GE interface for appliance management and SafeMode access. Solid Green = Link at 1G or lower, Blinking Green = Activity
- 2 **console** **Console Port - RJ45:** Serial Console for CLI access
- 3 **X24 - X29** **10/5/2.5/1GE SFP28 Ports and LEDs:** Solid Amber = Link at 10G, 5G or 2.5G, Blinking Amber = Activity at 10G, 5G or 2.5G. Solid Green = Link at 1G or lower, Blinking Green = Activity at 1G or lower. Off = No link
- 4 **X0 - X23** **RJ45 1GE Copper Ports and LEDs:** Solid Green = Link at speeds 1G or lower, Blinking Green = Activity at 1G or lower, Amber = Unused, Off = No link
- 5 **SafeMode Button:** A recessed button used to enter SafeMode: If NSa is up: Press button with a narrow, straight object. If NSa is down: Press while connecting NSa to power and hold until Test LED blinks yellow three times.
- 6 **Power Button:** Short press powers ON if button was used to power system off. Short press powers OFF with Graceful Shutdown. Test and Alarm LEDs turn Red. Standby power to some circuitry stays on. Long Press (5+ sec) = Forced Shutdown. Standby power to some circuitry stays on.
- 7 **SS** **USB SS 3.0 Ports:** For Configuration, Recovery, Reimaging the NSa, and USB WWAN device support.
- 8 **Storage LED:** Status on internal and external storage. Blinking Green = Activity. Yellow = Storage warning. Off = No activity
- 8 **Alarm LED:** Red = High Level Alarm (such as Fan Failure) / Power down requested, Yellow = Lower Level Alarm

4 Connect and Power On

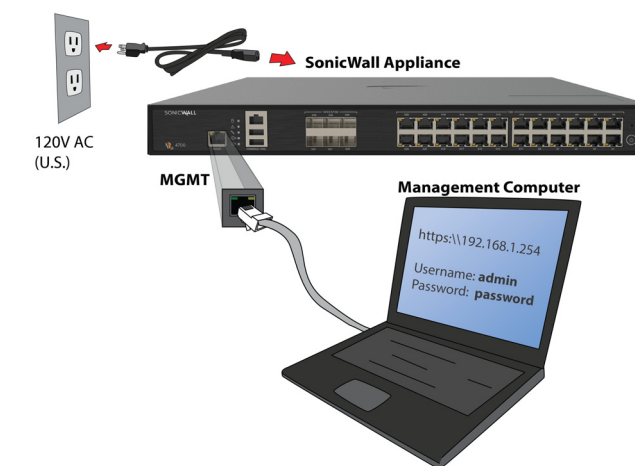

To power on your NSa and connect the LAN and WAN:

- 1 Connect the provided power cord to the appliance and to an electrical outlet (100-240 volts). The NSa powers on. The startup sequence takes about eight minutes.
- 2 Connect the NSa LAN interface (X0 by default) to your local, internal network.
- 3 Connect the NSa WAN interface (X1) to the Internet.

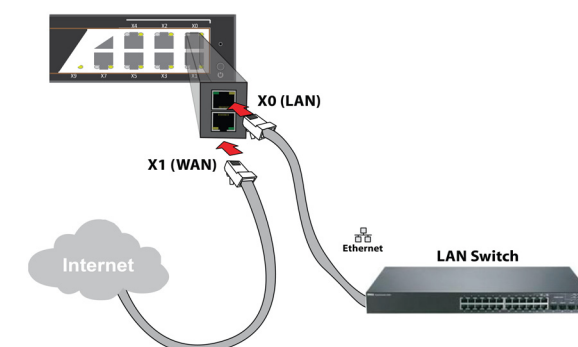

5 Setup Options

Setup using Local Management



Set up and manage your NSa by connecting it to a management computer with an Ethernet cable. To minimize scrolling, set your screen resolution to at least 1920 x 1080 pixels.

Setup using Cloud Management



Use SonicWall Capture Security Center (CSC) and Network Security Manager (NSM) with Zero Touch to manage and configure your NSa from the cloud.

Setup using SonicExpress App



Use SonicWall SonicExpress on your smartphone to register and configure your NSa.

- NOTE:** After initial setup, be sure to download the latest firmware from MySonicWall and upgrade your NSa. Your appliance must be registered to download the latest firmware from MySonicWall.

7 Cloud Management

Use CSC to access MySonicWall and NSM to register and manage your NSa.



- NOTE:** This option requires a Cloud Management license.

- Log into CSC at cloud.sonicwall.com using your MySonicWall credentials.
- Select the **MySonicWall** tile to register your NSa.
- Enable **Zero Touch** and **NSM licensing** on your NSa in MySonicWall.
- Select the **Network Security Manager** tile in CSC to manage your NSa from the cloud.

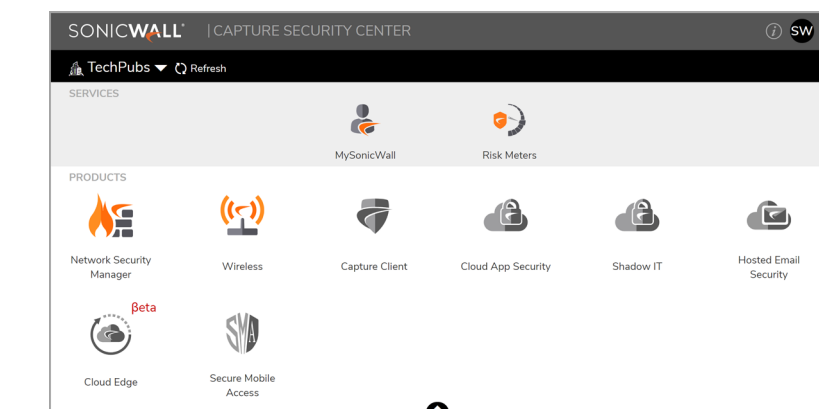

ID	FRIENDLY NAME	SERIAL NUMBER	TENANT NAME	SERVICES	MODEL	IP ADDRESS	TAGS	VERSION	ZERO TOUCH	LINK	STATUS
1	NSM-001	000000000000	NSM-2.0	Unknown	Unknown	Unknown	Unknown	Unknown			Red
2	NSM-002	000000000000	NSM-2.0	Unknown	Unknown	Unknown	Unknown	Unknown			Red
3	NSM-003	000000000000	NSM-2.0	Unknown	Unknown	Unknown	Unknown	Unknown			Red
4	NSM-004	000000000000	NSM-2.0	Unknown	Unknown	Unknown	Unknown	Unknown			Red
5	NSM-005	000000000000	NSM-2.0	Unknown	Unknown	Unknown	Unknown	Unknown			Red
6	NSM-006	000000000000	NSM-2.0	Unknown	Unknown	Unknown	Unknown	Unknown			Red
7	NSM-007	000000000000	NSM-2.0	Unknown	Unknown	Unknown	Unknown	Unknown			Red
8	NSM-008	000000000000	NSM-2.0	Unknown	Unknown	Unknown	Unknown	Unknown			Red
9	NSM-009	000000000000	NSM-2.0	Unknown	Unknown	Unknown	Unknown	Unknown			Red
10	NSM-010	000000000000	NSM-2.0	Unknown	Unknown	Unknown	Unknown	Unknown			Red

6 Initial Setup and Registration Using Local Management

- Configure your computer with an IP address in the 192.168.1.x subnet, such as 192.168.1.100, and set the network mask to 255.255.255.0.
 - Using the provided Ethernet cable, connect the MGMT interface to your computer.
 - Navigate to <https://192.168.1.254> in your web browser and login with the default credentials:
Username: **admin**
Password: **password**
 - After a successful login with the default password, you are prompted to change the password.
- NOTE:** The default password must be changed at the time of your first login. Use the new password for future login attempts.
- Launch the **Setup Guide** wizard or manually configure the NSa to setup the WAN interface, change the **admin** password, and select other settings.
 - After completing the setup wizard, reconfigure your computer to automatically obtain an IP address and DNS server address, or set it to the appropriate static network settings.
 - Connect your computer to the LAN or WAN network and login to SonicOS. The LAN provides a DHCP IP

address to your computer. The default LAN IP address is <https://192.168.168.168>.

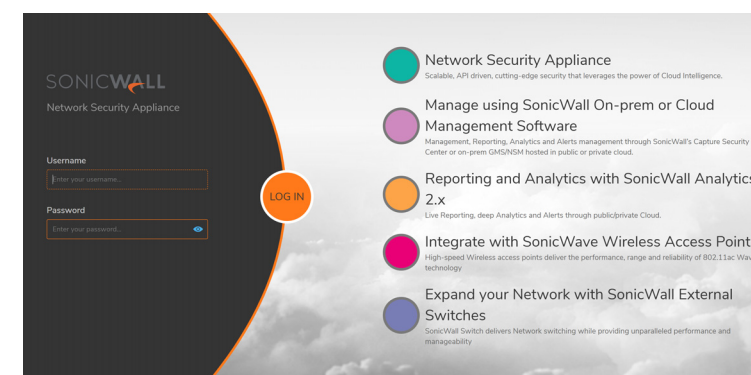

- NOTE:** You cannot reach the Internet or other external destinations while connected to the MGMT interface without first configuring a default gateway in its interface settings.
- Click **Register** and enter your MySonicWall credentials to register your NSa.
- TIP:** Registering the appliance from SonicOS requires that DNS settings are configured for the WAN interface. For DHCP WAN type, DNS is set automatically.

8 SonicExpress App

Use SonicExpress on your smartphone to register and configure your NSa.



- Download and launch the SonicExpress App on your iOS or Android device.
- Tap **Login** and login with your MySonicWall credentials.
- Select the tenant for the NSa. Tenants can contain multiple SonicWall appliances.
- Connect your iOS/Android device to the NSa with the smartphone USB cable. This cable is not supplied with the NSa.



- NOTE:** Use the USB cable from your mobile device.

- Use the **Setup Guide** to register the NSa, synchronize service licenses, change the password, and configure essential interface settings.

9 SonicWall Secure SD-Branch

SD-Branch combines SD-WAN, SD-LAN, unified security, and centralized management for distributed enterprises.

Related Products



TZ, NSa, NSsp Series

Next-generation firewalls with integrated SD-WAN



SonicWave APs

Wireless Access Points



SonicWall Switch

Network Access Switch



Capture Client

Endpoint Security



Cloud App Security

Secure Cloud Applications



Capture Security Center

Single-pane-of-glass Management with Zero-Touch Deployment