



OX-1 Support Overview



Package Contents



OX-1



USB2.0 cable



Quick Start Guide



Warranty Card



IMPORTANT SAFEGUARDS

Part Identification

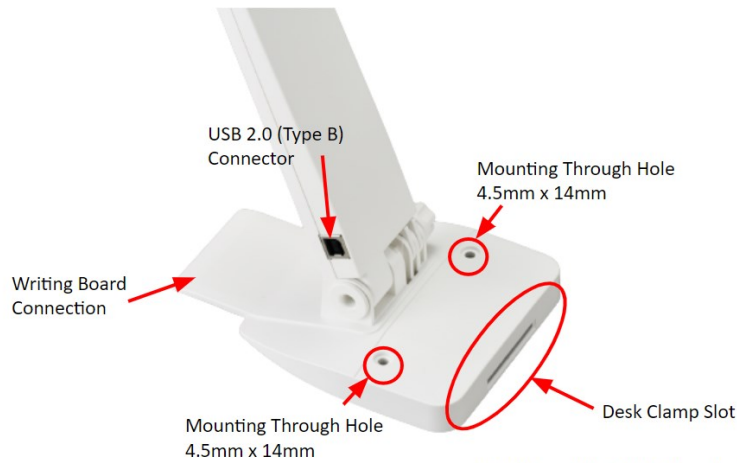

Not Pictured: 1/4-20 UNC thread on bottom of camera

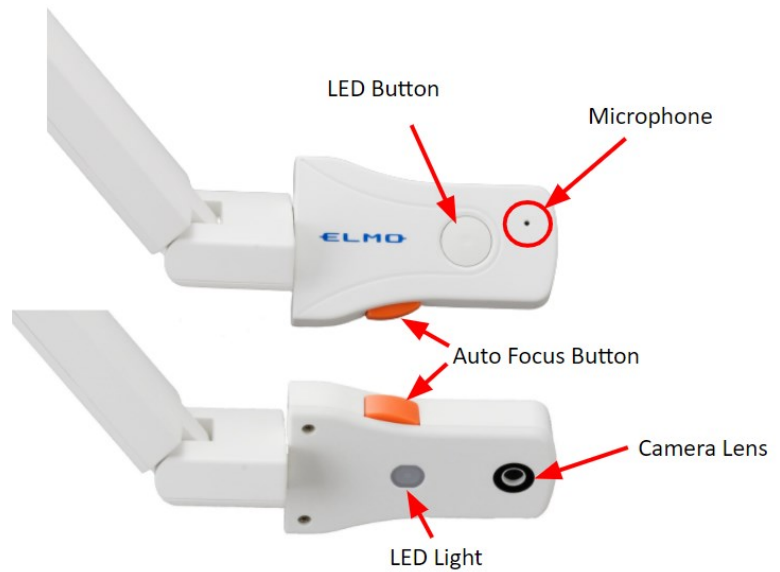

Supported Software

Windows 7 / 8 / 8.1 / 10

- ELMO Interactive Toolbox for Windows
- Image Mate + Cloud

MacOS 10.14 +

- ELMO Interactive Toolbox for Mac
- Image Mate + Cloud

ChromeOS

- Image Mate + Cloud

FAQ

Q: Where do I find the drivers?

A: The OX-1 is UVC compliant and uses Operating System provided drivers.

Q: How do I know I'm choosing the correct camera?

A: The OX-1 will be recognized as either: OX-1 or ELMO Camera. This depends on which software you're using.

Q: Why is my image backwards?

A: The image may appear mirrored in some third-party software. This is normal and expected.

Troubleshooting

Problem: Camera not recognized / No image from camera

Solution: Change USB cable. Change USB port. Reset/reinstall software.

Problem: Image too bright / dark

Solution: Adjust brightness in software. Turn LED on/off.

Problem: Image is out of focus

Solution: Press AF button. Adjust distance between object and lens (minimum 100mm).

Problem: Low frame rate

Solution: Check available system resources. Adjust resolution in software.

Optional Accessories



MX Writing Board (1356)



Desk Clamp (1434)

Replacement Parts

Part Name	Product Code
Replacement USB Cable	5ZA0000151