



VP2776T-4K

Package Contents

- Monitor
- Power Cord
- Video Cable
- Quick Start Guide



NOTE: The cables included in your package may vary depending on your country. Please contact your local reseller for more information.

Front View / Rear View



Front View

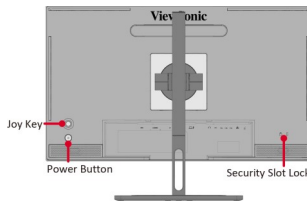

Rear View

I/O Ports

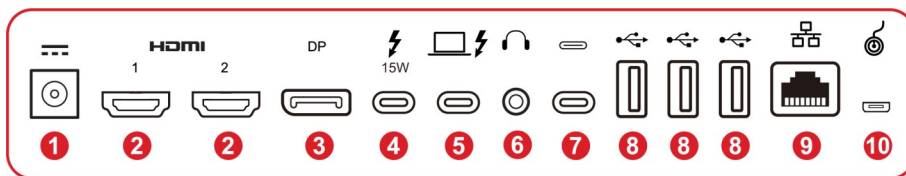

Number	Item
1	DC IN
2	HDMI
3	DisplayPort
4	Thunderbolt Out
5	Thunderbolt In
6	Audio Out
7	USB Upstream
8	USB Downstream
9	LAN
10	Micro USB

NOTE: For more information about the / / / / key and its functions, refer to **Hot Keys**.

Product Overview - ColorPro™ Wheel

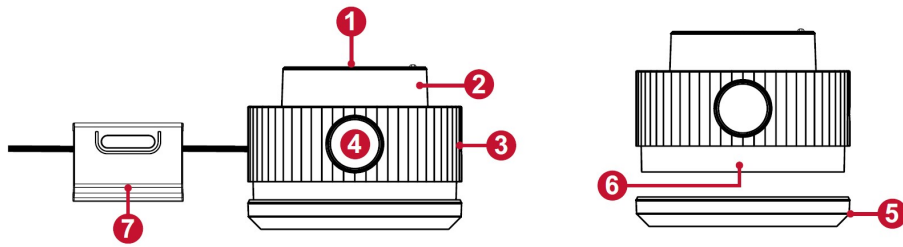

NOTE: The ColorPro™ Wheel is an optional accessory.

Number	Item
1	Confirm Button
2	Dial
3	Grip
4	Back Button
5	Lens Cap
6	Lens
7	Adjustable Weight

Stand Installation

1. Place the monitor on a flat, stable surface with the screen facing down.
2. Align and slide the upper hooks of the monitor stand into the stand mounting slots.

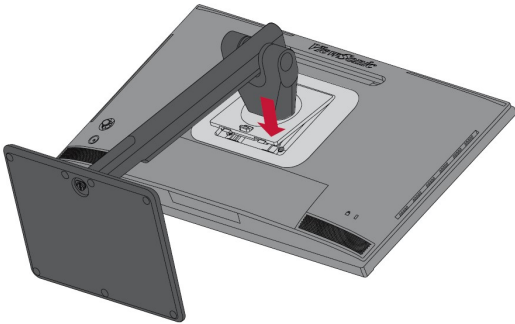
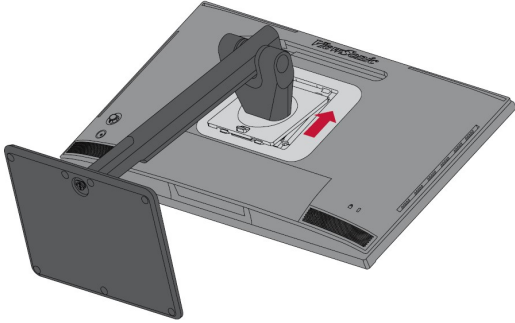

3. Lift the monitor into its upright position on a flat, stable surface.



NOTE: Always place the device on a flat, stable surface. Failure to do so may cause the device to fall and damage the device and/or result in personal injury.

Wall Mounting

Refer to the table below for the standard dimensions for wall mount kits.

NOTE: For use only with a UL certified wall mount kit/bracket. To obtain a wall-mounting kit or height adjustment base, contact ViewSonic® or your local dealer.

Maximum Loading	Hole Pattern (W x H)	Interface Pad (W x H x D)	Pad Hole	Screw Specification	Screw Quantity
14 kg	100 x 100 mm	N/A	N/A	M4 x 10 mm	4

1. Turn off the device and disconnect all cables.
2. Place the device on a flat, stable surface with the screen facing down.
3. Pull and hold the quick release tab and carefully lift the stand.

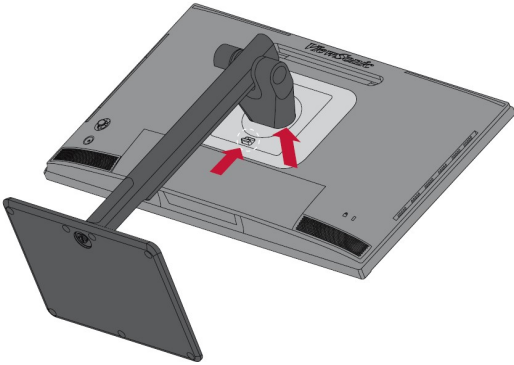

4. Pull down slightly to disengage the hooks and remove the stand.

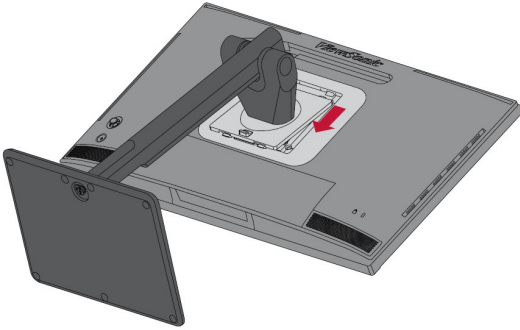

5. Attach the mounting bracket to the VESA mounting holes at the rear of the monitor. Then secure it with four screws (M4 x 10 mm).

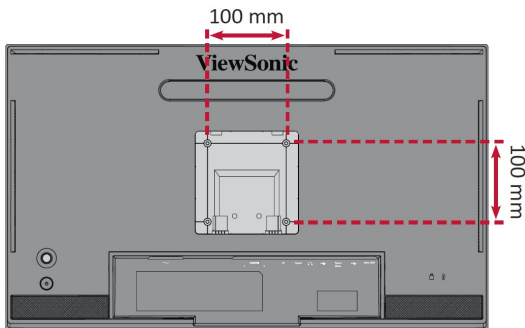

6. Follow the instructions that come with the mounting kit to mount the monitor.

Installing the Shade Hood

NOTE: The Shade Hood is an optional accessory.

1. Place the monitor upright on a flat, stable surface. Make sure the monitor is rotated to the landscape mode.

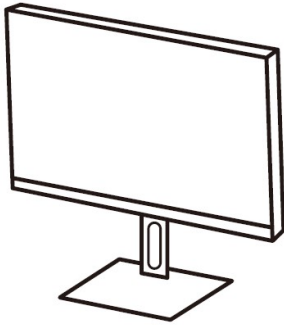

2. Prepare the shade hood by folding the side panels down.

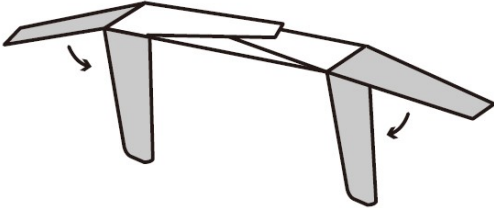

3. Attach the shade hood to the top of the monitor by aligning the shape bar inside the hood with the one on top of the monitor. Repeat for the left and right sides.

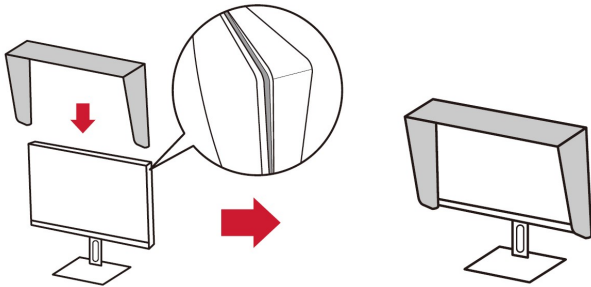

4. Press down on the shade hood to fix it firmly in place.

Using the Security Slot

To help prevent the device from being stolen, use a security slot locking device to secure the device to a fixed object.

Additionally, fastening the monitor to a wall or fixed object using a security cable can help support the weight of the monitor in order to prevent the monitor from falling over.

Below is an example of setting up a security slot locking device on a table.

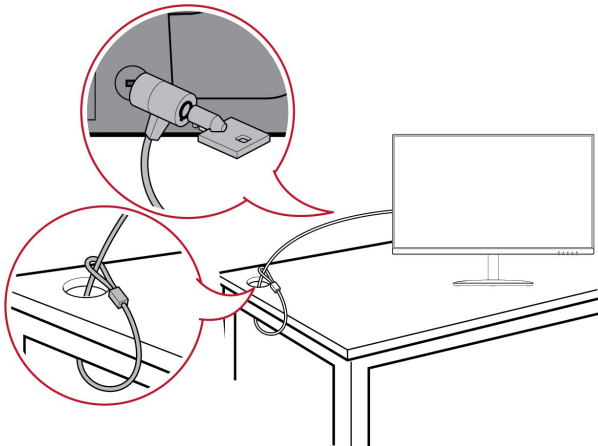

Connecting to Power

1. Connect the power adapter to the DC IN jack at the rear of the monitor.
2. Plug the power adapter plug into a power outlet.

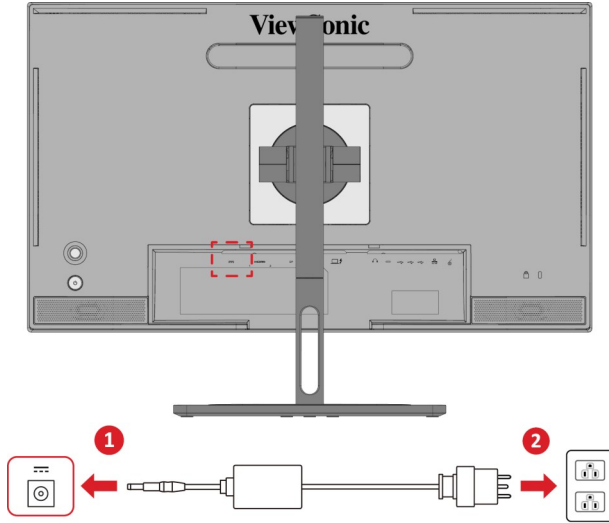

Connecting to Video

HDMI

1. Connect one end of an HDMI cable to an HDMI port of your monitor.
2. Then connect the other end of the cable to the HDMI port of your computer.

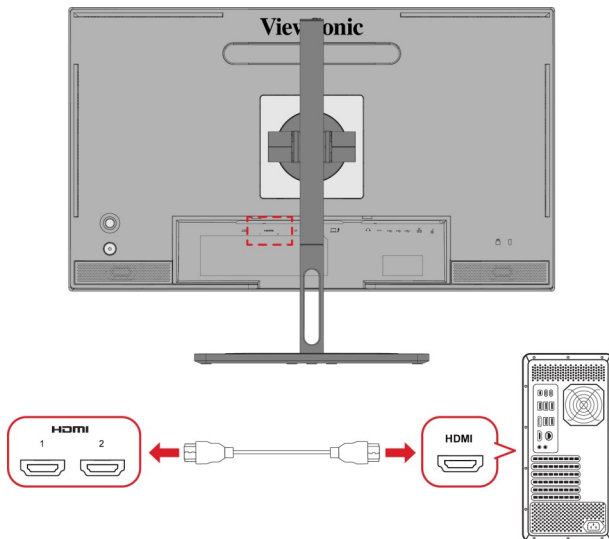

DisplayPort

1. Connect one end of a DisplayPort cable to the DisplayPort port of the monitor.
2. Plug the other end of the cable to the DisplayPort or mini DP port of your computer.

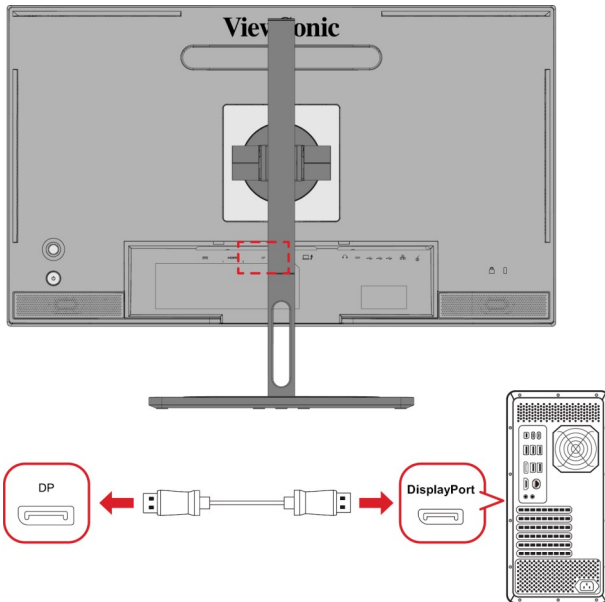

NOTE: To connect the monitor to the Thunderbolt port (v. 1 & 2) on your Mac, connect the Mini DisplayPort end of a “Mini DisplayPort to DisplayPort cable” to the Thunderbolt output port of your Mac. Then connect the other end of the cable to the DisplayPort port of the monitor.

Thunderbolt

1. Connect one end of a Thunderbolt cable to the Thunderbolt port of the monitor.
2. Plug the other end of the cable into the Thunderbolt port of your computer.

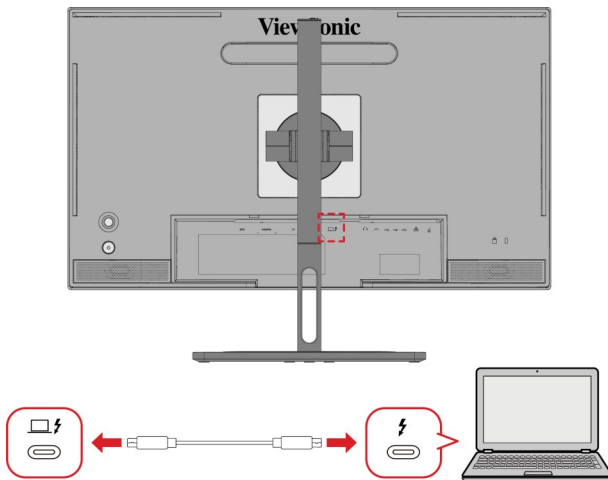

NOTE: For video output use, make sure your Thunderbolt output device (e.g., laptop) and cable support video signal transmission.

USB Connection

The monitor supports two types of USB ports, upstream and downstream. When making connection(s), observe the following guideline.

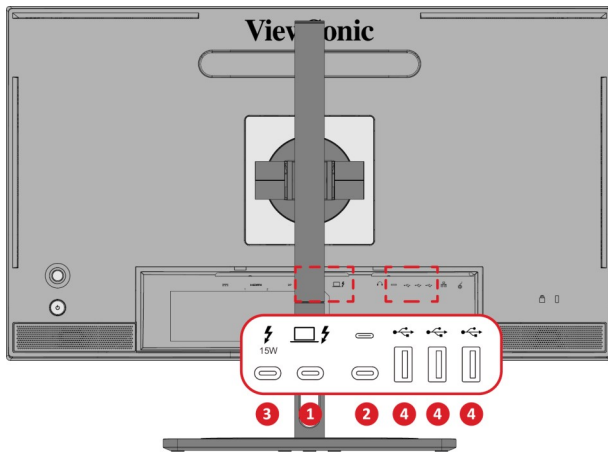

USB Type	Connection Type	Description
• Upstream	Thunderbolt	Transfers data between the computer and the USB devices connected to the monitor.
	Type C	For KVM function and Firmware updates. Supports 5V/3A charging.
• Downstream	Thunderbolt	For peripheral device(s) (e.g., storage device, keyboard, mouse, etc.).
	Type A	Supports 5V/2A charging. NOTE: 5V/2A cannot be sustained if all three USB Type A ports are used at the same time.

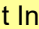
NOTE: To use peripheral devices with the USB Type A ports, please also connect your computer to the monitor's Thunderbolt In  port.

Using the USB Ports

1. To use the downstream USB ports, connect one end of a Thunderbolt cable to the upstream Thunderbolt In  port of the monitor. Plug the other end of the cable into a Thunderbolt port of your computer.
2. Connect your peripheral device(s) to a downstream USB Type A port of the monitor.

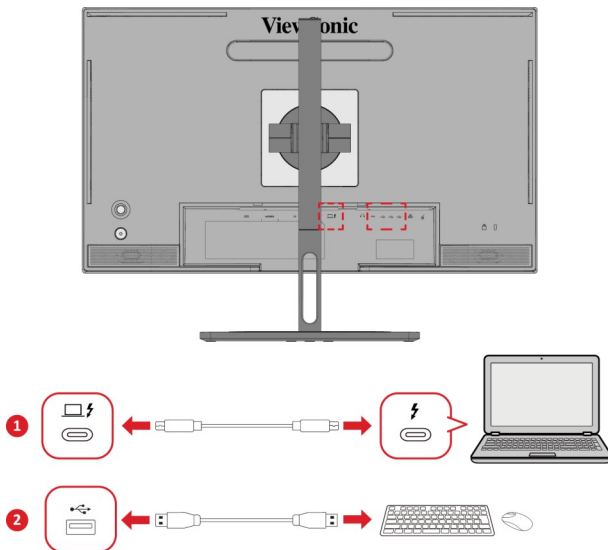

Audio Connection

Plug the audio jack of the audio device into the Audio Out port of the monitor.

NOTE: The monitor is also equipped with dual speakers.

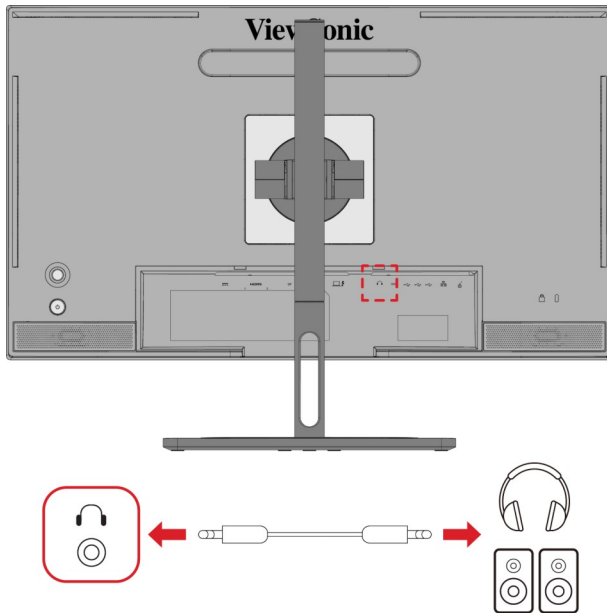

Connecting the ColorPro™ Wheel

NOTE: The ColorPro™ Wheel is an optional accessory.

Connect the USB Type A and Micro USB cable of the ColorPro™ Wheel to the USB Type A and Micro USB port of the monitor.

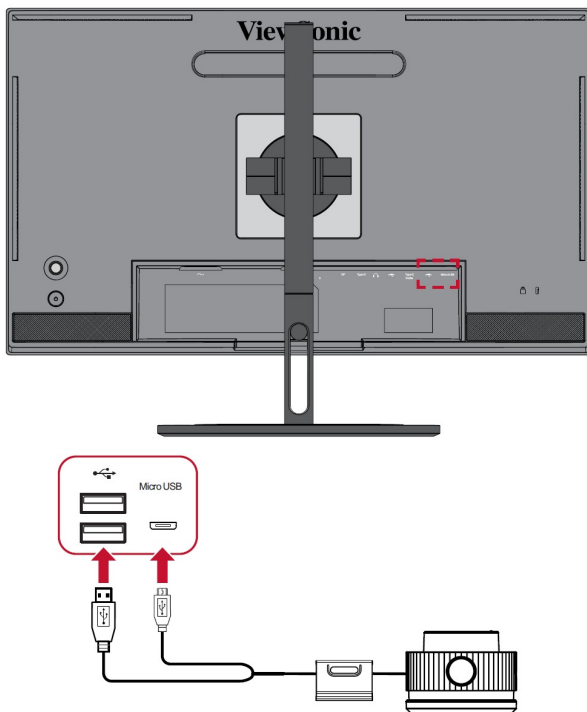

Adjusting the Viewing Angle

For optimal viewing, you can adjust the viewing angle using any of the following methods:

Height Adjustment

Lower or raise the monitor to the desired height (0 to 130 mm).

NOTE: When adjusting, press down firmly along the adjustment track holding the monitor with both hands on the side.

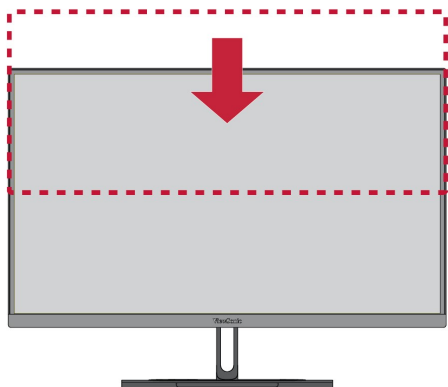

Screen Orientation Adjustment (Monitor Pivot)

1. Adjust the monitor height to the highest position. Then tilt the monitor backwards to the full tilt position.

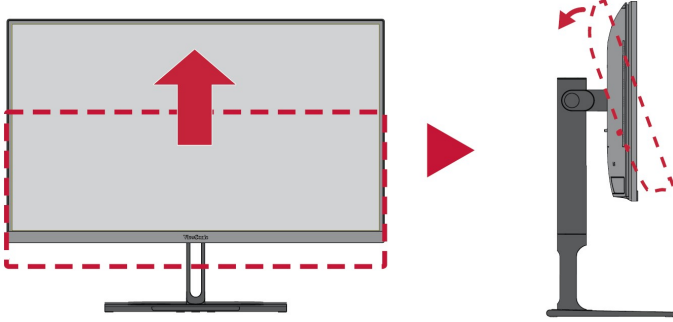

2. Rotate the monitor 90° clockwise or counterclockwise from landscape to portrait orientation.

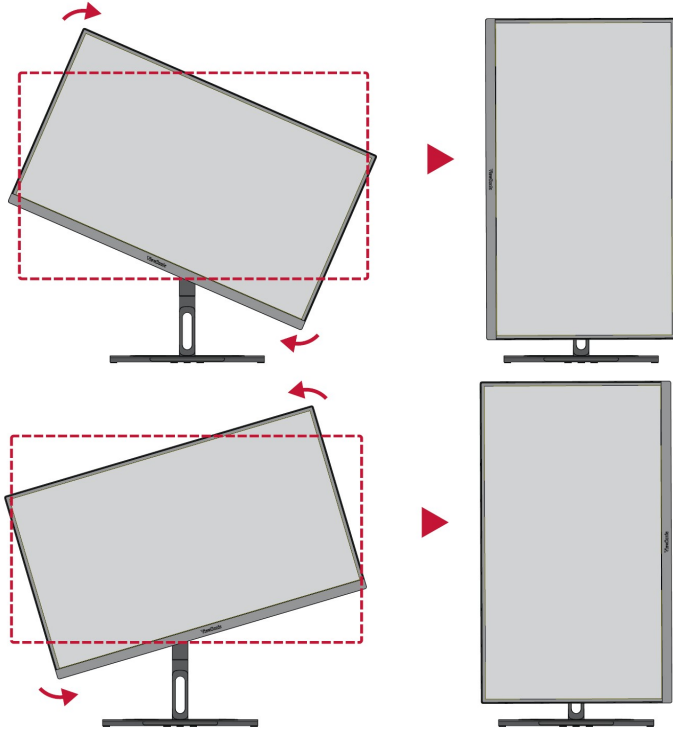

NOTE:

- When adjusting, make sure to hold both sides of your monitor firmly with both hands.
- If using the Auto Pivot function, the system can detect the screen orientation automatically.

Swivel Angle Adjustment

Swivel the monitor to the left or right for the desired viewing angle (60°).

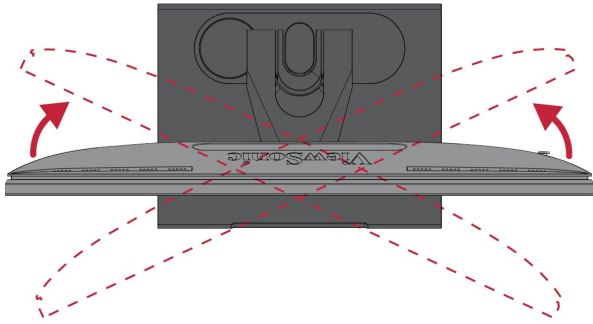

Tilt Angle Adjustment

Tilt the monitor forwards or backwards to the desired viewing angle (-5° to 21°).

NOTE: When adjusting, support the stand firmly with one hand while tilting the monitor forwards or backwards with the other hand.

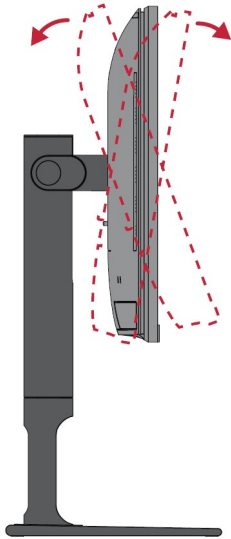

Turning the Device On/Off

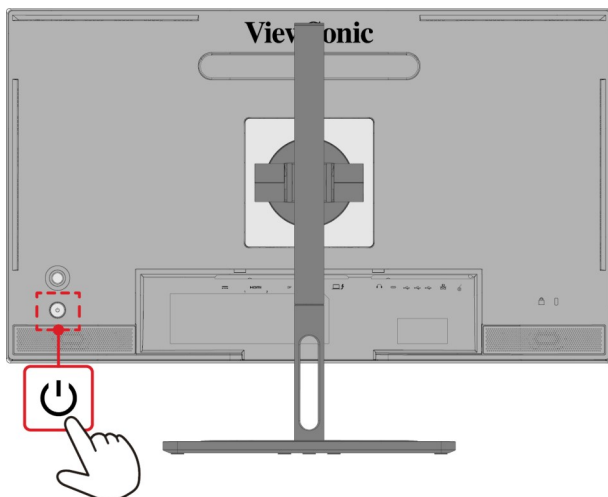

1. Plug the connected power adapter into a power outlet.
2. Press the **Power** button to turn on the monitor.
3. To turn the monitor off, press the **Power** button again.

NOTE:

- If the OSD Menu is still on screen, press and hold the **Power** button for three seconds to power off.
- The monitor will still consume some power as long as the power cord is connected to the power outlet. If the monitor is not being used for a long period of time, please disconnect the power plug from the power outlet.

Using the Joy Key

Use the **Joy Key** to activate Hot Keys, navigate the On-Screen Display (OSD) Menu, and change settings.

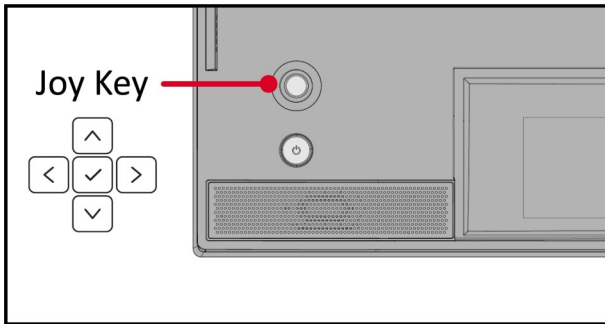

Startup Menu

Move the Joy Key  to activate the Startup Menu.

NOTE: Follow the key guide that appears on the screen to select the option or make adjustments.

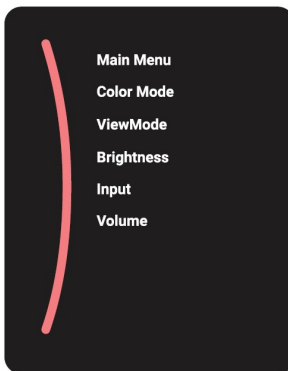

Main Menu

Enter the On-Screen Display (OSD) Menu.



Color Mode

Select one of the preset standard color settings.

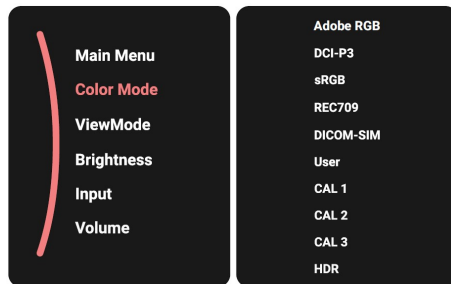

ViewMode

Select one of the preset display settings.

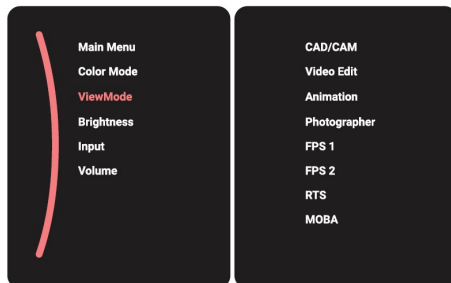

Brightness

Adjust the brightness level.

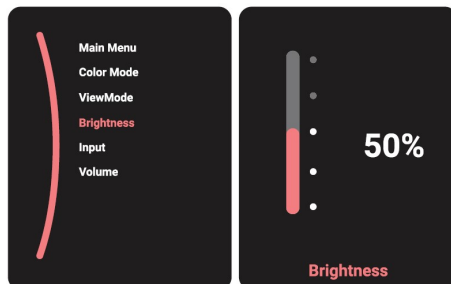

Input

Select the input source.

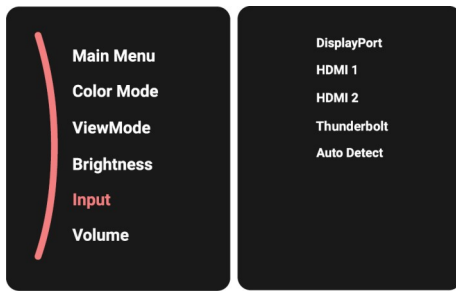

Volume

Adjust the volume settings.

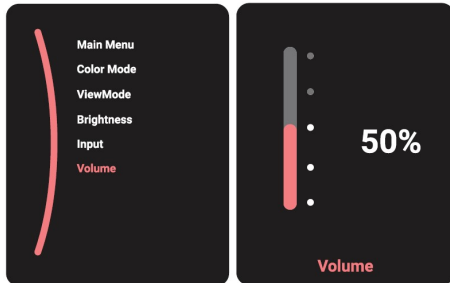



NOTE: Move the **Joy Key**  to return to the previous menu.

Hot Keys

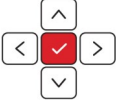
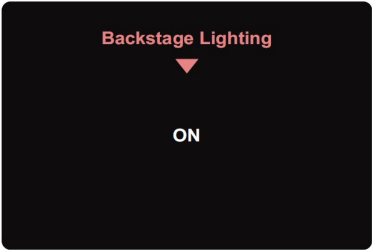
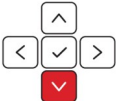
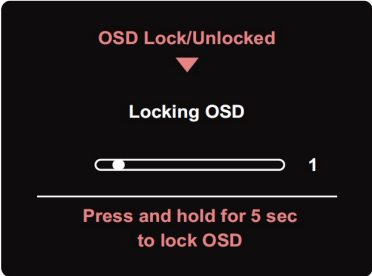
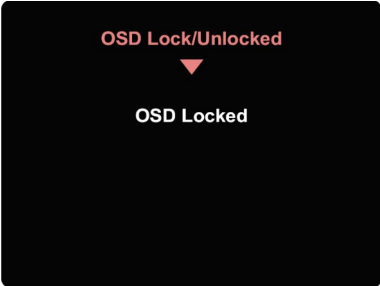
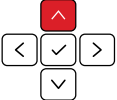
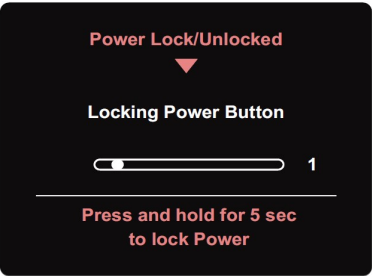
When the On-Screen Display (OSD) Menu is off, you can quickly access special functions by using the **Joy Key**.

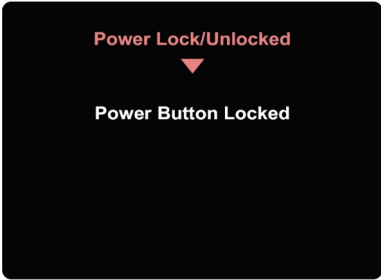
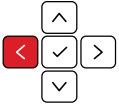
Key	Description
	<p>Press and hold the key for five seconds to activate/deactivate LED lighting.</p> 
	<p>Press and hold the key to lock/unlock the OSD Menu.</p> <p>When the menu appears on the screen, continue holding the key for 10 seconds to lock/unlock the OSD Menu.</p>  <p>If the OSD Menu is locked, the below message will appear on the screen:</p> 
	<p>Press and hold the key to lock/unlock the Power button.</p> <p>When the menu appears on the screen, continue holding the key for 10 seconds to lock/unlock the Power button.</p>  <p>If the Power button is locked, the below message will appear on the screen.</p>

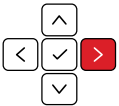
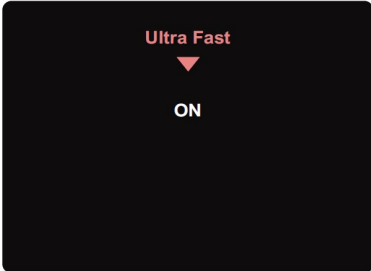
	
	<p>Press and hold the key for 10 seconds to display/hide the boot up screen when the device is turned on.</p> 
	<p>Press and hold the key for 10 seconds to activate/deactivate Ultra Fast.</p> 

ColorPro™ Wheel for OSD Control

NOTE: The ColorPro™ Wheel is an optional accessory.

In addition to the **Joy Key**, the ColorPro™ Wheel also provides a quick way to control and access the On-Screen Display (OSD) Menu.

Using the ColorPro™ Wheel

Entering the OSD Menu

Enter the OSD Menu by pressing the **Confirm Button**.

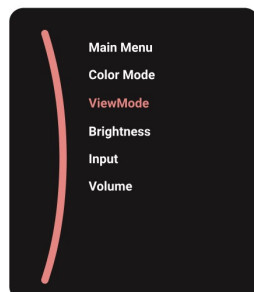
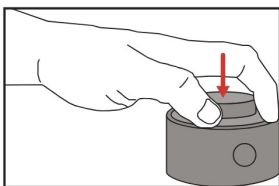

Select an Option and Confirm

Rotate the **Dial** to select an option, and press the **Confirm Button** to confirm.

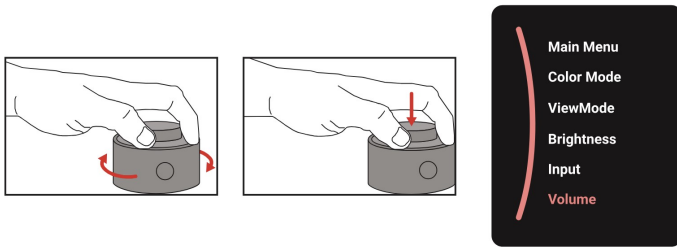

Adjust the Value

Rotate the **Dial** left or right to adjust the value of the selected option.

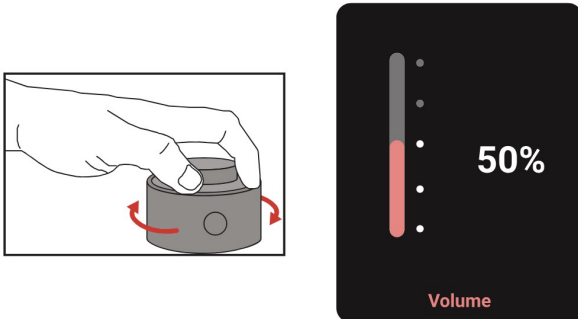

Back

Press **Back Button** the at any time to return to the previous option.

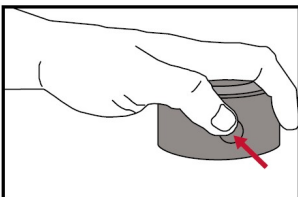

ColorPro™ Wheel Hot Keys

In addition to the **Joy Key**, the ColorPro™ Wheel also provides a quick way to access special functions when the On-Screen Display (OSD) Menu is off.

Key	Description
	<p>Press and hold the key for 2 seconds to activate/deactivate LED lighting.</p>
	<p>Press the key to activate the KVM feature when in PBP Mode.</p>

General Operations

1. Move the **Joy Key** to display the Startup Menu. Then navigate to **Main Menu** and press the **Joy Key** to display the OSD Menu.



2. Move the **Joy Key** or to select the main menu. Then press the **Joy Key** to enter the selected menu.

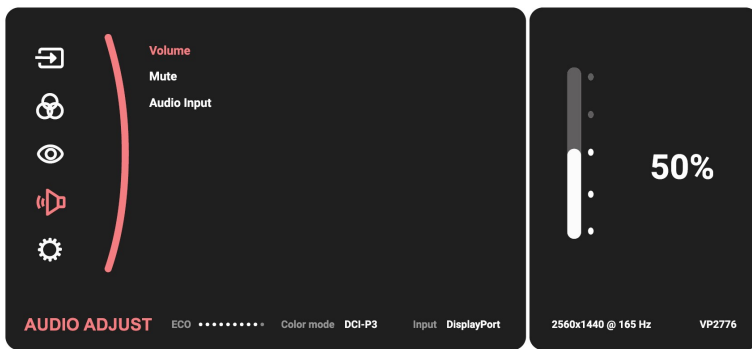

3. Move the **Joy Key** or to select the desired menu option. Then press the **Joy Key** to enter the sub-menu.

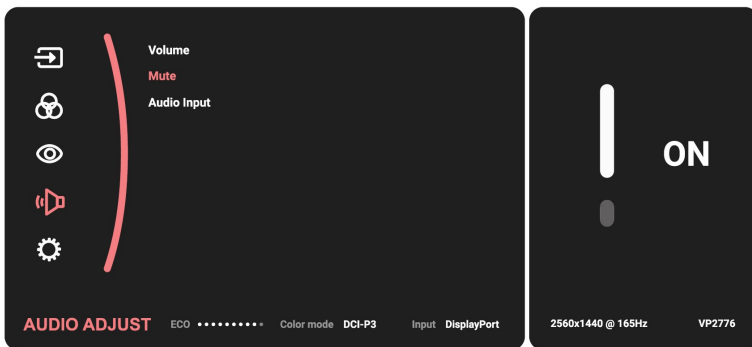

4. Move the **Joy Key** or to select the desired menu option. Then press the **Joy Key** to enter the sub-menu.

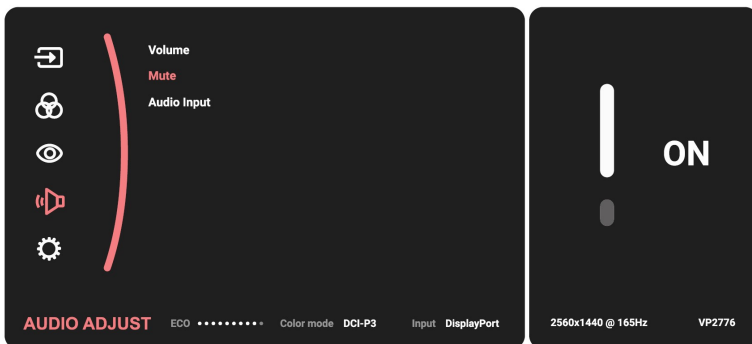

5. Move the **Joy Key** or to adjust/select the setting. Then press the **Joy Key** to confirm.



6. Move the **Joy Key** to return to the previous menu.

OSD Tree

Input SelectColor ModeViewModeAudio AdjustSetup Menu

Sub-menu	Menu Option	
DisplayPort	Color Format	Auto
		RGB (Full Range)
		RGB (Limited Range)
		YUV (Full Range)
		YUV (Limited Range)
	DisplayPort 1.4	On
		Off
HDMI 1	Color Format	Auto
		RGB (Full Range)
		RGB (Limited Range)
		YUV (Full Range)
		YUV (Limited Range)
	HDMI 2.0	On
		Off
HDMI 2	Color Format	Auto
		RGB (Full Range)
		RGB (Limited Range)
		YUV (Full Range)
		YUV (Limited Range)
	HDMI 2.0	On
		Off
Thunderbolt	Color Format	Auto
		RGB (Full Range)
		RGB (Limited Range)
		YUV (Full Range)
		YUV (Limited Range)
	USB 3.2	On
		Off
	DisplayPort 1.4	On
		Off
Auto Detect	On	
	Off	

Input



1. Move the **Joy Key** to display the Startup Menu. Then navigate to **Main Menu** and press the **Joy Key** to display the OSD Menu.
2. Move the **Joy Key** or to select **Input**. Then press the **Joy Key** to enter the **Input** menu.
3. Move the **Joy Key** or to select the desired input source. Then press the **Joy Key** to confirm the selection.

Color Mode

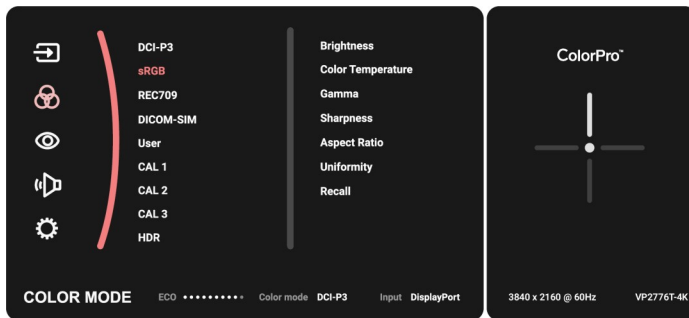

1. Move the **Joy Key** to display the Startup Menu. Then navigate to **Main Menu** and press the **Joy Key** to display the OSD Menu.
2. Move the **Joy Key** or to select **Color Mode**. Then press the **Joy Key** to enter the **Color Mode** menu.
3. Move the **Joy Key** or to select the desired option. Then press the **Joy Key** to enter its sub-menu.
4. Move the **Joy Key** or to adjust/select the setting, and press the **Joy Key** to confirm the selection (if applicable).

Menu Option	Description
DCI-P3	Precise color gamut and gamma of DCI-P3 standard.
sRGB	Precise color gamut and gamma of sRGB standard.
REC709	Precise color gamut and gamma of ITU-R Rec. 709 standard.
DICOM-SIM	Gamma curves are set to a DICOM simulation.
User	Custom, user-defined settings.
CAL1/CAL2/ CAL3	Display with the 1st/2nd/3rd user calibration mode.
HDR	Reduce the overall contrast of a given scene so that detail in the highlights and shadows can be seen.

ViewMode

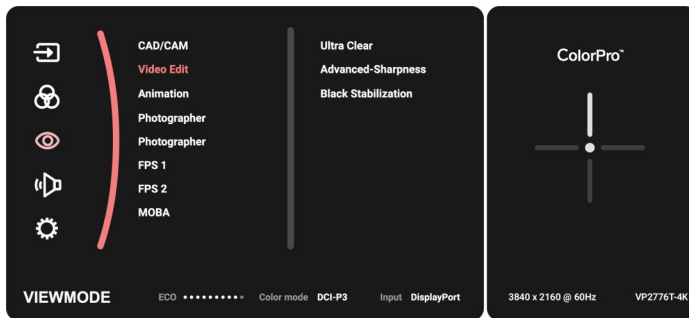

1. Move the **Joy Key** to display the Startup Menu. Then navigate to **Main Menu** and press the **Joy Key** to display the OSD Menu.
2. Move the **Joy Key** or to select **ViewMode**. Then press the **Joy Key** to enter the **ViewMode** menu.
3. Move the **Joy Key** or to select the desired option. Then press the **Joy Key** to enter its sub-menu.

Menu Option	Description
CAD/CAM	Select this option for viewing graphic design files.
Video Edit	Select this option for video editing.
Animation	Select this option for animation.
Photographer	Select this option for viewing photo files.
FPS 1	Ideal for First-Person Shooter games.
FPS 2	Ideal for First-Person Shooter games.
RTS	Ideal for Real-Time Strategy games.
MOBA	Select this option for Multiplayer Online Battle Arena games.

Audio Adjust

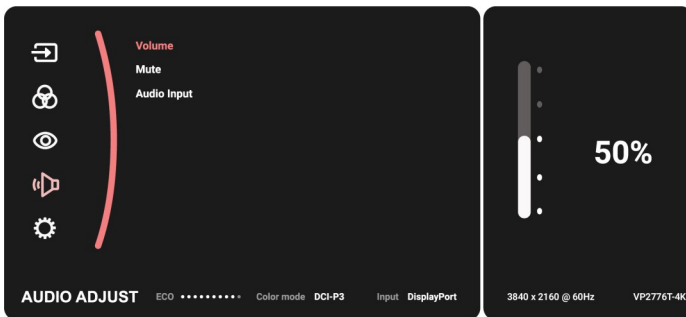

1. Move the **Joy Key** to display the Startup Menu. Then navigate to **Main Menu** and press the **Joy Key** to display the OSD Menu.
2. Move the **Joy Key** or to select **Audio Adjust**. Then press the **Joy Key** to enter the **Audio Adjust** menu.
3. Move the **Joy Key** or to select the desired option. Then press the **Joy Key** to enter its sub-menu.
4. Move the **Joy Key** or to adjust/select the setting, and press the **Joy Key** to confirm the selection (if applicable).

Menu Option	Description
Volume	Adjust the volume level.
Mute	Enable this option to temporarily turn off the sound.
Audio Input	Select the audio input source.

Setup Menu

Navigation icons: Home, Headphones, Eye, Speaker, Gear

Language Select

- Adaptive Sync
- Resolution Notice
- Information
- OSD Timeout
- OSD Background
- OSD Pivot
- Power Indicator
- ...

SETUP MENU ECO ***** Color mode DCI-P3 Input DisplayPort 3840 x 2160 @ 60Hz VP2776T-4K

English

Français

Deutsch

Español

Italiano

Suomi

...

1. Move the **Joy Key** to display the Startup Menu. Then navigate to **Main Menu** and press the **Joy Key** to display the OSD Menu.
2. Move the **Joy Key** or to select **Setup Menu**. Then press the **Joy Key** to enter the **Setup Menu** menu.
3. Move the **Joy Key** or to select the desired option. Then press the **Joy Key** to enter its sub-menu.
4. Move the **Joy Key** or to adjust/select the setting, and press the **Joy Key** to confirm the selection (if applicable).

Menu Option	Description
Language Select	Select an available language for the OSD Menu.
Resolution Notice	Enable this option to allow the system to inform users that the current viewing resolution is not the correct native resolution.
Information	Display the monitor information.
OSD Timeout	Set the length of time the OSD Menu remains on screen.
OSD Background	Show/Hide the OSD background when the OSD Menu appears on the screen.
OSD Pivot	<p>Set the OSD Menu orientation.</p> <ul style="list-style-type: none"> ▪ Auto: With the built-in G sensor, the OSD Menu can automatically pivot when the monitor is positioned vertically. ▪ ▪ 0°: Sets the OSD Menu without a pivot. ▪ ▪ +90°: Sets the OSD Menu with a +90° pivot. ▪ ▪ 90°: Sets the OSD Menu with a -90° pivot. ▪ ▪ 180°: Sets the OSD Menu with a 180° pivot. ▪
Power Indicator	Set the Power Indicator On or Off. If the setting is set to On, the power indicator lights blue when the device is turned on.
Auto Power Off	Enable this option to allow the monitor to automatically turn off after a certain amount of time.
Sleep	Set the amount of idle time before the monitor enters Sleep mode.
Multi-Picture	<p><u>Off</u></p> <div style="border: 1px dashed black; padding: 5px; text-align: center;"> <p>Disable this function.</p> </div> <p><u>PBP Left-Right</u> Display two windows, a 1x1 split screen, side-by-side on the left and right of the screen. User can specify the input source for each screen.</p> <p><u>PIP</u> Split the screen into two parts, a main window and an inset window. User can specify the input source for each screen.</p> <p><u>Dual Color</u> Display two different color settings in PIP or PBP mode.</p>
ECO Mode	Choose between various modes, based on power consumption.
Overscan	Enable this option to automatically enlarge the original picture horizontally and vertically to an equal aspect ratio that fills the screen.
Response Time	Adjust the response time, creating smooth images without streaking, blurring or ghosting. A low response time is perfect for the most graphic-intense gaming, and provides amazing visual quality while watching sports or action movies.
USB Charging	Enable/disable usb charging.
Backstage Lighting	Adjust the LED lighting.

Burn-in Eraser	Reduce image burn-in.
DDC/CI	Enable this option to allow the monitor control via the graphics card.
Rename	Rename the personalized custom profile.
All Recall	Resets all settings to their default values.

HDR (High-Dynamic-Range)

Reduces the overall contrast of a given scene so that detail in the highlights and shadows can be seen.

NOTE: Ensure the HDR setting is turned on on your device first before enabling the HDR10 on the monitor.

For example, the HDR setting on Xbox One S or PS4 Pro needs to be turned on first before enjoying your HDR10 video content.



Xbox One S



PS4 Pro

To enable the HDR function:

1. Move the **Joy Key** to display the Startup Menu. Then navigate to **Main Menu** and press the **Joy Key** to display the OSD Menu.
2. Move the **Joy Key** or to select **Color Mode**. Then press the **Joy Key** to enter the **Color Mode** menu.
3. Move the **Joy Key** or to select **HDR**. Then press the **Joy Key** to enter its sub-menu.
4. Move the **Joy Key** or to select one of the options . Then press the **Joy Key** to confirm.

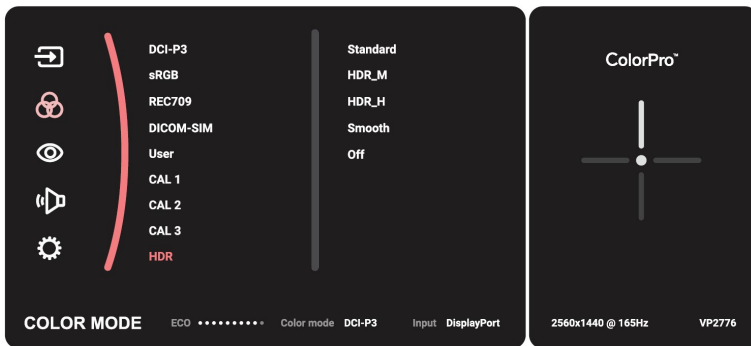

KVM

The KVM function allows the user to control two computers connected to the same monitor from a single keyboard and mouse.

NOTE: Only applicable in PBP (Picture-by-Picture) mode.

To connect the two computers to the monitor:

1. Connect one end of a Thunderbolt cable to the Thunderbolt In port of the monitor. Then connect the other end of the cable to the Thunderbolt port of the laptop.
2. Connect one end of a DisplayPort cable to the DisplayPort of the monitor. Then connect the other end of the cable to the DisplayPort or Mini DisplayPort port of the computer.
3. Connect one end of a USB Type C cable to the USB Type C port of the monitor. Then connect the other end of the cable to the USB port of the computer.

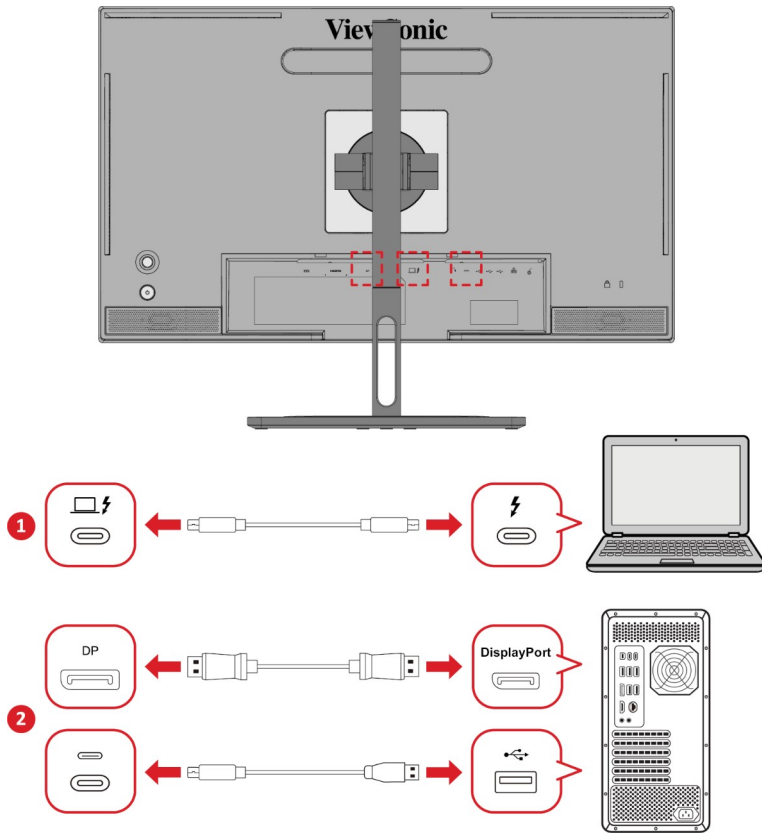

To enable PBP mode:

1. Move the **Joy Key** to display the Startup Menu. Then navigate to **Main Menu** and press the **Joy Key** to display the OSD Menu.
2. Move the **Joy Key** or to select the **Setup Menu** menu. Then press the **Joy Key** to enter the menu.
3. Move the **Joy Key** or to select **Multi-Picture**. Then press the **Joy Key** to enter its sub-menu.
4. Move the **Joy Key** or to select **PBP Left-Right**. Then press the **Joy Key** to enable PBP mode.

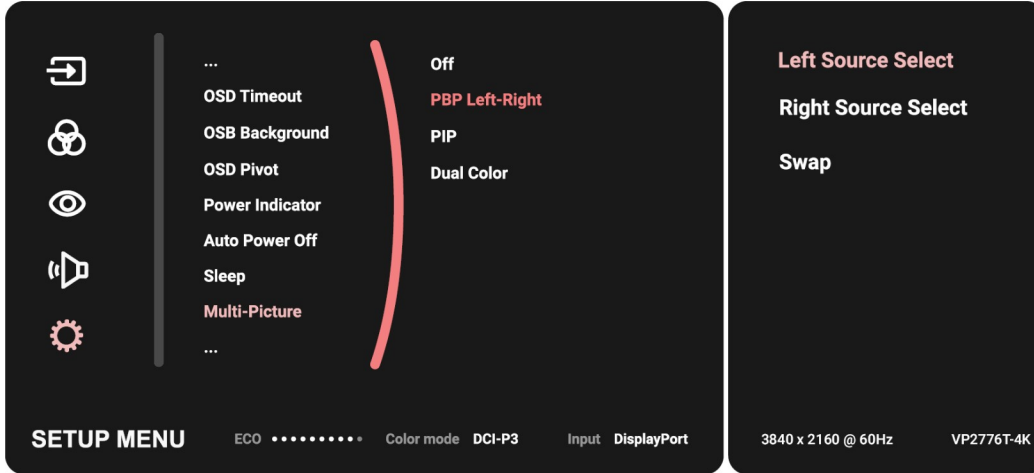

To activate the KVM function:

1. Press and hold the **Joy Key** for two seconds to activate the KVM function.
2. Then you will be able to switch the cursor between the two screens (left/right window).

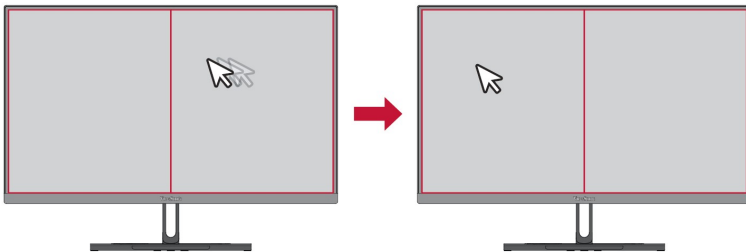

Auto Pivot

With the Auto Pivot function, the monitor can detect the image display and adjust the image's orientation on the screen automatically when pivoting the screen vertically or horizontally.

NOTE: The Auto Pivot function uses DDC/CI to communicate with the monitor. Before applying the Auto Pivot function, please make sure the DDC/CI setting is set to **On**.

To enable the DDC/CI setting:

1. Open the OSD Menu and select the **Setup Menu** menu. Then press the **Joy Key** to enter the menu.
2. Move the **Joy Key** or to select **DDC/CI**. Then press the **Joy Key** to enter its sub-menu.
3. Move the **Joy Key** or to select **On**. Then press the **Joy Key** to confirm.



After ensuring **DDC/CI** is **On**, proceed to set **OSD Pivot** to **Auto**:

1. Open the OSD Menu and select the **Setup Menu** menu. Then press the **Joy Key** to enter the menu.
2. Move the **Joy Key** or to select **OSD Pivot**. Then press the **Joy Key** to enter its sub-menu.
3. Move the **Joy Key** or to select **Auto**. Then press the **Joy Key** to confirm.

Colorbration+

To ensure long-term color accuracy, some specific models support the hardware color calibration function. The Colorbration+ application installation file can be found at our [website \(http://color.viewsonic.com/support/software/\)](http://color.viewsonic.com/support/software/).

Standard monitor packing does not include the color sensor, which the Colorbration+ application needs for the calibration process.

Compatible color sensors include:

- X-Rite i1 Display Pro
- X-Rite i1 Pro 2
- X-Rite i1 Studio
- Xrite Colormunki Photo
- Xrite Colormunki Design
- Datacolor SpyderX series

Dual Color

The monitor comes with a dual color engine to display two different color settings in PIP (Picture-in-Picture) or PBP mode. You can set different color presets in both windows (Main Window and Secondary Window).

NOTE: To enable PIP or PBP mode, refer to the **Multi-Picture** section.

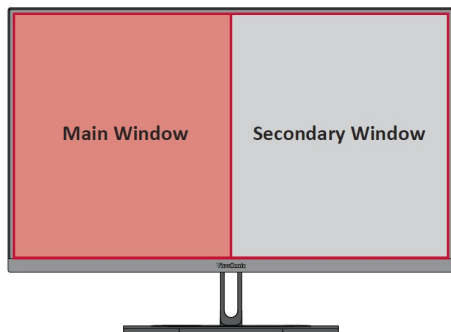

To configure Dual Color:

1. Move the **Joy Key** to display the **Startup Menu**. Then navigate to **Main Menu** and press the **Joy Key** to display the OSD Menu.
2. Move the **Joy Key** or to select the **Setup Menu** menu. Then press the **Joy Key** to enter the menu.
3. Move the **Joy Key** or to select **Multi-Picture**. Then press the **Joy Key** to enter its sub-menu.
4. Move the **Joy Key** or to select **Dual Color**. Then press the **Joy Key** to enter its sub-menu.
5. Move the **Joy Key** or to select the desired color setting. Then press the **Joy Key** to confirm.

Multi-Picture

Multi-Picture allows users to further customize their work space by allowing up to four split windows from different inputs, displaying high resolution content with different aspect ratios, without distortion from the original input sources.

To enable Multi-Picture mode:

1. Move the **Joy Key** to display the **Startup Menu**. Then navigate to **Main Menu** and press the **Joy Key** to display the OSD Menu.
2. Move the **Joy Key** or to select **Color Mode**. Then press the **Joy Key** to enter the Color Mode menu.
3. Move the **Joy Key** or to select **Multi-Picture**. Then press the **Joy Key** to enter its sub-menu.
4. Move the **Joy Key** or to select **PBP Left-Right** or **PIP**. Then press the **Joy Key** to enter the selected mode.

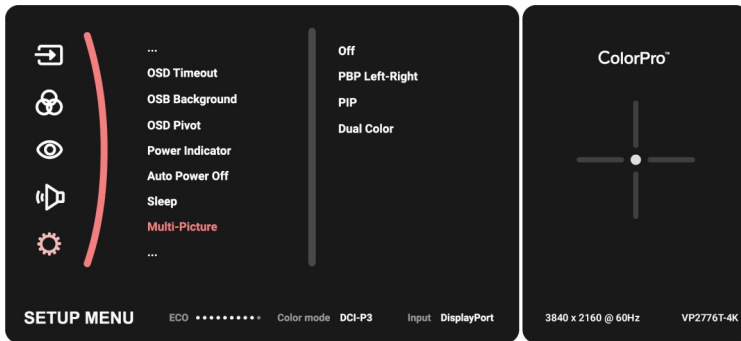

PBP (Picture-by-Picture)

NOTE: To display full-sized images in the windows, please adjust the screen resolution to 1920 x 1080 (PBP Left-Right).

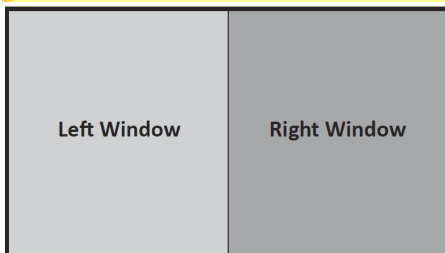

To configure PBP:

1. Move the **Joy Key** to display the **Startup Menu**. Then navigate to **Main Menu** and press the **Joy Key** to display the OSD Menu.
2. Move the **Joy Key** or to select **Setup Menu**. Then press the **Joy Key** to enter the **Setup Menu** menu.
3. Move the **Joy Key** or to select **Multi-Picture**. Then press the **Joy Key** to enter its sub-menu.
4. Move the **Joy Key** or to select **PBP Left-Right**. Then press the **Joy Key** to enter its sub-menu.
5. To change the input source, select the source location (**Left Source Select/Right Source Select**) and press the **Joy Key** .
6. Move the **Joy Key** or to select the desired input source and press the **Joy Key** to confirm.
7. To swap the two windows, select **Swap** and press the **Joy Key** to confirm.

PIP (Picture-in-Picture)

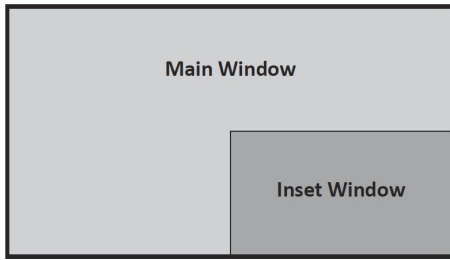

To configure PIP:

1. Move the **Joy Key** to display the **Startup Menu**. Then navigate to **Main Menu** and press the **Joy Key** to display the OSD Menu.
2. Move the **Joy Key** or to select **Setup Menu**. Then press the **Joy Key** to enter the **Setup Menu** menu.
3. Move the **Joy Key** or to select **Multi-Picture**. Then press the **Joy Key** to enter its sub-menu.
4. Move the **Joy Key** or to select **PIP**. Then press the **Joy Key** to enter its sub-menu.
5. To change the input source for the Inset Window, select **PIP Source Select** and press the **Joy Key** . Then move the **Joy Key** or to select the desired input source and press the **Joy Key** to confirm.
6. To adjust the Inset Window position, select **PIP Position** and press the **Joy Key** .
 - Press the **Joy Key** to select **PIP H.Position** or **PIP V.Position**.
 - Move the **Joy Key** or to adjust the setting and press the **Joy Key** to confirm.
7. To adjust the Inset Window size, select **PIP Size** and press the **Joy Key** . Then move the **Joy Key** or to adjust the setting.
8. To swap the two windows, select **Swap** and press the **Joy Key** to confirm.

Backstage Lighting

With the Backstage Lighting function, the monitor can adjust the LED brightness to the optimal settings.

To configure the Backstage Lighting settings:

1. Open the OSD Menu and select the **Setup Menu** menu. Then touch the **Joy Key** to enter the menu.
2. Move the **Joy Key** or to select **Backstage Lighting**. Then touch the **Joy Key** to enter its sub-menu.
3. Move the **Joy Key** or to select **Level 1**, **Level 2**, or **Level 3** to enable the function. Then touch the **Joy Key** to confirm.

Firmware Update

For the best display performance and to resolve any known issues, it is best to keep your monitor updated with the latest firmware version. With the supplied USB cable and the vDisplayManager application, you can easily update your monitor's firmware.

To update the firmware:

1. Download and install the vDisplayManager application from our [website \(https://color.viewsonic.com/support/software/\)](https://color.viewsonic.com/support/software/).
2. Connect the USB Type B male cable (square with 2 cut corners) to the USB Type B port of your monitor. Then connect the other end of the cable to the USB port of the computer.
3. Launch vDisplayManager. Select the **Advanced** tab in the side menu.
4. Click **Update** to check for any updates to your monitor's firmware.
5. Wait until the update process is complete (if applicable).

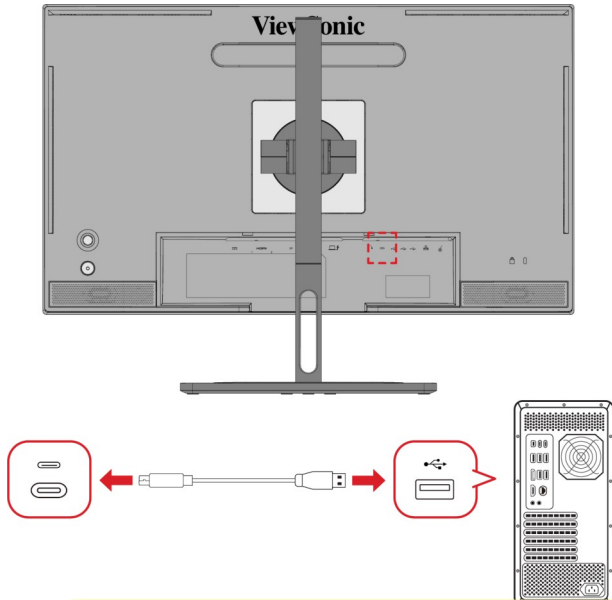

NOTE: Any interruptions during the firmware update process may permanently damage your monitor. Do not disconnect the USB cable or turn off your PC and monitor.

Technical Specifications

Item	Category	Specifications
LCD	Type	IPS type, a-si TFT Active Matrix 3840 x 2160 LCD, 0.1554 (H) mm x 0.1554 (V) mm pixel pitch
	Display Size	68.47 cm (27" viewable)
	Color Filter	RGB vertical stripe
	Glass Surface	Anti-Glare (Haze 25%), Hard Coating (3H)
Input Signal	Video Sync	<p>TMDs digital (100 Ω)</p> <p>HDMI (v. 2.0): f_h:15-240 kHz, f_v:24-75 Hz</p> <p>DisplayPort (v. 1.4a): f_h:15-240 kHz, f_v:24-75 Hz</p> <p>Type C: f_h:15-240 kHz, f_v:24-75 Hz</p>
Compatibility	PC	up to 3840 x 2160
	Macintosh	up to 3840 x 2160
Resolution ^[1]	Recommended	3840 x 2160 @ 60Hz
	Supported	<ul style="list-style-type: none"> ▪ 4096 x 2160 @ 24, 25, 30, 50, 60Hz ▪ 3840 x 2160 @ 24, 25, 30, 60Hz ▪ 3840 x 1080 @ 60Hz ▪ 2560 x 1440 @ 60Hz ▪ 2048 x 1152 @ 60Hz ▪ 1920 x 1440 @ 60Hz ▪ 1920 x 1200 @ 60Hz ▪ 1920 x 1080 @ 50, 60Hz ▪ 1680 x 1050 @ 60Hz ▪ 1600 x 1200 @ 60Hz ▪ 1600 x 900 @ 60Hz ▪ 1440 x 900 @ 60, 75Hz ▪ 1400 x 1050 @ 60, 75Hz ▪ 1366 x 768 @ 60Hz ▪ 1360 x 768 @ 60Hz ▪ 1280 x 1024 @ 50, 60, 75Hz ▪ 1280 x 960 @ 50, 60, 75Hz ▪ 1280 x 800 @ 60Hz ▪ 1280 x 768 @ 50, 60Hz ▪ 1280 x 720 @ 50, 60Hz ▪ 1152 x 900 @ 67Hz ▪ 1152 x 864 @ 75Hz ▪ 1024 x 768 @ 50, 60, 70, 72, 75Hz ▪ 848 x 480 @ 60Hz ▪ 800 x 600 @ 56, 60, 72Hz ▪ 720 x 576 @ 50Hz ▪ 720 x 480 @ 60Hz ▪ 720 x 400 @ 70Hz ▪ 640 x 480 @ 50, 60, 67, 72Hz ▪ 640 x 400 @ 60, 70Hz ▪ 640 x 350 @ 70Hz
Power ^[2]	Input Voltage	AC 100-240V, 50/60Hz (auto switch)
Display Area	Full Scan (H x V)	596.74 x 335.66 mm (23.49" x 13.21")
Operating Conditions	Temperature	0° C to 40° C (32° F to 104° F)
	Humidity	20% to 90% (non-condensing)
	Altitude	3.048 km (10,000 ft)

Storage Conditions	Temperature	-20° C to 60° C (-4° F to 140° F)
	Humidity	5% to 90% (non-condensing)
	Altitude	12 km (9,370.1 ft)
Dimensions	Physical (W x H x D)	613.10 x 569.11~449.11 x 232.4 mm (24.14" x 22.41~17.68" x 9.15")
Wall Mount	Dimensions	100 x 100 mm
Weight	Physical	8.23 kg (18.15 lbs)
Power Saving Modes	On ^[3]	45W (Typical) without Audio 74W (Max) with Audio
	Off	< 0.3W (Max)

1. Do not set the graphics card in your computer to exceed these timing modes; doing so may result in permanent damage to the display.
2. Please use the power adapter from ViewSonic® or an authorized source only.
3. The test condition follows EEI standards.



The terms HDMI, HDMI High-Definition Multimedia Interface, HDMI trade dress and the HDMI Logos are trademarks or registered trademarks of HDMI Licensing Administrator, Inc.

Compliance Information

This section addresses all connected requirements and statements regarding regulations. Confirmed corresponding applications shall refer to nameplate labels and relevant markings on the unit.

FCC Compliance Statement

This device complies with part 15 of FCC Rules. Operation is subject to the following two conditions: (1) this device may not cause harmful interference, and (2) this device must accept any interference received, including interference that may cause undesired operation. This equipment has been tested and found to comply with the limits for a Class B digital device, pursuant to part 15 of the FCC Rules.

These limits are designed to provide reasonable protection against harmful interference in a residential installation. This equipment generates, uses, and can radiate radio frequency energy, and if not installed and used in accordance with the instructions, may cause harmful interference to radio communications. However, there is no guarantee that interference will not occur in a particular installation. If this equipment does cause harmful interference to radio or television reception, which can be determined by turning the equipment off and on, the user is encouraged to try to correct the interference by one or more of the following measures:

- Reorient or relocate the receiving antenna.
- Increase the separation between the equipment and receiver.
- Connect the equipment into an outlet on a circuit different from that to which the receiver is connected.
- Consult the dealer or an experienced radio/TV technician for help.

Warning: You are cautioned that changes or modifications not expressly approved by the party responsible for compliance could void your authority to operate the equipment.

Industry Canada Statement

CAN ICES(B) / NMB(B)

CE Conformity for European Countries



The device complies with the EMC Directive 2014/30/EU and Low Voltage Directive 2014/35/EU.

The following information is only for EU-member states:

The mark shown to the right is in compliance with the Waste Electrical and Electronic Equipment Directive 2012/19/EU (WEEE). The mark indicates the requirement NOT to dispose of the equipment as unsorted municipal waste, but use the return and collection systems according to local law.



Declaration of RoHS2 Compliance

This product has been designed and manufactured in compliance with Directive 2011/65/EU of the European Parliament and the Council on restriction of the use of certain hazardous substances in electrical and electronic equipment (RoHS2 Directive) and is deemed to comply with the maximum concentration values issued by the European Technical Adaptation Committee (TAC) as shown below:

Substance	Proposed Maximum Concentration	Actual Concentration
Lead (Pb)	0.1%	< 0.1%
Mercury (Hg)	0.1%	< 0.1%
Cadmium (Cd)	0.01%	< 0.01%
Hexavalent Chromium (Cr6 ⁺)	0.1%	< 0.1%
Polybrominated biphenyls (PBB)	0.1%	< 0.1%
Polybrominated diphenyl ethers (PBDE)	0.1%	< 0.1%
Bis (2-ethylhexyl) phthalate (DEHP)	0.1%	< 0.1%
Butyl benzyl phthalate (BBP)	0.1%	< 0.1%
Dibutyl phthalate (DBP)	0.1%	< 0.1%
Diisobutyl phthalate (DIBP)	0.1%	< 0.1%

Certain components of products as stated above are exempted under the Annex III of the RoHS2 Directives as noted below. Examples of exempted components are:

- Copper alloy containing up to 4% lead by weight.
- Lead in high melting temperature type solders (i.e. lead-based alloys containing 85% by weight or more lead).
- Electrical and electronic components containing lead in a glass or ceramic other than dielectric ceramic in capacitors, e.g. piezoelectronic devices, or in a glass or ceramic matrix compound.
- Lead in dielectric ceramic in capacitors for a rated voltage of 125V AC or 250V DC or higher.

Indian Restriction of Hazardous Substances

Restriction on Hazardous Substances statement (India). This product complies with the “India E-waste Rule 2011” and prohibits use of lead, mercury, hexavalent chromium, polybrominated biphenyls or polybrominated diphenyl ethers in concentrations exceeding 0.1 weight % and 0.01 weight % for cadmium, except for the exemptions set in Schedule 2 of the Rule.

Product Disposal at End of Product Life

ViewSonic® respects the environment and is committed to working and living green. Thank you for being part of Smarter, Greener Computing. Please visit the ViewSonic® website to learn more.

USA & Canada

<https://www.viewsonic.com/us/go-green-with-viewsonic> < <https://www.viewsonic.com/us/go-green-with-viewsonic>>

Europe

<https://www.viewsonic.com/eu/environmental-social-governance/recycle> < <https://www.viewsonic.com/eu/environmental-social-governance/recycle>>

Taiwan

<https://recycle.moenv.gov.tw> < <https://recycle.moenv.gov.tw>>

For EU users, please contact us for any safety/accident issue experienced with this product:

ViewSonic Europe Limited
Haaksbergweg 75
1101 BR Amsterdam
Netherlands
+31 (0) 650608655
EPREL@viewsoniceurope.com
<https://www.viewsonic.com/eu/> < <https://www.viewsonic.com/eu/> >

Copyright Information

Copyright© ViewSonic® Corporation, 2024. All rights reserved.

Macintosh and Power Macintosh are registered trademarks of Apple Inc.

Microsoft, Windows, and the Windows logo are registered trademarks of Microsoft Corporation in the United States and other countries.

ViewSonic® and the three birds logo are registered trademarks of ViewSonic® Corporation.

VESA is a registered trademark of the Video Electronics Standards Association. DPMS, DisplayPort, and DDC are trademarks of VESA.

ENERGY STAR® is a registered trademark of the U.S. Environmental Protection Agency (EPA).

As an ENERGY STAR® partner, ViewSonic® Corporation has determined that this product meets the ENERGY STAR® guidelines for energy efficiency.

Disclaimer: ViewSonic® Corporation shall not be liable for technical or editorial errors or omissions contained herein; nor for incidental or consequential damages resulting from furnishing this material, or the performance or use of this product.

In the interest of continuing product improvement, ViewSonic® Corporation reserves the right to change product specifications without notice. Information in this document may change without notice.

No part of this document may be copied, reproduced, or transmitted by any means, for any purpose without prior written permission from ViewSonic® Corporation.

VP2776T-4K_UG_ENG_1a_20240430

Customer Service Contact Information

For technical support or product service, see the table below or contact your reseller.

You will need the product's serial number

Asia Pacific & Africa

Country / Region	Website
Australia	https://viewsonic.com/au/ < https://viewsonic.com/au/ >
Bangladesh	https://www.viewsonic.com/bd/ < https://www.viewsonic.com/bd/ >
中国(China)	https://www.viewsonic.com.cn < https://www.viewsonic.com.cn >
香港 (繁體中文)	https://www.viewsonic.com/hk/ < https://www.viewsonic.com/hk/ >
Hong Kong (English)	https://www.viewsonic.com/hk-en/ < https://www.viewsonic.com/hk-en/ >
India	https://www.viewsonic.com/in/ < https://www.viewsonic.com/in/ >
Indonesia	https://www.viewsonic.com/id/ < https://www.viewsonic.com/id/ >
Israel	https://www.viewsonic.com/il/ < https://www.viewsonic.com/il/ >
日本 (Japan)	https://www.viewsonic.com/jp/ < https://www.viewsonic.com/jp/ >
Korea	https://www.viewsonic.com/kr/ < https://www.viewsonic.com/kr/ >
Malaysia	https://www.viewsonic.com/my/ < https://www.viewsonic.com/my/ >
Middle East	https://www.viewsonic.com/me/ < https://www.viewsonic.com/me/ >
Myanmar	https://www.viewsonic.com/mm/ < https://www.viewsonic.com/mm/ >
Nepal	https://www.viewsonic.com/np/ < https://www.viewsonic.com/np/ >
New Zealand	https://www.viewsonic.com/nz/ < https://www.viewsonic.com/nz/ >
Pakistan	https://www.viewsonic.com/pk/ < https://www.viewsonic.com/pk/ >
Philippines	https://www.viewsonic.com/ph/ < https://www.viewsonic.com/ph/ >
Singapore	https://www.viewsonic.com/sg/ < https://www.viewsonic.com/sg/ >
臺灣 (Taiwan)	https://www.viewsonic.com/tw/ < https://www.viewsonic.com/tw/ >
ประเทศไทย (Thailand)	https://www.viewsonic.com/th/ < https://www.viewsonic.com/th/ >
Việt Nam	https://www.viewsonic.com/vn/ < https://www.viewsonic.com/vn/ >
South Africa & Mauritius	https://www.viewsonic.com/za/ < https://www.viewsonic.com/za/ >

Americas

Country / Region	Website
United States	https://www.viewsonic.com/us/ < https://www.viewsonic.com/us/ >
Canada	https://www.viewsonic.com/us/ < https://www.viewsonic.com/us/ >
Latin America	https://www.viewsonic.com/la/ < https://www.viewsonic.com/la/ >

Europe

Country / Region	Website
Europe	https://www.viewsonic.com/eu/ < https://www.viewsonic.com/eu/ >
France	https://www.viewsonic.com/fr/ < https://www.viewsonic.com/fr/ >
Deutschland	https://www.viewsonic.com/de/ < https://www.viewsonic.com/de/ >
Қазақстан	https://www.viewsonic.com/kz/ < https://www.viewsonic.com/kz/ >
Россия	https://www.viewsonic.com/ru/ < https://www.viewsonic.com/ru/ >
España	https://www.viewsonic.com/es/ < https://www.viewsonic.com/es/ >
Türkiye	https://www.viewsonic.com/tr/ < https://www.viewsonic.com/tr/ >
Україна	https://www.viewsonic.com/ua/ < https://www.viewsonic.com/ua/ >
United Kingdom	https://www.viewsonic.com/uk/ < https://www.viewsonic.com/uk/ >

Limited Warranty

ViewSonic® Display

What the warranty covers:

ViewSonic® warrants its products to be free from defects in material and workmanship during the warranty period. If a product proves to be defective in material or workmanship during the warranty period, ViewSonic® will, at its sole option, and as your sole remedy, repair or replace the product with a similar product. Replacement Product or parts may include remanufactured or refurbished parts or components. The repair or replacement unit or parts or components will be covered by the balance of the time remaining on the customer's original limited warranty and the warranty period will not be extended. ViewSonic® provides no warranty for any third-party software whether included with the product or installed by the customer, installation of any unauthorized hardware parts or components (e.g. Projector Lamps). (Please refer to: "What the warranty excludes and does not cover" section).

How long the warranty is effective:

ViewSonic® displays are warranted for between 1 and 3 years, depending on your country of purchase, for all parts including the light source and for all labor from the date of the first consumer purchase.

Who the warranty protects:

This warranty is valid only for the first consumer purchaser.

What the warranty excludes and does not cover:

- Any product on which the serial number has been defaced, modified, or removed.
- Damage, deterioration, or malfunction resulting from:
 - Accident, misuse, neglect, fire, water, lightning, or other acts of nature, unauthorized product modification, or failure to follow instructions supplied with the product.
 - Repair or attempted repair by anyone not authorized by ViewSonic®.
 - Damage to or loss of any programs, data, or removable storage media.
 - Normal wear and tear.
 - Removal or installation of the product.
- Software or data loss occurring during repair or replacement.
- Any damage of the product due to shipment.
- Causes external to the product, such as electric power fluctuations or failure.
- Use of supplies or parts not meeting ViewSonic's specifications.
- Failure of owner to perform periodic product maintenance as stated in the User Guide.
- Any other cause which does not relate to a product defect.
- Damage caused by static (non-moving) images displayed for lengthy periods of time (also referred to as image burn-in).
- Software - Any third-party software included with the product or installed by the customer.
- Hardware/Accessories/Parts/Components – Installation of any unauthorized hardware, accessories, consumable parts or components (e.g. Projector Lamps).
- Damage to, or abuse of, the coating on the surface of the display through inappropriate cleaning as described in the product User Guide.
- Removal, installation, and set-up service charges, including wall-mounting of the product.

How to get service:

- For information about receiving service under warranty, contact ViewSonic® Customer Support (Please refer to the “Customer Service” page). You will need to provide your product’s serial number.
- To obtain warranty service, you will be required to provide: (a) the original dated sales slip, (b) your name, (c) your address, (d) a description of the problem, and (e) the serial number of the product.
- Take or ship the product, freight prepaid, in the original container to an authorized ViewSonic® service center or ViewSonic®.
- For additional information or the name of the nearest ViewSonic® service center, contact ViewSonic®.

Limitation of implied warranties:

There are no warranties, express or implied, which extend beyond the description contained herein including the implied warranty of merchantability and fitness for a particular purpose.

Exclusion of damages:

ViewSonic’s liability is limited to the cost of repair or replacement of the product. ViewSonic® shall not be liable for:

- Damage to other property caused by any defects in the product, damages based upon inconvenience, loss of use of the product, loss of time, loss of profits, loss of business opportunity, loss of goodwill, interference with business relationships, or other commercial loss, even if advised of the possibility of such damages.
- Any other damages, whether incidental, consequential or otherwise.
- Any claim against the customer by any other party.
- Repair or attempted repair by anyone not authorized by ViewSonic®.

Effect of state law:

This warranty gives you specific legal rights, and you may also have other rights which vary from state to state. Some states do not allow limitations on implied warranties and/or do not allow the exclusion of incidental or consequential damages, so the above limitations and exclusions may not apply to you.

Sales outside the U.S.A. and Canada:

For warranty information and service on ViewSonic® products sold outside of the U.S.A. and Canada, contact ViewSonic® or your local ViewSonic® dealer. The warranty period for this product in mainland China (Hong Kong, Macao, and Taiwan Excluded) is subject to the terms and conditions of the Maintenance Guarantee Card. For users in Europe and Russia, full details of warranty provided can be found at: **ViewSonic EU (<http://www.viewsonic.com/eu/>)** under “Support/Warranty Information”.

Mexico Limited Warranty

ViewSonic® Display

What the warranty covers:

ViewSonic® warrants its products to be free from defects in material and workmanship, under normal use, during the warranty period. If a product proves to be defective in material or workmanship during the warranty period, ViewSonic® will, at its sole option, repair or replace the product with a like product. Replacement product or parts may include remanufactured or refurbished parts or components & accessories.

How long the warranty is effective:

ViewSonic® LCD displays are warranted for between 1 and 3 years, depending on your country of purchase, for all parts including the light source and for all labour from the date of the first consumer purchase.

Who the warranty protects:

This warranty is valid only for the first consumer purchaser.

What the warranty excludes and does not cover:

- Any product on which the serial number has been defaced, modified, or removed.
- Damage, deterioration, or malfunction resulting from:
 - Accident, misuse, neglect, fire, water, lightning, or other acts of nature, unauthorized product modification, or failure to follow instructions supplied with the product.
 - Causes external to the product, such as electrical power fluctuations or failure.
 - Use of supplies or parts not meeting ViewSonic®'s specifications.
 - Normal wear and tear.
 - Removal or installation of the product.

How to get service:

- For information about receiving service under warranty, contact ViewSonic® Customer Support (Please refer to the "Customer Service" page). You will need to provide your product's serial number, so please record the product information in the space provided below on your purchase for your future use. Please retain your receipt of proof of purchase to support your warranty claim.
- To obtain warranty service, you will be required to provide: (a) the original dated sales slip, (b) your name, (c) your address, (d) a description of the problem, and (e) the serial number of the product.
- Take or ship the product, freight prepaid, in the original container to an authorized ViewSonic® service center.
- Round trip transportation costs for in-warranty products will be paid by ViewSonic®.

Limitation of implied warranties:

There are no warranties, express or implied, which extend beyond the description contained herein including the implied warranty of merchantability and fitness for a particular purpose.

Exclusion of damages:

ViewSonic®'s liability is limited to the cost of repair or replacement of the product. ViewSonic® shall not be liable for:

- Damage to other property caused by any defects in the product, damages based upon inconvenience, loss of use of the product, loss of time, loss of profits, loss of business opportunity, loss of goodwill, interference with business relationships, or other commercial loss, even if advised of the possibility of such damages.
- Any other damages, whether incidental, consequential or otherwise.
- Any claim against the customer by any other party.
- Repair or attempted repair by anyone not authorized by ViewSonic®.

**Contact Information for Sales & Authorized Service (Centro Autorizado de Servicio)
within Mexico:**

Name, address, of manufacturer and importers:
México, Av. de la Palma #8 Piso 2 Despacho 203, Corporativo Interpalmas,
Col. San Fernando Huixquilucan, Estado de México
Tel: (55) 3605-1099 <http://www.viewsonic.com/la/soporte/index.htm> <
<http://www.viewsonic.com/la/soporte/index.htm>>

NÚMERO GRATIS DE ASISTENCIA TÉCNICA PARA TODO MÉXICO: 001.866.823.2004

Hermosillo:

Distribuciones y Servicios
Computacionales SA de CV.
Calle Juarez 284 local 2
Col. Bugambillas C.P: 83140
Tel: 01-66-22-14-9005
E-Mail:
disc2@hmo.megared.net.mx
(<mailto:disc2@hmo.megared.net.mx>)

Villahermosa:

Compumantenimientos Garantizados, S.A.
de C.V.
AV. GREGORIO MENDEZ #1504
COL, FLORIDA C.P. 86040
Tel: 01 (993) 3 52 00 47 / 3522074 / 3 52
20 09
E-Mail:
compumantenimientos@prodigy.net.mx
(<mailto:compumantenimientos@prodigy.net.mx>)

Puebla, Pue. (Matriz):

RENTA Y DATOS, S.A. DE C.V.
Domicilio:
29 SUR 721 COL. LA PAZ
72160 PUEBLA, PUE.
Tel: 01(52).222.891.55.77 CON
10 LINEAS
E-Mail:
datos@puebla.megared.net.mx
(<mailto:datos@puebla.megared.net.mx>)

Veracruz, Ver.:

CONEXION Y DESARROLLO, S.A DE
C.V. Av.
Americas # 419
ENTRE PINZÓN Y ALVARADO
Fracc. Reforma C.P. 91919
Tel: 01-22-91-00-31-67
E-Mail: gacosta@qplus.com.mx (<mailto:gacosta@qplus.com.mx>)

Chihuahua:

Soluciones Globales en
Computación
C. Magisterio # 3321 Col.
Magisterial
Chihuahua, Chih.
Tel: 4136954
E-Mail:
Cefeo@soluglobales.com (<mailto:Cefeo@soluglobales.com>)

Cuernavaca:

Compusupport de Cuernavaca SA de CV
Francisco Leyva # 178 Col. Miguel Hidalgo
C.P. 62040, Cuernavaca Morelos
Tel: 01 777 3180579 / 01 777 3124014
E-Mail:
aquevedo@compusupportcva.com (<mailto:aquevedo@compusupportcva.com>)

Distrito Federal:

QPLUS, S.A. de C.V.
Av. Coyoacán 931
Col. Del Valle 03100, México,
D.F.
Tel: 01(52)55-50-00-27-35
E-Mail :
gacosta@qplus.com.mx (<mailto:gacosta@qplus.com.mx>)

Guadalajara, Jal.:

SERVICRECE, S.A. de C.V.
Av. Niños Héroes # 2281
Col. Arcos Sur, Sector Juárez
44170, Guadalajara, Jalisco
Tel: 01(52)33-36-15-15-43
E-Mail: mmiranda@servicrece.com (<mailto:mmiranda@servicrece.com>)

Guerrero Acapulco:

GS Computación (Grupo
Sesicomp)

Monterrey:

Global Product Services
Mar Caribe # 1987, Esquina con Golfo

<p>Progreso #6-A, Colo Centro 39300 Acapulco, Guerrero Tel: 744-48-32627</p>	<p>Pérsico Fracc. Bernardo Reyes, CP 64280 Monterrey N.L. México Tel: 8129-5103 E-Mail: aydeem@gps1.com.mx (mailto:aydeem@gps1.com.mx)</p>
<p>MÉRIDA: ELECTROSER Av Reforma No. 403Gx39 y 41 Mérida, Yucatán, México CP97000 Tel: (52) 999-925-1916 E-Mail: rrrb@sureste.com (mailto:rrrb@sureste.com)</p>	<p>Oaxaca, Oax.: CENTRO DE DISTRIBUCION Y SERVICIO, S.A. de C.V. Murguía # 708 P.A., Col. Centro, 68000, Oaxaca Tel: 01(52)95-15-15-22-22 Fax: 01(52)95-15-13-67-00 E-Mail: gpotai2001@hotmail.com (mailto:gpotai2001@hotmail.com)</p>
<p>Tijuana: STD Av Ferrocarril Sonora #3780 L-C Col 20 de Noviembr Tijuana, Mexico</p>	<p>FOR USA SUPPORT: ViewSonic® Corporation 381 Brea Canyon Road, Walnut, CA. 91789 USA Tel: 800-688-6688 http://www.viewsonic.com < http://www.viewsonic.com></p>

Using the Monitor Safely

Please read these instructions completely before using the equipment.

- Keep this user guide in a safe place for later reference.
- Read all warnings and follow all instructions.
- Sit at least 18" (45 cm) away from the device.
- Allow at least 4" (10 cm) clearance around the device to ensure proper ventilation.
- Place the device in a well-ventilated area. Do not place anything on the device that prevents heat dissipation.
- Do not use the device near water. To reduce the risk of fire or electric shock, do not expose the device to moisture.
- Avoid exposing the device to direct sunlight or other sources of sustained heat.
- Do not install near any heat sources such as radiators, heat registers, stoves, or other devices (including amplifiers) that may increase the temperature of the device to dangerous levels.
- Use a soft, dry cloth to clean the external housing. For more information, refer to the "Maintenance" section of this manual.
- Avoid touching the screen, as oil may collect on the screen if you touch it.
- Do not touch the screen surface with sharp or hard objects, as it may cause damage to the screen.
- Do not place the device on cloth or other materials that may be placed between the product and supporting furniture.
- When moving the device, be careful not to drop or bump the device on anything.
- Do not place the device on an uneven or unstable surface. The device may fall over resulting in an injury or a malfunction.
- Do not place any heavy objects on the device or connection cables.
- Always use cabinets, stands, or installation methods recommended by the manufacturer of the device set.
- Always use furniture that can safely support the device.
- Always ensure the device is not overhanging the edge of the supporting furniture.
- Do not place the device on tall furniture, such as cupboards or bookcases, without anchoring both the furniture and the device to a suitable support.
- Always educate children about the dangers of climbing on furniture to reach the device or related equipment.
- Do not place the monitor where children are likely to be present.
- Do not place items that might tempt children to climb, such as toys and remote controls, on the top of the device or furniture on which the product is placed.
- If smoke, an abnormal noise, or a strange odor is present, immediately turn the device off and call your dealer or ViewSonic®. It is dangerous to continue using the device.
- Do not attempt to circumvent the safety provisions of the polarized or grounding-type plug. A polarized plug has two blades with one wider than the other. A grounding-type plug has two blades and a third grounding prong. The wide blade and the third prong are provided for your safety. If the plug does not fit into your outlet, obtain an adapter and do not attempt to force the plug into the outlet.
- When connecting to a power outlet, Do not remove the grounding prong. Please ensure grounding prongs are never removed.
- Always route and manage cords and cables connected to your device so they cannot be tripped over, pulled, or grabbed.
- Protect the power cord from being treaded upon or pinched, particularly at the plug, and at the point where it emerges from the equipment. Ensure that the power outlet is located near the equipment so that it is easily accessible.
- Disconnect the power plug from the power outlet if the device is not being used for a long period of time.
- Please confirm the distribution system installed in the building. The system should provide a circuit breaker rated at 120/240V, 20A.
- Only use attachments/accessories, such as carts, stands, tripods, brackets or tables, specified by the manufacturer.
- When a cart is used, use with caution when moving the cart/equipment combination to avoid injury from tipping over.
- Refer all servicing to qualified service personnel. Service will be required when the unit has been damaged in any way, such as:
 - if the power-supply cord or plug is damaged.
 - if liquid is spilled onto or objects fall into the unit.
 - if the unit is exposed to rain or moisture.
 - if the unit does not operate normally or has been dropped.
- When using ear-/headphones, adjust the volume to appropriate levels, or hearing damage may result.
- Stability Hazard: The display may fall, causing serious personal injury or death. To prevent injury, this display must be securely attached to the floor/wall in accordance with the installation instructions.
- Fastening the display to a wall or fixed object using cordage or other restraining devices can help support the weight of the display in order to prevent the display from falling over.

Hole Pattern (W x H)	Interface Pad (W x H x D)	Pad Hole	Screw Specification & Quantity
100 x 100 mm	115 x 115 x 2.6 mm	Ø 5 mm	M4 x 10 mm - 4 pieces

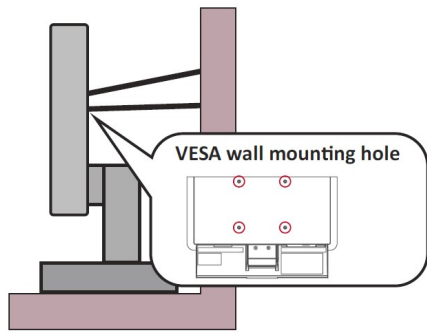

NOTE:

- Restraining device/cordage should be able to withstand 100N force.
 - Make sure the cordage is straightened, and any slack is removed. The back of the device shall face the wall to ensure the device cannot tilt under external force.
 - Make sure the display does not tilt under external force at any height and rotation angle of the device.
- If the existing display is going to be retained and relocated, the same considerations as above should be applied.

Glossary of Terms

NOTE: Some terms may not be applicable to your device.

ABCFGHILMOPRSTUVY1

Advanced DCR

Advanced DCR technology automatically detects the image signal and intelligently controls the backlight brightness and color to improve on the ability to make the black blacker in a dark scene, and make the white whiter in a bright environment.

Advanced Gamma

Allows the user to manually adjust the brightness level of the monitor’s grayscale levels. There are five selections: 1.8, 2.0, 2.2, 2.4, and 2.6.

Advanced Sharpness

Adjusts the picture quality of the monitor, with a range of 0 to 100.

All Recall

Returns the adjustments back to factory settings if the display is operating in a factory Preset Timing Mode listed in the Specifications of this manual.

Audio Adjust

Adjusts the volume, mutes the sound, or toggles between inputs if you have more than one source.

Auto Detect

If the current input source has no signal, the monitor will automatically switch to the next input option. This function can be enabled or disabled by default.

Troubleshooting Common Problems

Why is there no power?	▼
Why is there no image on screen?	▼
What should I do if the colors are wrong or abnormal?	▼
How do I adjust the screen when it is too bright or dark?	▼
What should I do if the screen image cuts in and out?	▼
The screen image is blurry, now what?	▼
How to center the screen properly?	▼
Why does the screen look yellow?	▼
Why can't I see the OSD Menu? And why aren't the controls accessible?	▼
What should I do if the Control Panel Keys aren't working?	▼
Why are some menus not selectable in the OSD Menu?	▼
Why is there no audio output?	▼
Why won't the connected USB devices work?	▼

Maintaining the Monitor

General Precautions

- Make sure the monitor is turned off and the power cable is unplugged from the power outlet.
- Never spray or pour any liquid directly onto the screen or case.
- Handle the monitor with care, as a darker-colored monitor, if scuffed, may show marks more clearly than a lighter-colored monitor.

Cleaning the Screen

- Wipe the screen with a clean, soft, lint-free cloth. This removes dust and other particles.
- If the screen is still not clean, apply a small amount of non-ammonia, non-alcohol based glass cleaner onto a clean, soft, lint-free cloth; then wipe the screen.

Cleaning the Case

- Use a soft, dry cloth.
- If the case is still not clean, apply a small amount of non-ammonia, non-alcohol based, mild non-abrasive detergent onto a clean, soft, lint-free cloth, then wipe the surface.

Disclaimer

- ViewSonic® does not recommend the use of any ammonia or alcohol-based cleaners on the display screen or case. Some chemical cleaners have been reported to damage the screen and/or case of the monitor.
- ViewSonic® will not be liable for damage resulting from use of any ammonia or alcohol-based cleaners.

Retrieved from "https://manuals.viewsonic.com/index.php?title=VP2776T-4K_Full_Guide&oldid=41875 < https://manuals.viewsonic.com/index.php?title=VP2776T-4K_Full_Guide&oldid=41875> "