

G715 KEYBOARD | CLAVIER G715

Wireless Gaming Keyboard
Clavier gaming sans fil

SETUP GUIDE | GUIDE D'INSTALLATION





ENGLISH 3

FRANÇAIS 10

ESPAÑOL 17

PORTUGUÊS 24

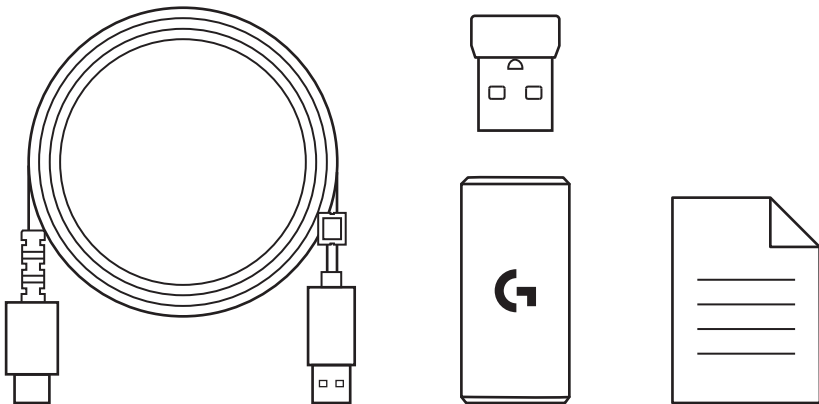
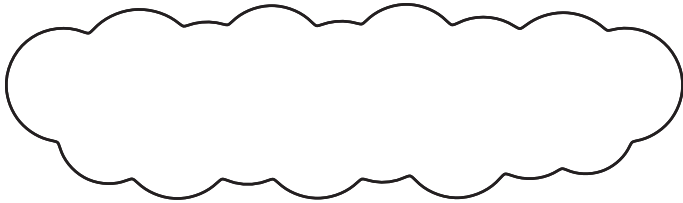
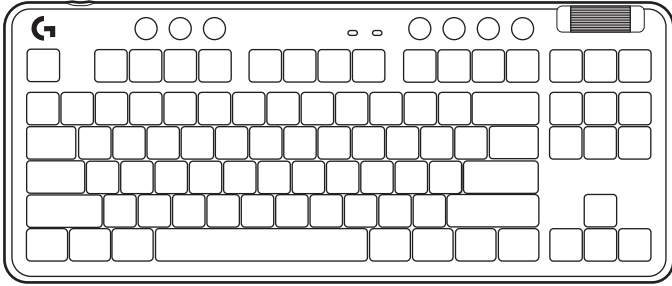

SETUP INSTRUCTIONS

1 Remove the LIGHTSPEED receiver from the storage slot.

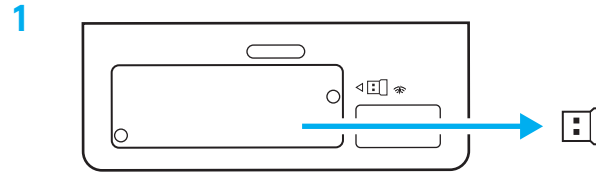

2 Insert the LIGHTSPEED receiver, with extender and cable into the PC USB port. Receiver can be used without the extender and cable by inserting it directly into a USB port if desired.

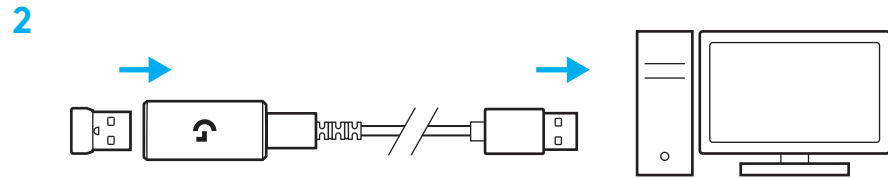

3 Turn on the keyboard by sliding the power button.
The Connection button will light up to a cyan color.

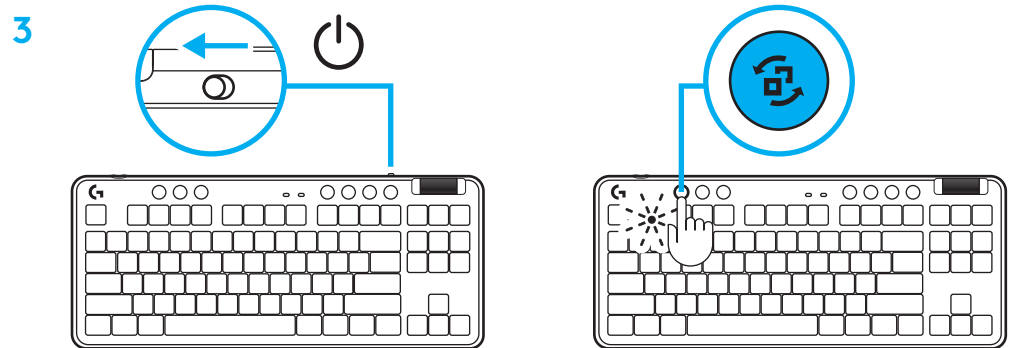

4 Download and install G HUB software to your PC/MAC for the best gaming experience (G HUB has onboarding story for features).
Go to **www.logitechG.com/ghub**



BLUETOOTH® CONNECTIVITY

1 Turn on the keyboard by sliding the button.

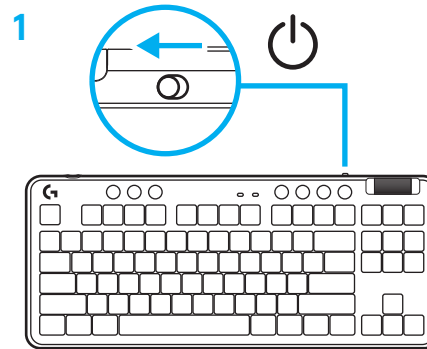

2 Press Connection button to cycle to *Bluetooth*®. Light will turn to light blue and flash quickly - waiting to pair.

Follow *Bluetooth*® connection for your device to pair with the keyboard.

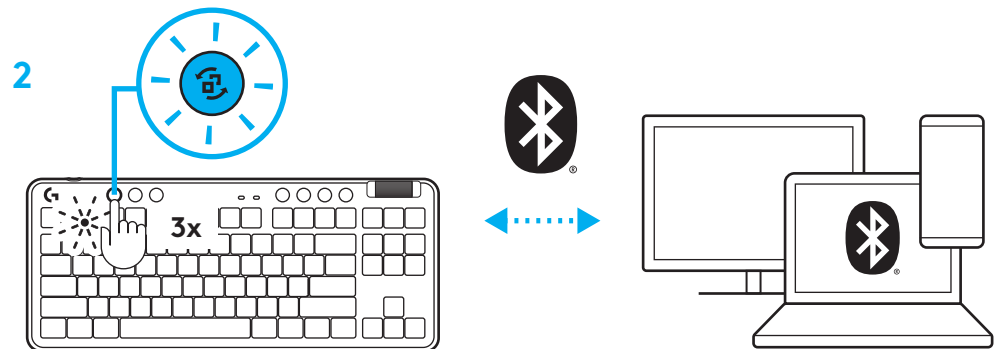

CHARGING YOUR KEYBOARD

- 1 Insert the USB-C cable into the port at the front of the keyboard.
- 2 Connect the cable to your PC.

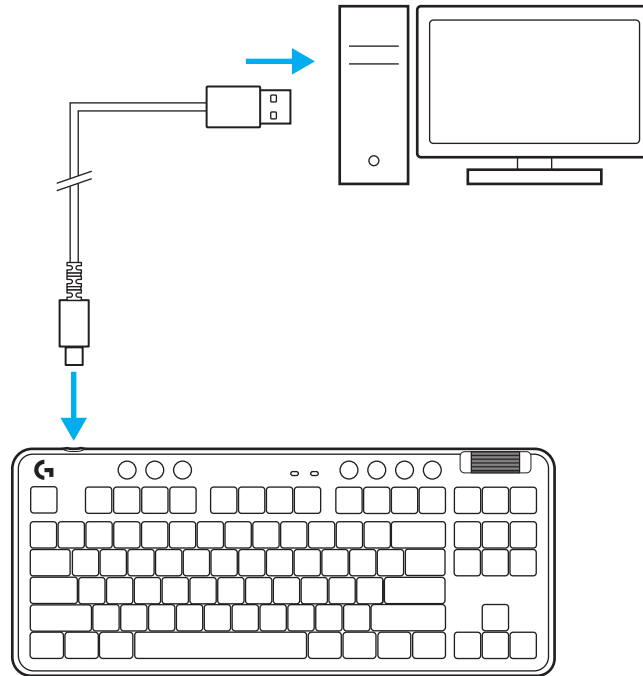

Battery indicator light will pulse green while charging and be solid green when fully charged.

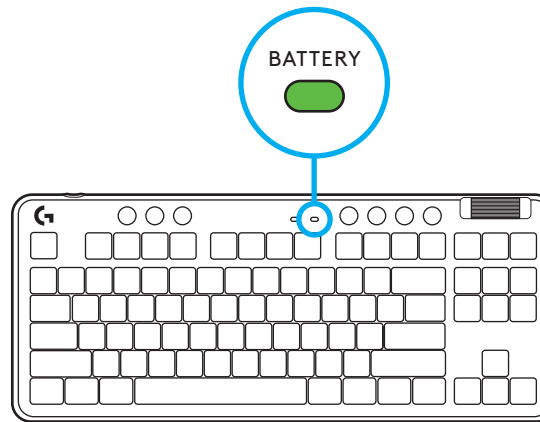

Media Controls

G715 includes media controls. Skip back, play/pause, skip forward and mute key, with a volume roller that controls your device volume.

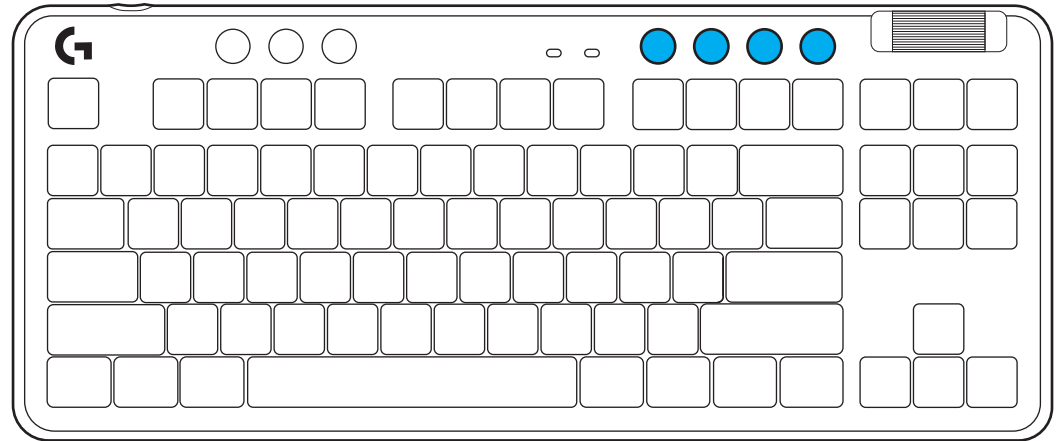

Game Mode

Pressing the Game mode button blocks the Windows and Menu keys when pressed. Additional keys can be blocked using G HUB software.

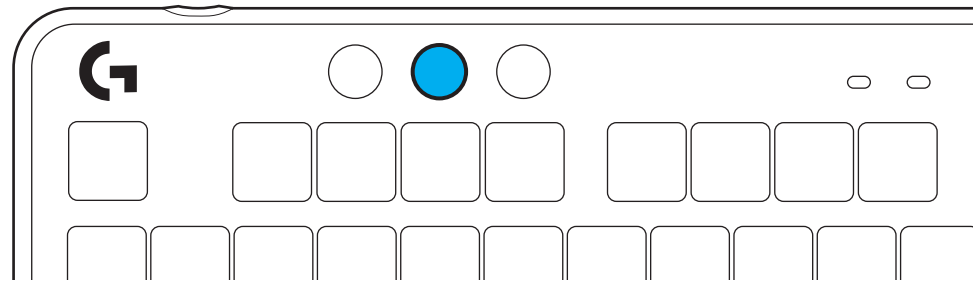

Brightness

Adjust lighting brightness by pressing the brightness button.

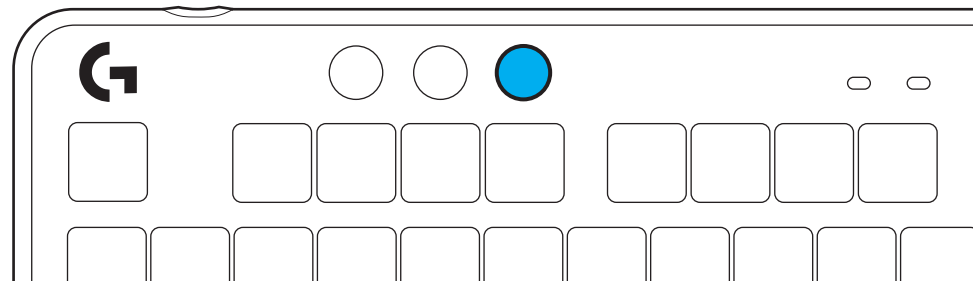

ONBOARD LIGHTING EFFECTS

The keyboard has 8 different lighting effects stored in its onboard memory. You can select and modify these by pressing the Brightness button and these keys:

Brightness + 1 = Rainbow > right

Brightness + 2 = Rainbow > left

Brightness + 3 = Rainbow center out

Brightness + 4 = Rainbow ^ up

Brightness + 5 = Color cycle

Brightness + 6 = Keystroke ripple

Brightness + 7 = Breathing cyan

Brightness + 8 = Custom lighting effect

Brightness + 9 = Custom lighting effect

Brightness + 0 = Solid cyan

Brightness + - = Animation slower

Brightness + = = Animation faster

G HUB lighting controls will override these settings.

CHANGING THE TOP PLATE

The top plate can be removed and replaced with optional accessory top plates.

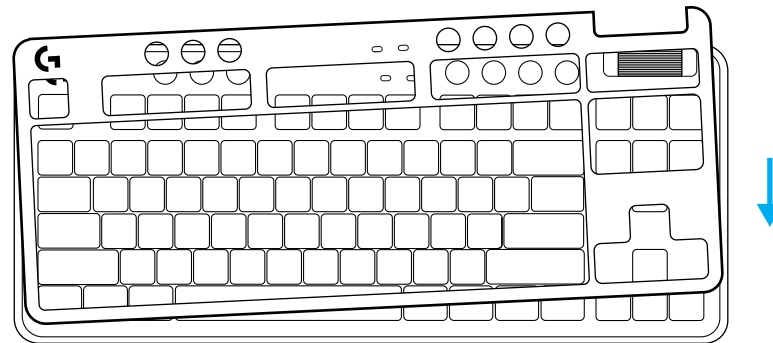
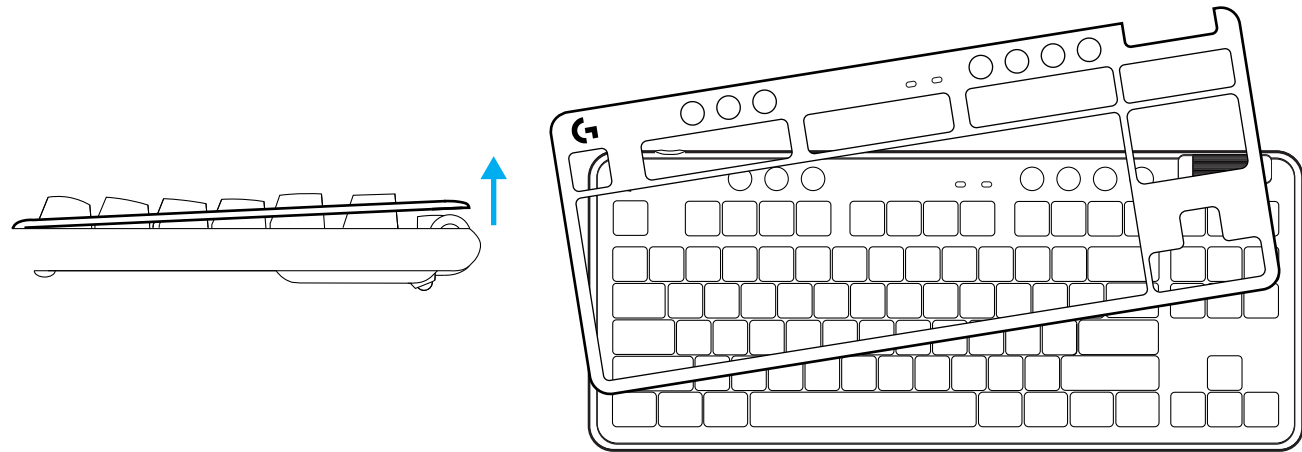

SWITCH BETWEEN LIGHTSPEED WIRELESS AND *BLUETOOTH*[®] DEVICES

Once connected, press the connect button to toggle connection. It will be a light cyan color for LIGHTSPEED, and a blue color for *Bluetooth*[®].

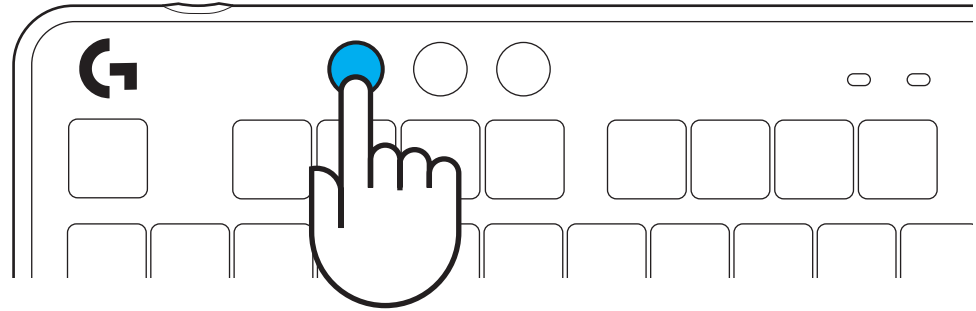

INSTRUCTIONS D'INSTALLATION

1 Retirez le récepteur LIGHTSPEED de l'emplacement de stockage.

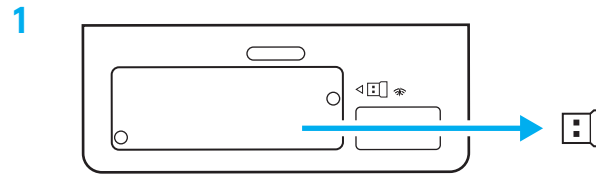

2 Insérez le récepteur LIGHTSPEED, avec la rallonge et le câble dans le port USB du PC. Le récepteur peut être utilisé sans la rallonge et le câble en l'insérant directement dans un port USB si vous le souhaitez.

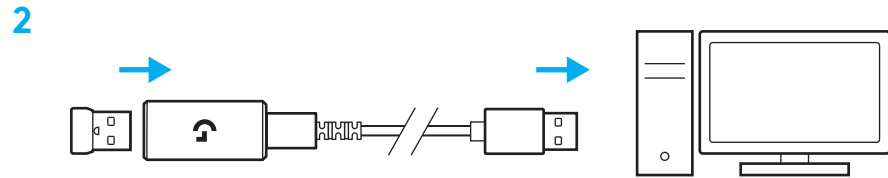

3 Allumez le clavier en faisant glisser le bouton d'alimentation.

Le bouton Connexion s'allume en cyan.

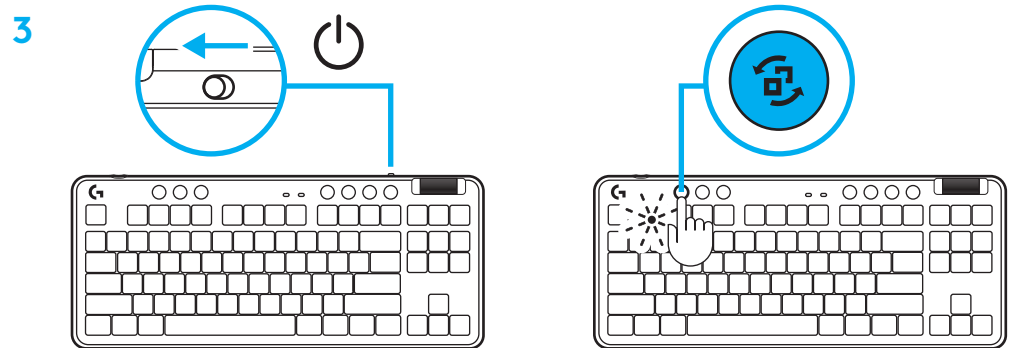

4 Téléchargez et installez le logiciel G HUB sur votre PC/MAC pour une expérience de jeu optimale (G HUB propose un parcours d'intégration pour les fonctionnalités). Rendez-vous sur <https://www.logitechG.com/ghub>



CONNECTIVITÉ BLUETOOTH®

- 1 Allumez le clavier en faisant glisser le bouton d'alimentation.

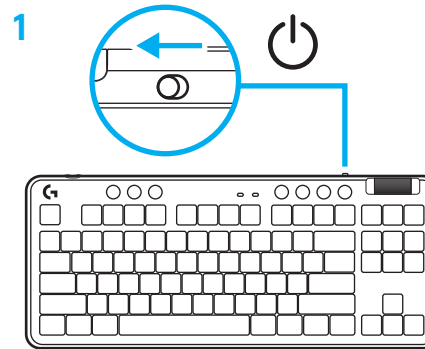

- 2 Appuyez sur le bouton Connexion pour passer en Bluetooth®. La lumière passera au bleu clair et clignotera rapidement en attente du couplage.

Suivez la connexion Bluetooth® pour que votre dispositif se couple avec le clavier.

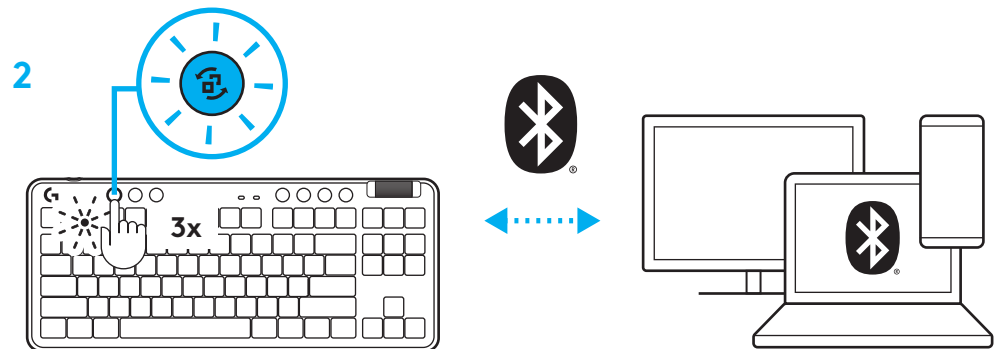

CHARGE DE VOTRE CLAVIER

- 1 Insérez le câble USB-C dans le port situé à l'avant du clavier.
- 2 Connectez le câble à votre PC.

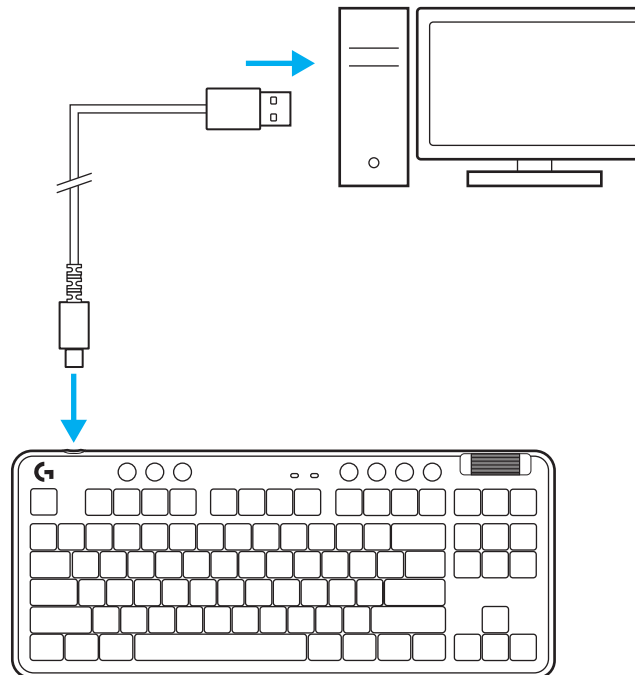

Le témoin lumineux de la batterie clignotera en vert pendant la charge et restera allumé en vert en continu une fois entièrement chargé.

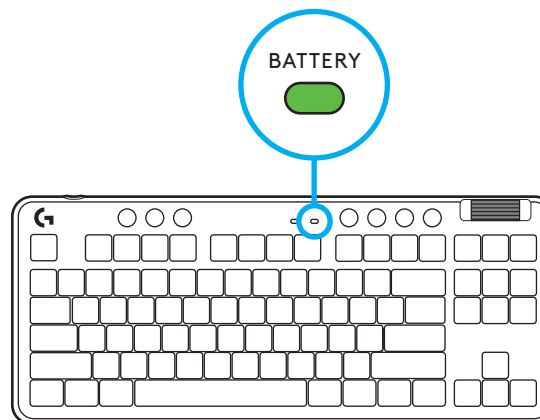

Commandes multimédia

G715 inclut des commandes multimédia.
Retour, Lecture/Pause, Avance et Sourdine, avec
une roulette contrôlant le volume de votre dispositif.

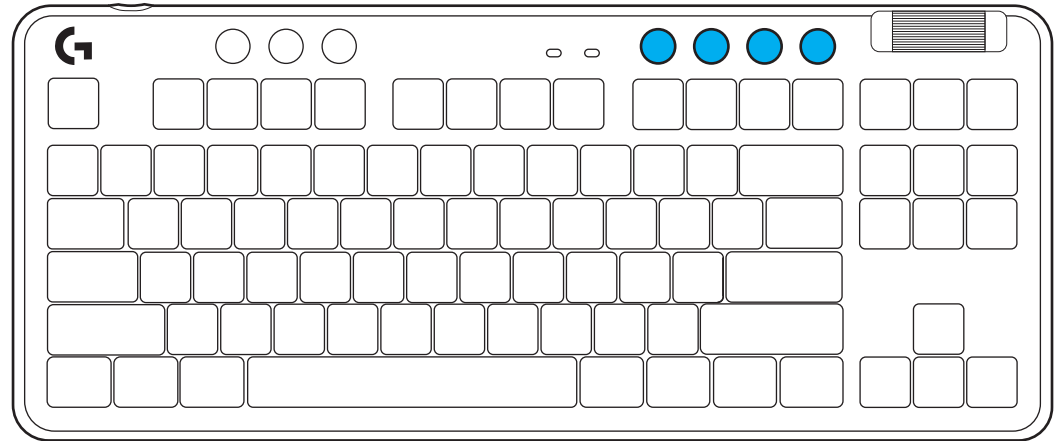

Mode Jeu

Le fait d'appuyer sur le bouton Mode Jeu bloque
les touches Windows et Menu. D'autres touches
peuvent être bloquées à l'aide du logiciel G HUB.

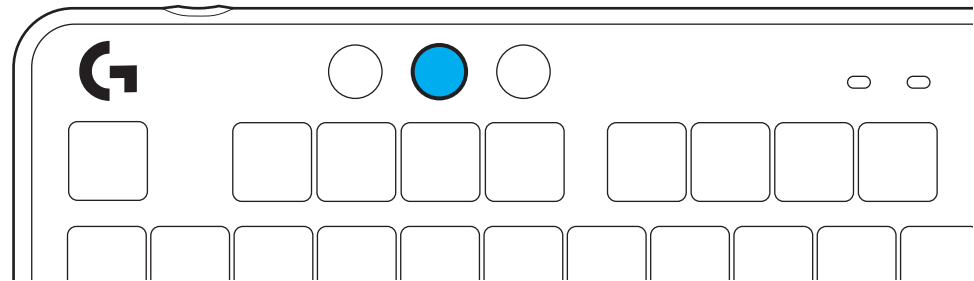

Luminosité

Réglez la luminosité de l'éclairage en appuyant
sur le bouton Luminosité.

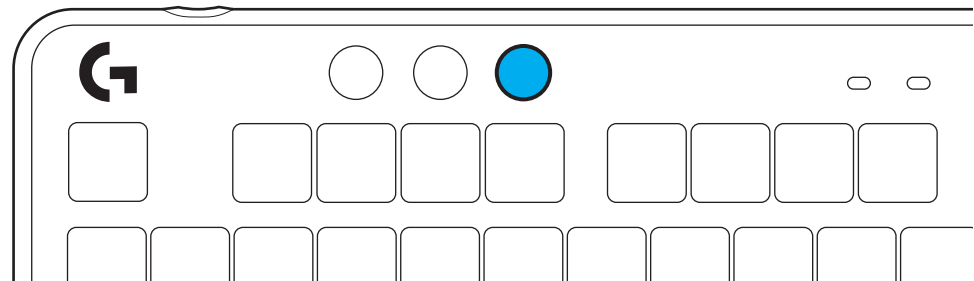

EFFET D'ÉCLAIRAGE INTÉGRÉ

Le clavier a 8 effets d'éclairage différents stockés dans sa mémoire. Vous pouvez les sélectionner et en changer en appuyant sur le bouton Luminosité et les touches suivantes:

Luminosité + 1 = Arc en ciel > droit

Luminosité + 2 = Arc en ciel > gauche

Luminosité + 3 = Arc en ciel centre

Luminosité + 4 = Arc en ciel ^ haut

Luminosité + 5 = Cycle de couleur

Luminosité + 6 = Ondulation frappe

Luminosité + 7 = Cyan clignotant

Luminosité + 8 = Effet d'éclairage personnalisé

Luminosité + 9 = Effet d'éclairage personnalisé

Luminosité + 0 = Cyan continu

Luminosité + = Animation plus lente

Luminosité + = Animation plus rapide

Les commandes d'éclairage G HUB remplaceront ces paramètres.

CHANGEMENT DE LA PLAQUE SUPÉRIEURE

La plaque supérieure peut être retirée et remplacée par des plaques supérieures accessoires en option.

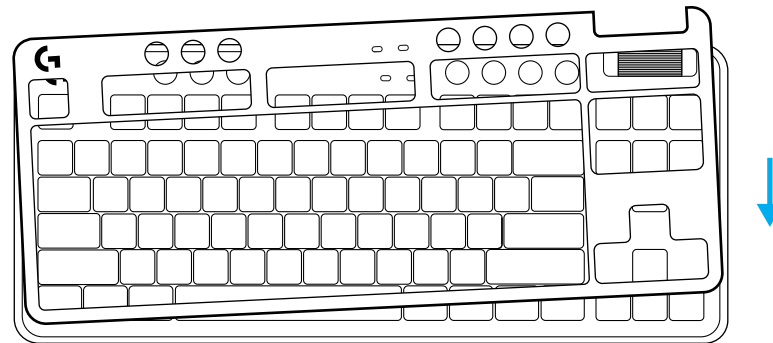
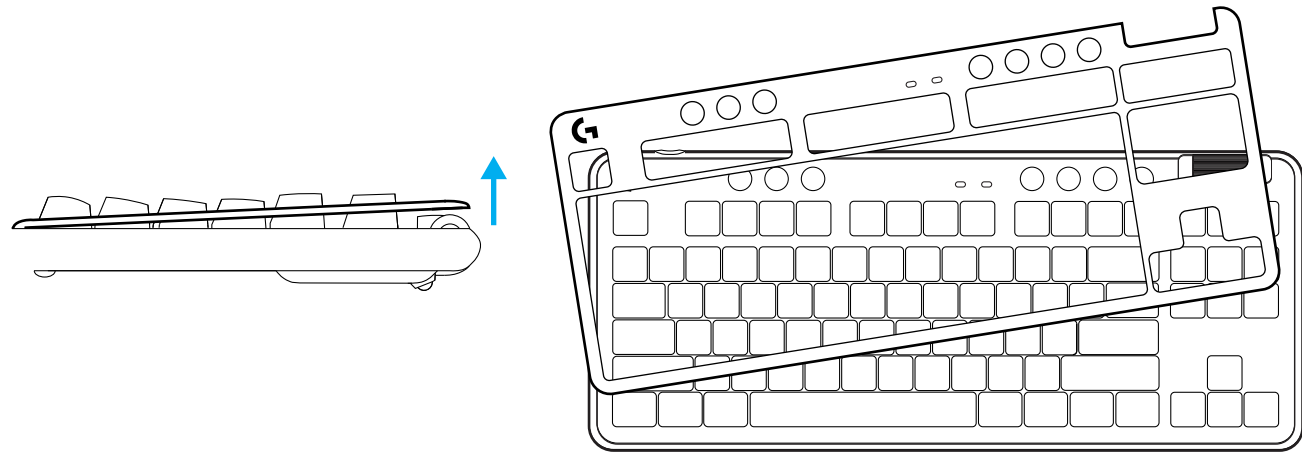

BASCULEZ ENTRE LES DISPOSITIFS SANS FIL LIGHTSPEED ET *BLUETOOTH*[®]

Une fois la connexion effectuée, appuyez sur le bouton de connexion pour changer de connexion. LIGHTSPEED sera éclairé en cyan et *Bluetooth*[®] en bleu.

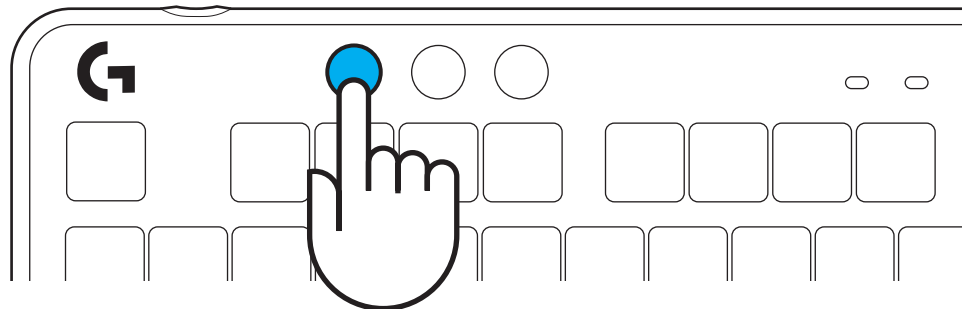

INSTRUCCIONES DE CONFIGURACIÓN

1 Extrae el receptor LIGHTSPEED de la ranura de almacenamiento.



2 Inserta el receptor LIGHTSPEED, con el alargador y el cable, en el puerto USB de la PC. El receptor también se puede usar sin el alargador y el cable insertándolo directamente en un puerto USB.

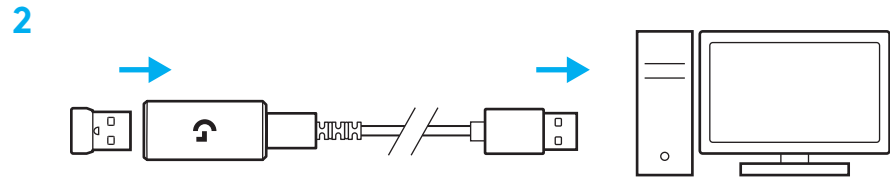

3 Desliza el botón de encendido para encender el teclado.

El botón de conexión se iluminará con luz cian.

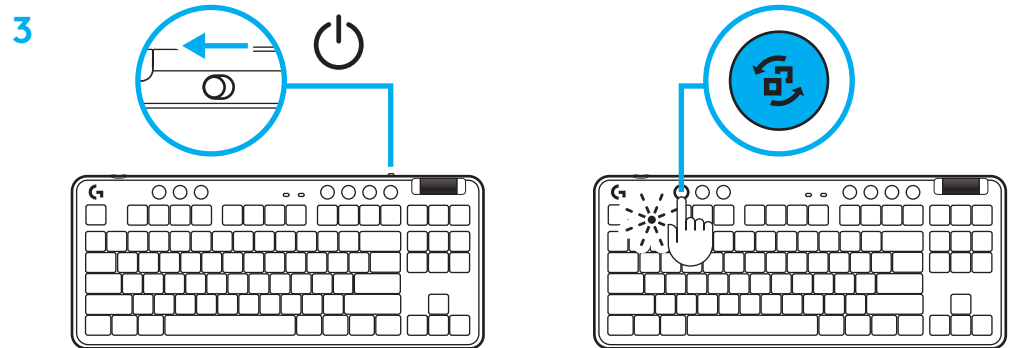

4 Descarga e instala el software G HUB en tu PC/ MAC para una experiencia de juego óptima (G HUB ofrece integración de funciones).
Ve a www.logitechG.com/g Hub

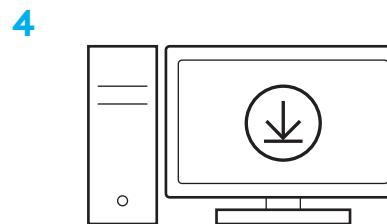

www.logitechG.com/g Hub

CONECTIVIDAD BLUETOOTH®

1 Desliza el botón para encender el teclado.

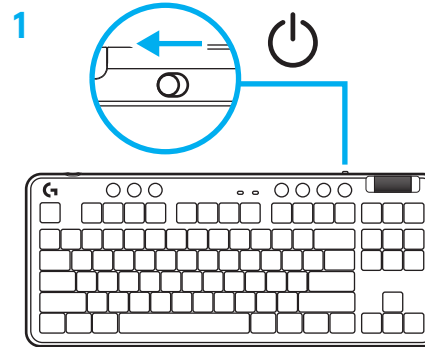

2 Presiona el botón de conexión para ir a la opción de *Bluetooth*®. La luz se volverá azul claro y emitirá destellos rápidos, a la espera del emparejamiento.

Sigue las instrucciones de conexión *Bluetooth*® de tu dispositivo para emparejarlo con el teclado.

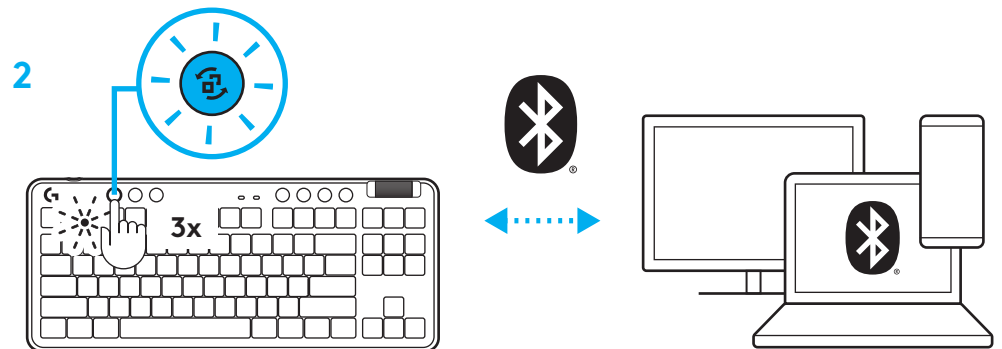

CARGA DEL TECLADO

- 1 Inserta el cable USB-C en el puerto situado en la parte frontal del teclado.
- 2 Conecta el cable a la PC.

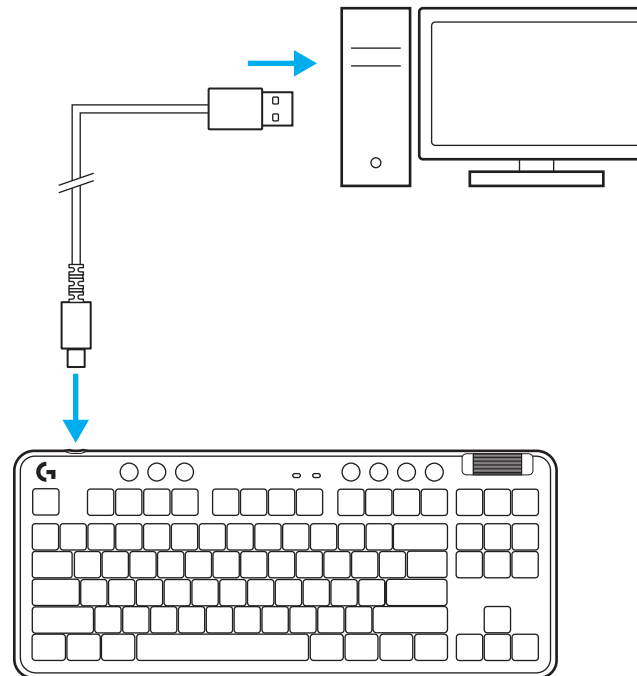

El indicador luminoso de carga emitirá pulsos verdes durante el proceso y se volverá permanente al completarse la carga.

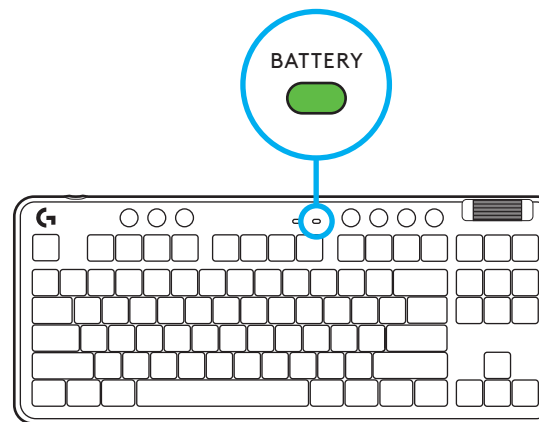

Controles multimedia

G715 incluye controles multimedia. Permiten saltar a la pista anterior, reproducir/poner en pausa, saltar a la pista siguiente y silenciar, con un mando giratorio que controla el volumen del dispositivo.

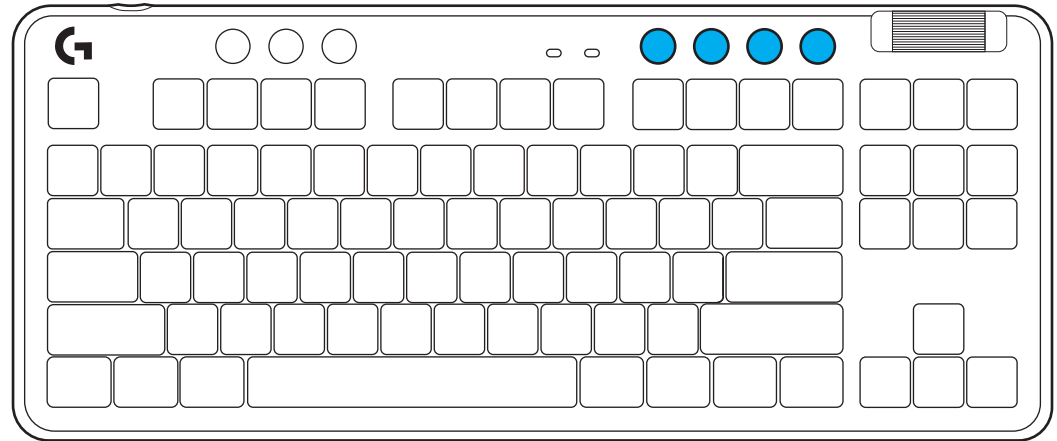

Modo de juego

Al presionar el botón de modo de juego se bloquea la pulsación de las teclas de Windows y menú. Es posible bloquear otras teclas usando el software G HUB.

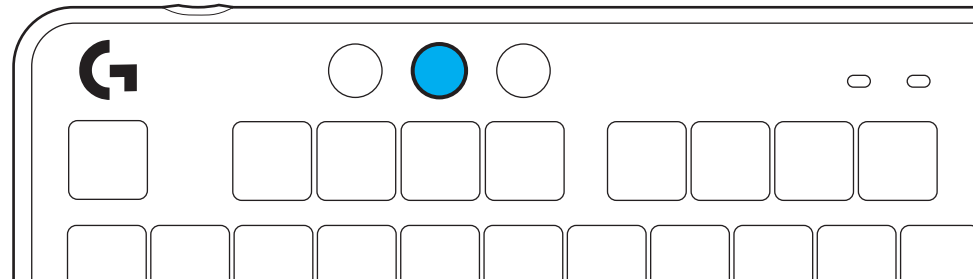

Brillo

Ajusta el brillo de la iluminación presionando el botón de brillo.

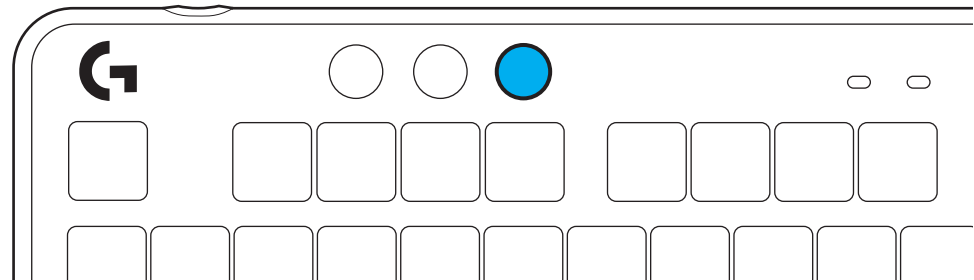

EFFECTOS DE ILUMINACIÓN INTEGRADOS

El teclado tiene 8 efectos de iluminación guardados en la memoria integrada. Puedes seleccionar y modificar esos efectos presionando el botón de brillo y luego estas teclas:

Brillo + 1 = Arcoíris > derecha

Brillo + 2 = Arcoíris > izquierda

Brillo + 3 = Arcoíris del centro al exterior

Brillo + 4 = Arcoíris ^ arriba

Brillo + 5 = Ciclo de colores

Brillo + 6 = Onda de pulsaciones

Brillo + 7 = Respiración cian

Brillo + 8 = Efecto de iluminación personalizado

Brillo + 9 = Efecto de iluminación personalizado

Brillo + 0 = Cian permanente

Brillo + - = Animación lenta

Brillo + = = Animación rápida

Los controles de iluminación de G HUB anularán esta configuración.

CAMBIO DE LA PLACA SUPERIOR

La placa superior se puede extraer y sustituir por placas accesorias opcionales.

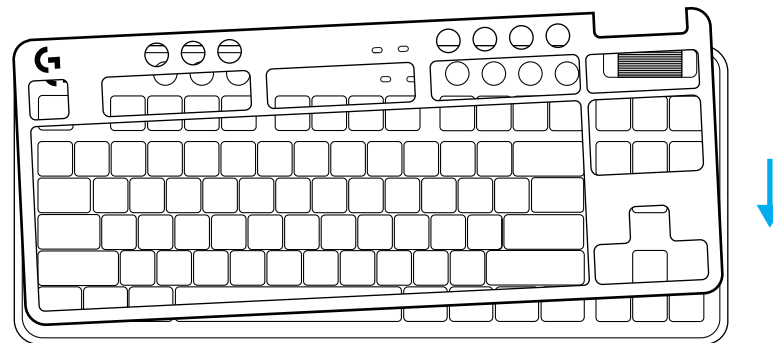
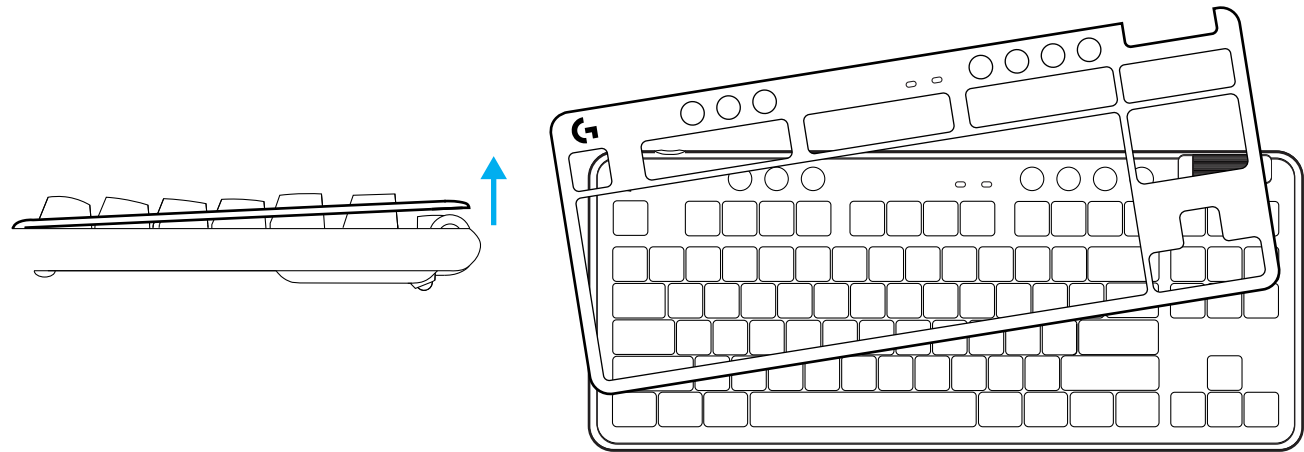

ALTERNAR ENTRE DISPOSITIVOS LIGHTSPEED INALÁMBRICOS Y *BLUETOOTH*®

Tras establecerse la conexión, presiona el botón de conexión para conmutar ésta. El color cian claro corresponde a la conexión LIGHTSPEED y el azul a la conexión *Bluetooth*®.

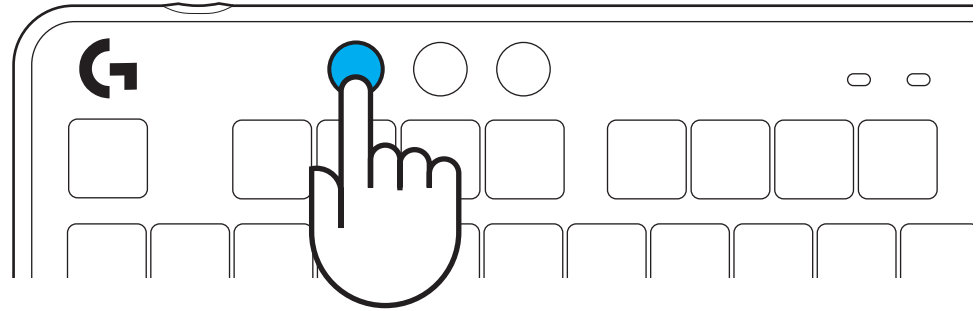

INSTRUÇÕES DE CONFIGURAÇÃO

1 Remova o receptor LIGHTSPEED do slot de armazenamento.

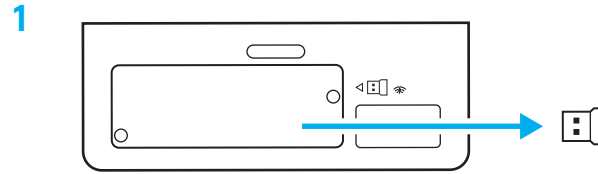

2 Insira o receptor LIGHTSPEED, com extensor e cabo na porta USB do PC. O receptor pode ser usado sem o extensor e o cabo, inserindo-o diretamente em uma porta USB, se desejado.

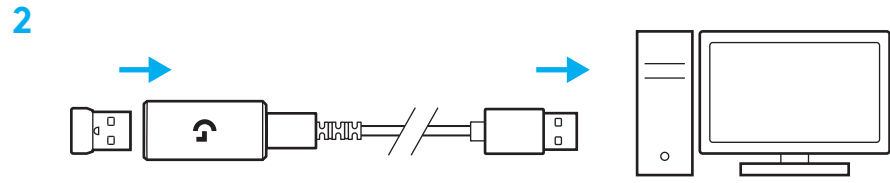

3 Ligue o teclado deslizando o botão de ligar/desligar.

O botão de conexão acenderá até uma cor de ciano.

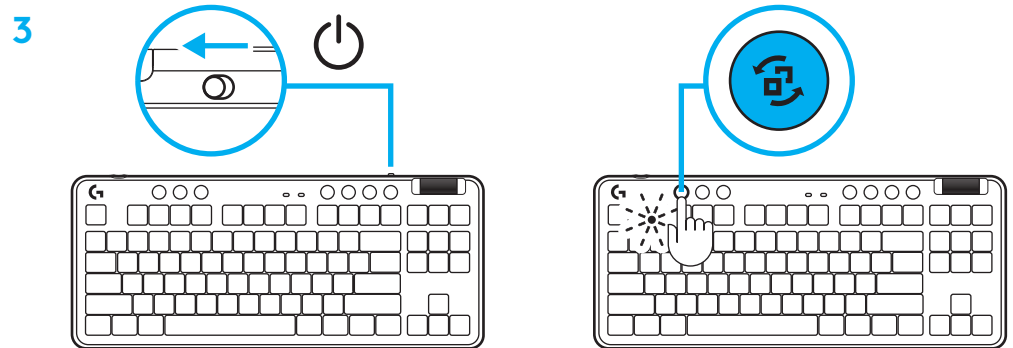

4 Baixe e instale o software G HUB em seu PC/MAC para obter a melhor experiência de jogo (a G HUB tem um histórico integrado para recursos). Ir para www.logitechG.com/ghub

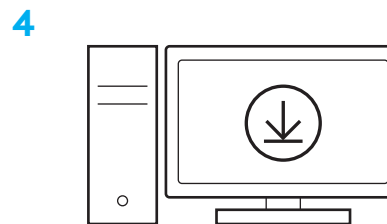

www.logitechG.com/ghub

CONECTIVIDADE BLUETOOTH®

1 Ligue o teclado deslizando o botão.

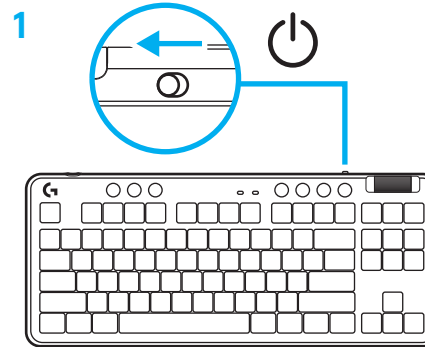

2 Pressione o botão de conexão para passar para Bluetooth®. A luz passará para azul claro e piscará rapidamente - esperando para emparelhar.

Siga a conexão Bluetooth® para que seu dispositivo seja pareado com o teclado.

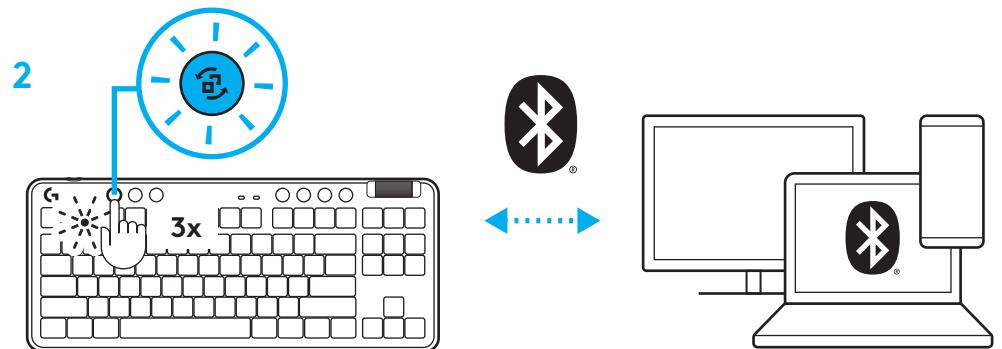

CARREGANDO SEU MOUSE

- 1 Insira o cabo USB-C na porta na parte da frente do teclado.
- 2 Conecte o cabo USB ao PC.

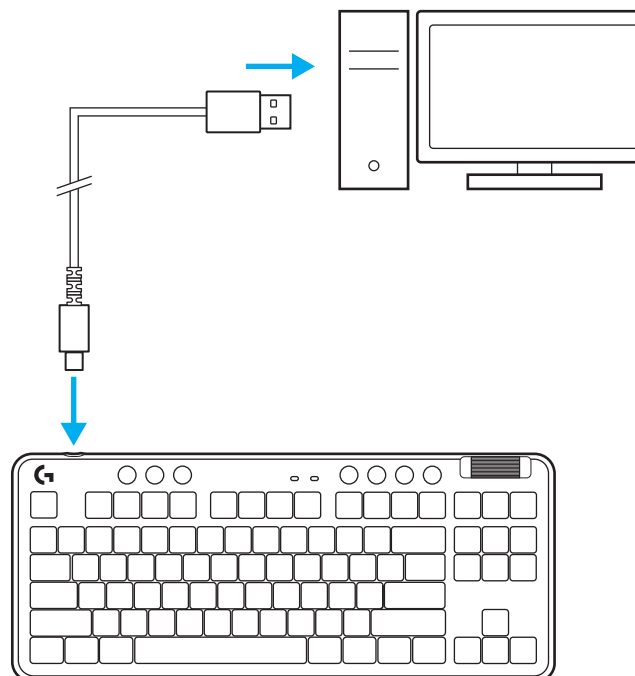

A luz indicadora de bateria pulsará verde durante a carga e será verde sólido quando totalmente carregada.

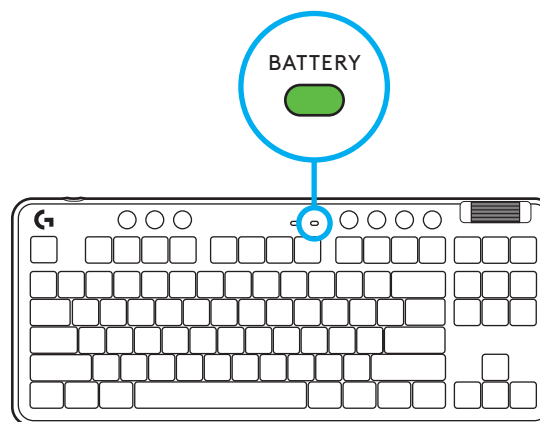

Controles de mídia

O G715 inclui controles de mídia. Pular para trás, jogar/pausar, pular para frente e tecla de silêncio, com um controle de volume de seu dispositivo.

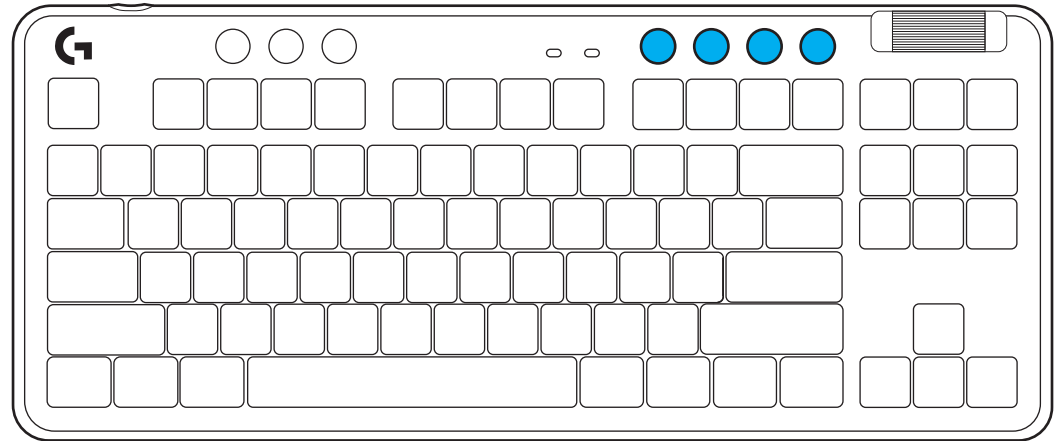

Modo de jogo

Pressionar o botão Modo de jogo bloqueia as teclas Windows e Menu quando pressionado. Teclas adicionais podem ser bloqueadas usando o software G HUB.

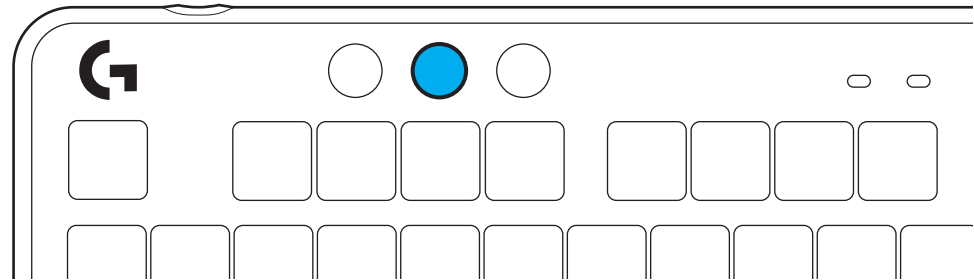

Brilho

Ajuste a iluminação pressionando o botão de iluminação.

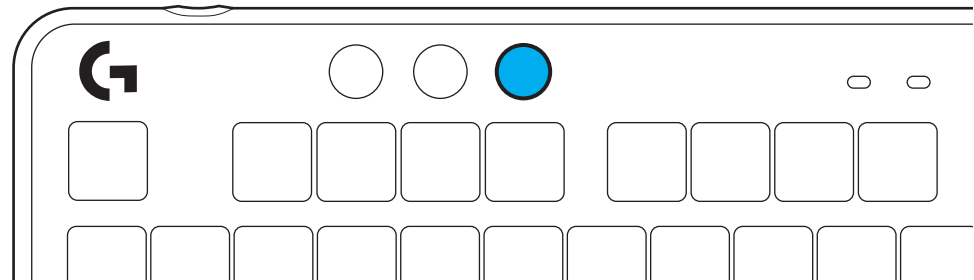

EFEITOS DE ILUMINAÇÃO INTEGRADOS

O teclado tem 8 efeitos de iluminação diferentes armazenados em sua memória onboard. Você pode selecioná-los e modificá-los pressionando o botão Iluminação e estas teclas:

Iluminação + 1 = Rainbow > direita

Iluminação + 2 = Rainbow > esquerda

Iluminação + 3 = Rainbow centro

Iluminação + 4 = Rainbow ^ cima

Iluminação + 5 = Ciclo de cor

Iluminação + 6 = Ripple de teclas

Iluminação + 7 = Ciano respirando

Iluminação + 8 = Efeito de iluminação personalizado

Iluminação + 9 = Efeito de iluminação personalizado

Iluminação + 0 = Ciano sólido

Iluminação + - = Animação mais lenta

Iluminação + = Animação mais rápida

Os controles de iluminação G HUB anularão essas configurações.

TROCANDO A PLACA SUPERIOR

A placa superior pode ser removida e substituída por placas superiores acessórias opcionais.

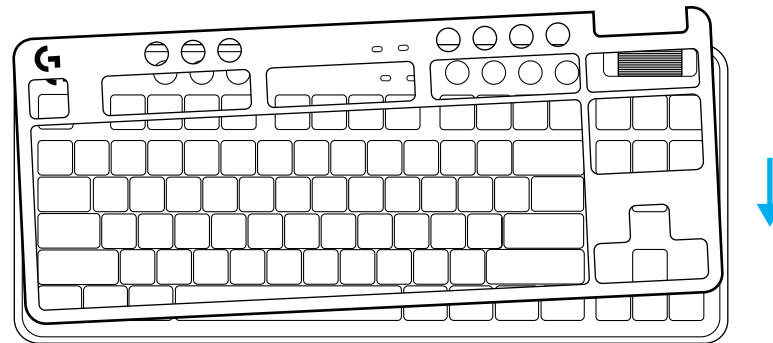
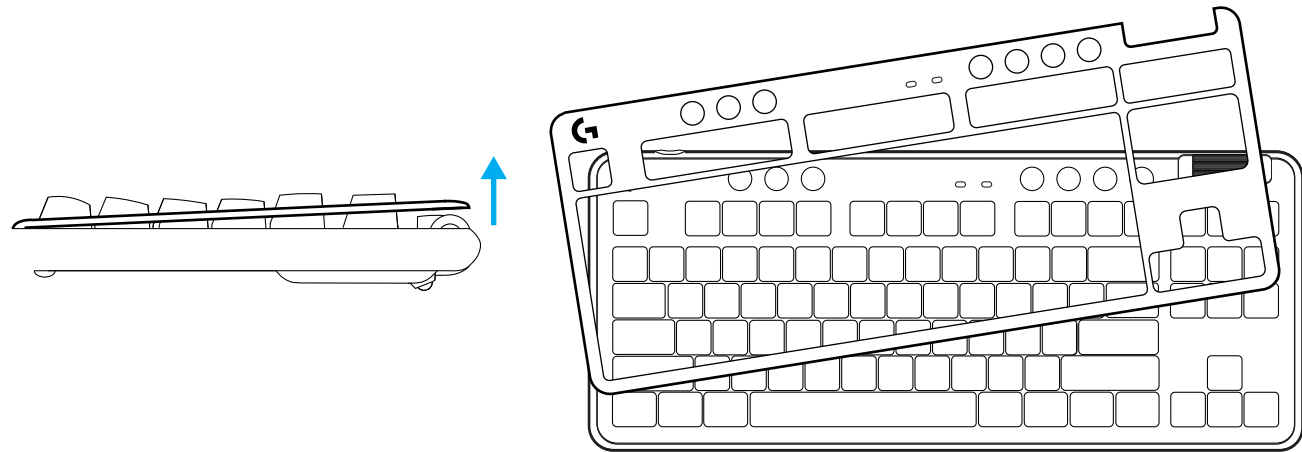

ALTERNAR ENTRE DISPOSITIVOS SEM FIO DE VELOCIDADE DA LUZ E DISPOSITIVOS *BLUETOOTH*[®]

Uma vez conectado, pressione o botão de conexão para alternar a conexão. Será uma cor de ciano claro para LIGHTSPEED, e uma cor azul para *Bluetooth*[®].

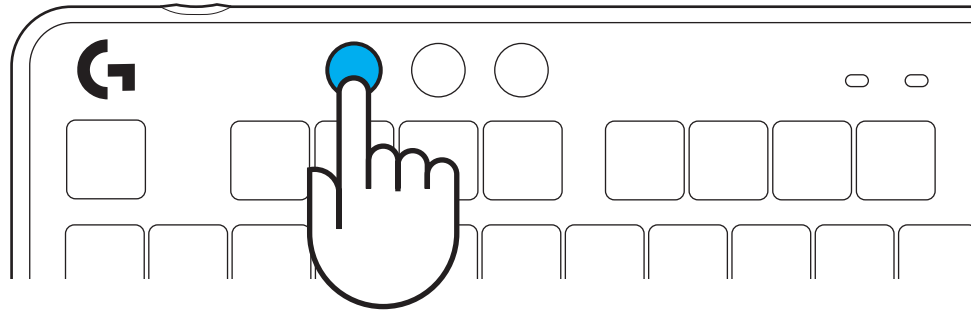



© 2022 Logitech. Logitech, Logitech G, Logi and their respective logos are trademarks or registered trademarks of Logitech Europe S.A. and/or its affiliates in the U.S. and other countries. All other trademarks are the property of their respective owners. Logitech assumes no responsibility for any errors that may appear in this manual. Information contained herein is subject to change without notice. The *Bluetooth*® word mark and logos are registered trademarks owned by Bluetooth SIG, Inc. and any use of such marks by Logitech is under license.

© 2022 Logitech. Logitech, Logitech G, Logi et leurs logos respectifs sont des marques commerciales ou déposées de Logitech Europe S.A. et/ou de ses sociétés affiliées aux États-Unis et dans d'autres pays. Toutes les autres marques sont la propriété exclusive de leurs détenteurs respectifs. Logitech décline toute responsabilité en cas d'erreurs susceptibles de s'être glissées dans le présent manuel. Les informations énoncées dans ce document peuvent faire l'objet de modifications sans préavis. La marque et les logos *Bluetooth*® sont des marques déposées détenues par Bluetooth SIG, Inc. et sont utilisés par Logitech sous licence.