



Assembly Guide

Z30 POS Stand

Revision C
P/N E236351

Kit Contents

Z30 POS Stand (Qty 1)

150W DC Power Adapter and cables

M3x6mm screw for cable door (Qty 1)

M4x8mm screw for mounting plate (Qty 1)

M4x6mm flat-head screw for display mounting (Qty 4)

Mounting bracket (Qty 1)

Tie-wraps (Qty 2)

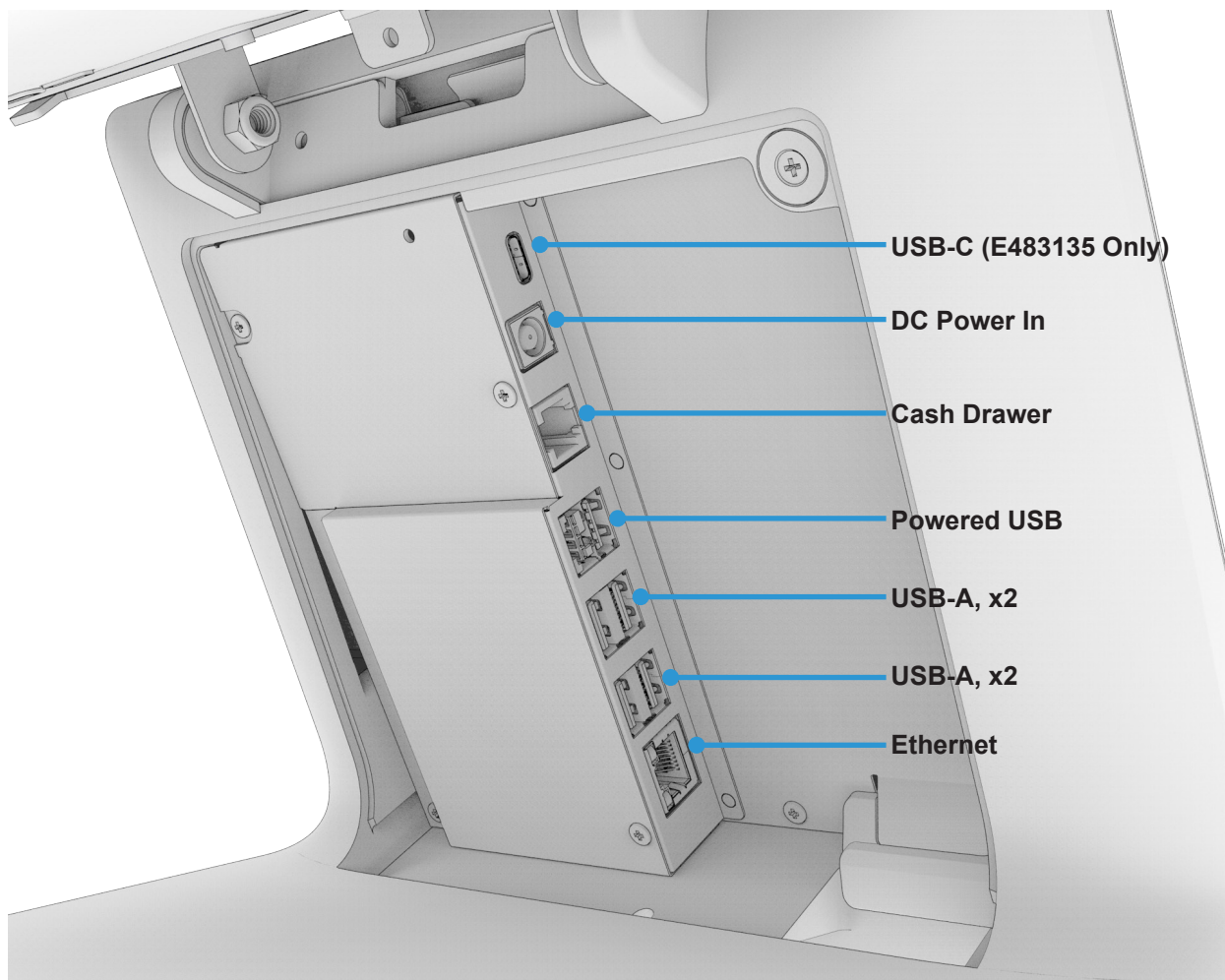

- 1 Elo Z30 POS Stand supports the I-Series 4 Slate display ordered separately. Remove screw on cable lock bracket from the rear of the display and place screw and bracket aside for reinstallation in step 6.

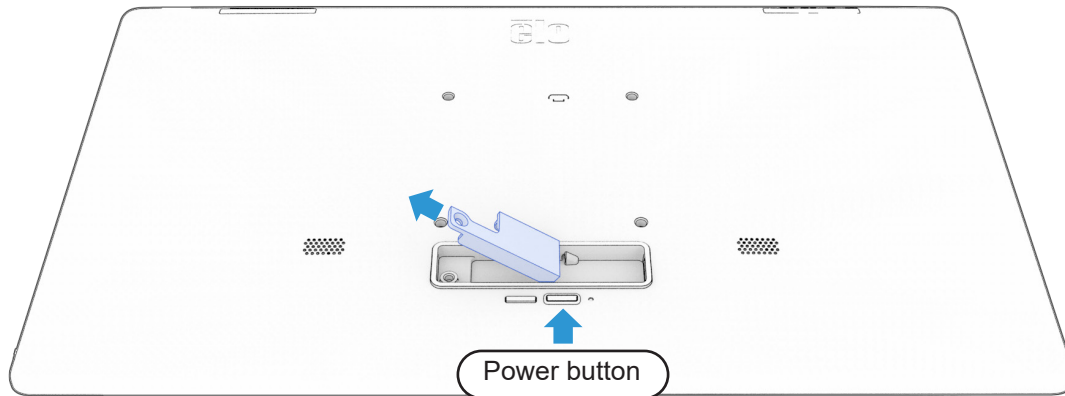

- 2 Remove the upper and lower VESA mount covers by removing the M3 screws noted below.

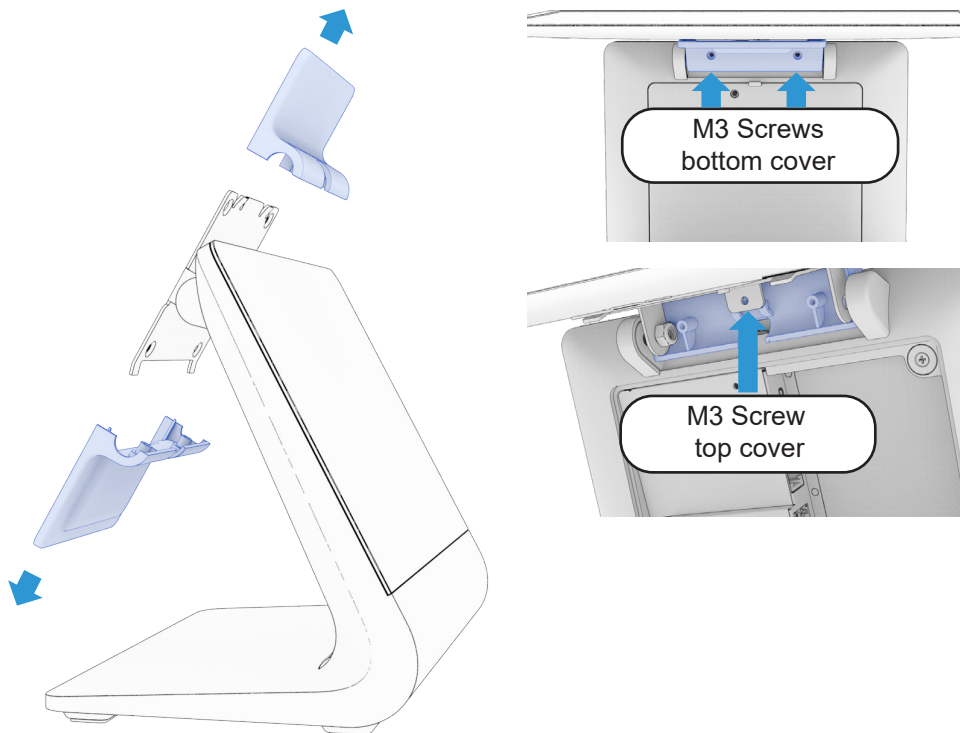

- 3 Install I-Series 4 Slate display on stand using included M4x6mm flat-head screws. Both landscape and portrait orientations are supported.

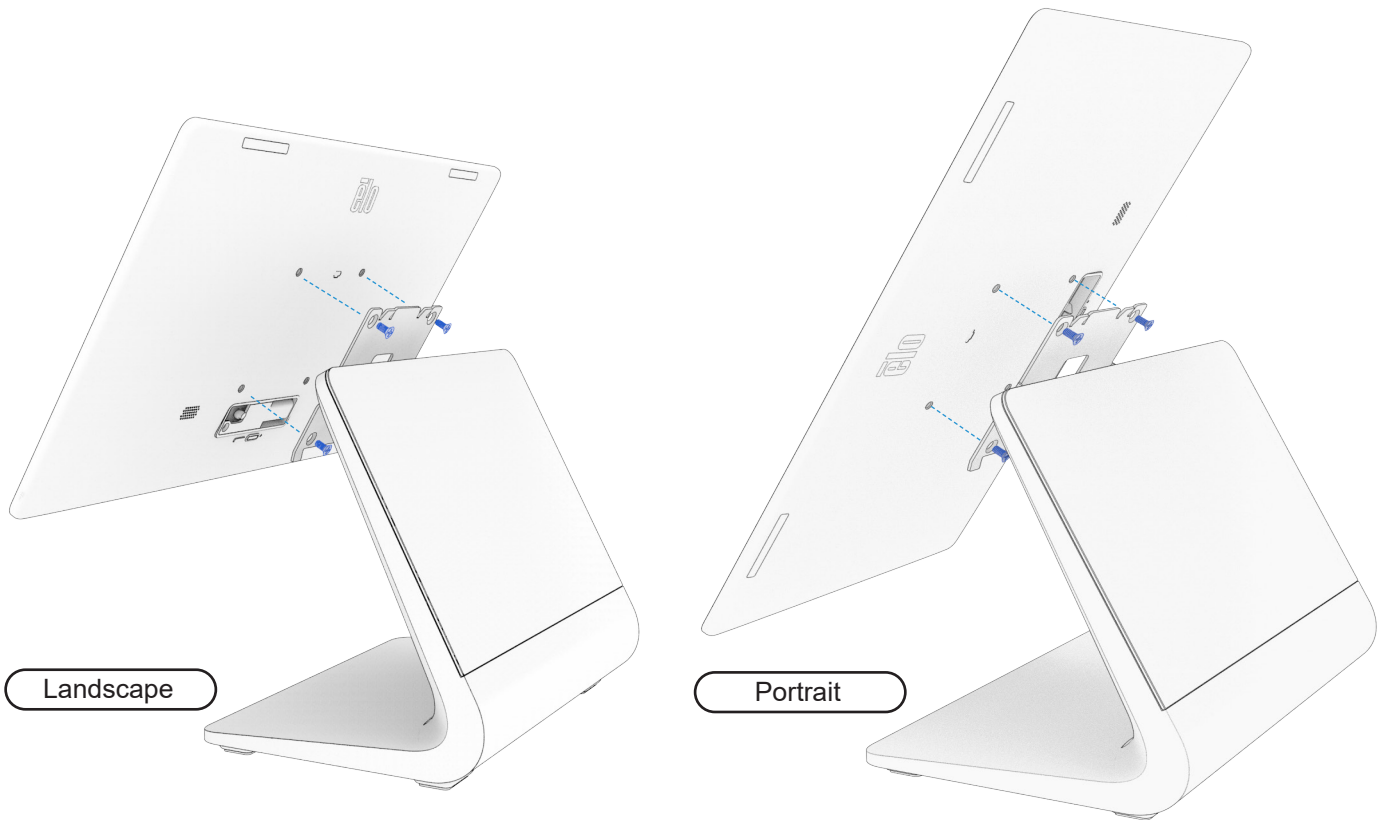

- 4 Mount the system to a table (optional). Skip to Step 6 if not mounting to a table.

Secure the mounting bracket to the table using appropriate screw type and length. Elo suggests M4 or #10 screw diameter.

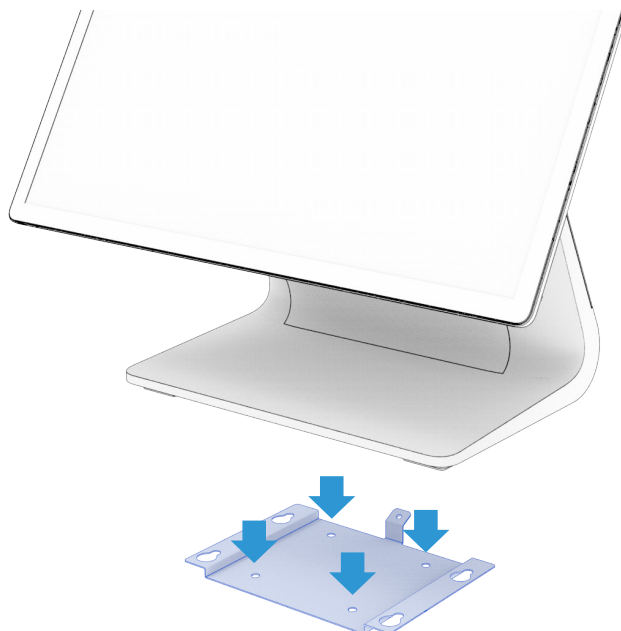

- 5 Lower the system onto the bracket and slide it back ensuring the bracket engages the screws on the bottom side.



- 6 Secure the system to the bracket using the M4x8mm screw included in the accessory box.

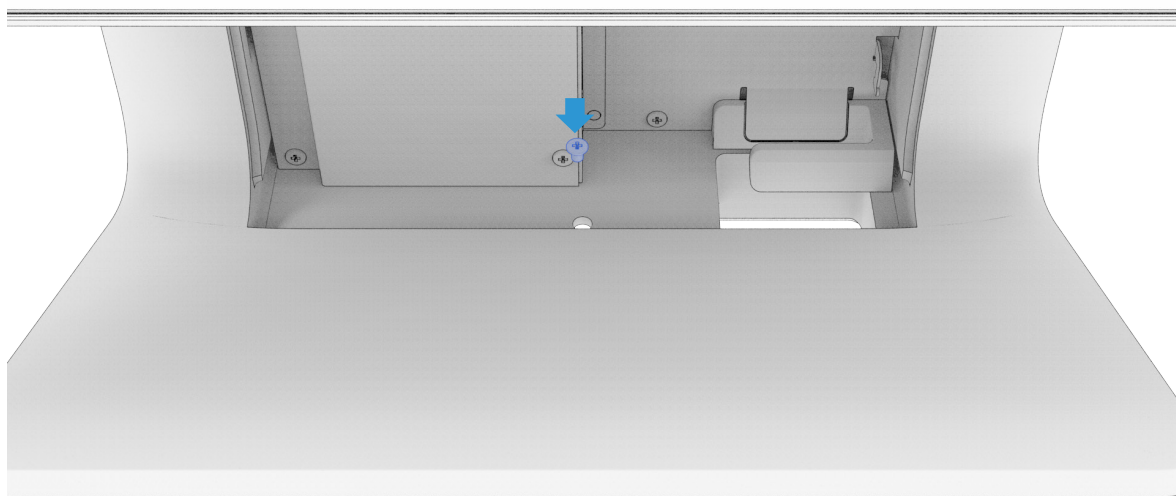

- 7 Connect the USB-C cable located in the hinge of the stand to the I-Series 4 Slate display. Re-install the cable lock bracket and screw from step 1.

Landscape



Portrait

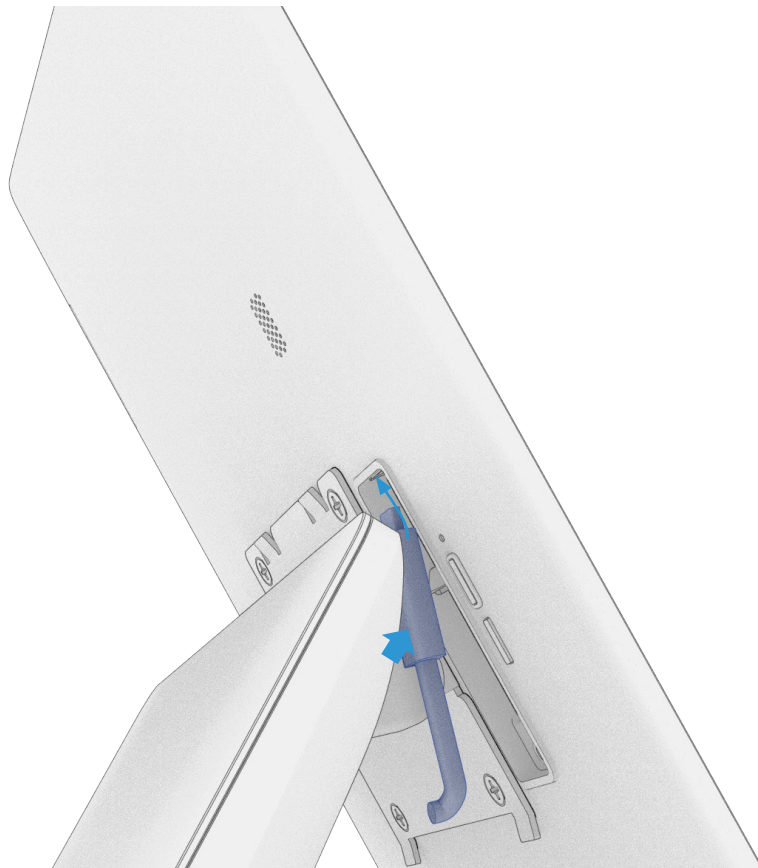

- 8 Slide the upper VESA mount cover over the VESA mount bracket and install the M3x6mm screw removed in step 2 to secure it in place. For landscape, install the lower VESA cover so it covers the USB-C cable ensuring the cable routes freely. For portrait, install the lower VESA cover so the USB-C cable routes through the notch as shown. Install the M3x13mm screws removed in step 2 to secure the lower VESA mount cover.

Landscape

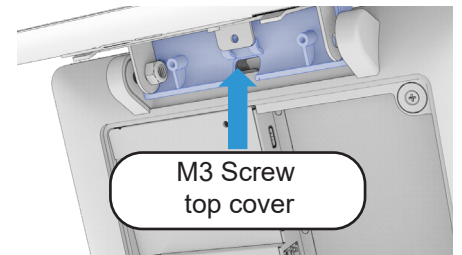
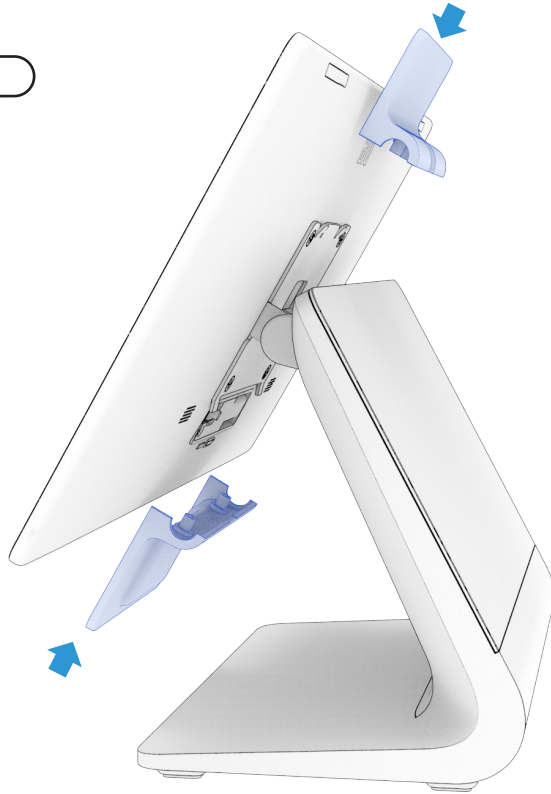

Portrait

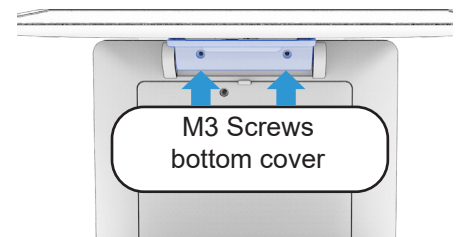
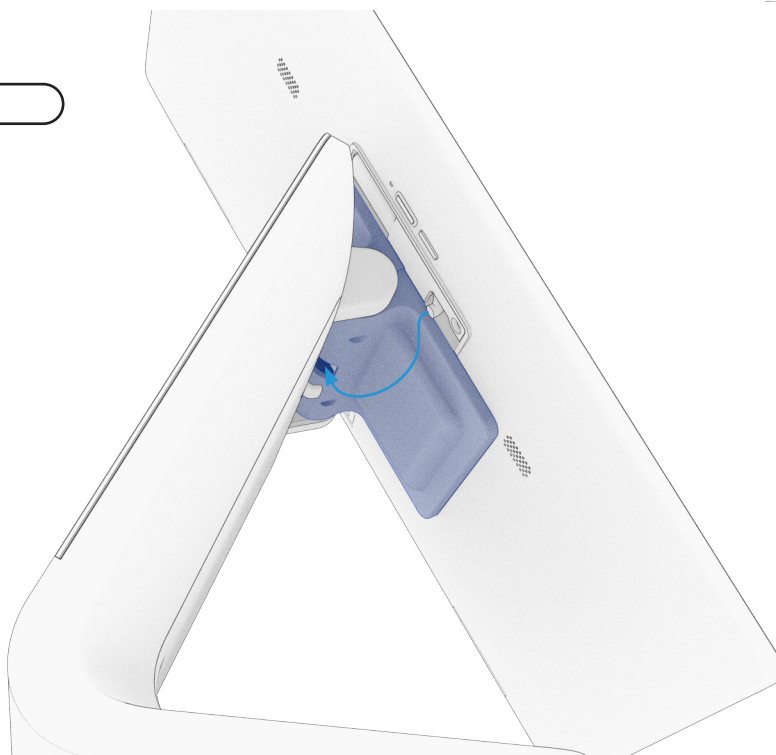

- 9 Remove the cable cover door to access the I/O connections.

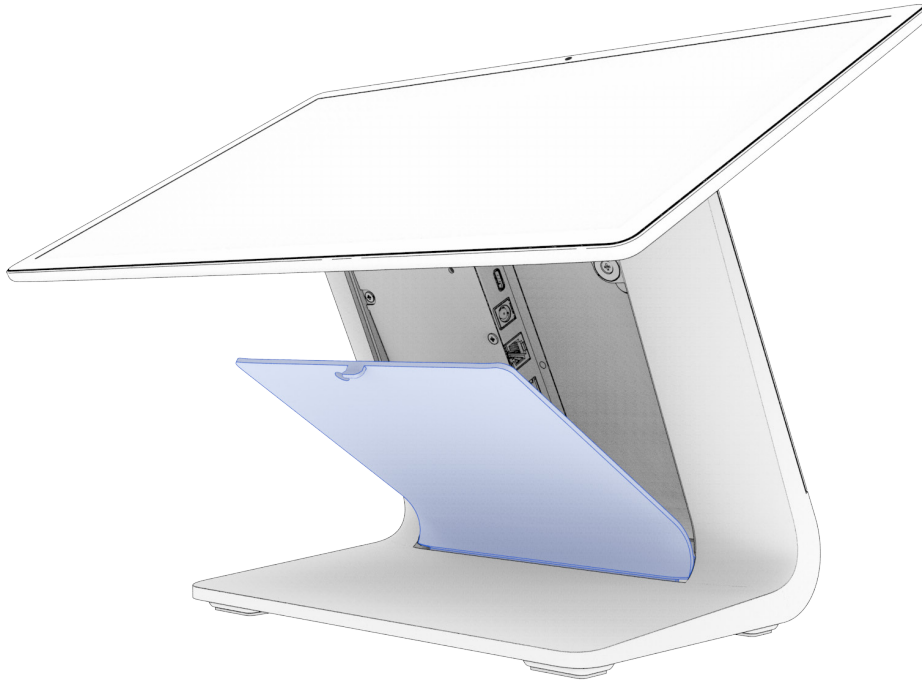

- 10 Route the DC power cable through the hole in the bottom of the stand and connect it as shown. Connect other I/O cables as needed (see page 2) Make sure all cables route through the plastic clip at the bottom and re-install cable cover door.

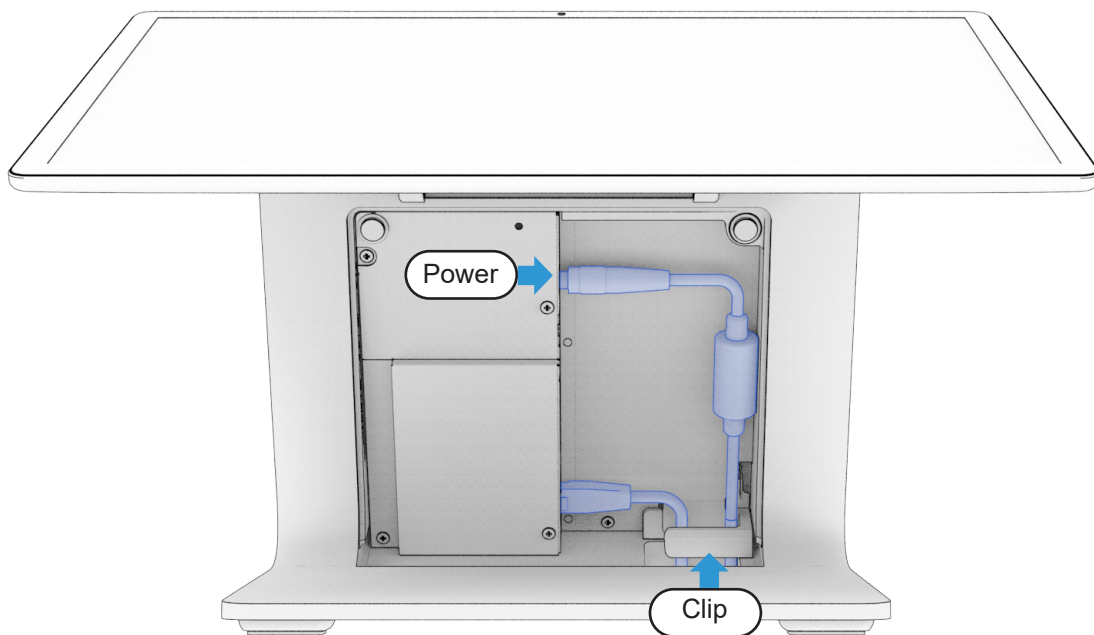

11 Power on the system when installation is complete.

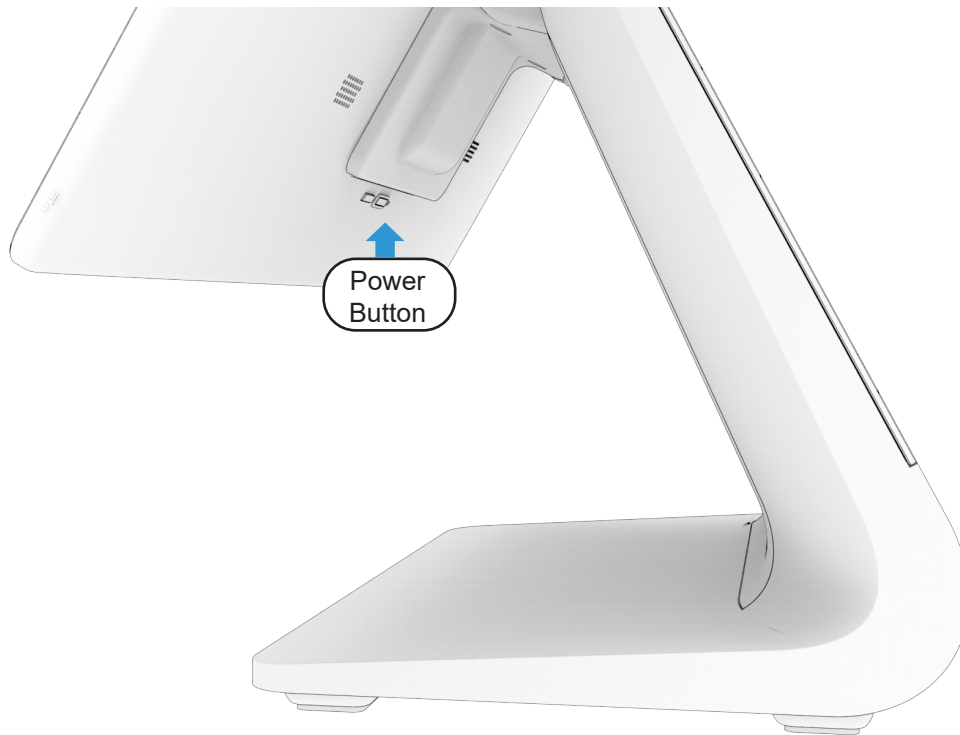

Learn more about Elo at [EloTouch.com](https://www.elotouch.com)

America

Tel +1 408 597 8000
EloSales.NA@elotouch.com

Europe (EMEA)

Tel +32 16 930 136
EMEA.sales@elotouch.com

Asia Pacific

Tel +86 (21) 3329 1385
EloAsia@elotouch.com

The information in this document is subject to change without notice. Elo Touch Solutions, Inc. and its Affiliates (collectively "Elo") makes no representations or warranties with respect to the contents herein, and specifically disclaims any implied warranties of merchantability or fitness for a particular purpose. Elo reserves the right to revise this publication and to make changes from time to time in the content hereof without obligation of Elo to notify any person of such revisions or changes.

No part of this publication may be reproduced, transmitted, transcribed, stored in a retrieval system, or translated into any language or computer language, in any form or by any means, including, but not limited to, electronic, magnetic, optical, chemical, manual, or otherwise without prior written permission of Elo Touch Solutions, Inc.

Elo and the Elo logo are either trademarks or registered trademarks of Elo Touch Solutions, Inc..

