



150" Home Theater LCD Projector

NVP-1000



User Manual

Please read carefully before using product and
keep for future reference

Table of Contents

Introduction.....	3
Safety Instructions.....	4
Additional Warnings.....	5
Package Contents.....	6
Placing Projector.....	7
Making Adjustments.....	8
Remote Overview.....	9
Projector Overview.....	10
Main Operation.....	11
Bluetooth Operation.....	12
HDMI Operation.....	14
Audio / Video Input.....	15
Computer Video (VGA).....	16
External Audio.....	17
Micro SD & USB Inputs.....	18
Specifications.....	19
Support.....	20

Introduction

Congratulations, and thank you for choosing Naxa's 150" Home Theater LCD Projector. This manual will help you operate your new device.

We know you have many choices when it comes to technology; thank you for choosing us here at Naxa Electronics. Established in 2001 in Los Angeles, California, we are dedicated to delivering products that entertain and delight.

We trust that you will be happy with your purchase. Please read this manual carefully and save it for reference. You may also find the latest FAQ, documentation, and other product material at our website. Come visit us on the web at www.naxa.com and see all that we have to offer!

Safety Instructions

1. Read these instructions.
2. Keep these instructions.
3. Heed all warnings.
4. Follow all instructions.
5. Do not use this apparatus near water.
6. Clean only with a dry cloth.
7. Do not block any ventilation openings. Install in accordance with the manufacturer's instructions.
8. Do not install near any heat sources, such as radiators, heat registers, stoves, or other apparatus (including amplifier) that produce heat.
9. Protect the power cord from being walked on or pinched, particularly at plugs, convenience receptacles, and the point where they exit from the apparatus.
10. Only use attachments / accessories specified by the manufacturer.
11. Unplug this apparatus during lightning storms or when unused for long periods of time.
12. Refer all servicing to qualified service personnel. Servicing is required when the apparatus has been damaged in any way, such as power-supply cord or plug is damaged, liquid has been spilled or objects have fallen into the apparatus, the apparatus has been exposed to rain or moisture, does not operate normally, or has been dropped.
13. Use only with a cart, stand, tripod, bracket, or table specified by the manufacturer or sold with the apparatus. When a cart is used, use caution when moving the cart / apparatus combination to avoid injury from tip-over.

Additional Warnings

1. Do not look directly into the projector light.
2. Do not touch the projector lens.
3. Mains adapter is used as disconnect and it should remain readily operable during intended use. In order to disconnect the apparatus from the mains completely, the mains plug should be disconnected from the mains socket completely.
4. **CAUTION:** Use of controls or adjustments or performance of procedures other than those specified may result in hazardous radiation exposure.
5. **WARNING:** Changes or modified to this unit not expressly approved by the party responsible for compliance could void the user's authority to operate the equipment.
6. **WARNING:** Use of this unit near fluorescent lighting may cause interference regarding use of the remote. If the unit is displaying erratic behavior move away from any fluorescent lighting, as it may be the cause.
7. **WARNING:** Shock hazard - DO NOT OPEN.
8. Caution and marking information is located at the rear or bottom of the apparatus.
9. **WARNING:** To reduce the risk of fire or electric shock, do not expose this apparatus to rain, moisture, dripping, or splashing.
10. Objects filled with liquids, such as vases, shall not be placed on the apparatus.

Package Contents



Projector



AC Power Adapter



Remote control



User manual

Placing Projector

Your projector can be installed in four different configurations (see picture below).

Front Table:

Select this location with the projector placed near the floor in front of the screen. This is the most common way to position the projector for quick setup and portability.

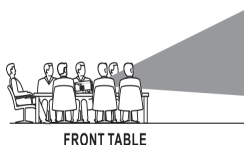

Front Ceiling:

Select this location with the projector suspended upside-down from the ceiling in front of the screen.

NOTE: A projector mount is required to install the projector on the ceiling.

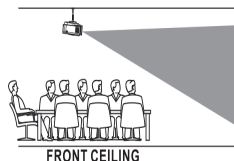

Rear Table:

Select this location with the projector placed near the floor behind screen.

NOTE: A special rear projection screen is required.

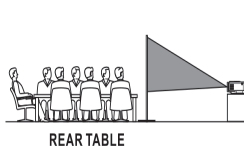

Rear Ceiling:

Select this location with the projector suspended upside-down from the ceiling behind the screen.

NOTE: A projector mount and a special rear projection screen is required.

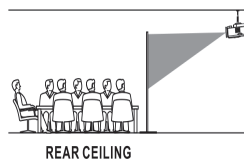

Making Adjustments

Follow the pictures below to adjust the focus and trapezoidal screen. Adjust the focus by turning the knob while observing the image pixels near the center of the screen. Optimal focus is obtained when the pixels are clearly visible. Depending on the projected screen size, the focus near the screen edges may be less sharp than the screen center.

FOCUS ADJ. KNOB

Then sharpen the image by rotating focus knob.



Keystone image is created when the projector beam is projected to the screen in an angle. Keystone correction will restore the distorted image to a rectangular or square shape.

TRAPEZOIDAL ADJ. KNOB

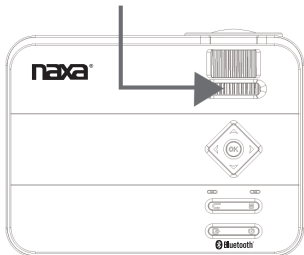

Control Overview

Power

Press to power ON.

Press and hold to power OFF.

◀◀ Previous / Next ▶▶

Press to skip between chapters or tracks.

■ Stop

Press to stop playback.

Flip

Press to flip display image 180°.

▶|| Play/Pause

Press to play or pause an individual chapter or track.

Arrows/OK

Press to navigate and confirm selections in Settings and other menus.

Menu

Press to access projector Settings.

Go To/Number Keypad

Press to enter specific chapter or track numbers. Use Play button to begin playing.

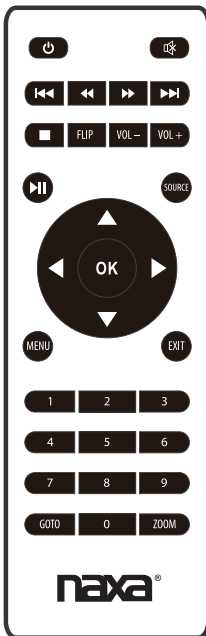

Mute

Press to mute volume.

◀◀ Back / Fwd ▶▶

Press to search through an individual chapter or track.

VOL+ / VOL-

Press to adjust audio level.

Source

Press to select media source (AV, PC, HDMI, MEDIA).

Exit

Press to exit menus.

Zoom

Press to zoom display image in or out.

Projector Overview

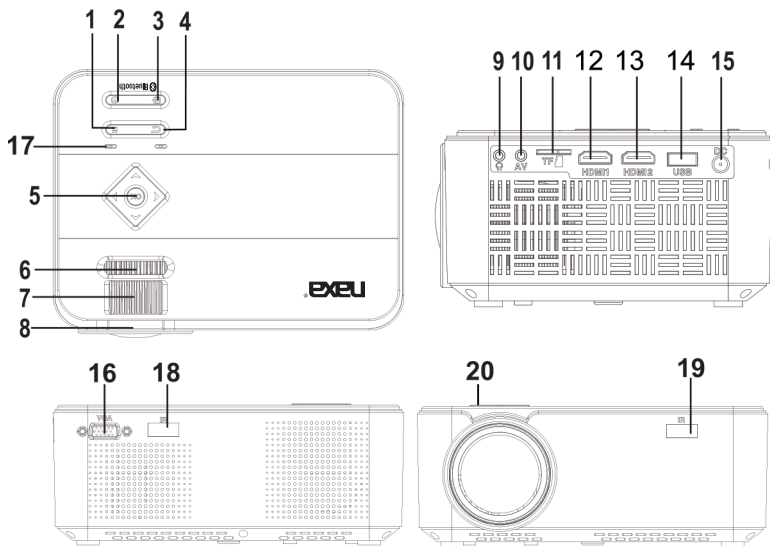

1. Menu Button
2. Power Button
3. Source Button
4. Return Button
5. Netvigator Button
6. Trapezoidal ADJ. Knob
7. Focus ADJ. Knob
8. Lens

12. HDMI Port 1
13. HDMI Port 2
14. USB Port
15. DC IN Jack
16. VGA Port
17. Power On Indicator
18. IR Window (rear side)
19. IR Window (front side)
20. Angel ADJ. Knob

Main Operation

 - Press the button to turn on unit, press again to turn off.

 / **SOURCE** - Press the button to select input source.

 / **MENU** - Press the button to enter projector menu.

 - Press the buttons to select screen item of projector menu.

 / **EXIT** - Press the button to exit the projector menu.

 - Press the buttons to fast search forward and rewind on USB / TF.

 - Press the buttons to search next or previous file on USB / TF.

VOL+ / VOL - Press the buttons to select correct sound.

 - Press the button to play/pause the connect USB / TF card.

FLIP ? Press the button to rotate / mirror projector screen

ZOOM - Press the button to select image scale.

 - Press to muting the audio sound of your projector. Press again to resume.

Bluetooth® Operation

Pairing is the term used when two Bluetooth devices are connected wirelessly for the first time. This allows the devices to see each other and sets up a one-to-one communication channel between both devices.

Bluetooth Connection

1. Press the Power button to turn on the unit.
2. Press the Menu button to enter the menu screen.
3. Use the left / right directional arrows to select right side menu.
4. Use the up / down directional arrows to select Bluetooth column.
5. Press the “OK” button to enter Bluetooth menu.
6. Use the left/right directional arrows to select “ON”.
7. Turn on your external Bluetooth speaker and select Bluetooth pairing mode.
8. A few seconds later, an audio sound will prompt to notify you that the projector and speaker are connected.
9. After connecting, the projector will sound through the external Bluetooth speaker.

NOTE: When the BT can't connect to this device automatically, please enter the Bluetooth setup menu and select to reset BT. Then, the BT device will connect to the projector automatically

Disconnecting Bluetooth Device

1. Press the Menu button to enter the menu screen.
2. Use the left / right directional arrows to select above menu.
3. Use the up / down directional arrows to select Bluetooth column.
4. Press the "OK" button to enter Bluetooth menu.
5. Use the left/right directional arrows to select "OFF" and disconnect Bluetooth.

HDMI Operation

HDMI offers superior sound and picture quality, and is the easiest way to play media from a computer, Blu-Ray player, or other device with an HDMI output.

Requires an HDMI cable (not included) and a device with an HDMI output.

1. Using an HDMI cable, connect the HDMI 1 or 2 Input on the projector to the HDMI output on your media player or computer.
2. Set the projector's Source to the connected HDMI Input and use the controls on the connected device to select and play media.

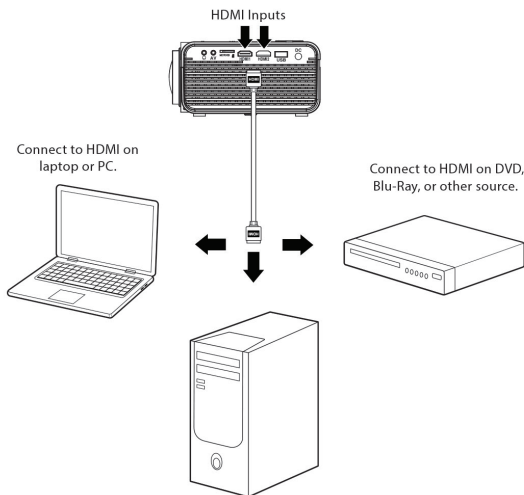

Audio / Video Input

Requires a 3.5mm to RCA audio / video cable.

1. Connect the 3.5mm to RCA audio video cable to the AV input on the projector.
2. Connect the 3.5mm to RCA audio / video cable to the RCA stereo audio outputs and composite video output on the media player.
3. Set the projector's Source to AV and use the control on the connected player to select and play media.

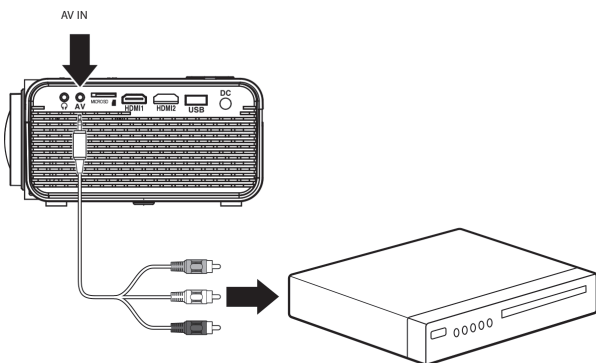

Connect AV cable (included) to media player's AV outputs.
Audio Left Channel - White
Audio Right Channel - Red
Video - Yellow

Computer Video (VGA)

NOTE: VGA connections do not support audio. You will need to use the computer's speakers to hear audio.

Requires a VGA cable (not included) and a desktop PC or laptop with a VGA output.

1. Using a VGA cable, connect the VGA Input on the projector to the VGA output on your computer.
2. Set the projector's Source to PC and use the controls on the computer to select and play media.

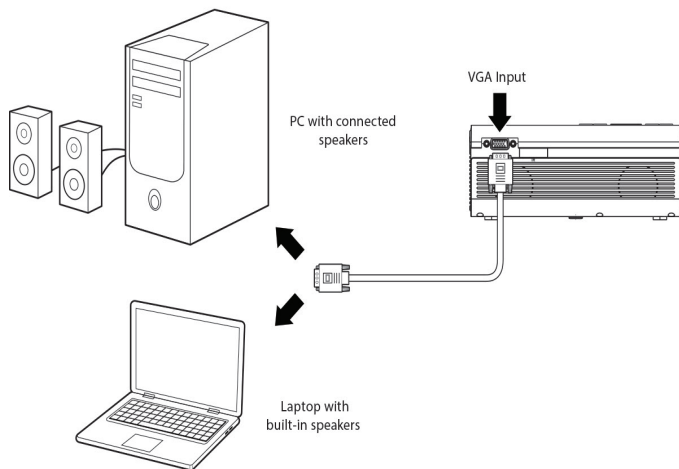

External Audio

NOTE: Speakers must have their own power supply.

Requires a 3.5mm to RCA audio / video cable.

1. Using a 3.5mm to RCA stereo cable, connect the external powered speakers to the headphone jack on the projector.
2. The projector will automatically detect the connection and send audio signal to the speakers.

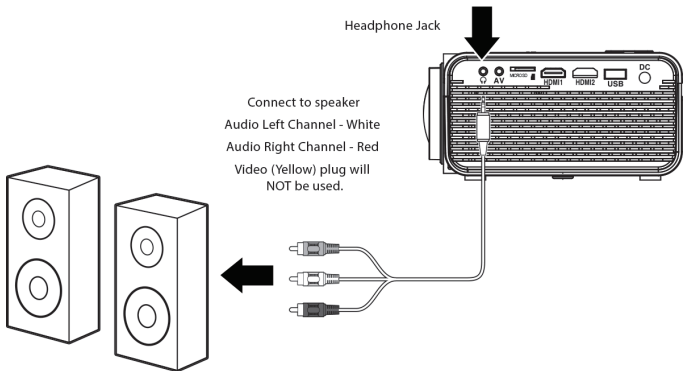

Micro SD & USB Inputs

Supports Micro SD cards and USB flash drives up to 32GB.

Supports AVI, MOV file formats.

1. Load a USB drive into the USB port.
2. Set the Source to Media Player, then use the arrow buttons to select “C:Drive” or “D:Drive” (C:Drive is the SD card, D:Drive is the USB).
3. Use the arrow buttons to select Music / Photo / Movie, then press the “OK” button to begin playing content from the connected storage device.

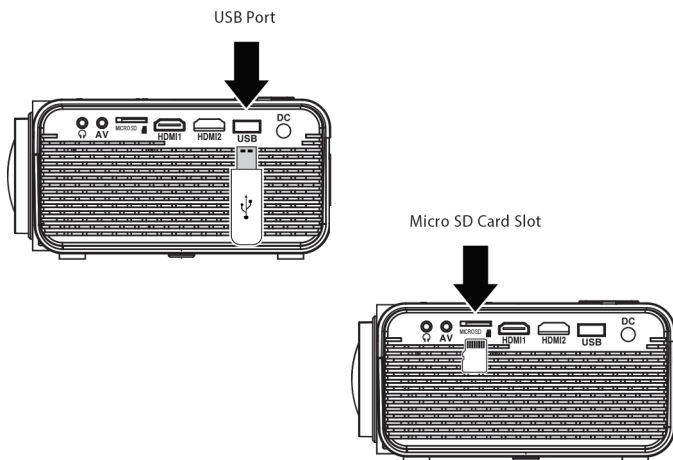

Specifications

Light Source Type	LED
HDMI Input Supported Video Resolution	1080p, 1080o, 720p, 576i, 480p, and 480i
Power Consumption	Operating 50W; Standby 0.8W
Power Input	DC 12V, 3.5A
Connect Included Adapter	
Included Adapter	Input: AC 100-240V, 50/60Hz
Connect DC Input of Unit	Output: DC12V, 3.5A
Display Color	16.7K
Projection Size	30-170 Inch
Signal Port	Video / VGA / HDMI / TF Card
USB Port	Supports USB device up to 10000 GB Supports mpeg1, Mpeg2, mpeg3, mp3, jpeg
Weight	0.9 KG
Dimension	203 x 150 x 82 mm

Support

If you have problems with your device, please consult the instructions in this manual. Please also visit us on the web at www.naxa.com to get up to the minute news, alerts, and documentation for your device. For additional assistance, please contact Naxa Technical Support.

NAXA Technical Support

2320 East 49th St. Vernon, CA 90058

http://www.naxa.com/naxa_support/

MADE IN CHINA