



INSTALLATION INSTRUCTIONS

Product
7160-1146

Revision
Rev.A

Form
INST-839

ZEBRA DOCK SCREEN BLANKING MOUNT

Printing Spec:PS-001

Attaching the Zebra dock screen blanking mount to the Zebra docking station:

1. Remove the new cable restraint bracket from the screen blanking assembly by removing the (2) #6-32 x 3/8" long mounting screws that hold it in place.
2. Replace the original cable restraint bracket on the Zebra dock with the new cable restraint bracket removed from the assembly in step 1. Attach using the (2) screws that held the original cable restraint on the dock.

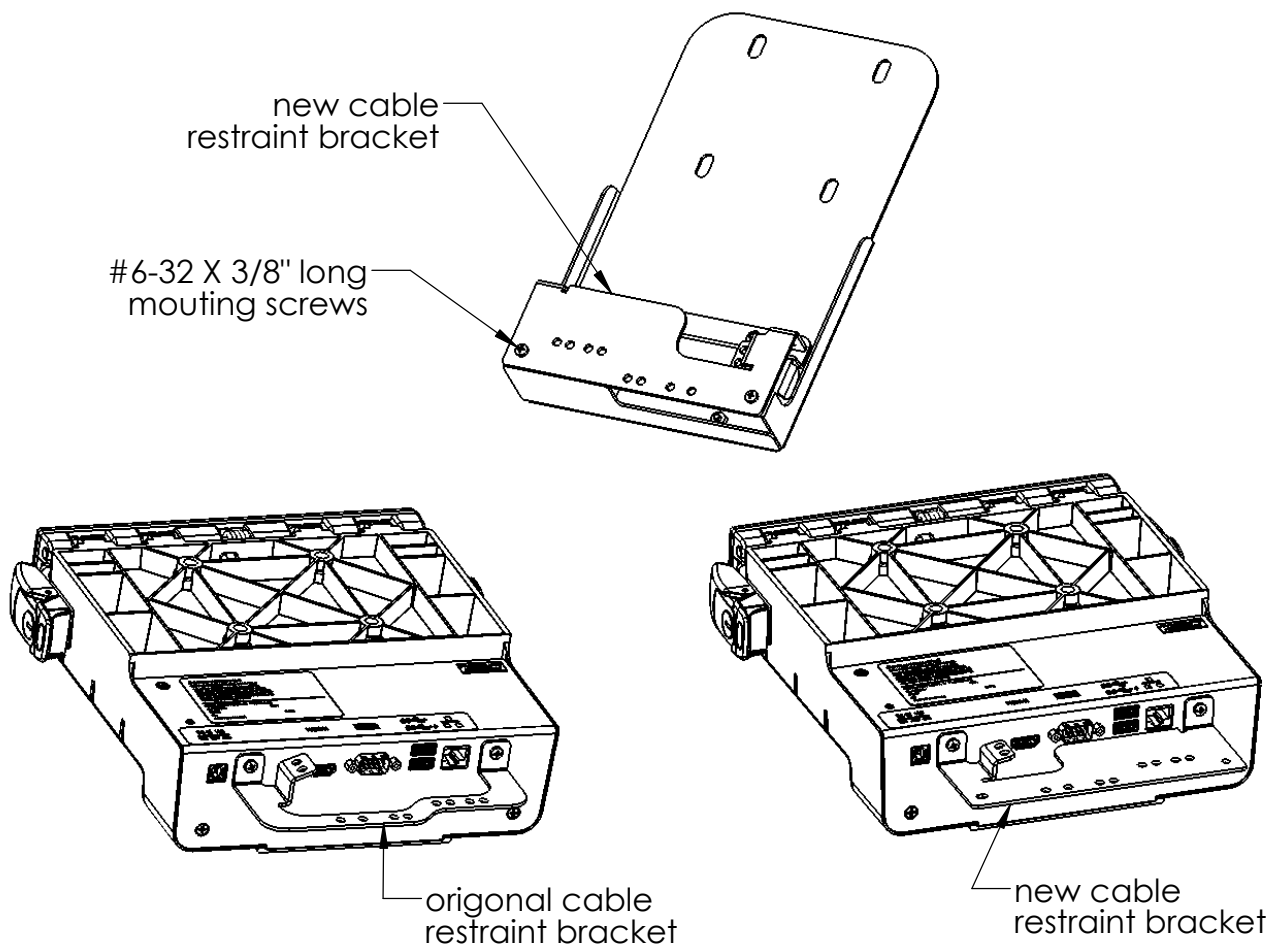

Product Mounting Disclaimer

Gamber-Johnson is not liable under any theory of contract or tort law for any loss, damage, personal injury, special, incidental or consequential damages for personal injury or other damage of any nature arising directly or indirectly as a result of the improper installation or use of its products in vehicle or any other application. In order to safely install and use Gamber-Johnson products full consideration of vehicle occupants, vehicle systems (i.e., the location of fuel lines, brakes lines, electrical, drive train or other systems), air-bags and other safety equipment is required. Gamber-Johnson specifically disclaims any responsibility for the improper use or installation of its products not consistent with the original vehicle manufactures specifications and recommendations, Gamber-Johnson product instruction sheets, or workmanship standards as endorsed through the Gamber-Johnson Certified Installer Program.

© Copyright 2017 Gamber-Johnson, LLC

If you need assistance or have questions, call Gamber-Johnson at 1-800-456-6868

3. Attach the accelerometer USB plug and any other peripheral cables to the docking station and cable tie in place. The USB and ethernet cables will need to be cable tied in a secondary location (ie. the serial port or HDMI location) since they need to be bent and routed over to come out the opening on the bottom side.
4. Attach the screen blanking assembly to the new cable restraint bracket with the (2) #6-32 x 3/8" long mounting screws that were removed in step 1.

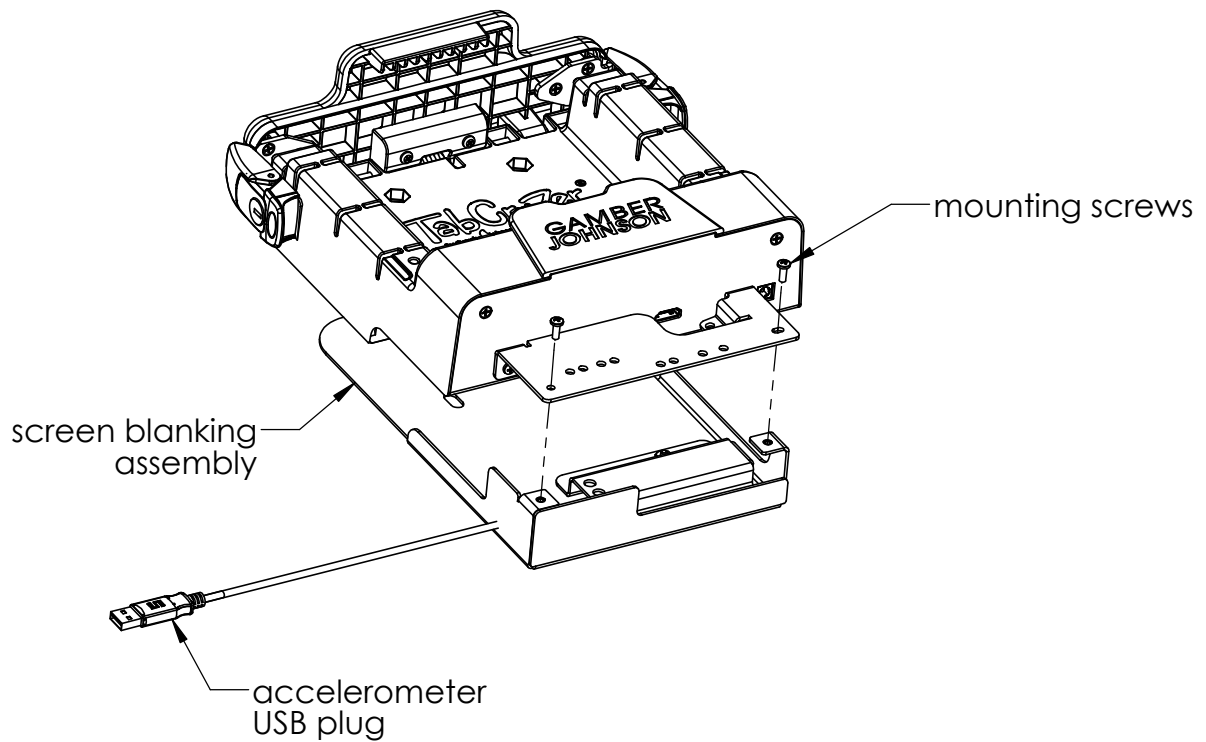

The dock (with the screen blanking assembly attached) can now be mounted using the mounting hardware typically supplied with the docking station.