

User's Manual

FVP-4000T

The default password is 0000.

For Your Safety

Safety Instructions

1. POWER SUPPLY

- Operate this product only from the type of power supply shown on the marking label. If you do not know the type of power supplied to your home, contact your local power company.
- Disconnect the power supply before you start any maintenance or installation procedures.

2. OVERLOADING

- Make sure that the wall outlet, extension cord and adapter have a sufficient power rating for the appliance. If not, this can cause an electric fire shock.

3. LIQUID

- Do not expose this product to liquids. Do not put objects filled with liquid on the product.

4. CLEANING

- Disconnect the product from the wall outlet before you clean it.
- Use a moist cloth to clean the product. Do not use solvents. Wipe the surface gently with a soft cloth as it may get scratched.

5. VENTILATION

- Make sure that the slots on top of the product are not blocked. It is necessary to have a sufficient airflow into the unit.
- Do not put electronic equipment on the product.
- Do not put objects on the product. This will block the ventilation or cause damage to the surface.

6. ATTACHMENTS

- Do not use any unsupported attachments as these may be hazardous or cause damage to the product.

7. LIGHTNING, STORM OR NOT IN USE

- Unplug the product from the wall outlet and disconnect the antenna during a thunderstorm or when left unattended and unused for long periods of time. This will prevent damage to the unit due to lightning and power-surges.

8. EXTRANEIOUS OBJECTS

- Do not insert anything through the openings in the unit, where they can touch dangerous voltage points or damage parts.

9. REPLACEMENT OF PARTS

- When replacement of parts is required, be sure the service technician uses replacement parts specified by the manufacturer or those that have the same characteristics as the original part. Unauthorised substitution may result in additional damage to the unit.

10. CONNECTION TO THE SATELLITE DISH/LNB/CABLE TV SIGNAL/AERIAL

- Disconnect the power supply before you connect or disconnect the cable from the satellite dish/cable TV signal/aerial. If not, this can cause damage to the LNB/cable TV line/aerial.

11. CONNECTION TO THE TV

- Disconnect the power supply before you connect or disconnect the cable from the TV. If not, this can cause damage to the TV.

12. LOCATION

- Place the product indoors to avoid exposure to lightning, rain or sun. Do not place it near a radiator or heat register.
- Keep at least 10 cm clearance from any other appliances susceptible to electromagnetic influences such as a TV or a VCR.
- If you place the product on a rack or a bookcase, make sure that there is adequate ventilation and that you have followed the manufacturer's instructions for mounting.
- Do not place the product on an unstable surface where it can fall. A falling product can cause serious injury to a personnel and serious damage to the appliance.

13. ENVIRONMENT

- Attention should be drawn to the environmental aspects of battery disposal.
- Care is required for the use of this apparatus in tropical and/or moderate climates.

Cautions and Warnings

1. TO AVOID DAMAGE OF POWER CORD OR PLUG

- Do not modify or process the power cord or plug arbitrarily.
- Do not bend or twist the power cord.
- Make sure to disconnect the power cord while you hold the plug.
- Keep heating appliances as far as possible from the power cord to prevent the cover vinyl from melting.
- The mains plug, as a disconnection device, shall remain readily accessible by the user.
- All-pole main switch shall remain readily operable. (For products with power switch)

2. TO AVOID ELECTRICAL SHOCK

- Do not open the main body.
- Do not insert metal or inflammable objects inside the product.
- Do not touch the power plug with wet hands.
- Disconnect the power cord in case of lightning.
- Unplug the power cable before you install the aerial cable.

3. TO AVOID DAMAGE OF PRODUCT

- Do not use the product when it is out of order. If you continue to use the product when defective, this may cause serious damage. Make sure to contact the customer service centre if the product is out of order.
- Do not insert metal or alien substance into the slots for the modules. It may cause damage to the product and reduce its life span.
- Do not overly pile objects on the product. It may cause cracks, deformation and discoloration.

4. TO AVOID DAMAGE OF HDD

- Do not move the product or turn the power off suddenly while the hard disk drive is running.
- The company shall not be liable for any corruption of data on the hard disk drive caused by carelessness or misuse of the user.

Contents

For Your Safety	3
Contents & Accessories	4
Contents	
Accessories	
Quick Start Guide	5
Product Overview	
Connections	
Remote Control Wizard	
Watching TV	9
Home	
Simple Guide	
Programme Detail	
Smart Search	
TV Guide	
Recording	15
Instant Recording	
Scheduled Recording	
Recording Conflict	
Playing Recorded Programmes	
Media Center	17
Direct Access to Media Files	
Playing Media Files	
Playing Files by Storage	

On Demand	21
Settings	22
General Settings	
Network Settings	
PVR Settings	
System Settings	
Channel Settings	
Appendix	27
Trouble Shooting	
HUMAX Customer Support	
Glossary	
Using the Universal Remote Control	
Open Source Software Notice	

Accessories

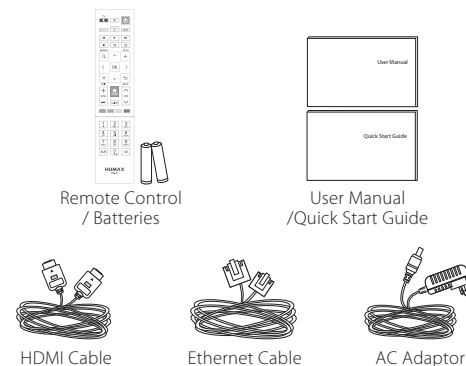

Note: Accessories may vary according to area.

Product Overview

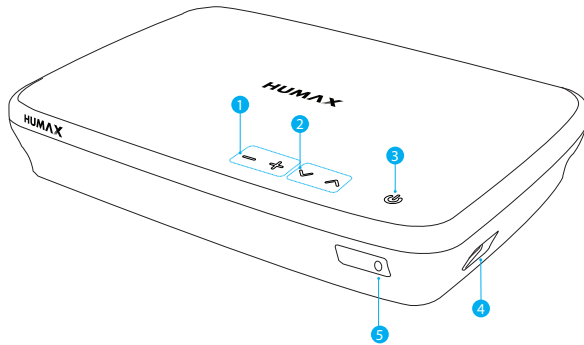

- 1 **VOLUME:** Changes the audio volume.
- 2 **CHANNEL:** Changes the channel or page.
- 3 **STANDBY:** Switches between operation and standby modes.
- 4 **USB:** Connect a USB memory device.
- 5 **LED:** Lights red in standby mode and blue in operation mode.

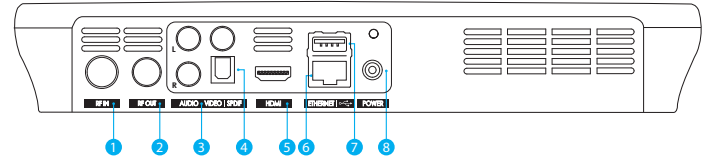

- 1 **RF IN:** Connect to a TV antenna.
- 2 **RF OUT:** Connect to the TV or VCR using an RF cable.
- 3 **VIDEO/AUDIO:** Use a RCA cable to connect to the TV.
- 4 **SPDIF:** Use an SPDIF cable to connect to the digital audio device.
- 5 **HDMI:** Use a HDMI cable to connect to the TV.
- 6 **ETHERNET:** Connect a LAN cable.
- 7 **USB:** Connect a USB memory device.
- 8 **POWER:** Connect the AC adaptor.

Note: The image may differ from the actual product.

Connections

This section describes how to connect your product to match your particular devices and to gain optimum signal quality.

Warning: Connect all devices before you plug any power cords into the wall outlet. Always turn off the product, TV and other devices before you connect or disconnect any cables.

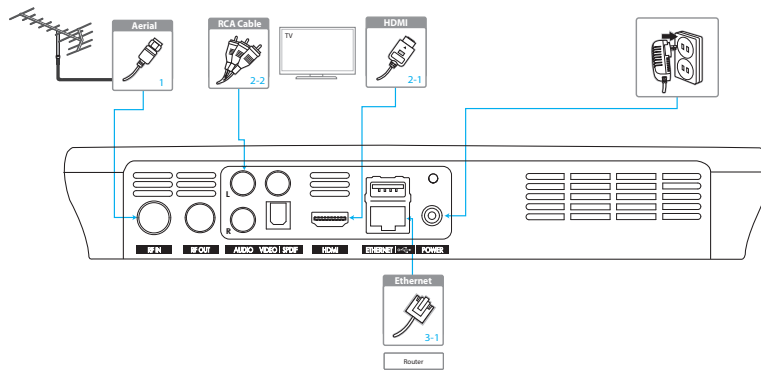

Note:

- If you encounter any problems setting up your product, please contact your local retailer or HUMAX Customer Service.
- Connecting your TV directly to the audio/video output of the product will assure a more vivid picture and enhance your viewing enjoyment.

HDMI CEC

HDMI CEC (Consumer Electronics Control) lets you to control the TV and HDMI CEC supported devices through the HDMI cable.

If your TV supports HDMI CEC, it will turn on or off automatically when the product is turned on or off.

Connecting the Antenna

Connect the aerial to the ANTENNA IN.

Connecting the TV

2-1 Using a HDMI cable

For the best picture quality, use a HDMI cable to connect to the TV.

2-2 Using a RCA cable

Use a HDMI or RCA cable to connect to your TV set.

- For the best quality, use a HDMI cable.
- Use a RCA cable if you do not have a HDMI connection on your TV set.

Connecting the Network

3-1 Connecting to the LAN

1. Use the Ethernet cable to connect the product and the LAN router.
2. Set the options for the LAN.
(Go to **HOME > SETTINGS > Network Settings** to set the network options)

3-2 Connecting to the Wireless LAN

Your product has a built-wireless network connection. Go to **HOME>SETTINGS> Network Settings>Configure WLAN** and set the options for the wireless LAN.

Note:

- We recommend the network connection over a direct LAN.
- Make sure that the distance between the Wireless LAN access point and the product is not too far away. This may lower the quality of service.

Remote Control

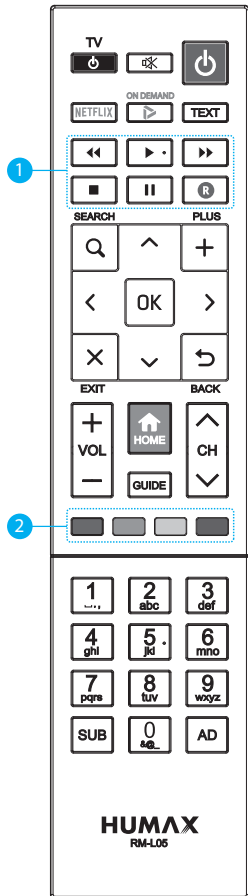

	TV STANDBY	Turns TV on/off
	TV AV	Switches the input source of the TV
	STANDBY	Switches between operation and standby modes
	ON DEMAND	Goes to ON DENAMD
	TEXT	Enters the digital text service
	MUTE	Mutes audio
1	Playback Control Buttons	◀◀ Fast Rewind, ▶ Play, ▶▶ Fast Forward, ■ Stop, Pause, Ⓜ Record
	SEARCH	Runs Smart Search
	PLUS	Displays option menus
	ARROW Buttons	Moves the cursor up, down, left or right
	OK	Selects a menu or confirms a selection
	EXIT	Exits all On-Screen Display (OSD) screens
	BACK	Returns to the previous channel or the previous screen
	VOL +/-	Changes the audio volume
	HOME	Displays the HOME menu
	GUIDE	Displays the programme guide
	CH ^/▼	Changes the channel or page
2	COLOUR Buttons	For interactive applications
	NUMERIC	(0-9)
	SUB	Sets the subtitle language
	AD	Displays the audio description

Inserting Batteries

Insert the batteries matching the plus(+) and minus(-) at each end.

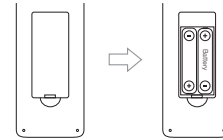

Note: If the remote control batteries are low, the **STANDBY** button and the **TV STANDBY** button will blink twice whenever you press the **HOME** button.

Wizard

The installation wizard operates automatically when you power on the product for the first time or do factory default in menu.

Note: If you exit the installation wizard without fully completing the channel searching procedure, you may not have all of the channels available. In this case, go to **HOME>SETTINGS>Channel Settings>Search Channels** and search for more channels.

1. Preferred Language

Select a language for audio and subtitles and press the **OK** button.

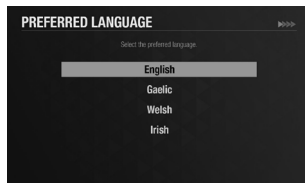

2. Network Connection

Make sure that the LAN cable is connected to the Ethernet port or the wireless LAN is connected. Configure the network setting.



3. Privacy Policy

Agree or disagree to share anonymous data about how you use your products.

If you agree, this is very helpful for us to make better products.

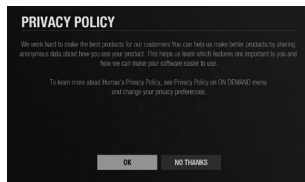

4. Channel Search

Set the search options and then search channels. You can search channels automatically or manually. Save the found channels when the search is complete.

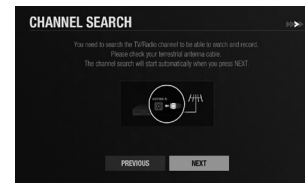

5. Quick Booting Mode

Set to **On** to decrease the standby power consumption.



6. Result

The result of the installation wizard will show. Select **EXIT**.

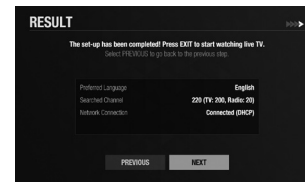

Home

You can go to the home menu by pressing the **HOME** button wherever you are. From the home menu, you can reach On Demand, TV Guide, Recordings, Media Center, and Settings.

- To see the recent list, press the **▼** button.
You can easily go to the recently accessed contents or menus.

Simple Guide

You can change channels, see what's on later or watch catch-up programmes when available.

- Press the **OK** button while watching live TV to display Simple Guide.
- Press the **▲/▼** arrow buttons to display a channel list.
- Press the **EXIT** button to hide the Simple Guide.

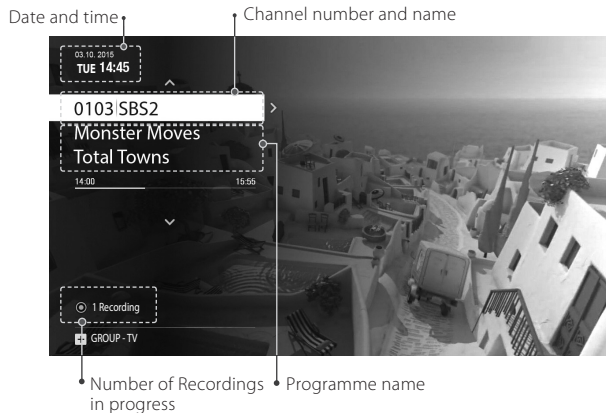

Watching Live TV

- When you have selected a programme from the Simple Guide press the **OK** button to change to that channel.
- You can also enter the channel number directly.

Pausing and Rewinding Live TV (TSR)

Time Shifted Recording (TSR) allows you to pause a live programme and return later where you left off. The TSR function temporarily records the programme you are watching to the hard disk drive automatically for up to 2 hours.

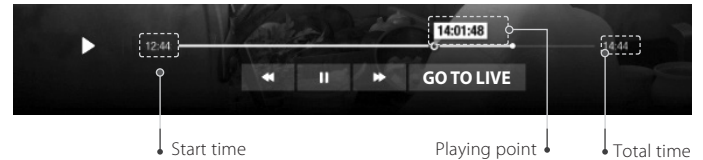

Note:

- Pausing Live TV will work after 10 seconds of changing to a channel.
- Each time you change channels the TSR will clear and start again

To pause the programme

1. Press the **PAUSE** button.
2. Press the **PLAY** button to watch from the pausing point.
Pressing Pause starts a time gap between Live TV and the point you pressed pause.

To watch missed scenes

1. Press the **FAST REWIND** button.
2. Press the **PLAY** button at the point where you want to start watching.

To skip scenes

Press the **FAST FORWARD** button when there is a time gap between the current watching point and the live broadcasting point. If you reach the live broadcasting point while fast forwarding, the programme automatically plays at normal speed.

Setting TV Options

- Press the **PLUS** button while watching live TV to change the resolution, display format, switch on audio description, and subtitles.
- Press the **SUB** button to switch on subtitles.
- Press the **AD** button to switch on audio description.

Changing Channel Group

1. Press the **OK** button while watching live TV to display Simple Guide.
2. Press the **PLUS** button.
3. Select a channel group and press the **OK** button.

Seeing What's On Later

1. Press the **▶** arrow button to see what's on later.
2. Select a programme and press the **OK** button.
Programme detail appears. You can set recordings or reminders.

Watching Catch-Up Programmes

Press the **◀** arrow button to watch catch-up programmes.
Catch-up programmes are accessible only when the network is connected and that programme is available on Catch-up from the broadcaster.

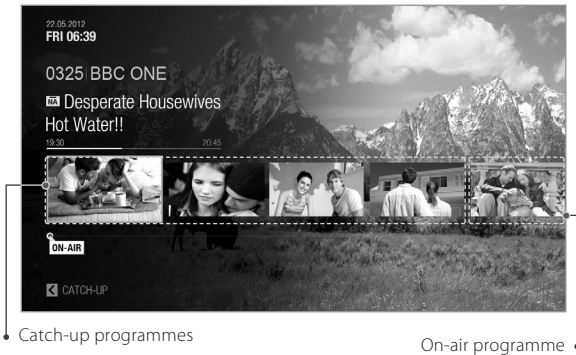

Programme Detail

- To find out more about the programme you are watching, press the **OK** button.
- Press the **OK** button again to display programme detail. You can watch an episode of a catch-up programme or set reminders or recordings for future programmes.

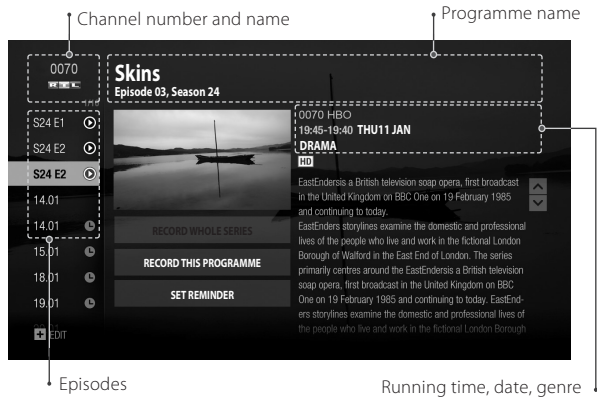

Episode Icons	
	Reminder (blue), Scheduled recording (red)
	Playback possible
	Recording in progress
	Series recording
	Daily
	Weekly

Programme Icons	
	HD programme
	Parental guidance programme
	Blocked by digital recording management
	Encrypted programme
	Locked programme
	Dolby digital plus
	Dolby Digital
	Programme with audio description
	Programme with subtitle
	Split programme

Smart Search



You can search your favourite programmes by entering a keyword.

- Press the **SEARCH** button and then enter a keyword.

Note: Enter at least three characters to search programmes or media files. If you enter less than three characters, channels and Apps are searched.



TV Guide

You can see the programme schedule of each channel, and schedule recordings or reminders for future programmes.

- Press the **GUIDE** button.
- Use the arrow buttons on the remote control to navigate in the Guide.
- Select a programme from next or catch-up programmes and press the **OK** button to display the programme details.

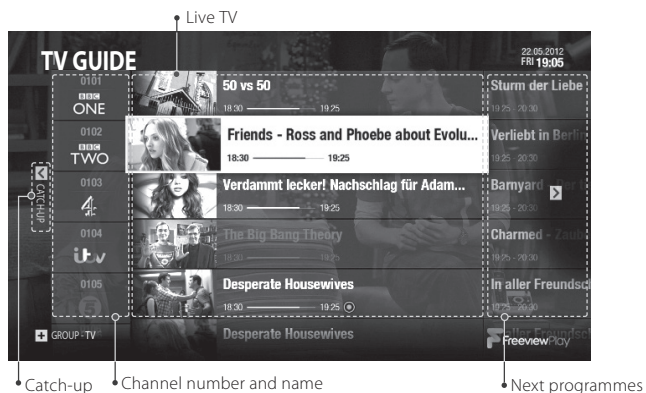

Seeing What's on Later

Press the **▶** arrow button to see the next programmes.

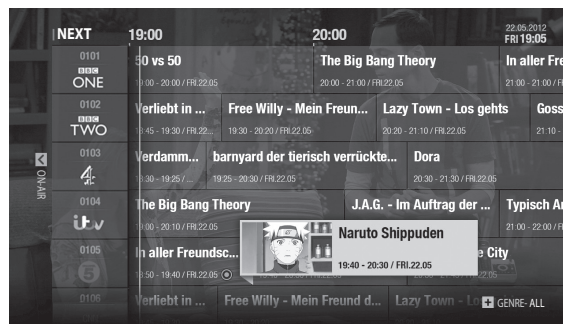

Setting Reminders or Recordings

1. Select a programme and press the **OK** button.
2. Select an episode in the left column.
3. Select **RECORD WHOLE SERIES**, **RECORD THIS PROGRAMME** or **SET REMINDER** and press the **OK** button.

	Reminder (blue)		Recording in process
	Recording (red)		Series recording

Note:

- If the programme conflicts with another programme, adjust the scheduling appropriately. See page 16 for more information.
- If the channel is locked, you will be prompted to enter your password. The default password is 0000. If you have forgotten your password, please contact your local distributor.

Changing Programme Genre

- Press the **PLUS** button when the cursor is on a next programme.
- Select a genre and press the **OK** button.

Watching Live TV

Select a programme and press the **OK** button or enter the channel number directly.

Note: Press the **CH/V** button to change a page.

Changing Channel Group

1. Press the **PLUS** button.
2. Select the channel group and press the **OK** button.

Quick Navigation

1. To move to a certain date, long press the **◀/▶** arrow buttons.
2. Select a date and press the **OK** button.

Watching Catch-Up Programmes

1. Press the ◀ arrow button to go back in the Guide to see programmes available in Catch-Up.
2. Select a programme and press the OK button.
If the programme has been recorded or is available on Catch-Up you can play it back.

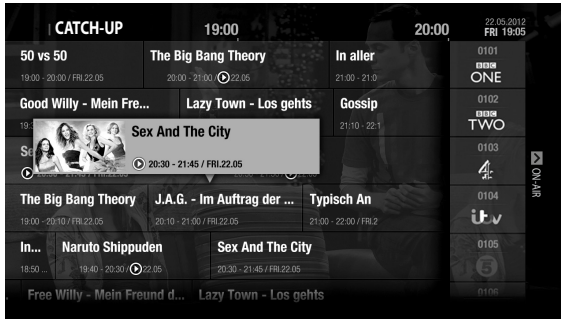

Note: Not all programmes will be available from the broadcasters on Catch-up.

Recording

You can record programmes instantly and schedule recordings in **TV Guide**, **Programme Detail** or **Recordings**. You can record up to four programmes at once while watching a different channel live.

Note: When recording four programmes you may have a limited number of channels you can view Live. Visit www.humaxdigital.com/uk/support for more information.

Instant Recording

Press the **RECORD** button to record the current programme. Press the **STOP** button to stop recording.

Extending recording duration

1. Press the **RECORD** button while the channels is recording.
2. Set the duration manually or select till the end of the current or next programme.

Note:

- Recording will continue until the end of the current programme. If it ends within ten minutes, the recording will continue until the end of the next programme.
- Recording continues for two hours if there is no programme information.

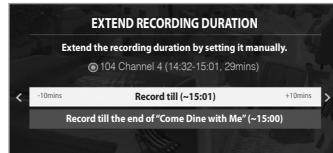

Scheduled Recording

You can schedule recordings in TV Guide, Programme Detail and Recordings.

TV Guide

Press the **HOME** button and select **TV GUIDE**.

Select a future programme and press the **RECORD** button.

Note: See page 13 for scheduling recordings or reminders in **TV GUIDE**.

Programme Detail

Press the **▶** button while watching a programme.

Select a future programme listed on the left to record and press the **OK** button.

Select a recording option.

Recordings

You can schedule recordings or reminders manually.

1. Press the **HOME** button. Select **RECORDINGS** and **SCHEDULE**.
2. Select **ADD A SCHEDULE**.
3. Set a schedule manually.
4. Select **OK** and press the **OK** button.

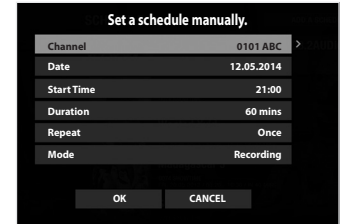

Editing Schedule

You can delete or reschedule the scheduled programmes.

1. Press the **HOME** button. Select **RECORDINGS** and **SCHEDULE**.
2. Select a scheduled programme.
3. Press the **PLUS** button.
4. Select **Delete** or **Reschedule**.

Note: You can set the padding time to record programmes with extra recording time. Go to **HOME > SETTINGS > PVR Settings > Recording Options**.

Recording Conflict

Recording Conflict

A recording conflict occurs:

- **Case 1** when you try to start a new recording while recording.
- **Case 2** when a new recording conflicts with the previously scheduled recordings.

Select one of the recordings to cancel.

Tuning Conflict

A tuning conflict occurs when a scheduled recording is about to start while you are watching another channel.

A record notice will pop up 30 seconds before the scheduled recording starts.

- **YES:** The channel will change at the start time and the recording will start.
- **NO:** The scheduled recording will be cancelled.

Playing Recorded Programmes

You can play the recorded programmes in **RECORDINGS**.



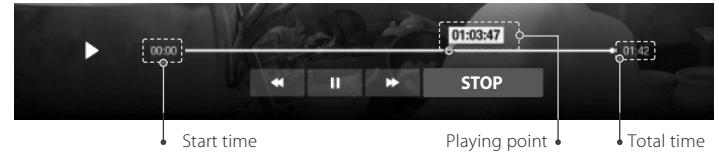

The recordings are categorised by groups, **PROGRAMME, CHANNEL, DAY OF WEEK** so that you can find the recordings you want easily.

Playing Recordings

1. Press the **HOME** button. Select **RECORDINGS**.
2. Select a recording and press the **OK** button.
3. Select **PLAY THIS PROGRAMME** and press the **OK** button.
You can delete the recording or record whole series if the programme is part of a series.
4. Press the **OK** or **PLAY** button during playback, the play bar appears.



Playback Controls

	Play		Fast rewind
	Pause		Fast forward
	Stop		

- **Fast Rewind / Fast Forward:** When the time bar is on screen, press the **◀/▶** button to scroll back or forward quickly.
- **Skip Backward / Skip Forward :** When the time bar is on screen press the **</>** button to skip backwards or forwards.

Media Center

You can play video, music, photo files from the connected storage devices or home network devices on your TV. Make sure that the USB storage device or network is connected correctly.

Press the **HOME** button. Select **MEDIA CENTER**.

Direct Access to Media Files

1. Select **VIDEO**, **PHOTO** or **MUSIC**.
2. Select a storage or network server.
The recently played files appear.

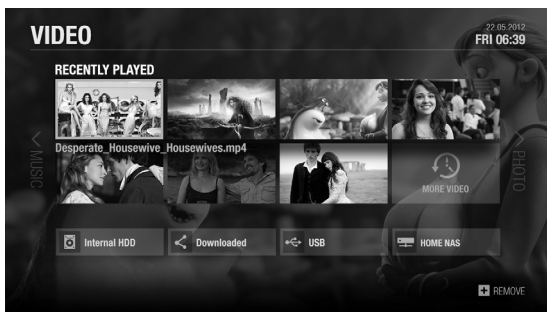

Note:

- You cannot play the recently played files from the external storage which is already disconnected.
- HUMAX is not responsible for any data loss or file damage.
- Some playback control buttons may not function depending on the contents.

Note: Certain files may not play depending on file formats or video and audio codec.

Playing Media Files

Playing Video

Select a video file and press the **OK** button.



	Play		Fast rewind
	Pause		Fast forward
	Stop		

Changing Subtitle Option

1. Select **SUB** and press the **OK** button when the play bar is on the screen.
2. Set the subtitle option.

Note: Subtitle may not be available for some video files played over the network.

Playing Photo

Select a photo file and press the **OK** button. Photo slideshow starts.



	Play		Pause
	Exit slideshow		Play mode

Changing Play Mode

You can set the slideshow speed or background music during slideshow. Press the **PLUS** button.

- **Slideshow Speed:** Select the display time per photo in slideshow.
- **Music Play:** Select **On** to play music files during slideshow.

Playing Music

Select a music file and press the **OK** button. All files in the group will play successively.

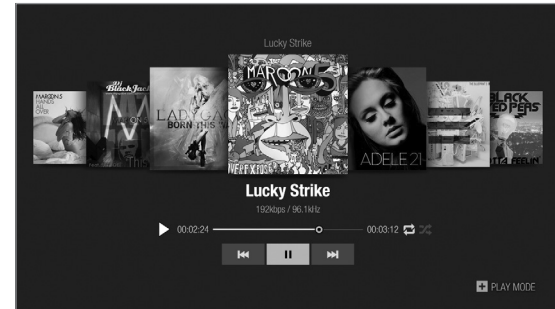

	Play		Pause
	Exit music player		Play mode

Changing Play Mode

You can set the slideshow speed or background music during slideshow. Press the **PLUS** button.

- **Repeat Option:** Set the repeat option in the playlist.
- **Play Mode:** Select **Normal** or **Shuffle**.

Editing Files

You can delete, copy, move files and change the storage. Select a file and press the **PLUS** button.

Delete	Delete the file.
Copy	Copy the file to the storage you want.
Move	Move the file to the storage you want.
Select	Select a file.
Select All	Select all files.

Note:

- When you copy or move a file to an external storage device, the file is copied to its root folder.
- Files may not be copied or moved if the storage is full or the file size is too large.
- Files on a network server cannot be edited.

Playing Files by Storage

Playing Files from Storage Device

You can play files from the storage devices such as internal or external HDD and USB storage devices.

1. Select a storage device.
2. Select **VIDEO**, **MUSIC** or **PHOTO**.
3. Select files you want to play.

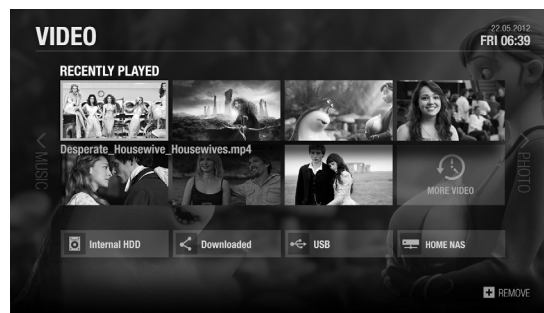

Note:

- Do not disconnect the USB storage device during playback, the files or the USB storage device may be damaged.
- It is recommended to use the USB storage devices requiring external power supply.
- If the USB storage device is connected in standby mode, it will automatically be recognized when the product is turned on.
- HUMAX cannot guarantee compatibility with all USB storage devices and assumes no responsibility for any loss of data.

Playing Files from Home Network Devices

Your HUMAX product is a home network device capable of sharing media files with other home network devices such as the PC, NAS or another HUMAX PVR when they are connected to the same home network.

You can play the video, music or photo files saved in your home network devices on your product when the home network device is connected to the same home network.

Connecting to Home Network

1. Press the **HOME** button. Select **SETTINGS > Network Settings**.
2. Set the options for the LAN or Wireless LAN.

Note: See page 23 for connecting to the network.

Playing Files from Home Network Devices

1. Select a home network device.
2. Select **VIDEO**, **MUSIC** or **PHOTO**.
3. Select files you want to play.

Note:

- The list of supported home network media servers will appear automatically.
- Home network media server software such as Window Media Player 12 must be installed and executed on the PC to share media files stored in the PC. The media files must be stored in the library folder of the PC.
- Refer to the instructions of your operating system for setting up home network server.

Playing Files from SAMBA Server

1. Select a **SAMBA** server.
2. Enter the ID and Password of the PC to access to the shared folders.
3. Play the files from the SAMBA server on your TV.

Note: Make sure that the settings in your Windows7 PC is ready to connect to the SAMBA server. Refer to the instructions of your operating system for setting up SAMBA server.

ON DEMAND

You can download TV Apps from App Market and enjoy them on your TV.
Press the **HOME** button. Select **On Demand**.



Note:

- Apps may differ depending on the region or service providers.
- You may need to agree to Privacy Policy before using certain Apps.
- TV APPS are subject to change without notice. HUMAX is not responsible for the content or the discontinuity of the services.

General Settings

Press the **HOME** button. Select **SETTINGS** and then **General Settings**.

Parental Control

- **Guidance Policy:** You can set the guidance on the recordings or Internet contents during the watershed which is the time period (21:00 to 05:30) for adult contents.
- **Change Password:** Enter a new password.
- **Block Channel Settings:** Set On if you want to block access to the Channel Settings you have previously made.

Note:

- Enter the password to view the blocked programmes.
- The default password is 0000. If you have forgotten your password, please contact your local distributor.

Language Setting

You can set the preferred language for audio and subtitle.

Video Setting

You can set the screen ratio, display format and screen resolution.

Audio Setting

- **S/PDIF:** You can select the digital audio signal output.
- **HDMI:** You can select the digital audio signal for HDMI output.
- **Audio Description:** You can set to narrate the on-screen visuals which is used for visually impaired viewers.
- **Lip-Sync Delay:** You can adjust the sound difference between audio and video.

Note: Not all channels will provide audio description. For further information, contact the broadcaster.

On-Screen Display

- **Info Display Time:** You can set the duration the Simple Guide is displayed whenever you change the channel.
- **Subtitle Display:** You can set to display the subtitle automatically or not.
- **Hard of Hearing:** You can set to show the closed captions.
- **Subtitle Font:** You can set the subtitle font.

Privacy Policy

You can agree or disagree to send HUMAX your watching information. Your watching information will be helpful for HUMAX to improve both product and service.

Network Settings

Press the **HOME** button. Select **SETTINGS** and then **Network Settings**.

Configuring LAN

1. Select **Configure LAN**.
2. Select your IP configuration type between **DHCP** and **Manual**.
 - **DHCP**: If you use a router or modem that has a DHCP (Dynamic Host Configuration Protocol) server function, select **DHCP**. The IP address will automatically be determined.
 - **Manual**: If there is no DHCP server on the network and you want to set the IP address manually, select **Manual**. Enter the values for IP Address, Netmask, Gateway Address and DNS Address.
3. Select **APPLY** to connect to the selected network and press the **OK** button.

Note:

- When entering the IP address manually, enter 3 digits in a row.
- The network is connected by wired LAN when both wireless and wired LAN are activated.
- HUMAX recommends the network connection over a wired LAN.

Configuring Wireless LAN

1. Select **Configure WLAN**.
2. Select the wireless LAN network and press the **OK** button.
3. Press the **BACK** button to save.

Note: If you choose a locked wireless network, you need to enter the password to proceed. The network password is case-sensitive and cannot contain spaces.

Network Connection Status

You can view the connection status of the local area network or the Internet. Select **RETRY** if either network is disconnected.

Network Server

- **Network Server**: Set to **On** to share the live broadcast, recordings and media files saved in the internal HDD with other products that support home network-Digital Media Player.
- **Rename Server**: Enter a new name to change the server name.
- **Server Status**: You can see the information on network servers.

File Share

- **SAMBA Server**: When **SAMBA Server** is set to **On**, the internal HDD can be accessed as a network disk drive from your PC. You can copy the video, music, photo files in the internal HDD to the PC storage.
- **FTP Server**: When **FTP Server** is set to **On**, you can copy the video, music, photo files in the internal HDD to the PC storage using the FTP client programme.
- **Password**: If Password is set, you can access the internal HDD only by entering the password.
- **Download Folder**: When **Download Folder** is set to **Enable**, you can copy the video, music, photo files in the PC to the download folder in the internal HDD.

PVR Settings

Press the **HOME** button. Select **SETTINGS** and then **PVR Settings**.

IP EPG

Set to **On** to enjoy advanced EPG services over the Internet.

Recording Options

- **Start Padding Time / End Padding Time:** You can set the recording padding time to add extra recording time to the start and end of all your scheduled recordings.
Note: The start and end times set will override the broadcast Accurate recording.
- **Auto Delete:** Set to **On** to add old recordings to the list of **TO BE DELETED**.

Playback Options

- **Series Play:** Set to **On** to play back all episodes of a programme successively.
- **Instant Replay Time:** Select the replay time.
- **Skip Forward Time:** Select the skip time.

Storage

You can check the capacity of each storage or format the storage when necessary.

- **Internal HDD:** Run the HDD test or format the storage.
- **External Devices:** To remove the storage, select **Remove Storage Safely** first.

Note: All data in the storage will be deleted after formatting.

System Settings

Press the **HOME** button. Select **SETTINGS** and then **System Settings**.

System Information

You can view the system information. Select **CHECK NEW SOFTWARE** to see if new software is available.

Power Timer

You can set the time the product powers on or powers off.

Power Management

- **Automatic Power Down:** Select **On** to enter standby mode automatically if no user interaction occurs for 3 hours.
- **Power Saving in Standby:** Select **On** to reduce the power consumption in standby to below 0.5W.

Note:

- A message will display 2 minutes before the product enters standby mode. If you ignore this message, the product enters standby mode automatically.
- When set to **On** the product will not supply the loop through aerial signal to any connected device.

Factory Default

You can restore your receiver to factory settings.

Shortly after you complete the factory default, the installation wizard will appear automatically.

Warning: Note that once you perform factory default, all user configured data will be reset.

Channel Settings

Press the **HOME** button. Select **SETTINGS** and then **Channel Settings**.

Setting Favourite Channels

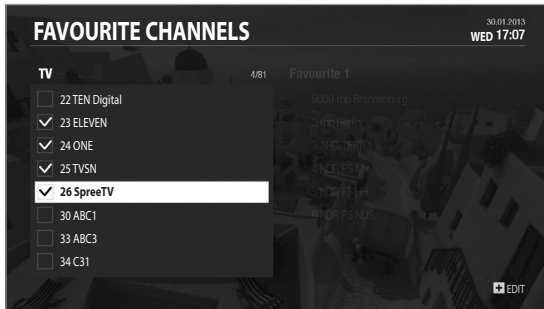

Note: Press the **EXIT** button to exit. Press the **BACK** button to return to the previous screen.

Select the channels from the left column and press the **PLUS** button.

Add to favourite	Add to favourite channels.
Change Group	List channels in another channel group.
Select / Deselect All	Mark or release all channels.

Select the channels from the right column and press the **PLUS** button.

Remove	Remove from favourite group.
Move	Move the channel in the favourite group.
Change Favourite	Change to another favourite group.
Rename Favourite	Rename the favourite group.
Select / Deselect All	Mark or release all channels.

Editing Channel List

You can delete, lock or rename channels in the channel list. Select a channel and press the **PLUS** button.

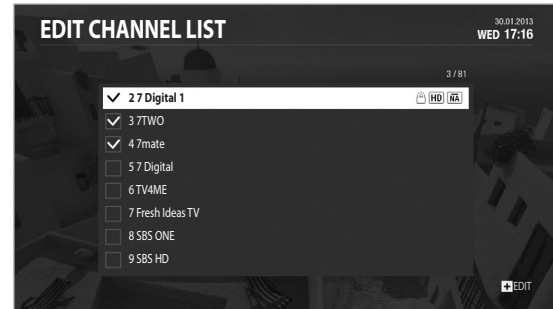

Delete	Delete channels from channel list.
Lock/Unlock	Lock channels to block access.
Rename	Change channel name.
Select/Deselect All	Mark or release all channels.
Change Group	To list the channels of another favourite group, press the PLUS button and select Change Favourite . Select the group and press the OK button.

Signal Test

You can check the signal strength and quality of the searched channels.

Automatic Channel Search

You can search channels automatically without entering any other information. When the channel search is complete, select **SAVE** and press the **OK** button to save the results.

Note: Select **STOP** and press the **OK** button to stop the channel search. The searched channels will remain.

Manual Channel Search

You can search channels manually by searching parameters.

- **Channel:** Select the channel.
- **Frequency:** Enter the frequency. The corresponding frequency value will be automatically displayed.
- **Transmission:** Select **DVB-T** or **DVB-T2**.
- **Bandwidth:** Select the bandwidth.
- **Network Search:** Select **On** or **Off**.

Trouble Shooting

Before contacting the customer service center, make sure to read the tips below carefully. If the problem persists after you complete the following procedure, please contact HUMAX customer service for further instructions.

General

Problem	Possible Cause	What to Do
No red or blue LED on the front panel of the product	Mains adaptor unplugged. Mains socket switched off.	<ul style="list-style-type: none"> • Check the main power cable and make sure it is plugged into a suitable power outlet. • Connect the power cable to a different power outlet.
No picture (Nothing shows on the TV)	HDMI cable not securely connected. TV Set not on correct Input / Source	<ul style="list-style-type: none"> • Make sure that the product is powered on and in operation mode. • Make sure that the AV or HDMI cable is firmly connected to the TV. • Check if the channel is currently on air. • Check that you TV is on the correct input / source for the HDMI / AV connection (refer to your TV manual for more details on how to change the input / source). • Check the brightness of the TV.
No picture (No channels)	Aerial is disconnected. Aerial is damaged/misaligned. Out of digital signal area. Aerial not positioned correctly.	<ul style="list-style-type: none"> • Make sure that the product is powered on and in operation mode. Press the STANDBY button. • Make sure that the AV or HDMI cable is firmly connected to the TV and the product. • Make sure that the aerial cable is properly connected to the product. • Press the Input or Source button on the TV remote and select AV or HDMI mode depending on how your product is connected to the TV. • Search channels again. Go to HOME > SETTINGS > Channel Settings > Automatic Channel Search. • Check if the channel is currently on air.
Poor Picture Sound quality	Electro magnetics from electronic devices around the product can cause the issue. Poor/faulty HDMI cable	<ul style="list-style-type: none"> • Make sure there is no mobile phone or microwave oven near the product. • Keep the power and the RF cables apart from each other. • Adjust the antenna direction to get a better picture. <p>Note: If the antenna is covered with snow, the RF is weakened by heavy rain, or the aerial position is changed by strong wind, the condition of the sound and picture may temporarily be poor. However, the poor sound and picture quality due to weather conditions cannot be accepted as a malfunction of product.</p>

Problem	Possible Cause	What to Do
No sound	AV/HDMI cables are not connected properly or faulty. Volume is set to minimum or mute.	<ul style="list-style-type: none"> • Check that your AV or HDMI cable is connected correctly. • Check the volume levels of your TV and the product. • Check if the product or TV is on mute. • Check audio type or soundtrack option. (where applicable)
No volume control on HD channels	Check the HDMI Audio setting	<ul style="list-style-type: none"> • Go to HOME > SETTINGS > General Settings > Audio Setting - change the HDMI audio setting to Stereo.
No response to remote control	Low batteries	<ul style="list-style-type: none"> • Remove and reinsert the batteries in the remote control. • Replace the batteries in the remote control for a new set.
No password information		<ul style="list-style-type: none"> • The default password is always 0000.
Channel search does not work	Aerial is disconnected. Aerial is damaged/misaligned. Out of digital signal area. Aerial is not positioned correctly.	<ul style="list-style-type: none"> • Make sure that the aerial cable is properly connected to the product. • [Terrestrial] Use the appropriate aerial capable of receiving VHF or UHF channels for your area.
Cannot update the new software	Network is not set up.	<ul style="list-style-type: none"> • Check if the network is configured properly. You can check the network connection status by going to HOME > SETTINGS > Networks Settings > Network Connection Status. Note: If your product stays connected to the network, everytime you turn off the product it will search for any updates available on air. • To manually search for any updates available, go to HOME > SETTINGS > System Settings > System Information and then select CHECK NEW SOFTWARE. • To update the software via USB, <ol style="list-style-type: none"> 1. Download the latest software version and save it to an empty USB memory stick. 2. Please make sure the software is saved in the root of the USB stick. 3. Insert the USB memory stick into a rear USB port of the product. 4. Go to Home > Settings > System Settings > System Information and press the OK button on Check New Software. 5. When the download progress stops it may take up to 5 minutes for it to restart so 'DO NOT TURN OFF the product' 6. To confirm successful update, please go to Home > Settings > System Settings > System Information and check Software Version.
Randomly Shuts itself off	Automatic Power Down Option On Timer is set	<ul style="list-style-type: none"> • Go to HOME > SETTINGS > System Settings > Power Management and then check if Automatic Power Down is set to On. • Go to HOME > SETTINGS > System Settings > Power Timer and then check if Power Off Timer is set to On.

Appendix

Recordings

Problem	Possible Cause	What to Do
Cannot schedule recordings or reminders	Conflict of recordings	<ul style="list-style-type: none">• Check that there is a previous schedule conflicting with a new schedule. Cancel one of the schedules.• This product has 3 tuners. This allows you to record up to 4 different channels and watch another program. There may be limitations on the 4th channel you can record or the live TV channel you try to view depending on the channels you are recording.
Cannot record programmes	Full HDD Conflict of recordings	<ul style="list-style-type: none">• The hard disk is full. Delete unnecessary programmes and make space for new recording.• Check if recording conflicts with another channel. Stop the current recording or wait until the recording is finished.• Check that the product is switched on when recording starts.• If you are missing first or end bits of the program, set the padding time. Go to HOME > SETTINGS > PVR Settings > Recording options and set the padding times.• Check if your product recognizes problems with the HDD. Go to HOME > SETTINGS > PVR Settings > Storage, select the storage, and run the HDD test.
Cannot change channels while recording.	Conflict of recordings	<ul style="list-style-type: none">• This product has 3 tuners. This allows you to record up to 4 different channels and view a 5th Live TV channel. The 4th channel recording and the 5th you are trying to view maybe limited to channels being in the same broadcast groups as the first 3 programmes you have set to record.
How to set the padding time		<ul style="list-style-type: none">• If you are missing first or end bits of the programme, set the padding time. Go to HOME > SETTINGS > PVR Settings > Recording Options and set the padding times.
How enter passive mode		<ul style="list-style-type: none">• Go to HOME > SETTINGS > System Settings > Power Management and set Power Saving in Standby to On.

Playback

Problem	Possible Cause	What to Do
How to edit recorded programmes		<ul style="list-style-type: none">• Go to HOME > RECORDINGS and select a file. Press the PLUS button and delete. If you want to delete more than 1 programme, press the PLUS button and select Select. You can mark files and then delete, copy or move the multiple files.
How to edit media files?		<ul style="list-style-type: none">• Go to HOME > MEDIA CENTER and select Internal HDD. Select a file and press the PLUS button. You can delete, copy or move the file.

Appendix

Problem	Possible Cause	What to Do
Does not recognize larger external HDDs.	HDD capacity is too large.	<ul style="list-style-type: none"> HUMAX recommends to use external HDDs up to 1TB. If the external HDD is making a ticking sound or not being recognized, this may indicate that the electricity is not sufficient. Please connect the power cable of the external HDD or connect another USB cable to the product.
How to read files from external HDD		<ul style="list-style-type: none"> Go to HOME > MEDIA CENTER and select an external HDD. Select a file and press the OK button. Some files may not be played depending on the file format.
How to delete root folder?		<ul style="list-style-type: none"> You cannot delete the root folder that is to store the downloaded files.

Network

Problem	Possible Cause	What to Do
Cannot connect to the Internet	<p>Too far from the wireless router</p> <p>Walls or obstacles between the product and the router cause interference.</p> <p>Faulty Ethernet cable</p> <p>Wrong password</p>	<ul style="list-style-type: none"> Check if the network is connected properly. Go to HOME > SETTINGS > Network Settings and select Network Connection Status. If wireless network is not available in your home, use an Ethernet cable to connect the product and the router. Turn off the product and the router and then on to refresh the network. Move the product closer to the wireless router or remove any obstacles from between them. If you use an Ethernet cable, change the Ethernet cable for another. Check if other network devices in the same network are connecting to the Internet okay. Check the network password. <p>Note: The home network environment may cause the Internet speed slow down.</p>
On Demand does not work.		<ul style="list-style-type: none"> Check if the network is connected properly. Go to HOME > SETTINGS > Network Settings and select Network Connection Status. If not connected, refer to the troubleshooting guide for the network. <p>Note:</p> <ul style="list-style-type: none"> Network traffic may cause temporary loss of network connectivity. Poor network connection may cause On Demand run slowly.

Appendix

Media Center

Problem	Possible Cause	What to Do
Cannot play YouTube video.	Some YouTube videos are played on PC only.	<ul style="list-style-type: none">• Play another video to view.
Network server does not work	HUMAX product is not connected to the network or the network is not configured. Home network devices are not connected to the network or the network is not configured. PC/Router settings are not correct.	<ul style="list-style-type: none">• Go to HOME > SETTINGS > Network settings and check if Network Server is set to On. When the network server option is set to on, files stored in the internal HDD can be shared with other home network devices in the same network.• Make sure that the options to share media files are enabled on your PC.• Check if any firewall settings on your PC or router blocks home network compatibility.
File share(SAMBA/FTP) does not work	Network connection error File sharing options	<ul style="list-style-type: none">• Check if the network is connected properly. Go to HOME > SETTINGS > Networks Settings and select Network Connection Status.• Make sure that your product and PCs are in the same network.• Make sure that the SAMBA server is activated. Go to HOME > SETTINGS > Network Settings > File Share and set SAMBA Server to On.• Make sure that the FTP server is activated. Go to HOME > SETTINGS > Network Settings > File Share and set FTP Server to On.• Check if the password is correct. Go to HOME > SETTINGS > Network Settings > File Share and set a new password.

Others

Problem	Possible Cause	What to Do
Can I use a HUMAX product from other countries in UK?	Each country has their own broadcasting system. HUMAX product is made it possible for regional broadcasting environment.	<ul style="list-style-type: none">• HUMAX products from other countries are not available in UK. Customer services may be limited.

Cautions: Electromagnetic interferences from other electronic devices or cables may cause malfunction to the HUMAX product.

HUMAX Customer Support

More information on your product is provided in the HUMAX website. Should your product require warranty service, please contact HUMAX to obtain the appropriate authorization.

UK	Tel: Opening Hours: E-mail: Website: Language:	0344 318 8800 Mon - Fri 09:00 – 17:30 (excluding Bank Holidays) uksupport@humax-digital.co.uk www.humaxdigital.co.uk English
----	--	--

Glossary

CVBS (Composite Video Baseband Signal)

A technology for transmitting video signals via a cable. Mixes luminance (brightness) and the chrominance (colour) signals together.

Dolby Digital

An encoding system that digitally compresses up to 5.1 discrete channels of audio (left front, centre, right front, left surround, right surround) into a single Bitstream. A low frequency effect (LFE) channel is included providing the sound needed for special effects.

DVB (Digital Video Broadcasting)

A set of standards that define digital broadcasts using satellite, cable or terrestrial systems.

EPG (Electronic Program Guide)

An electronic equivalent to a printed television listings magazine. It is an application used with digital set-top boxes and digital television sets to list current and scheduled programs that are or will be available on each channel, including a short summary or commentary for each Program. The information supplied in the EPG is sent and updated by the channel broadcaster.

Frequency

The property of a signal measured in cycles per second (=Hz).

FTA (Free- To-Air)

An unscrambled broadcaster allowing customers to view channels or services without paying any subscription.

HDD (Hard Disk Drive)

The primary computer storage medium, which is made of one or more aluminum or glass platters, coated with a ferromagnetic material.

HDMI (High-Definition Multimedia Interface)

An all-digital audio/video interface that supports standard, enhanced, or high-definition video, plus multi-channel digital audio on a single cable. It transmits all ATSC HDTV standards and supports 8-channel digital audio.

OTA (Over the Air)

A standard for the transmission of software for equipment, through a broadcast system. Manufacturers reserve the right for deciding the release of the software for their products.

PVR (Personal Video Recorder)

A video recorder that can record and playback and are then demodulated by the tuner of your TV or STBs.

RGB (Red – Green – Blue)

A technology for transmitting video signals via a cable. RGB is a system to represent red, green, and blue colours on a TV or monitor display. Red, green, and blue can be combined in various proportions to obtain any colour.

S/PDIF (Sony/Philips Digital Interface format)

A standard format for the transfer of digital audio signals. It allows the transfer of digital audio between two devices without any conversion to and from analogue, which could degrade the signal quality.

S-Video (Super-Video)

Sometimes referred to as Y/C video; a technology for transmitting video signals via a cable. It is a video signal transmission in which the luminance (brightness) and the chrominance (colour) signals are transmitted separately to achieve superior picture clarity.

TSR (Time Shifted Recording)

A function that records the present program temporarily to support trick-play.

Using the Universal Remote Control

Setting the Universal Remote Control

Set up the universal remote control so that you can control your TV with this universal remote control.

1. Press the **TV STANDBY** button and **OK** button at the same time for 3 seconds. The **TV STANDBY** button will light on.
2. Enter the 3-digit code. The button will blink when each digit is entered and it will blink twice after the last digit is entered.
3. Press the **OK** button. The **TV STANDBY** button will blink three times.

Note:

- When no code is entered for 20 seconds, the universal setting mode will switch to normal mode.
- Try several setting codes and select the code that has the most functions.

Setting the Code Randomly

1. Press the **TV STANDBY** button and **OK** button at the same time for 3 seconds. The **TV STANDBY** button will light on.
2. Use the **CH▲/CH▼** button to search the brand code of the TV. If the TV powers off, this means that the TV brand code matches with the TV.
3. Press the **OK** button. The **TV STANDBY** button will blink 3 times.

Note: If the code setting process is not completed, the previously set code remains as default.

Brand	Code
Acer	261, 278, 305
Acoustic Solutions	210, 312, 324, 370, 386, 428, 477
Akai	102, 006, 098, 144, 145, 111, 061, 043, 074, 148, 232, 280, 128, 122, 461, 109, 462, 489, 094, 084, 083, 065, 035, 034, 033, 028, 023, 011, 004, 002, 154, 321
Alba	006, 144, 134, 204, 087, 064, 036, 005, 108, 473, 455, 447, 388, 099, 084, 077, 072, 065, 059, 034, 023, 002
Bang & Olufsen	014
Beko	006, 144, 086, 145, 111, 064, 072, 172, 361, 405
BenQ	223, 328, 329
Black Diamond	444, 204, 211
Brionvega	006, 014, 062
Bush	102, 006, 144, 134, 204, 138, 087, 061, 043, 036, 005, 108, 376, 373, 370, 361, 355, 352, 327, 388, 430, 431, 432, 440, 448, 451, 473, 476, 477, 478, 002, 033, 035, 044, 045, 056, 059, 065, 066, 095, 133, 164, 210, 213, 229, 232, 250
cello	397, 410, 418, 419, 420
Crown	006, 144, 134, 204, 086, 145, 087, 111, 143, 064, 361, 135, 072, 071, 053, 033, 002
Daewoo	102, 006, 124, 444, 036, 441, 406, 341, 338, 271, 249, 195, 192, 190, 164, 133, 119, 091, 079, 066, 035, 034, 002
Dell	235, 278
DMTech	260, 438, 449, 454, 456
Ferguson	006, 120, 098, 103, 030, 204, 012, 020, 029, 046, 052, 054, 077, 292, 447, 476
Finlux	102, 006, 144, 145, 333, 327, 172, 122, 118, 094, 089, 084, 083, 070, 055, 035, 023, 018, 017, 014, 011, 010
Fujitsu	002, 011, 032, 035, 042, 137, 173, 187
Fujitsu General	002, 032, 035, 137
Fujitsu Siemens	172, 211, 230, 246, 268, 369
Funai	144, 134, 043, 275, 336, 369, 407
GoldStar	006, 144, 145, 111, 061, 001, 007, 020, 023, 027, 034, 035, 047, 067

Gooding	087
Goodmans	102, 006, 120, 144, 103, 134, 124, 444, 204, 087, 043, 036, 005, 478, 211, 232, 477, 250, 476, 271, 445, 355, 370, 373, 440, 376, 382, 383, 386, 002, 004, 011, 035, 047, 052, 054, 065, 066, 084, 091, 094, 119, 121, 133, 172, 195, 210
Graetz	144, 087, 061, 023, 053, 065, 211
Grundig	102, 006, 030, 087, 142, 005, 108, 498, 476, 448, 447, 445, 430, 405, 370, 271, 267, 250, 225, 135, 121, 010, 101, 096, 028, 077
Grunkel	211
Hannspree	262, 263, 264, 342, 401, 402, 463
Hantarex	006, 002, 094, 190, 260, 289
Hinari	006, 043, 036, 005, 002, 033, 059, 077, 443
Hisense	102, 092, 165, 254, 265, 366, 491
Hitachi	006, 098, 124, 204, 208, 005, 019, 037, 146, 152, 153, 163, 169, 193, 197, 007, 206, 210, 217, 227, 295, 296, 330, 377, 399, 424, 483, 020, 021, 023, 027, 035, 054, 056, 060, 076, 081, 083, 084, 085, 089, 091, 094, 018, 106, 107, 011
Humax	505, 299, 506, 507, 245, 319, 322, 411, 433, 479
Hyundai	164, 190, 192, 241, 244, 271, 291, 317, 338, 340, 341, 439
Inno Hit	036, 002, 011, 035, 045, 047, 094, 211
Irradio	006, 036, 002, 047, 065, 147
JVC	111, 036, 005, 129, 130, 015, 029, 065, 072, 137, 149, 207, 264, 362, 408, 496
Keymat	258, 300, 398, 436, 437
Lenoir	002, 214
LG	102, 006, 144, 145, 138, 061, 064, 248, 281, 354, 367, 368, 384, 396, 416, 417, 425, 426, 215, 209, 067, 047, 035, 034, 027, 023, 002, 001, 236, 257
Loewe	006, 064, 014, 048, 093, 094, 123, 131, 167, 414, 434
Logik	204, 001, 003, 029, 162, 195, 224, 292, 376, 464, 465, 466
Logix	134, 095

Luxor	098, 204, 061, 023, 033, 035, 047, 055, 056, 060, 083, 084, 122, 211
Manhattan	006, 134, 204, 164, 192, 237, 293
Marantz	102, 006, 071, 140, 277, 317
Marks and Spencer	420
Matsui	102, 006, 144, 030, 204, 087, 005, 080, 074, 153, 195, 097, 094, 369, 445, 077, 447, 065, 059, 056, 052, 044, 035, 033, 028, 011, 008, 004, 003, 002
Mitsubishi	102, 006, 204, 005, 019, 014, 015, 027, 093, 096, 191, 311
Mivar	034, 035, 047, 048, 094, 112
NEC	005, 002, 003, 025, 035, 040, 049, 066, 140, 239, 379
Nokia	098, 113, 111, 061, 023, 033, 049, 053, 055, 056, 066, 083, 084, 089, 122
Nordmende	006, 144, 103, 030, 020, 046, 054, 242, 280, 499
Onida	207, 226
Orion	102, 006, 144, 204, 467, 458, 457, 456, 448, 445, 443, 385, 218, 195, 131, 097, 094, 077, 071, 059, 050, 049, 003
Orline	006, 036
Ormond	134, 204
Orsowe	094
Pacific	102, 144, 204, 208, 077, 256
Packard Bell	254, 293
Panasonic	006, 098, 061, 129, 038, 023, 063, 094, 187, 251, 294, 353, 359, 279, 306
Panavision	006, 070
Philco	006, 064, 014, 021, 072
Philips	102, 006, 061, 459, 435, 429, 395, 310, 302, 297, 247, 125, 110, 101, 073, 066, 054, 029, 014, 002
Phonola	102, 006, 014, 029, 034
Pioneer	006, 086, 061, 064, 020, 023, 024, 046, 073, 093, 136, 159, 233, 277, 286, 381
Pionier	086, 064, 327
Radiomarelli	006, 014, 094

Relisys	190, 192, 193, 194, 220, 221, 271, 310, 333, 338, 341, 355, 390
Saba	120, 098, 144, 103, 061, 014, 020, 023, 046, 052, 054, 090, 094, 335
Sagem	113, 080, 182, 253, 337
Samsung	102, 006, 043, 064, 108, 115, 231, 252, 276, 287, 332, 345, 350, 351, 372, 442, 474, 488, 490, 492, 228, 176, 175, 127, 095, 047, 035, 034, 033, 027, 023, 011, 009, 002
Sanyo	204, 064, 005, 019, 442, 370, 363, 358, 357, 356, 222, 200, 150, 140, 097, 053, 048, 035, 034, 033, 025, 023, 017, 011, 008, 003, 002, 240
Schaub Lorenz	098, 144, 086, 111, 061, 056, 066, 215, 256, 267
Schneider	102, 006, 144, 134, 204, 061, 208, 036, 451, 450, 293, 128, 097, 095, 065, 056, 054, 042, 035, 023, 010
SEG	006, 134, 204, 087, 043, 036, 005, 285, 211, 210, 119, 062, 056, 035, 034, 002
Sei-Sinudyne	006, 014, 032, 094, 097
Seleco	023, 032, 042, 055, 062, 065, 070, 075, 099
Sharp	005, 130, 216, 015, 029, 088, 094, 177, 274, 334, 365, 409, 166, 288
Siemens	006, 030, 028, 096, 101
SKY	006, 195, 271, 300, 307, 308, 340, 341, 342, 343, 344, 391, 400, 421
Sonoko	006, 043, 002, 035, 045
Sony	006, 301, 005, 446, 412, 393, 375, 360, 325, 255, 203, 185, 174, 058, 003
Strong	210, 211
Technika	422, 428, 465, 468, 480, 493
TechniSat	102, 131, 237
Technisson	144, 242, 361
Technosonic	102, 120, 091, 195, 256, 258, 436, 437, 451, 468
Telefunken	006, 120, 144, 103, 086, 320, 202, 105, 090, 082, 055, 054, 052, 046, 020, 016, 012, 348
Tevion	102, 006, 144, 134, 204, 208, 468, 405, 403, 376, 355, 327, 298, 246, 242, 232, 230, 172, 128

Thomson	006, 120, 103, 020, 046, 052, 054, 056, 082, 335
Toshiba	030, 204, 005, 115, 129, 092, 447, 364, 313, 304, 242, 212, 211, 183, 100, 039, 022, 020, 010, 009, 004, 236, 257
Tosumi	451
Vestel	006, 134, 204, 035, 211, 333, 370
Videocon	092
Viewsonic	307, 308, 323, 335, 349, 391, 394, 259, 331
Wharfedale	102, 006, 095, 189, 256, 327, 370, 452, 453, 477, 502
Yamaha	169, 314, 330, 184
Zanussi	032, 035
TV/VCR Combo	
Aiwa	445
Amstrad	026
Beko	086
Daewoo	444, 119
GoldStar	006
Grundig	102, 006, 030, 101, 445
Irradio	147
LG	027
Philips	102, 006
Saba	120
Samsung	442
Sanyo	442
Sharp	015
Thomson	120
United	445
TV/VCR/DVD Combo	
Grundig	448
Orion	448

If the code for your equipment is not listed, visit the following website and see **MDB1.3** for a complete list of supported codes.
(<http://www.humaxdigital.com/global/support/rucodelist.asp>)

Open Source Software Notice

HUMAX products use certain open source operating system software distributed pursuant to GNU GENERAL PUBLIC LICENSE Version 2 and GNU LESSER GENERAL LICENSE Version 2.1 each as defined and published by the Free Software Foundation, Inc.

The following GPL and LGPL software source codes used in this product can be provided and this offer is valid for up to three years from the date of the download of the software or purchase of product containing such software. Please contact us at gnu@humaxdigital.com.

GPL Software

```
busybox
bzutils
c
compiler
linux
c2graphics
ntpd-utls
parted
xfsprogs
yast2utils
samba
proftpd
```

LGPL Software

```
libICE
DirectFB
libjpeg
```

FreeType License (FTL) Software

```
freetype
```

Portions of this software are copyright © <2007> The FreeType Project

(<http://www.freetype.org>).

All rights reserved.

OpenSSL License Software

```
OpenSSL
```

This product includes cryptographic software written by Eric Young (ey@cryptosoft.com).

This product includes software written by Tim Hudson (tjh@cryptosoft.com).

This product includes software developed by the OpenSSL Project for use

in the OpenSSL toolkit (<http://www.openssl.org>).

Use, modification and redistribution of the Open Source Software is governed

by the terms and conditions of the applicable Open Source License. The

GNU General Public License (GPL) v2 is shown below.

The GNU General Public License (GPL)

Version 2, June 1991

Copyright (C) 1989, 1991 Free Software Foundation, Inc. 51 Franklin Street,

Fifth Floor, Boston, MA 02110-1301, USA Everyone is permitted to copy and

distribute verbatim copies of this license document, but changing it

is not allowed.

Preamble

The licenses for most software are designed to take away your freedom to

share and change it. By contrast, the GNU General Public License is intended

to guarantee your freedom to share and change free software—to make sure

the software is free for all its users. This General Public License applies to most

of the Free Software Foundation's software and to any other program whose

authors commit to using it. Some other Free Software Foundation software

is covered by the GNU Lesser General Public License instead. You can do so

with your programs too. When we speak of free software, we are referring to

freedom, not price. Our General Public Licenses are designed to make sure

that you have the freedom to distribute copies of free software (and charge for

this service if you wish), that you receive source code or can get it if you

want it, that you can change the software or use pieces of it in new free

programs, and that you know you can do these things.

To protect your rights, we need to make restrictions that forbid anyone to

deny you these rights or to ask you to surrender the rights. These restrictions

translate to certain responsibilities for you: you distribute copies of the

software if you modify it.

For example, if you distribute copies of such a program, whether gratis or

for a fee, you must give the recipients all the rights that you have. You must

also make sure that they, too, receive or can get the source code. And you must

show them these terms so they know their rights.

We protect your rights with two steps: (1) copyright the software, and (2) offer

you this license which gives you legal permission to copy, distribute and/or

modify the software.

Also, for each author's protection and ours, we want to make certain that

everyone understands that there is no warranty for this free software. If the

software is modified by someone else and passed on, we want its recipients

to know that what they have is not the original author's, to prevent them

from being misled by claims to modify the program proprietary. To prevent

this, we have made it clear that any patent must be licensed for everyone's

free use or not licensed at all.

The precise terms and conditions for copying, distribution and modification

are given in the licenses. This document is only a synopsis of the licenses.

TERMS AND CONDITIONS FOR COPYING, DISTRIBUTION AND MODIFICATION

0. This license applies to any program or other work which contains a notice

placed by the copyright holder saying it may be distributed under the terms

of this license. The Program below refers to any such program or work, and a

'work based on the Program' means either the Program or any derivative work

under copyright law; that is to say, a work containing any part of the Program or

any part of a work containing any part of the Program or which is derived

or translated into another language. (Hereinafter, translation is included without

limitation in the term 'modification'.) Each licensee is addressed as 'you'.

Activities permitted under the Program's license include copying and

distributing the Program, and subject to restrictions other than those stated

here, is not restricted, and the output from the Program is covered only if its

contents constitute a work based on the Program (independent of having

been made by running the Program). Whether that is true depends on what

the Program does.

1. You may copy and distribute verbatim copies of the Program's source

code as you receive it, in any medium, provided that you conspicuously and

appropriately publish on each copy an appropriate copyright notice and

disclaimer of warranty, keep intact all the notices that refer to this License and

to the absence of any warranty, and give any other recipients of the Program

a copy of this License along with the Program. You may charge a fee for the

physical act of transferring a copy, and you may at your option offer warranty

protection in exchange for a fee.

2. You may modify any part of the source code of the Program or any portion of

it, thus forming a work based on the Program, and copy and distribute such

modifications or work under the terms of Section 1 above, provided that you

also meet all of these conditions:

a) You must cause the modified files to carry prominent notices stating that

you changed the files and the date of any change.

b) You must cause any work that you distribute to publish, that in whole

or in part contains code derived from the Program or any part thereof, to

be licensed as a whole at no charge to all third parties under the terms of

this License.

3. You must cause the program normally reads commands interactively when run,

your modified program, if any, started running on such interactive use in the

most ordinary way, to print or display an announcement including an appropriate

copyright notice for this program, your modified program, if any, and the name

of the person who provides warranty, if any, for the program; and that you

provide a warranty, or that users may redistribute the program under

these conditions, and telling the user how to view a copy of this License. (Excep-

tion: if the Program itself is interactive but does not normally print such

an announcement, your work based on the Program is not required to print

an announcement.)

These requirements apply to the modified work as a whole. If identifiable sec-

tions of code that were not derived from the Program, but which can be reasonably

considered independent and separate works in themselves, then this License,

and its terms, do not apply to those sections when you distribute them as

separate works. But when you distribute the same sections as part of a whole

which is a work based on the Program, the distribution of the whole must be

on the terms of this License, your permissions for other licenses extend to

this whole, and thus to each and every part regardless of how it is written

therein. The Free Software Foundation is authorized to make copies for you

to write to either party, but you, the copyright holder, must make the effort to

write to them by your, rather than the intent is to exercise the right to

control the distribution of derivative or collective works based on the

Program. In addition, you must cause any work that you distribute under the

Program with the Program (or with a work based on the Program) on a

volume of a storage or distribution medium (does not bring the other work

under the scope of this License.

3. You may copy and distribute the Program (or a work based on it, under

Section 2) in object code or executable form under the terms of Sections 1

and 2 above provided that you also do one of the following:

a) Accompany it with the complete corresponding machine-readable source

code, which must be distributed under the terms of Sections 1 and 2 above

on a medium customarily used for software interchange; or,

b) Accompany it with the information you received to run the program, to give

any third party, for a charge no more than your cost of physically performing

software distribution, a complete machine-readable copy of the corresponding

source code, to be distributed under the terms of Sections 1 and 2 above on a

medium customarily used for software interchange; or,

c) Accompany it with the information you received to as to offer to

distribute corresponding source code. (This alternative is allowed only for

non-commercial activities.) In addition, you must accompany each object

code with either the complete corresponding machine-readable source code,

or a written offer to provide the source code under the terms of Sections 1

and 2 above. You may charge a fee for copying the source code, for providing

access to copying facilities, for redistributing the source code, for copying

and distributing the source code, for providing access to copying facilities,

for copying the source code, for providing access to copying facilities, for

copying the source code, for providing access to copying facilities, for

copying the source code, for providing access to copying facilities, for

copying the source code, for providing access to copying facilities, for

copying the source code, for providing access to copying facilities, for

copying the source code, for providing access to copying facilities, for

copying the source code, for providing access to copying facilities, for

copying the source code, for providing access to copying facilities, for

copying the source code, for providing access to copying facilities, for

copying the source code, for providing access to copying facilities, for

copying the source code, for providing access to copying facilities, for

copying the source code, for providing access to copying facilities, for

copying the source code, for providing access to copying facilities, for

copying the source code, for providing access to copying facilities, for

copying the source code, for providing access to copying facilities, for

copying the source code, for providing access to copying facilities, for

copying the source code, for providing access to copying facilities, for

copying the source code, for providing access to copying facilities, for

copying the source code, for providing access to copying facilities, for

copying the source code, for providing access to copying facilities, for

copying the source code, for providing access to copying facilities, for

copying the source code, for providing access to copying facilities, for

copying the source code, for providing access to copying facilities, for

copying the source code, for providing access to copying facilities, for

copying the source code, for providing access to copying facilities, for

copying the source code, for providing access to copying facilities, for

copying the source code, for providing access to copying facilities, for

copying the source code, for providing access to copying facilities, for

copying the source code, for providing access to copying facilities, for

copying the source code, for providing access to copying facilities, for

copying the source code, for providing access to copying facilities, for

copying the source code, for providing access to copying facilities, for

copying the source code, for providing access to copying facilities, for

copying the source code, for providing access to copying facilities, for

copying the source code, for providing access to copying facilities, for

copying the source code, for providing access to copying facilities, for

copying the source code, for providing access to copying facilities, for

copying the source code, for providing access to copying facilities, for

copying the source code, for providing access to copying facilities, for

copying the source code, for providing access to copying facilities, for

copying the source code, for providing access to copying facilities, for

copying the source code, for providing access to copying facilities, for

copying the source code, for providing access to copying facilities, for

copying the source code, for providing access to copying facilities, for

copying the source code, for providing access to copying facilities, for

copying the source code, for providing access to copying facilities, for

copying the source code, for providing access to copying facilities, for

copying the source code, for providing access to copying facilities, for

copying the source code, for providing access to copying facilities, for

copying the source code, for providing access to copying facilities, for

copying the source code, for providing access to copying facilities, for

copying the source code, for providing access to copying facilities, for

copying the source code, for providing access to copying facilities, for

copying the source code, for providing access to copying facilities, for

copying the source code, for providing access to copying facilities, for

copying the source code, for providing access to copying facilities, for

copying the source code, for providing access to copying facilities, for

copying the source code, for providing access to copying facilities, for

copying the source code, for providing access to copying facilities, for

copying the source code, for providing access to copying facilities, for

copying the source code, for providing access to copying facilities, for

copying the source code, for providing access to copying facilities, for

copying the source code, for providing access to copying facilities, for

copying the source code, for providing access to copying facilities, for

copying the source code, for providing access to copying facilities, for

copying the source code, for providing access to copying facilities, for

copying the source code, for providing access to copying facilities, for

copying the source code, for providing access to copying facilities, for

copying the source code, for providing access to copying facilities, for

copying the source code, for providing access to copying facilities, for

copying the source code, for providing access to copying facilities, for

INCIDENTAL OR CONSEQUENTIAL DAMAGES ARISING OUT OF THE USE OR

INABILITY TO USE THE PROGRAM, INCLUDING BUT NOT LIMITED TO LOSS OF

DATA OR PROFITS, BUSINESS INTERRUPTION, OR LOSS OF BUSINESS SUSTAIN-

ANCE, OR FOR ANY OTHER PARTIES OR A FAILURE OF THE PROGRAM TO OPERATE WITH

ANY OTHER PROGRAMS, EVEN IF SUCH HOLDER OR OTHER PARTY HAS BEEN

ADVISED OF THE POSSIBILITY OF SUCH DAMAGES.

END OF TERMS AND CONDITIONS

How to Apply These Terms to Your New Programs

If you develop a new program, and you want it to be of the greatest possible

use to the public, the best way to achieve this is to make it free software

which everyone can redistribute and change under these terms. To do so,

attach the following notices to the program. It is safest to attach them to the

source code, but you may also attach them to the distribution, and each file

should have at least the "copyright" line and a pointer to where the

full notice is found.

Each file should have a copyright notice of its own, if it is feasible.

Copyright (C) *yyyy* your name <Your program is free software; you can

redistribute it and/or modify it under the terms of the GNU General Public

License as published by the Free Software Foundation; either version 2 of the

License, or (at your option) any later version. This program is distributed in

the hope that it will be useful, but WITHOUT ANY WARRANTY; without even the

implied warranty of MERCHANTABILITY or FITNESS FOR A PARTICULAR PUR-

POSE. See the GNU General Public License for more details. You should have

received a copy of the GNU General Public License along with this program; if

not, write to the Free Software Foundation, Inc., 51 Franklin Street, Fifth Floor,

Boston, MA 02110-1301, USA. Also include information on how to contact you

by electronic and paper mail. If the program is interactive, make it output a short

notice like this when it starts in an interactive mode:

Gnomovision version 69, Copyright (C) *yyyy* your name and/or Gnomovision

contributors. This is free software; you can redistribute it and/or modify it

under the terms of the GNU General Public License version 2. You are

free software, and you are welcome to redistribute it under certain conditions;

Warranty Certificate

IMPORTANT:

Keep this Certificate together with the Original invoice or receipt in a safe place and show them to the retailer or place of purchase whenever a warranty repair is necessary.

• **Model No.:** _____

• **Serial No.:** _____

• **Date of Purchase:** _____

• **Dealer's Signature:** _____

• **Customer's Signature:** _____

HUMAX thanks you for your recent HUMAX product purchase.

For your benefit, we recommend that you record your serial number, found on the product, and other purchase information on this card and keep it with your personal records, along with proof of purchase. This information will allow us to better serve your needs.

■ WARRANTY CONDITIONS

Keep this Certificate together with the original invoice or receipt in a safe place and show them to the retailer or place of purchase whenever a warranty repair is necessary.

■ HUMAX CONSUMER WARRANTY

HUMAX warrants this product to be free of defects in materials and workmanship, subject to the conditions set forth overleaf.

■ CONDITIONS

1. The HUMAX Warranty is valid for a period of two years from the date of first purchase.
2. In the event that this product fails to function properly during the warranty period, the retailer or distributor will make this product capable of operating for the purpose of which it was designed, without charging for labour and parts.
3. This warranty will be honoured only if the Warranty Certificate has been duly completed by the purchaser and is presented to the retailer with the original invoice or receipt.
4. This warranty does not cover shipping or transportation charges from you to us.
5. The obligations of HUMAX are limited to the repair of defect parts. Costs and risks of transport to the retailer as well as removal and installation of the product, and any other costs directly or indirectly related to its repair, are not covered by the warranty.
6. All warranty repairs performed by non-authorized repair shops will not be reimbursed and if such repairs damage this product such damage will not be covered by this warranty.
7. This warranty is not applicable in cases other than defects in materials or workmanship and, in particular, does not cover:
 - a. periodic check-ups, adjustments, maintenance or conversions as well as replacement of parts due to normal wear and tear;
 - b. damage caused by accidents, negligence, modifications, use of non-HUMAX parts, improper use, installation or package;
 - c. damage caused by lightning, water, fire, acts of war, public disturbances, incorrect mains voltages, incorrect ventilation or any other cause beyond the control of the HUMAX.
 - d. products where the label bearing the serial number has been removed, defaced or is illegible.
8. This warranty is offered to any person who has legally obtained possession of this product within the warranty period.
9. HUMAX's maximum liability shall not exceed the actual purchase price paid by you for the product. In no event shall HUMAX be liable for special, incidental, consequential or indirect damages.



UK

Tel:	0344 318 8800
Opening Hours:	Mon - Fri 09:00 – 17:30 (excluding Bank Holidays)
E-mail:	uksupport@humax-digital.co.uk
Website:	www.humaxdigital.co.uk
Language:	English

