

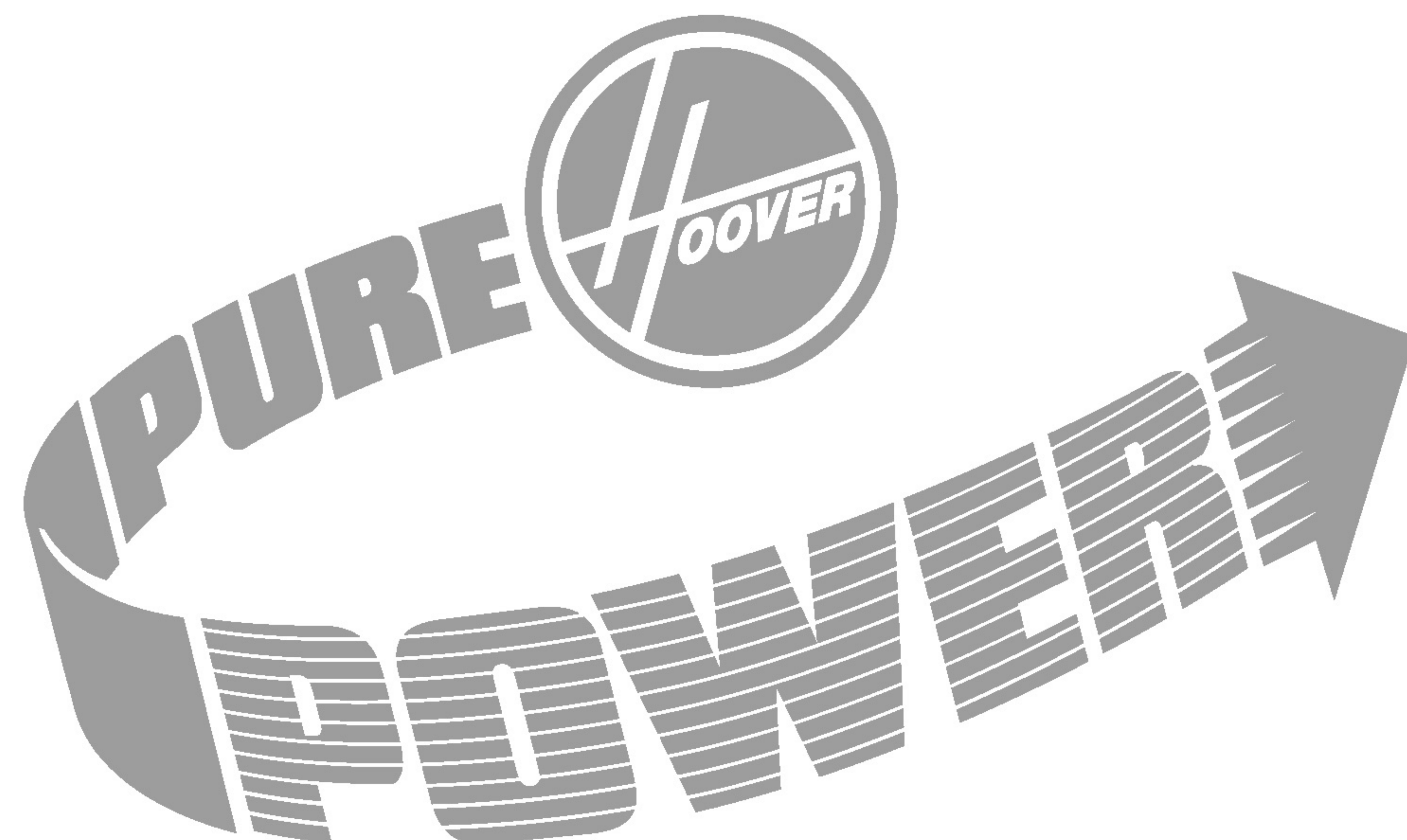

# PurePower



**USER  
INSTRUCTIONS**

## IMPORTANT SAFETY REMINDERS

User's manual-This cleaner should only be used for its intended purpose as described in these instructions. Ensure that these are fully understood before operating this appliance.

Only use attachments recommended or supplied by Hoover.

When using cleaning tools ensure that the cleaner is kept in the upright (parked) position. This will avoid possible damage to the carpet or floor covering. When cleaning stairs **DO NOT** position the cleaner above you.

**STATIC ELECTRICITY.** Some carpets can cause a small build up of static electricity. Any static discharge is not hazardous to health.

**DO NOT** use your cleaner out of doors or on any wet surface or for wet pick up.

Air freshener pads must be kept away from children. **DO NOT** suck, swallow or chew air freshener pads.

Keep hands, feet, loose clothing and hair away from rotating brushes.

**DO NOT** pick up hard or sharp objects, matches, hot ashes, cigarette ends or other similar items.

**DO NOT** pick up flammable liquids such as cleaning fluids, petrol etc. or their vapours.

Aerosol sprays may be flammable. **DO NOT** spray near cleaner.

**SUPPLY CORD.** **DO NOT** run over the supply cord when using your cleaner or remove the plug by pulling on the supply cord.

**FAULTS.** **DO NOT** continue to use your cleaner if it appears to be faulty. If the supply cord is damaged stop using the cleaner **IMMEDIATELY.** The supply cord must be replaced by an authorised Hoover service engineer to avoid a safety hazard.

**AFTER USE.** Switch the cleaner off and remove the plug from the electricity supply. Always switch off and remove the plug before cleaning the appliance or attempting any maintenance task.

**HOOVER SERVICE.** To ensure the continued safe and efficient operation of this appliance we recommend that any servicing or repairs are only carried out by an authorised Hoover service engineer.

HOOVER SERVICE                    08705 400 600  
HOOVER SPARES                    01204 556 111

Use only **HOOVER** paper bags and filters

**Congratulations on the purchase of your new Hoover PurePower.**

**This highly advanced machine - with new technology unique to Hoover - makes cleaning easier and more efficient.**

**You'll find it kinder to your carpets - and to you!**

**Please take the time to read this manual carefully.**

**You'll be ready to make the most of the special features only the new Hoover PurePower can offer!**

### **WARNING! ELECTRICITY CAN BE EXTREMELY DANGEROUS**

This appliance is double insulated and must not be earthed.

The plug is fitted with a 13 amp fuse.

**IMPORTANT: The wires in the mains lead are coloured in accordance with the following code:**

**Blue - NEUTRAL  
Brown - LIVE**

**HOOVER®**  
*PurePower*

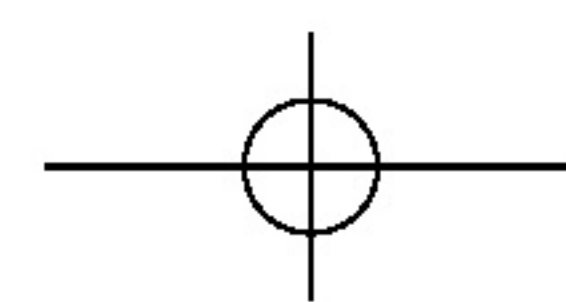

# GETTING TO KNOW YOUR CLEANER

## Effortless cleaning with your new Hoover PurePower...

When first unpacking your cleaner please check all items are included.

If any parts are missing, contact your retailer or call the Hoover helpline on 08705 400 600

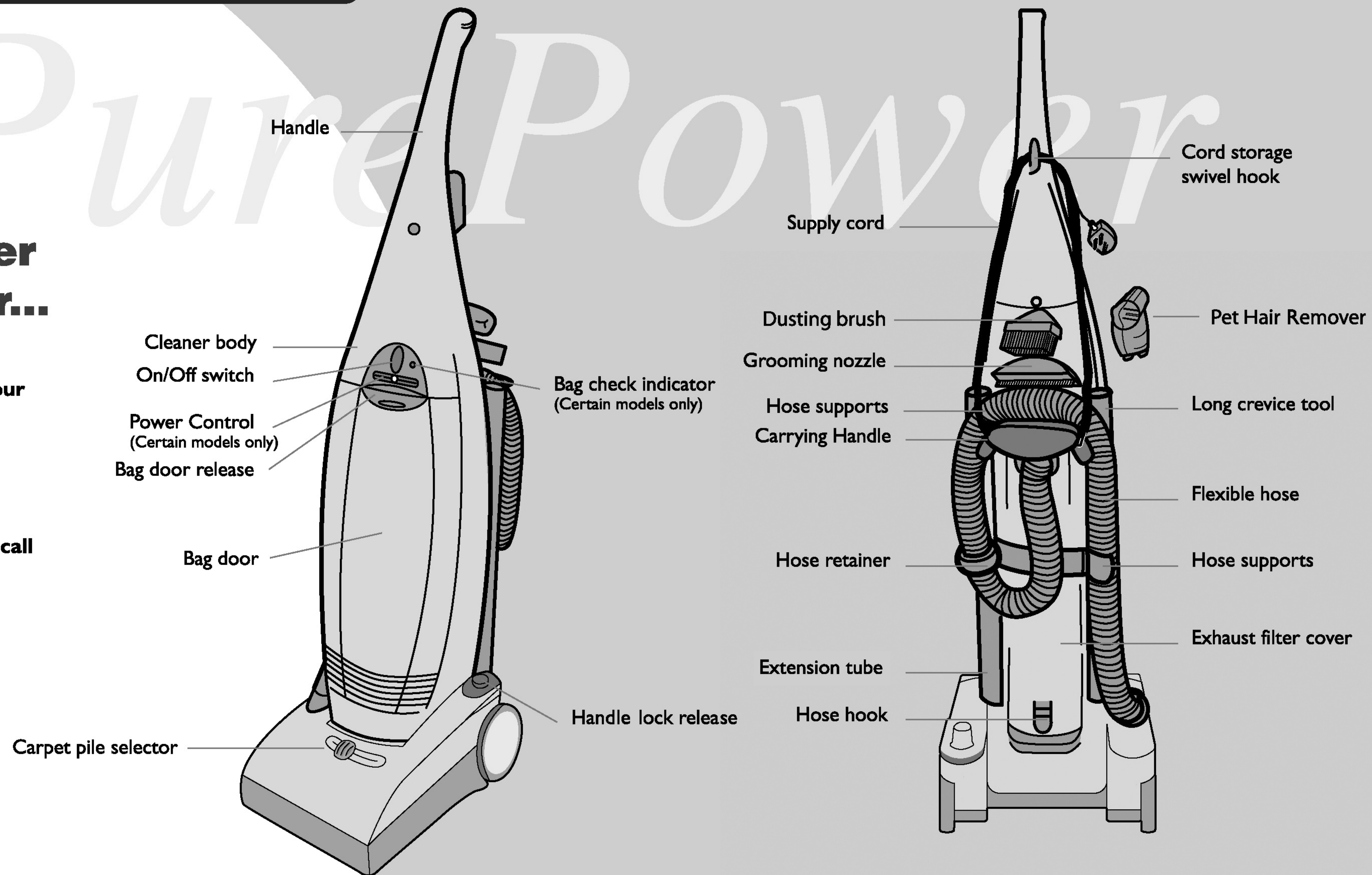

\* Features vary according to model

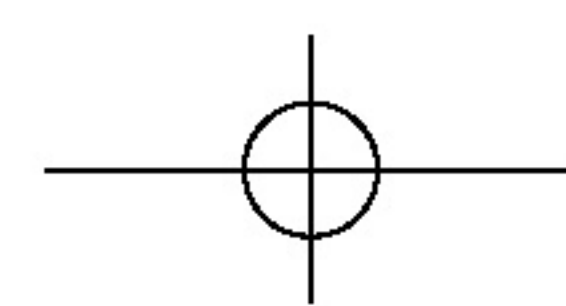

## PREPARING TO USE YOUR CLEANER

- 1 Insert handle into body of cleaner. Slide into position.  
Ensure handle is flush with body of cleaner. Tighten large screw (pre-fitted to handle upper hole). Insert small screw into handle lower hole and tighten.
- 2 Locate hose end, turn clockwise to lock.
- 3 Locate hose retainer on lower hose support.
- 4 Position hose over hose supports
- 5 Push handgrip firmly into socket.  
Clip tools to back of cleaner.  
Check that paper bag is fitted, if not fit new one (See 'Changing the paper bag' overleaf).

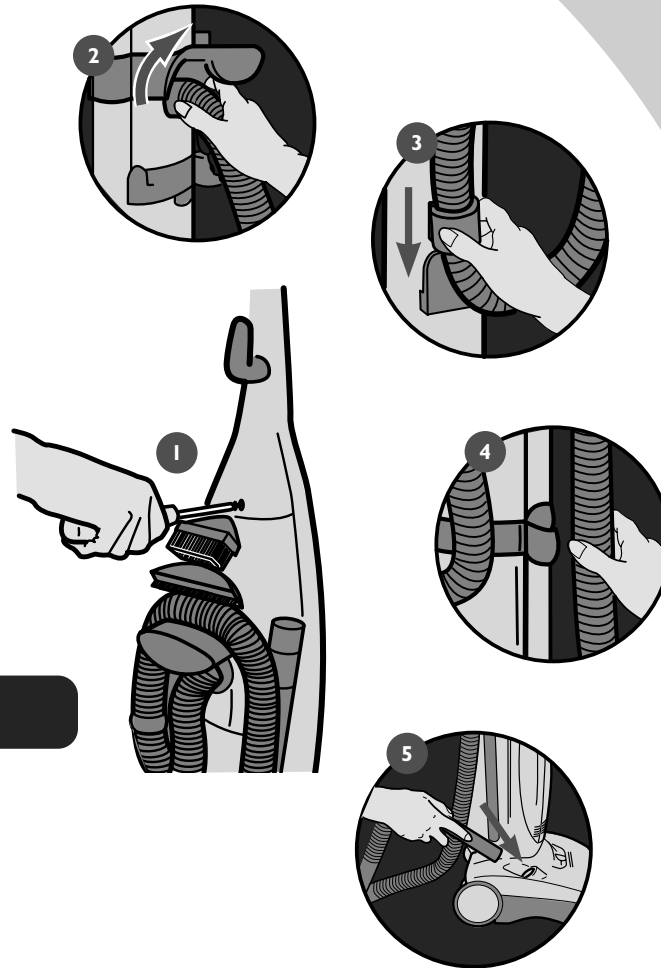

## POWER SWITCH SETTINGS

### Switching on and off

Push bottom of switch to switch on.  
Push top of switch to switch off.

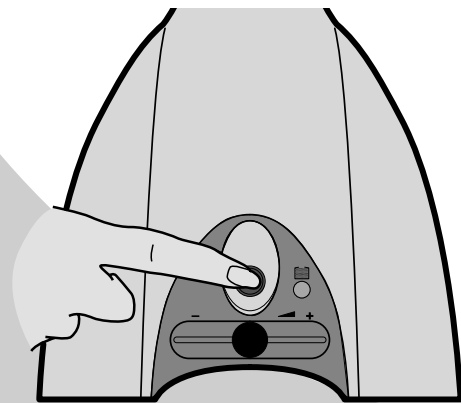

## CARPET HEIGHT SELECTOR

The carpet height selector raises or lowers the height of the nozzle. The nozzle height will not change until the handle is released. Try various settings until you get the best results for each of your carpets.

**IMPORTANT:** When cleaning hard floors such as vinyl or linoleum, move the "Height Right" selector knob to the hard floor position. Failure to do so may cause damage to the floor surface.

Ensure that cleaner is in the upright (parked position).

Slide knob to position best suited to depth of carpet pile.

Using this cleaner for carpets with pile greater than 30mm is not recommended.

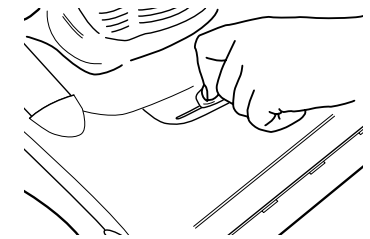

## HANDLE LOCK RELEASE

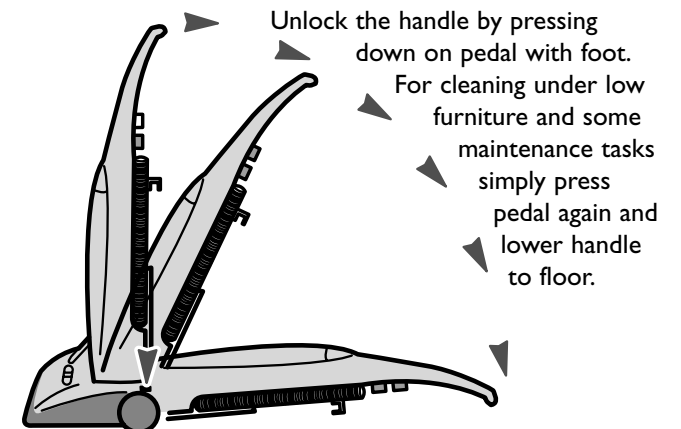

## CLEANING TOOLS

**IMPORTANT:** When using cleaning tools, the cleaner must be kept in the upright (parked) position, particularly when cleaning stairs. The nozzle height should also be set to the tools position:

### Pet Hair Remover

Ideal for removing pet hairs. Do not touch the rotating brush.

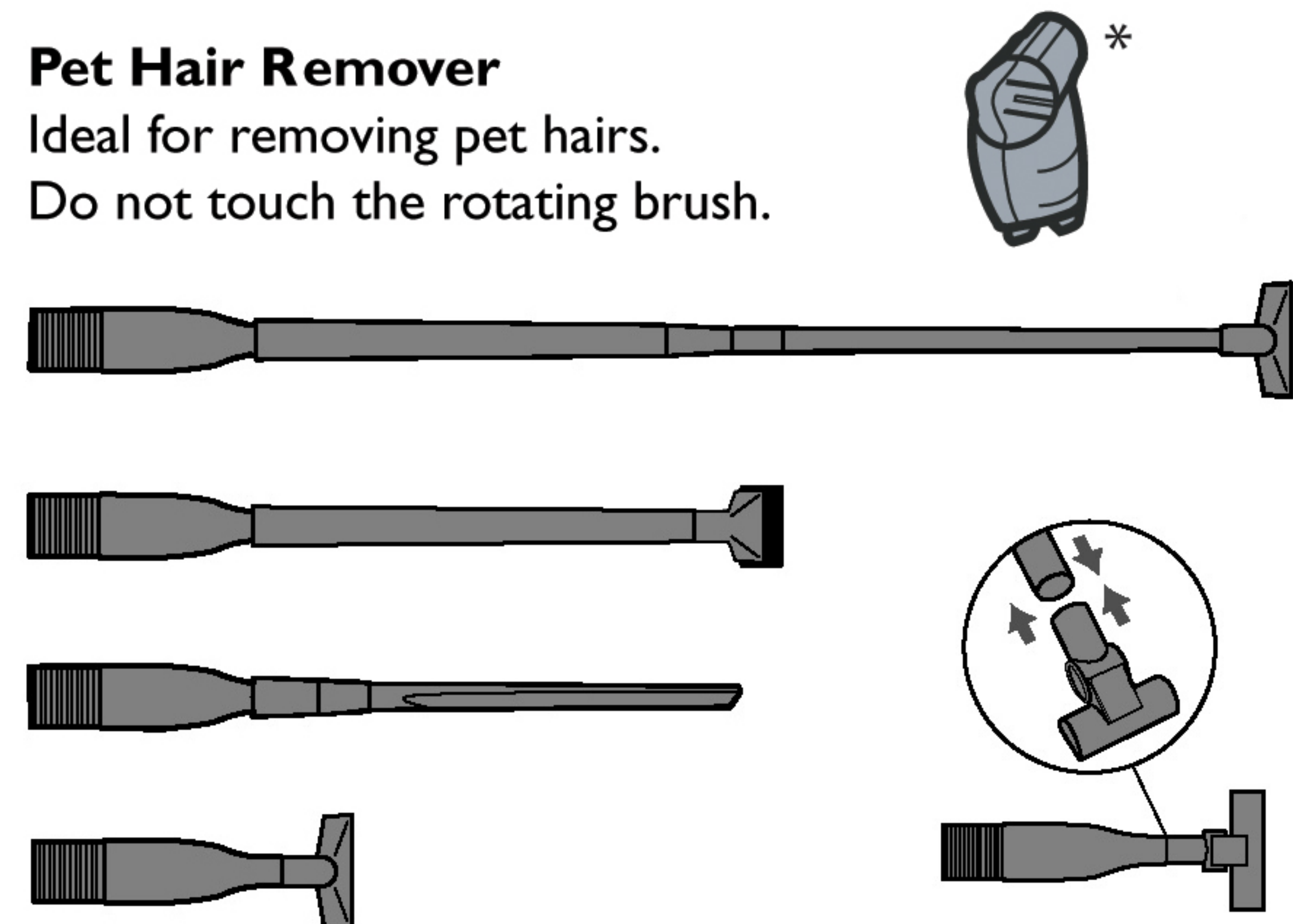

\* certain models only

Dependant on model, different hose types are supplied.

**DO NOT** touch the rotating brushes. The long crevice tool provides extra reach and can be attached to both the dusting brush and the grooming nozzle.

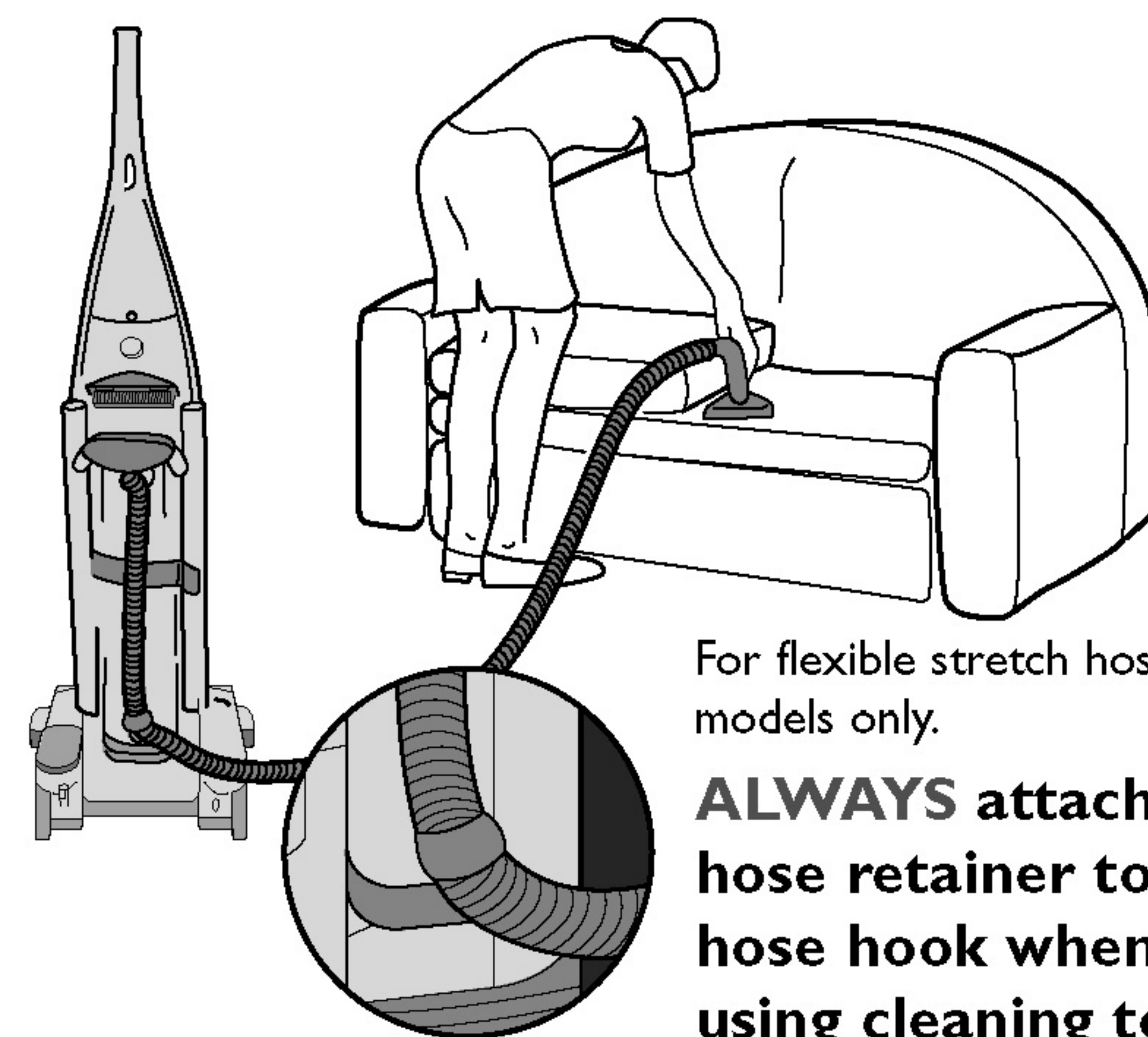

For flexible stretch hose models only.

**ALWAYS** attach hose retainer to hose hook when using cleaning tools. Unhook after use.

## CLEANING THE STAIRS

It is dangerous for the cleaner to be above you at the top of the stairs.

**ALWAYS** work with the cleaner below you. Ensure it is positioned up against the bottom step.

**DO NOT** attach hose retainer when cleaning stairs.

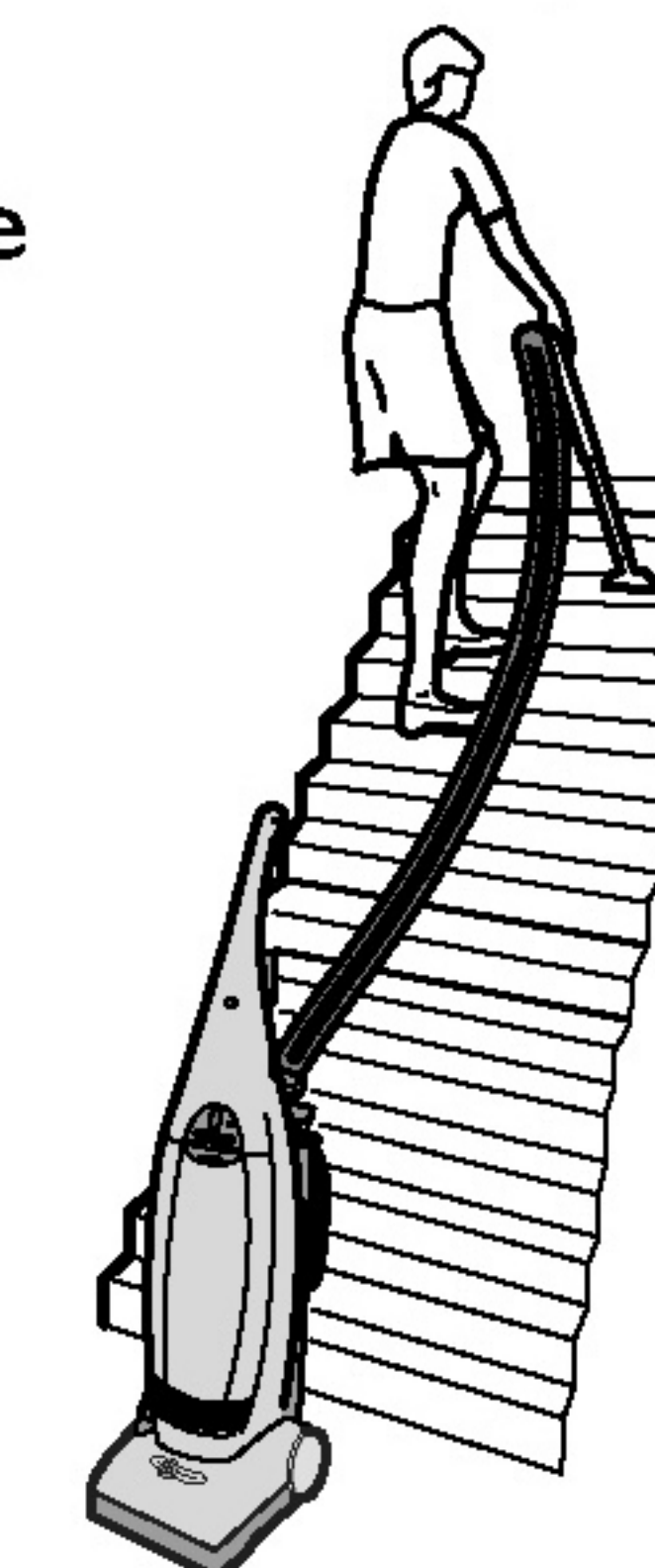

Illustration shows long stretch stair cleaning hose.

## CLEANING THE FILTERS

**PRE-MOTOR FILTER** – Replace or clean when blocked. This will be between every 3 and 5 full bags depending on the type and amount of dirt being picked up.

**Remove bag door**

Lift out filter.

(It can be cleaned by washing in warm soapy water).

**DRY THOROUGHLY**

before refitting. If filter is damaged fit a new one.

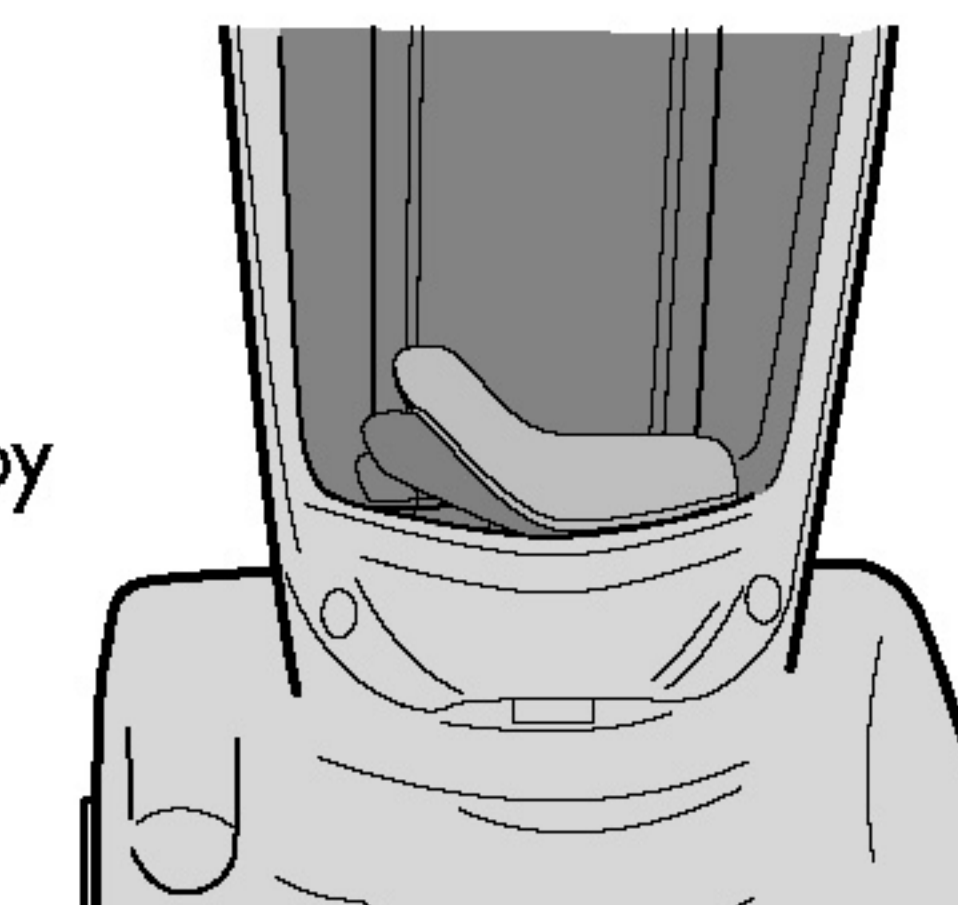

**EXHAUST FILTER**

\*'S' Class exhaust filter

\*Microfilter exhaust filter

– fit a new one after five full bags of dirt have been removed.

Press down on latch and remove the exhaust filter cover.

Lift out exhaust filter, turn cleaner over, face down on a soft surface and fit a new one. Refit the filter cover.

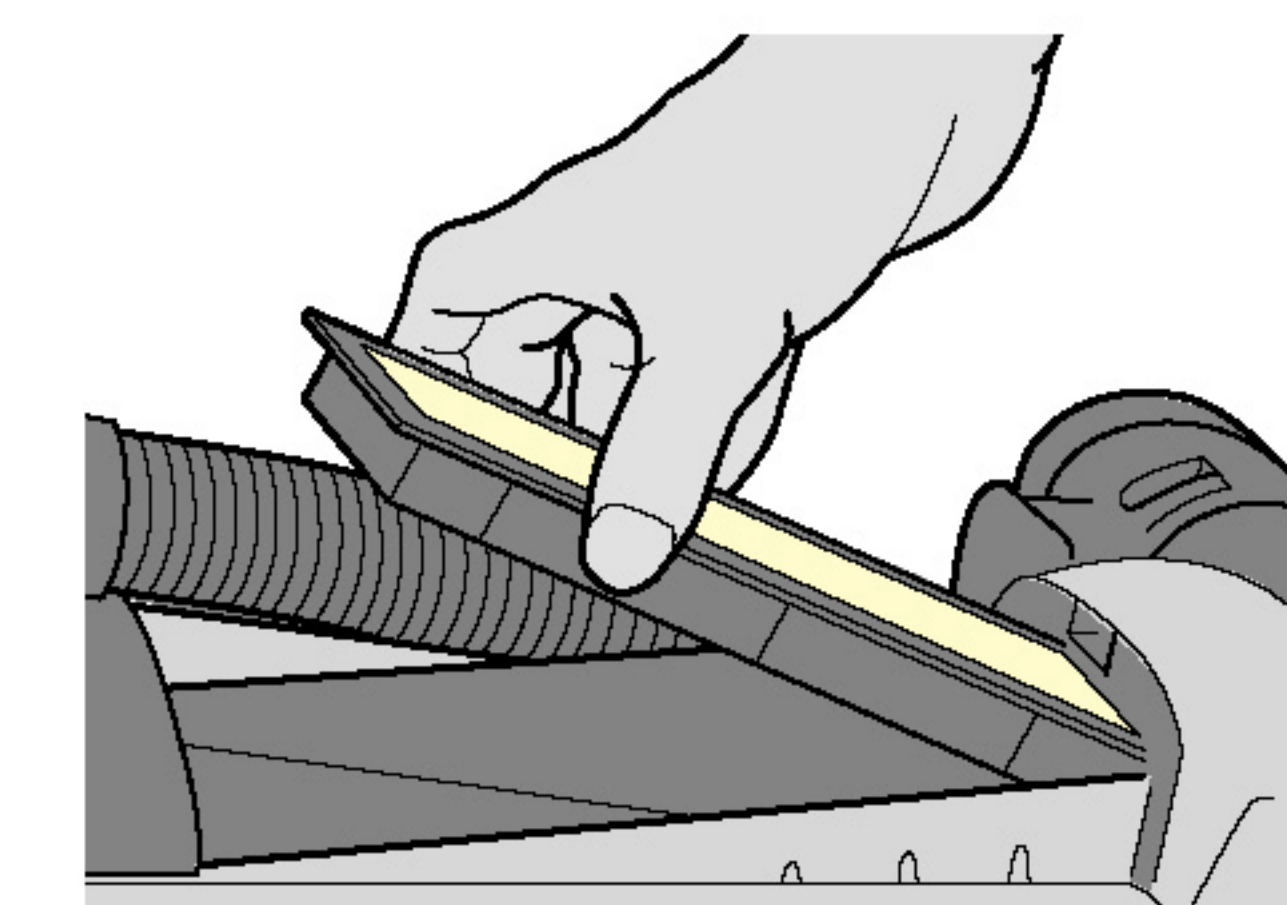
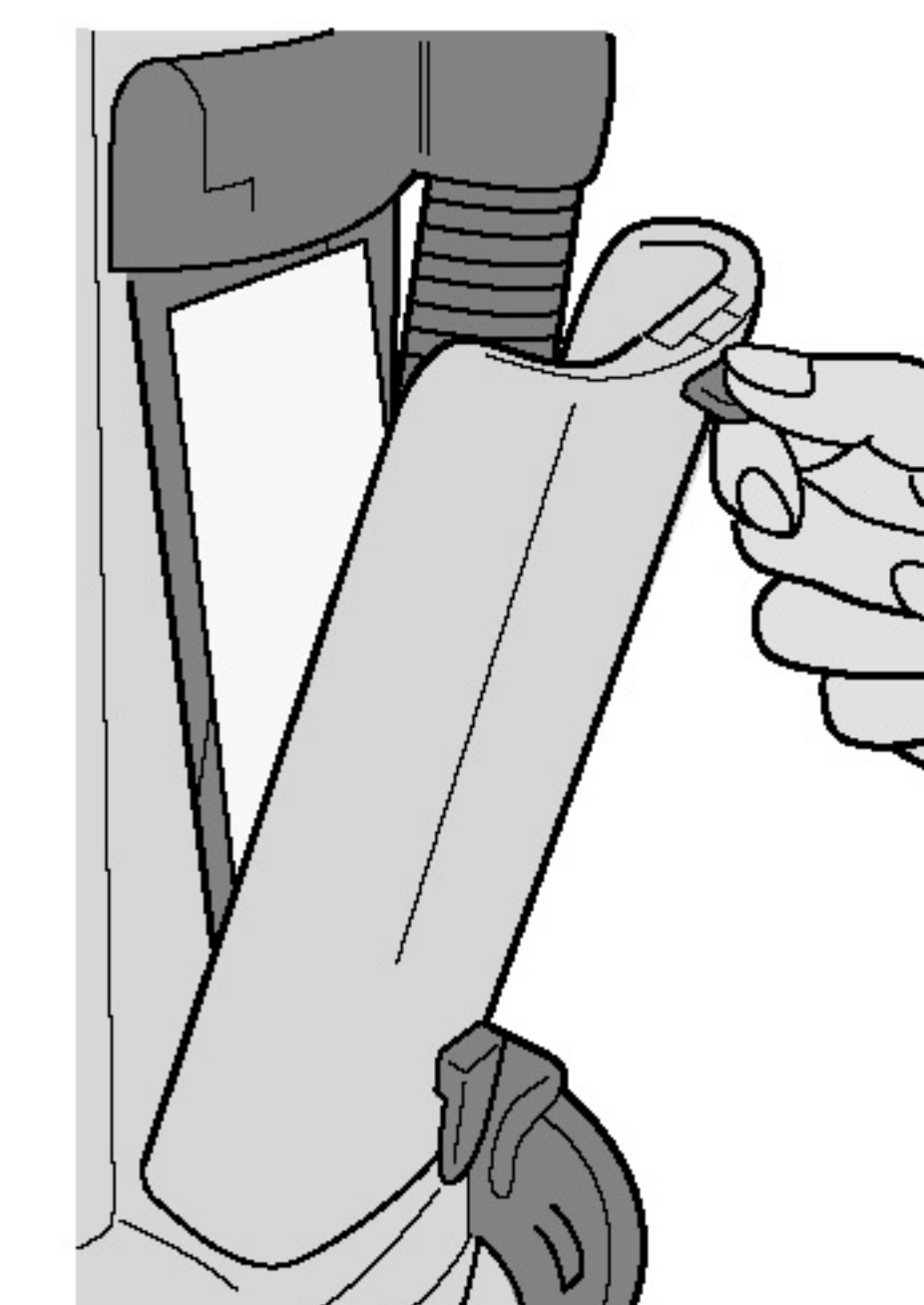

## CHANGING THE DISPOSAL BAG

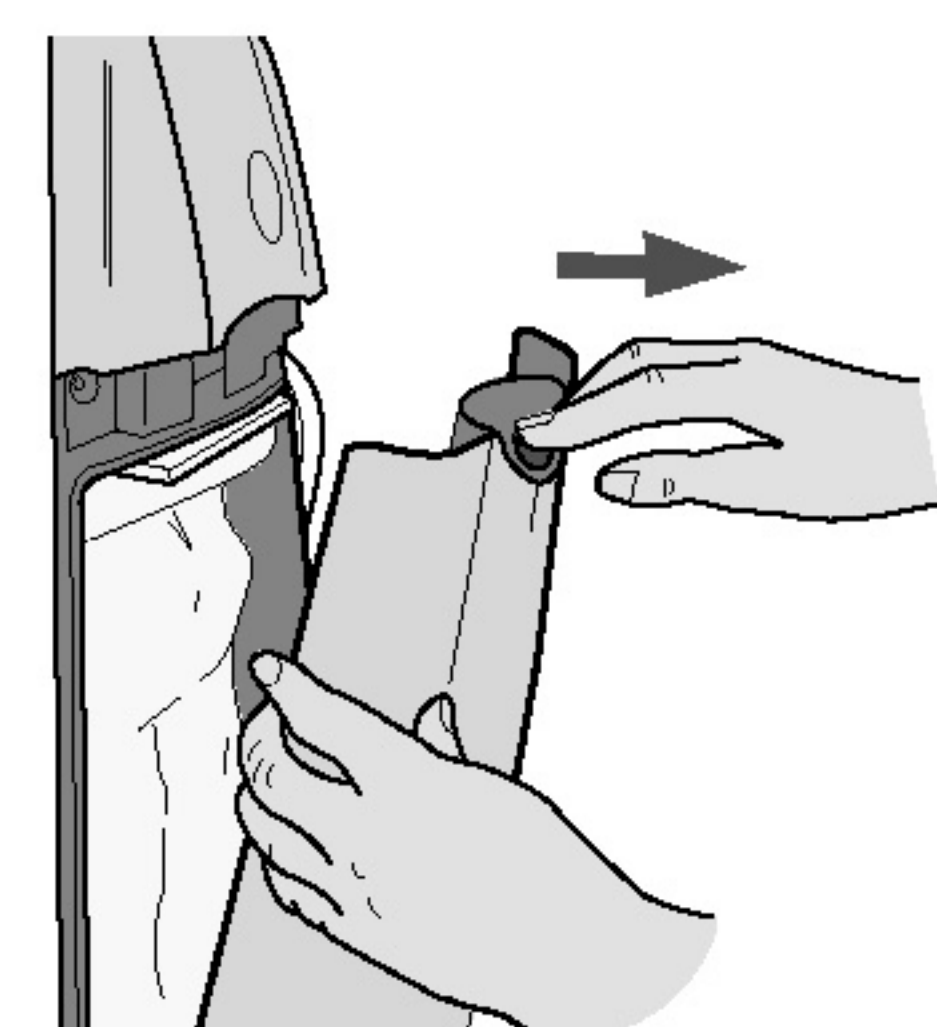

**To remove bag:**

- 1 Press down on door release pad and remove.
- 2 Gently pull bag collar retainer from hose inlet by pulling on stiff cardboard at top of bag.

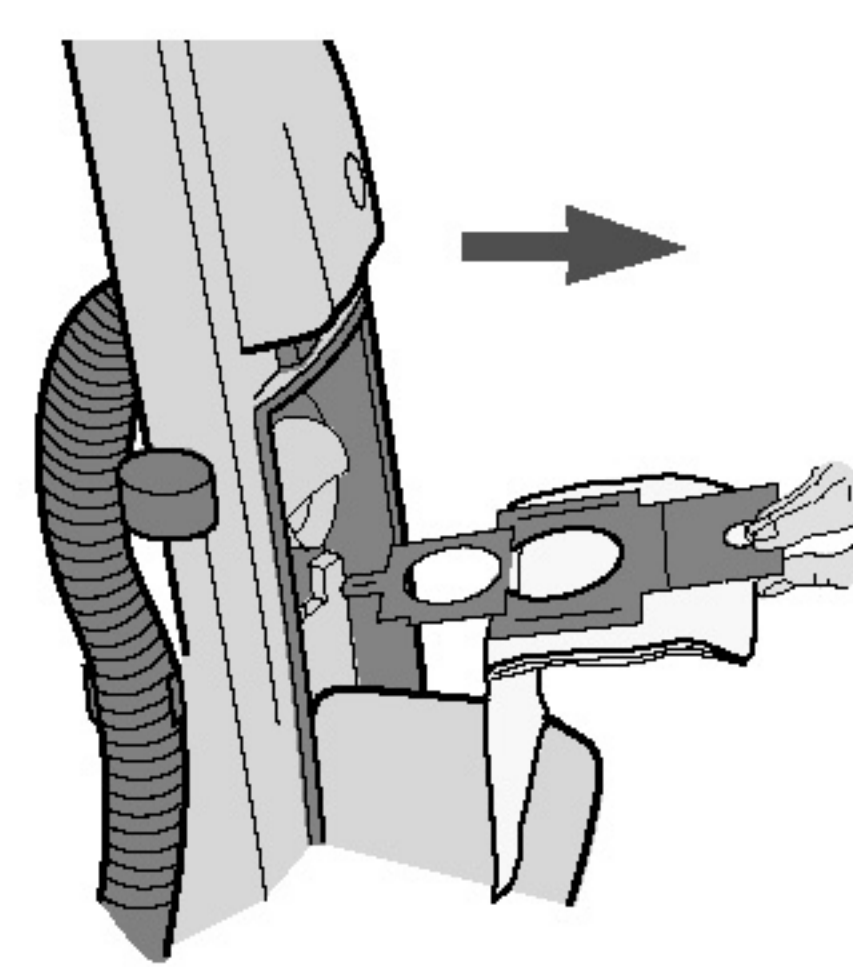

- 3 Slide bag from bag collar retainer by pulling on stiff cardboard at top of bag collar. A shutter will automatically seal off bag opening.
- 4 Discard full bag.

**IMPORTANT:** Switch cleaner off and remove plug from electricity supply before changing bag. Your cleaner is supplied with a bag already fitted. This bag **MUST NOT** be re-used.

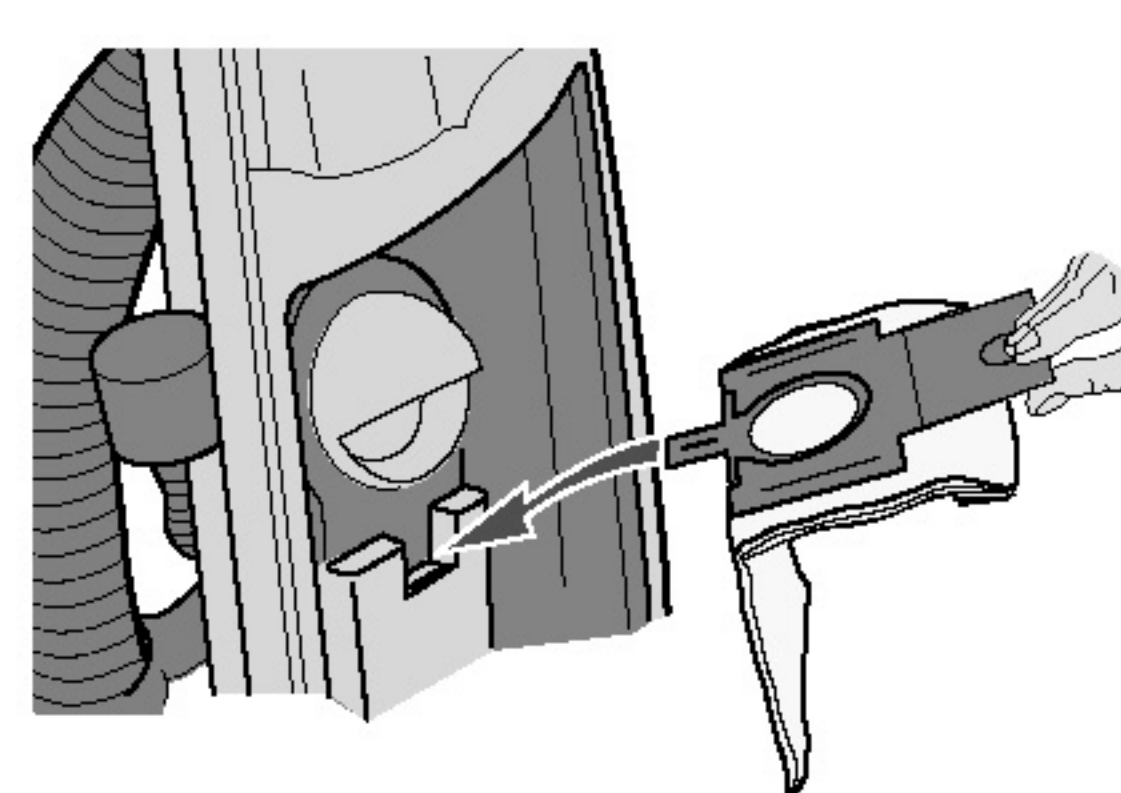

**To fit bag:**

- 1 Push the tab on the cardboard collar into the slot beneath the hose inlet.

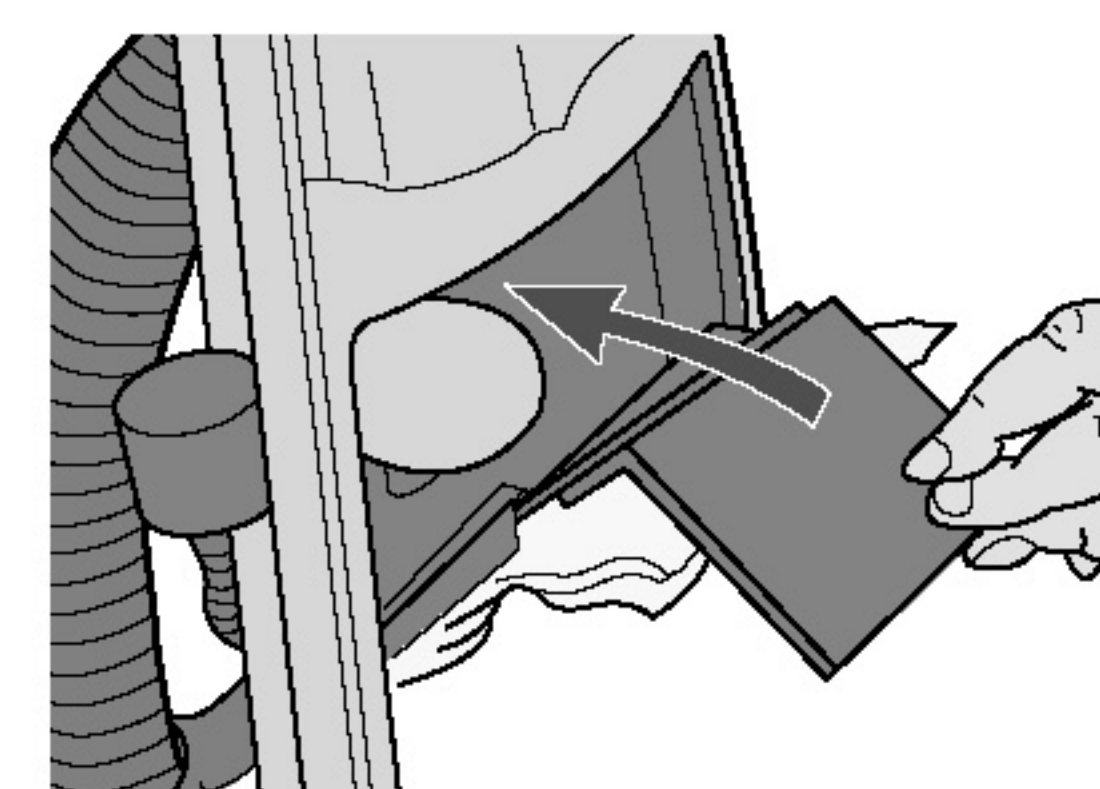

- 2 Push the bag collar over the hose inlet until it is firmly in place.
- 3 Open out the folds in the bag and refit bag door.



## CHANGING BELT OR BRUSHES



**IMPORTANT:** Switch cleaner off and remove plug from electricity supply before checking the brushes or removing hood.

If your cleaner is not picking up efficiently, the belt or brushes (or both) may need replacing, but first make sure you have:

- Emptied the dust container
- Cleaned filters
- Checked for blockages

1

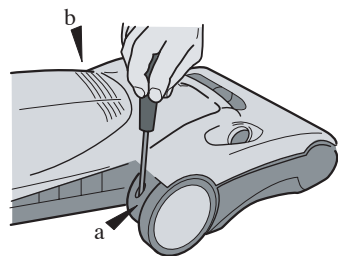

### Remove hood

- Prise off carpet-care control knob
  - Remove hood screws A and B
- Lift off hood

2

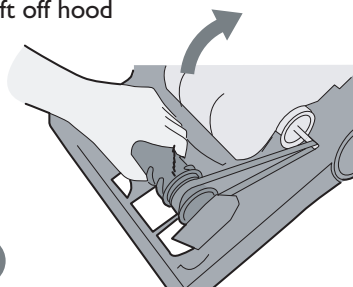

### Remove brush assembly

- Inspect belt for signs of wear.
- To remove, pull brush cleaner assembly upwards out of cleaner housing. Remove belt from motor spindle then from brush assembly.

### Replace belt

- Loop the new belt around the motor spindle then around the brush channel.

3

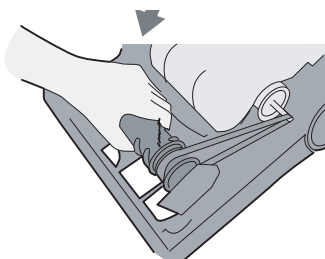

### Refit brush assembly

- Hold the brush assembly and stretch the belt until brush mountings slot down into the cleaner housing
- Rotate the brush to ensure free movement of the belt.

4

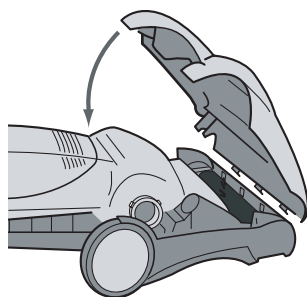

### Refit hood

- Refit hood, ensuring the lugs along the front of hood are located in the slots along the front edge of baseplate.
- Secure hood, using screws A and B.

5

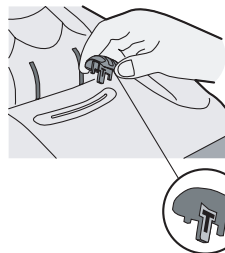

### Refit carpet-care control knob

- Ensure the raised face (T) is towards the front of the cleaner.

### Removing a blockage from the 'Pet hair remover'

(Certain models only)

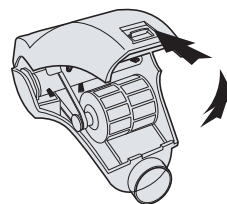

Open clip and lift cover to remove blockage.

## CLEARING A BLOCKAGE



**IMPORTANT:** Switch the cleaner off and remove the plug from the electricity supply before dismantling cleaner.

This cleaner is unlikely to become blocked, except by overfilling of the dust container or accidentally picking up large solid objects. Clearing a blockage is simple.

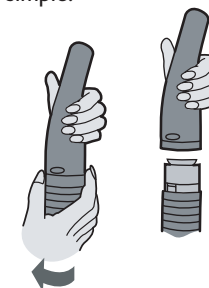

If cleaning tools were in use, check cleaning tool and extension tube first. Next check hose handgrip; to remove grip ribbed ring as shown, turn in direction of arrow and ease apart.

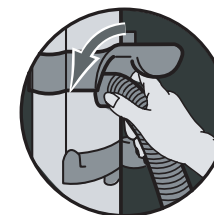

To check the hose, stretch it to full length and switch on the cleaner; the suction will dislodge most obstructions. If this is unsuccessful, switch off and unplug the cleaner. Remove the hose by turning it anti-clockwise as shown. Detach cassette and remove blockage.

### For blockages in cleaner base:

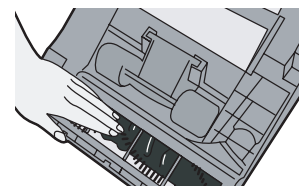

1. Turn the cleaner over and check that the brushes are free to rotate.

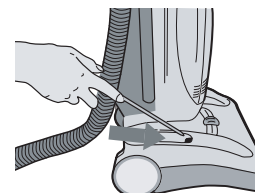

2. Check for a blockage in hose socket. Use a piece of wire or a blunt flexible rod to remove any obstructions.



**Genuine HOOVER spares  
Tel. 01204 556 111**

Always replace parts with genuine Hoover spares. These are available from your local Hoover dealer or direct from Hoover. When ordering parts always quote your model number.

**Hoover service  
Tel. 08705 400 600**

Should you require service at any time please call the HOOVER Service Office.

Hoover have a computerised nationwide service network of over 500 engineers who will respond quickly to your call and guarantee your repair for 12 months.

**GUARANTEE STATEMENT**

The guarantee conditions for this appliance are as defined by our representative in the country in which it is sold. Details regarding these conditions can be obtained from the dealer from whom the appliance was purchased, the bill of sale or receipt must be produced when making any claim under the terms of this guarantee.

Subject to change without notice.

**Use only HOOVER spares**

**Hoovercare**

To maintain your HOOVER product in peak condition you may also wish to take out a Hoovercare policy, for which an annual payment provides a comprehensive maintenance and repair scheme. For further information telephone the HOOVER Service Office.

**Quality, Safety & Environment**

As the owner of a new Hoover product we would like to tell you more about the high standards we have set in Quality, Safety and the Environment.

**Quality**

**BSI ISO 9001**

Hoover's factories have been independently assessed for quality. Our products are made using a quality system which meets the requirements of ISO 9001.

**Safety**

**Although safety certification of electrical appliances is not required by law in the UK, Hoover believe that independent approval is the best way of demonstrating safety in design and manufacture.**

**The British Electrotechnical Approvals Board (BEAB), the independent UK national authority for the safety of domestic electrical appliances, ensure that European Safety Standards are met and are maintained throughout the production life of an appliance.**

All appliances which pass these tests are permitted to carry this BEAB mark of safety:



**Environment - Weee Directive**



This appliance is marked according to the European Directive 2002/96/EC on Waste Electrical and Electronic Equipment (WEEE)

By ensuring this product is disposed of correctly you will help prevent potential negative consequences for the environment and human health, which could otherwise be caused by inappropriate waste handling of this product.

The symbol on the product indicates that this product may not be treated as household waste. Instead it shall be handed over to the applicable collection point for the recycling of electrical and electronic equipment.

Disposal must be carried out in accordance with local environmental regulations for waste disposal .

For more detailed information about treatment, recovery and recycling of this product, please contact your local city office, your household waste disposal service or the shop where you purchased the product.

## Bag check indicator

(certain models only)

**For an accurate reading of the bag check indicator ensure that:**

- flexible hose handgrip is pushed firmly into its socket.
- On Variable Power models control is set to maximum.

The **continuous red light** of the bag check indicator will come on if:

- Bag needs replacement. If picking up fine powders more frequent replacement will be required even although the bag does not appear well filled.
- Filters are dirty.
- There is a blockage.

The light may flicker on and off during normal use.

### WARNING!

**A thermal cut out switches off the cleaner to prevent overheating if it is used when full or there is a blockage or dirty filters. If this should happen switch off, unplug and correct the fault.**

**It will take about 30 minutes for the cut out to automatically reset.**

**IMPORTANT: Do not run cleaner over the supply cord as this could damage the supply cord insulation.**

ISO9001

BEAB  
Approved

## User checklist

If your cleaner is not working properly run through the following checklist.

1. Is there a working electricity supply to the cleaner?  
Check with another electrical product.
2. Is the bag full or choked with fine dust?
3. Is the hose blocked?
4. Is there a blockage in the cleaner base?
5. Are the filters blocked?
6. Is the nozzle height set correctly?
7. Are the brushes rotating correctly?
8. Has the cleaner overheated? If so, it will take about 30 minutes to reset.

If there is any doubt call your local Hoover Service Office for advice. They may be able to assist you over the telephone.



Hoover Limited  
Pentrebach  
Merthyr Tydfil  
Mid-Glamorgan  
CF48 4TU

Copyright 2001  
\*Registered Trade Mark  
Part no: 05655202