

Shark®

V3800UK

OWNER'S GUIDE

www.sharkclean.eu



IMPORTANT SAFETY INSTRUCTIONS

For Household Use Only

WHEN USING YOUR SHARK® CORDLESS SWEEPER, BASIC SAFETY PRECAUTIONS SHOULD ALWAYS BE FOLLOWED, INCLUDING THE FOLLOWING:

READ ALL INSTRUCTIONS BEFORE USING YOUR SHARK® CORDLESS SWEEPER.

IMPORTANT: This appliance is not intended for use by persons with reduced physical, sensory or mental capabilities, or lack of experience and knowledge, unless they have been given supervision or instruction concerning use of the appliance by a person responsible for their safety.

Children shall not use or play with this appliance. Close supervision is necessary to keep appliance out of reach of children during use.

WARNING: **TO REDUCE THE RISK OF FIRE, ELECTRIC SHOCK OR INJURY:**

1. **DO NOT** charge this unit outdoors.
2. **DO NOT** use outdoors or on wet surfaces.
3. Use **ONLY** as described in this manual. Use only manufacturer's recommended attachments.
4. Unplug from electrical outlet when not in use and before servicing.
5. **DO NOT** use with damaged cord or plug.
6. **DO NOT** use if the appliance is not working, has been dropped, dropped into water, damaged or left outdoors.
7. **NO SERVICEABLE PARTS.** Incorrect re-assembly or repair can cause a risk of electrical shock or injury to persons when the appliance is used. Contact Customer Service.
8. **DO NOT** abuse the charger cord. Never carry the charger or base by the cord or yank to disconnect from an outlet; instead grasp the charger and pull to disconnect.
9. Keep charger cord away from heated surfaces.
10. This product includes Lithium Ion batteries. Batteries must be recycled or disposed of properly. Do not incinerate batteries or expose to high temperatures, as they may explode.
11. **DO NOT** handle plug or appliance with wet hands.
12. **DO NOT** put any object into openings. Do not use with brush roll blocked; keep free of fibre, lint, hair and anything that may prevent brush roll from working.
13. Keep hair, loose clothing, fingers, and all parts of body away from openings and moving parts.
14. **DO NOT** pick up anything that is burning or smoking, such as cigarettes, matches, or hot ashes.

15. Use extra care when cleaning on stairs.
16. **DO NOT** use to pick up flammable or combustible liquids such as gasoline or use in areas where they may be present.
17. Read and follow all labels, operational and marking instructions.
18. **DO NOT** use charger with an extension cord. Plug charger directly into an electrical outlet. Use charger only in a standard (100-240V~, 50/60Hz) electrical outlet.
19. **DO NOT** use the Cordless Sweeper without dust cup in place.
20. Store the Cordless Sweeper indoors. Store the appliance after use to prevent accidents.
21. Discontinue use if the battery runtime changes abruptly or battery has white residual (venting) near positive terminal or the cell is deformed or leaked.
22. Use only on dry, indoor surfaces.
23. **DO NOT** use for any purpose other than described in this user's guide.
24. **DO NOT** attempt to use the charger with any other product or attempt to charge this product with another charger. Use only charger CHV3900BS supplied with this Cordless Sweeper.
25. The charger converts the 100-240V AC voltage to safety extra-low voltage.
26. The Cordless Sweeper must be disconnected from the power supply when removing the battery.

TO MAXIMISE THE LIFE OF YOUR LITHIUM ION BATTERIES:

1. Charge for 3.5 hours before initial use.
2. **DO NOT** store unit with the charging adapter attached and plugged in.
3. **DO NOT** store in areas of high temperature or humidity.
4. Use only the charger supplied with the product. If other chargers are used, the batteries can fail causing damage to the battery, product, or personal property.
5. Do not attempt to replace the battery with another manufacturer or different battery chemistry (alkaline). The battery is designed specifically for this product. The battery part number for this product is **XBTV3900**.

⚠ NOTE: Li-Ion batteries have a long useful life but at some time they will need to be replaced. To purchase replacement batteries, visit **www.sharkclean.eu**.

To remove and replace the batteries, refer to "Removing and Replacing the Battery" section on page 11.

⚠ NOTE: The Power Switch must be switched in the "Off" position in order to charge the unit. If the charging indicator does not light, press the On/Off button once.

⚠ IMPORTANT: This appliance contains Li-Ion batteries. The batteries must be recycled or disposed of in accordance with local regulations. The batteries must be removed from the appliance before it is scrapped. Please consult your local recycling centre for more information.

SAVE THESE INSTRUCTIONS

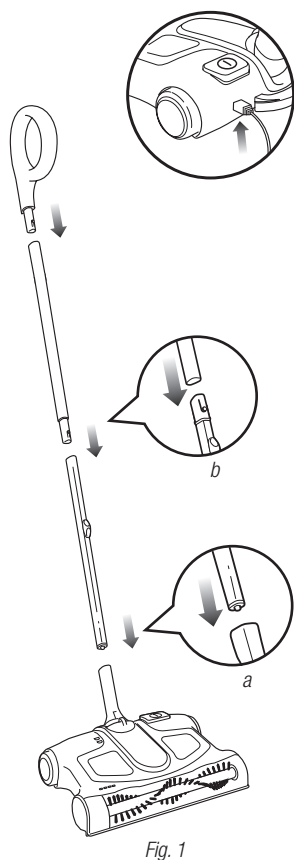

IMPORTANT: Before you can start using your new Cordless Sweeper, charge it for 3.5 hours.

NOTE: The charging adapter will be shipped inside the packaging.

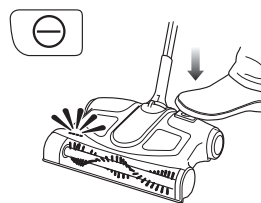
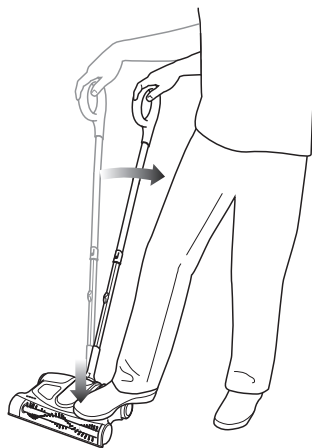

ASSEMBLE

- 1 Insert the lower extension tube into the head connector (a). Then insert the upper extension tube into the lower extension tube (b). Now attach the upper handle to the upper extension tube. (Fig. 1)

CLEAN

- 2 Pull back on the handle and press lightly on the body of the unit with your foot to engage the steering. (Fig. 2)
- 3 Using your foot, press the power button and push the unit forward over the surface you wish to clean. (Fig. 3)

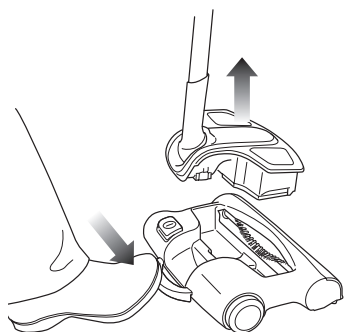

Fig. 4

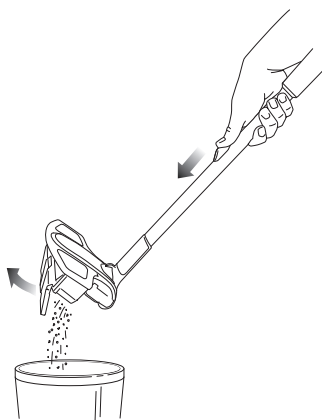

Fig. 5

EMPTY

- 4 When you're finished cleaning, empty the No Touch Dust Cup. Simply press the dust cup release pedal and lift out the dust cup. **(Fig. 4)**

⚠ NOTE: Be careful not to accidentally turn the unit on.

- 5 Over a rubbish bin, empty the dust cup by pressing the bottom-empty button on the lower portion of the handle. When it's empty, gently snap the No Touch Dust Cup back into place. **(Fig. 5)**

This appliance complies with the WEEE-Directive 2012/19/EU on the disposal of electrical and electronic equipment (WEEE).



This marking indicates that this product should not be disposed with other household wastes throughout the EU. To prevent possible harm to the environment or human health from uncontrolled waste disposal (especially the battery), recycle it responsibly to promote the sustainable reuse of material sources. To return your used device, please use the return and collection systems or contact the retailer where this product was purchased. They can take this product for environmental safe recycling.

This appliance complies with the European directives for electromagnetic compatibility (EMC) 2004/108/EC and its revisions, as well as Low Voltage Directive (LVD) 2006/95/EC and its revisions.

Guarantee: This product is unconditionally guaranteed for one year against all defects of workmanship and materials. This guarantee does not affect your statutory rights. If this product proves unsatisfactory please contact our customer service department on freephone 0800 862 0453 or by e-mail ukservice@euro-pro.com.

THIS MANUAL COVERS MODEL NUMBER:

V3800UK 32

TECHNICAL SPECIFICATIONS

Voltage: 7.2V ---

Power: 22 Watts

Charger Output: 10V --- 1000mA

Euro-Pro and **Shark** are trademarks of Euro-Pro Operating LLC. All other brand names may be trademarks of their respective owners.

RoHS



Li-Ion



Contents

**Thank you for
purchasing the Shark®
Cordless Sweeper.**

Assembly	8
Charging Your Shark® Cordless Sweeper	9
Using Your Shark® Cordless Sweeper	9
Emptying the No Touch Dust Cup	10
Storing Your Shark® Cordless Sweeper	10
Maintenance.....	11
Troubleshooting Guide.....	12
Ordering Replacement Parts	12

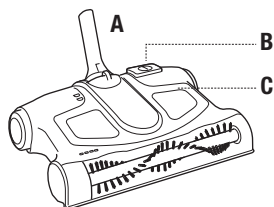

COMPONENTS:

- A** Main Unit
- B** Power Button
- C** No Touch Dust Cup
- D** Upper Handle
- E** Upper Handle Extension Tube
- F** Lower Handle Extension Tube
- G** No Touch Dust Cup Empty Button
- H** Charging Adapter

ASSEMBLY OF YOUR CORDLESS SWEEPER:

NOTE: The charging adapter will be shipped inside the packaging.

IMPORTANT: Charge the batteries for 3.5 hours before using the unit for the first time. See page 9 for instructions on charging your unit.

- 1** Insert the lower extension tube into the head connector (a). Then insert the upper extension tube into the lower extension tube (b). Now attach the upper handle to the upper extension tube. (**Fig. 1**)

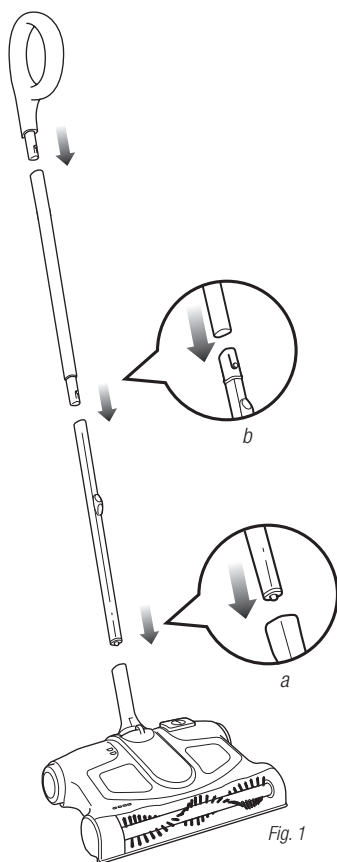

Fig. 1

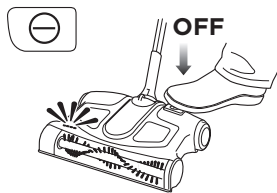

Fig. 2

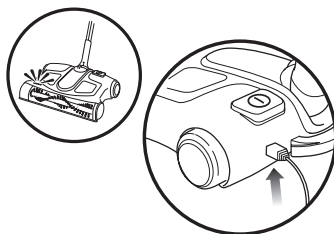

Fig. 3

- 1 Always make sure that the unit is turned off. **(Fig. 2)**
- 2 Insert the charger plug into the back of the unit then plug it into a wall outlet. The 4 blue LED lights will light up sequentially from 1 (Low) to 4 (high) while charging. When all 4 lights turn solid blue, the unit is fully charged and ready for use. If the lights do not illuminate when the unit's plugged in, press the power button once. The lights should start the illuminating sequence, signifying the unit is charging. **(Fig. 3)**

- NOTE:** When the power switch is on the sweeper will not charge.
- 3 Charge the battery for 3.5 hours before initial use and 3.5 hours for each recharge. Our Cordless Sweeper is powered by Li-Ion batteries that need this time to build up their charge. All 4 will turn blue when the unit is fully charged.
 - 4 For best battery performance, remove the charging adapter from the unit after the charging period has completed. Storing the unit with the adapter attached and plugged in will reduce the battery life.

- 5 The LED lights indicate battery capacity. As the unit loses battery strength, the LED lights will begin to turn off in a descending order, from 4 (High) to 1 (Low). When all four lights begin flashing, the motor on the unit will stop working. Please recharge the batteries according to step 2.

IMPORTANT: Although many adapters look similar, it's important to use only the adapter that came with the unit CHV3900BS.

USING YOUR SHARK® CORDLESS SWEEPER

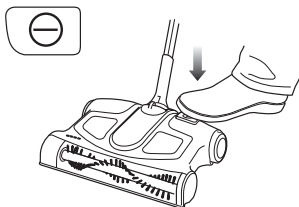

Fig. 4

If the brush roll stops moving, it's probably due to the anti-jam feature. This feature protects the motor from becoming

overheated. If the brush becomes overloaded, it will stop turning and both speed indicator and the first LED light will flash. Turn off your unit by pressing the power button once. See page 12 for further instructions on removing or cleaning the brush roll. Wait for 10 seconds to let your unit cool down. Now press the power button again and you're ready to resume cleaning!

- 1 Press the power button to start the unit. When finished cleaning, press the power button again to turn the unit off. **(Fig. 4)**
- 2 Do not use the unit to pick up liquids or clean wet floors.
- 3 Do not use the unit on concrete, tar or other rough surfaces.
- 4 Do not use the unit to pick up pieces of string or fabrics. Do not use the unit to clean tasselled or frayed carpets.

EMPTYING THE NO TOUCH DUST CUP

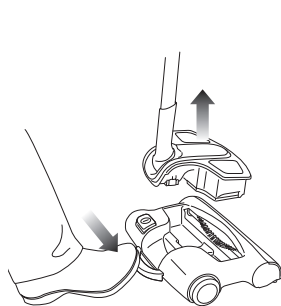

Fig. 5

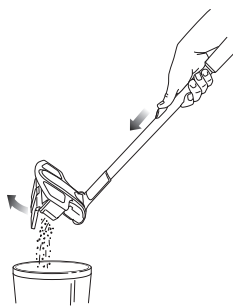

Fig. 6

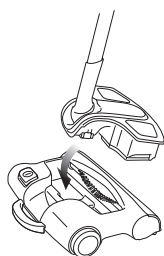

Fig. 7

- 1 To achieve the best performance, empty the No Touch Dust Cup after each use. Press the No Touch Dust Cup release pedal on back of the unit to remove the No Touch Dust Cup. **(Fig. 5)**
- 2 Hold the No Touch Dust Cup over a rubbish bin and push the No Touch Dust Cup empty button located on the lower portion of the handle. The trap door will spring open and release the debris into the rubbish bin. **(Fig. 6)**
- 3 To re-insert the No Touch Dust Cup, position it over the unit and press down gently until it snaps into place. **(Fig. 7)**



For easy insertion into the base, tip the No Touch Dust Cup slightly forward.

STORING YOUR SHARK® CORDLESS SWEEPER

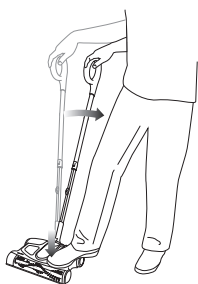

Fig. 8

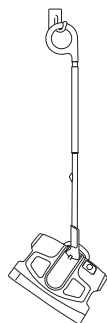

Fig. 9

- 1 Properly storing your unit will keep it ready to go the next time you want to use it. Store the unit in a dry area where it won't be exposed to the elements.
- 2 When storing your cordless sweeper, hang the handle from a hook.
- 3 Always empty the No Touch Dust Cup before storing.
- 4 Pull back on the handle and press lightly on the body of the unit with your foot. **(Fig. 8)**
- 5 Lift the unit and rotate the base one quarter turn so that you can lay it flat against the wall. Hang the unit using the handle from a hook secured to a wall or other vertical surface. **(Fig. 9)**



CAUTION: Any electronic appliance should not be stored in or exposed to areas of high heat or humidity. Do not store the unit close to stoves, radiators, furnaces or in a bathroom or bathing area.

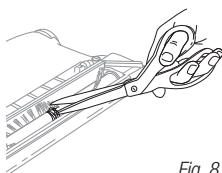

Fig. 8

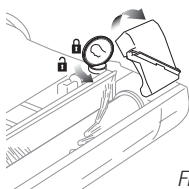

Fig. 9

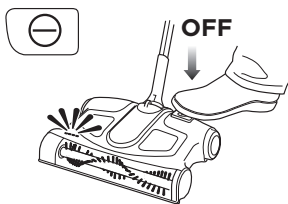

Fig. 10

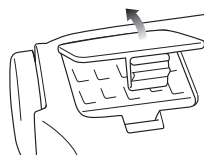

Fig. 11

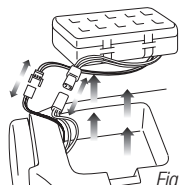

Fig. 12

CAUTION: Do not clean the unit while it is charging.

- Once a month, wipe down the unit with a dry cloth, including the area under the No Touch Dust Cup. Wipe away any hair, fibre or other dirt that may have built up in the chamber and on the rotating brush. Do not use any harsh cleaner or chemicals.
- Do not immerse the unit in water.

CLEANING THE ROTATING BRUSH

- Press the No Touch Dust Cup release pedal with your foot and remove the No Touch Dust Cup from the unit.
- Turn the unit upside down. Be careful not to accidentally turn the unit on!
- Remove all hair, string or fibres wrapped around the brush bar. Using a pair of scissors, carefully cut along the raised guide to remove anything wound around the brush bar. Avoid damaging or cutting the bristles. (Fig. 8)

- Use a coin to remove the trap door if you need to remove the brushroll to either clean it or replace it. (Fig. 9)

REMOVING AND REPLACING THE BATTERY

NOTE: Make sure the charging adaptor is not connected to the sweeper when removing or replacing the batteries.

NOTE: If uncertain as to how to remove your battery pack, we suggest you take the unit to a reputable small appliance service technician to have this service performed.

- Make sure the unit is off. If not, press the power button once to turn the unit "OFF". (Fig. 10)
- Turn the unit upside down.
- Push in the locking tab and lift off the battery compartment cover. (Fig. 11)
- Carefully lift out the battery pack and disconnect the wire terminals by pressing on the latch and pulling apart the wire terminal connectors. (Fig. 12)

- Remove the battery pack. (Fig. 12)
- Connect the wire terminal from the unit to the wire terminal connector of the new Shark® battery pack (XBTV3900) and replace the battery pack into the unit.
- Replace the battery compartment cover.
- Please call customer service at 0800 862 0453 if you have any problems removing the battery pack.

IMPORTANT: This appliance contains Li-Ion batteries. The batteries must be recycled or disposed of in accordance with local regulations. Please consult your local recycling centre for more information.

WARNING: Never use ordinary batteries for replacement as these may leak and cause damage. Use only battery pack XBTV3900 for replacement.



**LI-ION BATTERY
MUST BE RECYCLED
OR DISPOSED OF
PROPERLY**

PROBLEM	POSSIBLE REASONS AND SUGGESTED SOLUTION
The unit will not operate or the charging light is flashing	<p>Batteries need to be recharged.</p> <p>Batteries are dead and need to be replaced.</p> <p>There is no power in the electrical outlet supplying the charging adapter. Try to charge using a different outlet.</p> <p>Ensure the wire terminal connectors on the battery pack are securely attached.</p> <p>If the unit still doesn't work, call Customer Service at 0800 862 0453.</p>
The unit will not pick up	<p>Empty the No Touch Dust Cup.</p> <p>Recharge the battery.</p>
Dust is escaping from the unit	<p>Empty the No Touch Dust Cup.</p> <p>Ensure that the No Touch Dust Cup is properly in place.</p>
The rotating brush will not pick up	<p>Check for and remove any excessive material on the brush roll or in the bottom of the unit.</p> <p>Empty the No Touch Dust Cup.</p>
The unit will not charge	<p>Press the power button once to turn the unit "OFF".</p> <p>There is no power in the electrical outlet supplying the charging adapter. Try to charge using a different outlet.</p> <p>Ensure the wire terminal connectors on the battery pack are securely attached.</p> <p>Charging adapter may not be working. Call Customer Service at 0800 862 0453.</p> <p>Batteries are dead and need to be replaced.</p>

ORDERING REPLACEMENT PARTS

REPLACEMENT PARTS

- A** XBTV3900 Battery Pack
- B** CHV3900BS AC Adapter

To order any of the above replacement parts, go to **www.sharkclean.eu** or call **0800 862 0453**.

[illegible]

[illegible]

Euro-Pro Europe Limited
1 Mariner Court
Calder Park
Wakefield
WF4 3FL

Freephone 0800 862 0453

www.sharkclean.eu

Technical Details

Model number: V3800UK 32

Voltage: 7.2V 

Power: 22 Watts

Charger Output: 10V  1000mA

COPYRIGHT © EURO-PRO OPERATING LLC 2014

Euro-Pro and Shark are trademarks of Euro-Pro Operating LLC. All other brand names may be trademarks of their respective owners.

PRINTED IN CHINA

V3800UK_32_140804_2

Illustrations may differ from actual product.

RoHS



Li-Ion

