



WW90H7600E*
WW90H7410E*
WW80H7600E*
WW80H7410E*

Washing Machine

user manual

**Planet
First** 100%
Recycled Paper

This manual is made with 100% recycled paper.

Imagine the possibilities

Thank you for purchasing this Samsung product.



Contents

Safety information	3
What you need to know about safety instructions	3
Important safety symbols.....	3
Important safety precautions	4
Instruction about the WEEE	10
Installation	11
What's included.....	11
Installation requirements	12
Step-by-step installation.....	14
Before you start	18
Initial settings	18
Laundry guidelines.....	19
Detergent drawer guidelines	21
Operations	23
Control panel.....	23
Simple steps to start.....	24
Course overview	25
Settings.....	28
Maintenance	29
Eco Drum Clean	29
Smart Care.....	30
Emergency drain	31
Cleaning	32
Recovery from freezing	35
Care against an extended time of disuse.....	35
Troubleshooting	36
Checkpoints.....	36
Information codes	37
Specifications	38
Protecting the environment.....	38
Declaration of conformity.....	38
Fabric care chart	39
Sheet of household washing machines.....	40
Information of main washing programmes.....	42

Safety information

Congratulations on your new Samsung washing machine. This manual contains important information on the installation, use and care of your appliance. Please take some time to read this manual to take full advantage of your washing machine's many benefits and features.

What you need to know about safety instructions



Please read this manual thoroughly to ensure that you know how to safely and efficiently operate the extensive features and functions of your new appliance. Please store the manual in a safe location close to the appliance for future reference. Use this appliance only for its intended purpose as described in this instruction manual.

Warnings and Important Safety Instructions in this manual do not cover all possible conditions and situations that may occur. It is your responsibility to use common sense, caution and care when installing, maintaining and operating your washing machine.

Because the following operating instructions cover various models, the characteristics of your washing machine may differ slightly from those described in this manual and not all warning signs may be applicable. If you have any questions or concerns, contact your nearest service centre or find help and information online at www.samsung.com.

Important safety symbols

What the icons and signs in this user manual mean:

	WARNING: Hazards or unsafe practices that may result in severe personal injury, death and/or property damage.
	CAUTION: Hazards or unsafe practices that may result in personal injury and/or property damage.
	NOTE

These warning signs are here to prevent injury to yourself and others.

Please follow them explicitly.

After reading this manual, store it in a safe place for future reference.

Read all instructions before using the appliance.

As with any equipment that uses electricity and moving parts, potential hazards exist. To safely operate this appliance, familiarize yourself with its operation and exercise care when using it.

Important safety precautions

 **WARNING:** To reduce the risk of fire, electric shock, or injury to persons when using your appliance, follow basic precautions, including the following:

Do not let children (or pets) play in or on your washing machine. The washing machine door does not open easily from the inside and children may be seriously injured if trapped inside.

This appliance is not to be used by persons (including children) with reduced physical, sensory or mental capabilities, or lack of experience and knowledge, unless they have been given supervision or instruction concerning use of the appliance by a person responsible for their safety.

Children should be supervised to ensure that they do not play with the appliance.

For use in Europe: This appliance can be used by children aged from 8 years and above and persons with reduced physical, sensory or mental capabilities or lack of experience and knowledge if they have been given supervision or instruction concerning use of the appliance in a safe way and understand the hazards involved. Children shall not play with the appliance. Cleaning and user maintenance shall not be made by children without supervision.

If the supply cord is damaged, it must be replaced by the manufacturer, its service agent or similarly qualified persons in order to avoid a hazard.

This appliance should be positioned so that the power plug, the water supply taps, and the drain pipes are accessible.

For appliances with ventilation openings in the base, that a carpet must not obstruct the openings.

The new hose-sets supplied with the appliance are to be used and that old hose-sets should not be reused.

CAUTION: In order to avoid a hazard due to inadvertent resetting of the thermal cut-out, this appliance must not be supplied through an external switching device, such as a timer, or connected to a circuit that is regularly switched on and off by the utility.

⚠ WARNING: Critical installation WARNINGS

The installation of this appliance must be performed by a qualified technician or service company.

- Failure to do so may result in electric shock, fire, an explosion, problems with the product, or injury.

The appliance is heavy, therefore take care when lifting it.

Plug the power cord into an AC 220 - 240 V / 50 Hz wall socket or higher and use the socket for this appliance only. Never use an extension cord.

- Sharing a wall socket with other appliances using a power strip or extending the power cord may result in electric shock or fire.
- Ensure that the power voltage, frequency, and current are the same as those of the product specifications. Failure to do so may result in electric shock or fire. Plug the power plug into the wall socket firmly.

Remove all foreign substances such as dust or water from the power plug terminals and contact points using a dry cloth on a regular basis.

- Unplug the power plug and clean it with a dry cloth.
- Failure to do so may result in electric shock or fire.

Plug the power plug into the wall socket so that the cord is running towards the floor.

- If you plug the power plug into the socket in the opposite direction, the electric wires within the cable may be damaged and this may result in electric shock or fire.

Keep all packaging materials out of the reach of children as these may be dangerous.

- If a child places a bag over its head, it may suffocate.

When the appliance, power plug or power cord is damaged, contact your nearest service centre.

This appliance must be properly grounded.

Do not ground the appliance to a gas pipe, plastic water pipe, or telephone line.

- This may result in electric shock, fire, an explosion, or problems with the product.
- Never plug the power cord into a socket that is not grounded correctly and make sure that it is in accordance with local and national regulations.

Do not install this appliance near a heater or any inflammable material.

Do not install this appliance in a humid, oily or dusty location, or in a location exposed to direct sunlight or water (rain drops).

Do not install this appliance in a location exposed to low temperatures.

- Frost may cause the tubes to burst.

Do not install this appliance in a location where gas may leak.

- This may result in electric shock or fire.

Do not use an electric transformer.

- This may result in electric shock or fire.

Do not use a damaged power plug, damaged power cord, or loose wall socket.

- This may result in electric shock or fire.

Do not pull or excessively bend the power cord.

Do not twist or tie the power cord.

Do not hook the power cord over a metal object, place a heavy object on the power cord, insert the power cord between objects, or push the power cord into the space behind the appliance.

- This may result in electric shock or fire.

Do not pull the power cord when unplugging the power plug.

- Unplug the power plug by holding the plug.
- Failure to do so may result in electric shock or fire.

CAUTION: Installation CAUTIONS

This appliance should be positioned in such a way that the power plug is easily accessible.

- Failure to do so may result in electric shock or fire due to electric leakage.

Install your appliance on a solid, level floor that can support its weight.

- Failure to do so may result in abnormal vibrations, movement, noise, or problems with the product.

Do not install this appliance in a location exposed to low temperatures.

- Frost may cause the tubes to burst.

WARNING: Critical usage WARNINGS

If the appliance is flooded, turn off the water & power supplies immediately and contact your nearest service centre.

- Do not touch the power plug with wet hands.
- Failure to do so may result in electric shock.

If the appliance generates a strange noise, a burning smell, or smoke, unplug the power plug immediately and contact your nearest service centre.

- Failure to do so may result in electric shock or fire.

In the event of a gas leak (such as propane gas, LP gas, etc.), ventilate immediately without touching the power plug. Do not touch the appliance or power cord.

- Do not use a ventilating fan.
- A spark may result in an explosion or fire.

Do not let children play in or on the washing machine. In addition, when disposing of the appliance, remove the washing machine door lever.

- If trapped inside the product, children may suffocate to death.

Make sure to remove the packaging (sponge, styrofoam) attached to the bottom of the washing machine before using it.

Do not wash items contaminated with gasoline, kerosene, benzene, paint thinner, alcohol or other inflammable or explosive substances.

- This may result in electric shock, fire, or an explosion.

Do not open the washing machine door by force while it is operating (high-temperature washing/drying/spinning).

- Water flowing out of the washing machine may result in burns or cause the floor to be slippery. This may result in injury.
- Opening the door by force may result in damage to the product or injury.

Do not insert your hand under the washing machine while an operation is in progress.

- This may result in injury.

Do not touch the power plug with wet hands.

- This may result in electric shock.

Do not turn the appliance off by unplugging the power plug while an operation is in progress.

- Plugging the power plug into the wall socket again may cause a spark and result in electric shock or fire.

Do not let children or the infirm use this washing machine without proper supervision. Do not let children climb in or onto the appliance.

- This may result in electric shock, burns or injury.

Do not insert your hand or a metal object under the washing machine while it is operating.

- This may result in injury.

Do not unplug the appliance by pulling the power cord. Always grip the plug firmly and pull it straight out of the outlet.

- Damage to the power cord may cause a short-circuit, fire and/or electric shock.

Do not attempt to repair, disassemble, or modify the appliance yourself.

- Do not use a fuse (such as copper, steel wire, etc.) other than a standard fuse.
- When the appliance needs to be repaired or reinstalled, contact your nearest service centre.
- Failure to do so may result in electric shock, fire, problems with the product, or injury.

If the water supply hose comes loose from the water tap and floods the appliance, unplug the power plug.

- Failure to do so may result in electric shock or fire.

Unplug the power plug when the appliance is not being used for long periods of time or during a thunder or lightning storm.

- Failure to do so may result in electric shock or fire.

If any foreign substance enters into the appliance, unplug the power plug and contact you nearest Samsung Customer Service.

- This may result in electric shock or fire.

CAUTION: Usage CAUTIONS

When the washing machine is contaminated by a foreign substance such as detergent, dirt, food waste, etc., unplug the power plug and clean the washing machine using a damp, soft cloth.

- Failure to do so may result in discolouration, deformation, damage, or rust.

The front glass may be broken by a strong impact. Take care when using the washing machine.

- If the glass is broken, it may result in injury.

After a water supply failure or when reconnecting the water supply hose, open the water tap slowly.

Open the water tap slowly after a long period of non-use.

- The air pressure in the water supply hose or the water pipe may damage a product part or result in a water leak.

If a draining error occurs during an operation, check if there is a draining problem.

- If the washing machine is used when it is flooded because of a draining problem, it may result in electric shock or fire.

Insert the laundry into the washing machine completely so that the laundry does not get caught in the door.

- If laundry gets caught in the door, it may result in damage to the laundry or the washing machine, or result in a water leak.

Turn the water supply off when the washing machine is not being used.

Ensure that the screws on the water supply hose connector are properly tightened.

- Failure to do so may result in property damage or injury.

Ensure that the rubber seal and front door glass are not contaminated by a foreign substance (e.g. waste, thread, hair, etc.).

- If a foreign substance is caught in the door or the door is not completely closed, it may cause a water leak.

Open the water tap and check if the water supply hose connector is firmly tightened and that there is no water leak before using the product.

- If the screws on the water supply hose connector are loose, it may result in a water leak.

The product you have purchased is designed for domestic use only.

Using the product for business purposes qualifies as a product misuse. In this case, the product will not be covered by the standard warranty provided by Samsung and no responsibility can be attributed to Samsung for malfunctions or damages resulting from such misuse.

Do not stand on the appliance or place objects (such as laundry, lighted candles, lighted cigarettes, dishes, chemicals, metal objects, etc.) on the appliance.

- This may result in electric shock, fire, problems with the product, or injury.

Do not spray volatile material such as insecticide onto the surface of the appliance.

- As well as being harmful to humans, this may result in electric shock, fire or problems with the product.

Do not place objects that generate electromagnetic fields near the washing machine.

- This may result in injury due to a malfunction.

Water drained during a high-temperature wash or drying cycle is hot. Do not touch the water.

- This may result in burns or injury.

Do not wash, spin, or dry water-proof seats, mats, or clothing (*) unless your appliance has a special cycle for washing these items.

(*): Woollen bedding, rain covers, fishing vests, ski pants, sleeping bags, diaper covers, sweat suits, and bicycle, motor cycle and car covers, etc.

- Do not wash thick or hard mats even if the washing machine mark is on the care label. This may result in injury or damage to the washing machine, walls, floor, or clothing due to abnormal vibrations.
- Do not wash throw rugs or doormats with rubber backing. The rubber backing may come off and stick to inside the drum, and this may result in malfunction such as a drainage error.

Do not operate the washing machine when the detergent drawer is removed.

- This may result in electric shock or injury due to a water leak.

Do not touch the insides of the drum during or just after drying as it is hot.

- This may result in burns.

Do not insert your hand into the detergent drawer.

- This may result in injury as your hand may be caught by the detergent input device.

Do not place any objects (such as shoes, food waste, animals) other than laundry into the washing machine.

- This may result in damage to the washing machine, or injury and death in the case of pets due to the abnormal vibrations.

Do not press the buttons using sharp objects such as pins, knives, fingernails, etc.

- This may result in electric shock or injury.

Do not wash laundry contaminated by oils, creams or lotions usually found in skincare shops or massage clinics.

- This may cause the rubber seal to become deformed and result in a water leak.

Do not leave metal objects such as safety pins, hair pins or bleach in the drum for long periods of time.

- This may cause the drum to rust.
- If rust starts appearing on the surface of the drum, apply a (neutral) cleansing agent to the surface and use a sponge to clean it. Never use a metal brush.

Do not use dry cleaning detergent directly and do not wash, rinse, or spin laundry contaminated by dry cleaning detergent.

- This may result in spontaneous combustion or ignition due to the heat from the oxidation of the oil.

Do not use water from water cooling/heating devices.

- This may result in problems with the washing machine.

Do not use natural hand-washing soap for the washing machine.

- If it hardens and accumulates inside the washing machine, it may result in problems with the product, discolouration, rust, or bad odours.

Place socks and brassieres in a washing net and wash them with the other laundry.

Do not wash large laundry items such as bedding in the washing net.

- Failure to do so may result in injury due to abnormal vibrations.

Do not use hardened detergent.

- If it accumulates inside the washing machine, it may result in a water leak.

Make sure that the pockets of all the clothing items to be washed are empty.

- Hard, sharp objects such as coins, safety pins, nails, screws, or stones can cause extensive damage to the appliance.

Do not wash clothing with large buckles, buttons or other heavy metal objects.

Sort the laundry by color on the basis of its colorfastness and select the recommended cycle, water temperature and additional functions.

- This may result in discoloration or fabric damage.

Take care that children's fingers are not caught in the door when you close it.

- Failure to do so may result in injury.

WARNING: Critical cleaning WARNINGS

Do not clean the appliance by spraying water directly onto it.

Do not use the a strong acidic cleaning agent.

Do not use benzene, thinner or alcohol to clean the appliance.

- This may result in discolouration, deformation, damage, electric shock or fire.

Before cleaning or performing maintenance, unplug the appliance from the wall socket.

- Failure to do so may result in electric shock or fire.

Instruction about the WEEE



Correct Disposal of This Product (Waste Electrical & Electronic Equipment)

(Applicable in countries with separate collection systems)

This marking on the product, accessories or literature indicates that the product and its electronic accessories (e.g. charger, headset, USB cable) should not be disposed of with other household waste at the end of their working life. To prevent possible harm to the environment or human health from uncontrolled waste disposal, please separate these items from other types of waste and recycle them responsibly to promote the sustainable reuse of material resources.

Household users should contact either the retailer where they purchased this product, or their local government office, for details of where and how they can take these items for environmentally safe recycling.

Business users should contact their supplier and check the terms and conditions of the purchase contract. This product and its electronic accessories should not be mixed with other commercial wastes for disposal.

Installation

Follow these instructions carefully to ensure a proper installation of the washing machine, and to prevent accidents when doing the laundry.

What's included

Make sure all the parts are included in the product package. If you have a problem with the washing machine or the parts, contact a local Samsung customer center or the retailer.

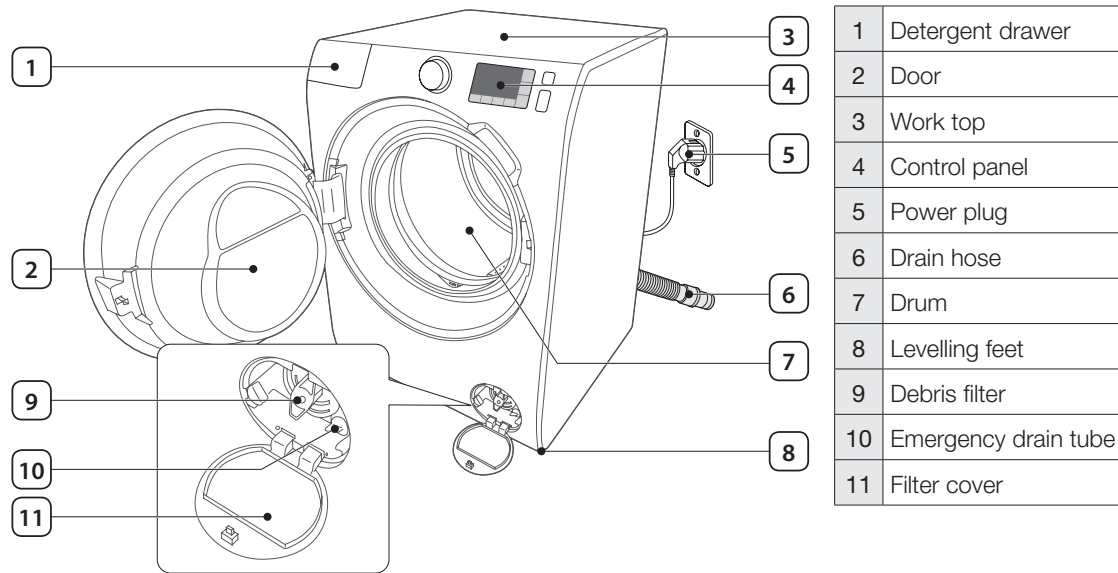

Spanner



Bolt caps

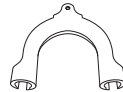

Hose guide



Cap fixer



Cold water supply hose



Hot water supply hose

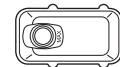

Liquid detergent container

-  **Bolt hole covers** : The number of bolt hole covers depends on the model (3~6 covers).
- Hot water supply hose** : Applicable models only.
- Liquid detergent container** : Applicable models only.

Installation requirements

Electrical supply and grounding

- AC 220-240 V / 50 Hz fuse or circuit breaker equipped
- Individual branch circuit specific to the washing machine

To ensure a proper grounding, the washing machine comes with a power cord featuring a threeprong grounding plug for use in a properly installed and grounded outlet.

Check with a qualified electrician or serviceperson if you are not sure about the grounding.

Do not modify the provided plug. If it does not fit the outlet, call a qualified electrician and install a proper outlet.



WARNING

- Do NOT use an extension cord.
- Use only the power cord that comes with the washing machine.
- Do NOT connect the ground wire to plastic plumbing, gas lines, or hot water pipes.
- Improperly connected grounding conductors may cause electric shock.

Water supply

A proper water pressure for this washing machine is between 50 kPa and 800 kPa. Water pressures less than 50 kPa may cause the water valve not to close completely. Or, it may take a longer time to fill the drum, turning off the washing machine resultantly. Water taps must be within 120 cm from the rear of the washing machine so that the provided inlet hoses reach the washing machine.

To reduce a risk of leak

- Make water taps easily accessible.
- Turn off taps when the washing machine is not in use.
- Check for any leak at water inlet hose fittings on a regular basis.



CAUTION: Before using the washing machine for the first time, check all connections at the water valve and taps for any leak.

Drain

Samsung recommends a standpipe in height of 65cm. The drain hose must be connected through the hose clip to the standpipe, and the standpipe must fully cover the drain hose.

Flooring

For best performance, the washing machine must be installed on a solid floor. Wood floors may need to be reinforced to minimize vibration and/or unbalanced loads. Carpeting and soft tile surfaces are not a good resistance to vibrations and may cause the washing machine to move slightly during the spin cycle.

 **CAUTION:** Do NOT install the washing machine on a platform or a poorly supported structure.

Water temperature

Do not install the washing machine in areas where water may freeze as the washing machine always retains some water in its water valves, pumps, and/or hoses. Frozen water left in the connection parts may cause damage to belts, the pump, and other components of the washing machine.

Alcove or closet installation

Minimum clearance for a stable operation:

Sides	25 mm	Rear	50 mm
Top	25 mm	Front	500 mm

If both the washing machine and a dryer are installed in one location, the front of the alcove or closet must have at least 500 mm unobstructed air opening. Your washing machine alone does not require a specific air opening.

Step-by-step installation

STEP 1 - Select a location

Location requirements:

- Solid, level surface without carpeting or flooring that may obstruct ventilation
- Away from direct sunlight
- Adequate room for ventilation and wiring
- The ambient temperature is always higher than the freezing point (0 °C)
- Away from a heat source

STEP 2 - Remove the shipping bolts

Unpack the product package and remove all shipping bolts.

1. Loosen all shipping bolts on the rear of the machine using the supplied spanner.

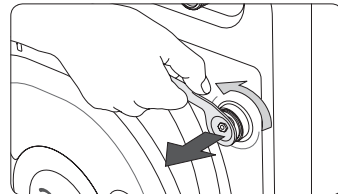

2. Fill the holes with the supplied plastic bolt caps. Keep the shipping bolts for future use.

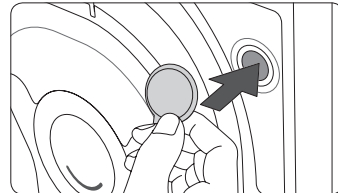

WARNING

Packaging materials can be dangerous to children. Dispose all packaging material (plastic bags, polystyrene, etc.) out of children's reach.

STEP 3 - Adjust the levelling feet

1. Gently slide the washing machine into position. Excessive force may damage the levelling feet.
2. Level the washing machine by manually adjusting the levelling feet.
3. When levelling is complete, tighten the nuts using the spanner.

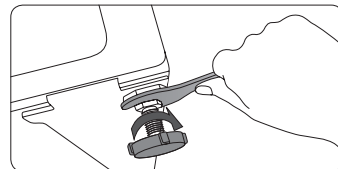
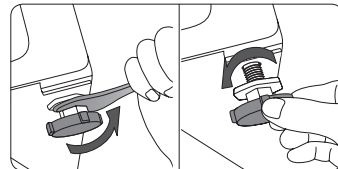

STEP 4 - Connect the water hose

Connect the water supply hose to the water tap.

1. Remove the **adaptor (A)** from the **water supply hose (B)**.

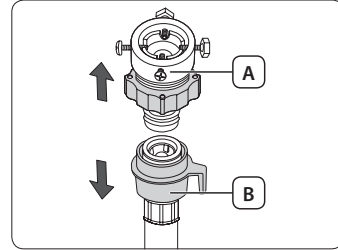

2. Use a Philips screwdriver to loosen four screws on the adaptor.

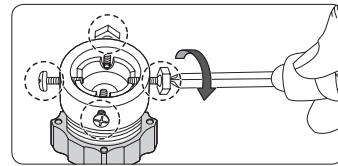

3. Hold the adaptor and turn **part (C)** in the arrow direction to loosen it by 5 mm (*).

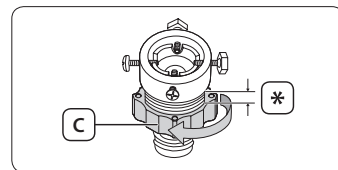

4. Insert the adaptor into the water tap, and tighten the screws while lifting up the adaptor.

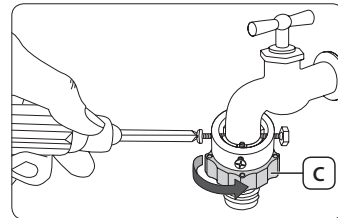

5. Turn **part (C)** in the arrow direction to tighten it.

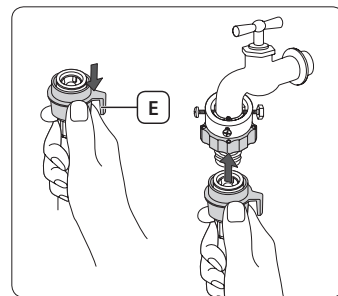

7. Connect the other end of the water supply hose to the inlet valve on the back of the washing machine. Turn the hose clockwise to tighten.

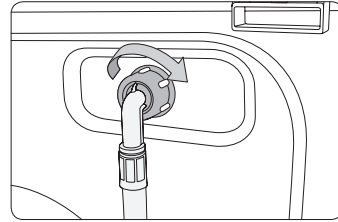

8. Open the water tap and check if there are any leaks around the connection areas. If there are water leaks, repeat the steps above.

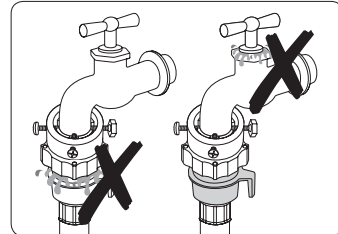

- If using a screw type of water tap, connect the water hose to the water tap as shown.
- Use a popular type of water taps. If the current tap is squareshaped or too big, remove the spacer ring before inserting the adaptor into the water tap.

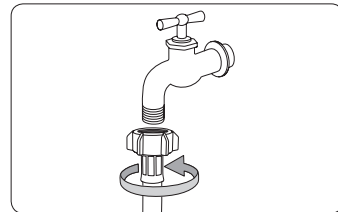

WARNING

Stop using the washing machine if there is a water leak, and contact a local Samsung service centre. Otherwise, this may cause electric shock.



CAUTION

Do not stretch the water supply hose by force. If the hose is too short, replace the hose with a longer, high-pressure hose.



- After connecting the water supply hose to the adaptor, check if it is connected properly by pulling the water supply hose downwards.
- Use a popular type of water taps. If the tap is square-shaped or too big, remove the spacer ring before inserting the tap into the adaptor.

For models having an additional hot water inlet:

1. Connect the red end of the hot water supply hose to the hot water inlet on the back of the machine.
2. Connect the other end of the hot water supply hose to the hot water tap.

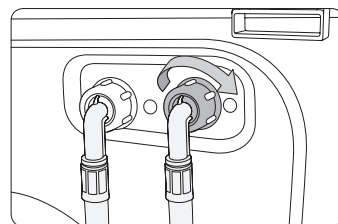

Aqua hose (applicable models only)

The aqua hose alerts users of a risk of water leaks. It senses the water flow and turns red on the centre **indicator (A)** in case of a leak.

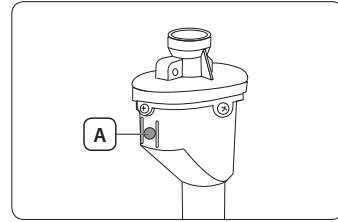

STEP 5 - Position the drain hose

The drain hose can be positioned in three ways:

Over the edge of a wash basin

The drain hose must be placed at a height of between 60 cm and 90 cm (*) from the floor. To keep the spout of the drain hose bent, use the supplied **plastic hose guide (A)**. Secure the guide to the wall using a hook to ensure stable drainage.

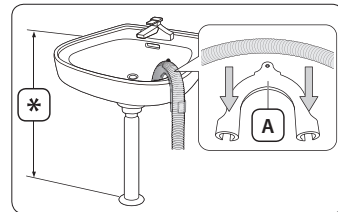

In a sink drain pipe

The drain pipe must be above the sink siphon so that the end of the hose is at least 60 cm above the floor.

In a drain pipe

The drain pipe should be between 60 cm and 90 cm high (*). It is advisable to use a 65 cm high vertical pipe. Make sure the drain hose is connected to the stand pipe at a slant.

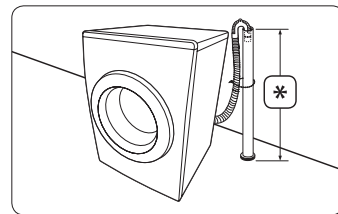

Drain standpipe requirements:

- Minimum diameter of 5 cm
- Minimum carry-away capacity of 60 litres per minute

STEP 6 - Turn on the washing machine

Plug the power cord into a wall socket featuring an AC 220-240V / 50Hz approved electrical outlet protected by a fuse or circuit breaker. Then, press the **Power** button to turn on the washing machine.

Before you start

Initial settings

Run Calibration mode (recommended)

Samsung washing machine detects the laundry weight automatically. For more accurate weight detection, please run Calibration Mode after the installation. Calibration mode is done by following the steps below.

1. Remove laundry or any contents in the machine and turn off the machine.
2. Press the **Power** button and release it, and then press the **Temp** button and **Delay End** button simultaneously. Then the machine turns on.
3. Press the **Start/Pause** button to activate "Calibration Mode".
4. The drum rotates clockwise and counterclockwise approximately for 3 minutes.
5. When "Calibration Mode" is finished, "**END(En)**" appears on the display, and the machine automatically turns off. The washing machine is now ready for use.

Laundry guidelines

STEP 1 - Sort

Sort the laundry according to these criteria:

- **Care Label:** Sort the laundry into cottons, mixed fibres, synthetics, silks, wools and rayon.
- **Colour:** Separate whites from colours.
- **Size:** Mixing different-sized items together in the drum improves the washing performance.
- **Sensitivity:** Wash delicate items separately using an EasyIron option for pure, new woollen items, curtains and silk items. Check the labels on the items.



Make sure to check the care label on the clothing, and sort them accordingly before starting the wash.

STEP 2 - Empty pockets

Empty all the pockets of your laundry items.

- Metal objects such as coins, pins, and buckles on clothing may damage other laundry items as well as the drum.

Turn clothing with buttons and embroiders inside out.

- If zips of pants and jackets are open while washing, the drum may be damaged. Zips should be closed and fixed with a string.
- Clothing with long strings may become entangled with other clothes. Be sure to fix the strings before starting the wash.

STEP 3 - Use a laundry net

- Brassieres (water washable) must be placed in a laundry net. Metal parts of the brassieres may break through and rip other laundry items.
- Small, light clothing such as socks, gloves, stockings and handkerchiefs may become caught around the door. Place them inside a fine laundry net.
- Do not wash the laundry net by itself without other laundry. This may cause abnormal vibrations that could move the washing machine and result in injury.

STEP 4 - Prewash (if necessary)

Add a Prewash option to the selected course with a protein-based detergent for cotton items that are contaminated severely.

STEP 5 - Determine the load capacity

Do not overload the washing machine or the laundry may not wash properly. For the load capacity for the type of clothing, see page 25.



When washing bedding or bedding covers, the wash time may be lengthened or the spin efficiency may be reduced. For bedding or bedding covers, the recommended maximum spin cycle speed is 800 rpm and the load capacity is 2.0 kg or less.



CAUTION: If the laundry is unbalanced and the "UE" error code is displayed, redistribute the load. Unbalanced laundry may reduce the spinning performance.

STEP 6 - Apply a proper detergent

The type of detergent depends on the type of fabric (cotton, synthetic, delicate items, wool), colour, wash temperature, and degree of soiling. Always use "low suds" laundry detergent, which is designed for automatic washing machines.



- Follow the detergent manufacturer's recommendations based on the weight of the laundry, the degree of soiling, and the hardness of the water in a local area. If you are not sure about the water hardness, contact a local water authority.
- Do not use detergent that tends to be hardened or solidified. This detergent may remain after the rinse cycle, blocking the drain outlet.



CAUTION: Use only a neutral liquid detergent for wool in the Wool course. A powder detergent with the Wool course may remain on the laundry and discolour the laundry.

Detergent drawer guidelines

The washing machine provides a three-compartment dispenser: the left compartment for the main wash, the centre for fabric softeners, and the right for the preliminary wash.

Ⓘ	Prewash detergent compartment
Ⓜ	Main wash detergent compartment: powder detergents, water softeners, pre-soaking agents, bleach, and stain removers
Ⓢ	Fabric softener compartment

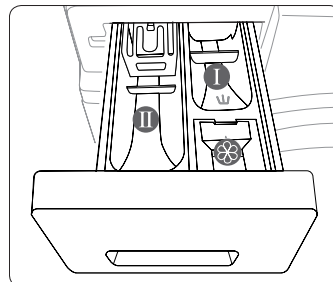

CAUTION

- Do not open the detergent drawer while the washing machine is operating.
- Do not use the following types of detergent:
 - Tablet or capsule types
 - Ball or net types
- To prevent the compartment clogging, concentrated or highly-enriched agents (fabric softener or detergent) must be diluted with water before applied.

The detergent drawer is located at the top-left corner of the washing machine.

1. Slide open the detergent drawer.
2. Apply an appropriate amount of detergent to the left compartment (Ⓜ).
To use a liquid detergent, see the Liquid detergent guide below.

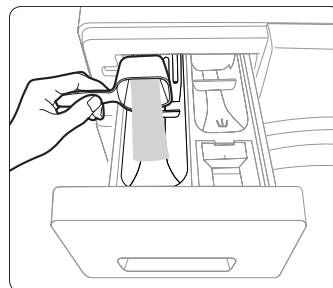

3. Apply an appropriate amount of fabric softener to the centre compartment (Ⓢ) if necessary.
Do not exceed the max line (A) which is marked on the compartment.

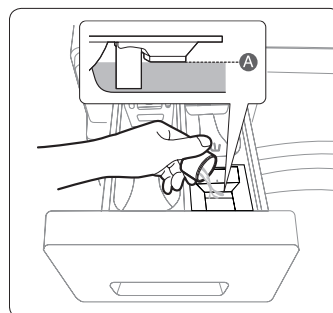

4. If selecting the Prewash option, apply an appropriate amount of detergent to the right compartment (I).
5. Slide the detergent drawer inward to close it.

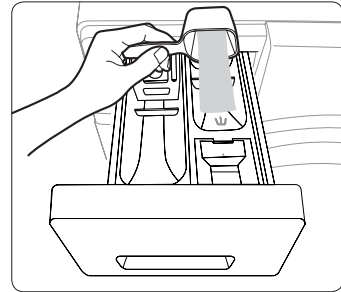

Liquid detergent container (Applicable models only)

To use a liquid detergent, first put the provided **liquid detergent container (A)** in the main wash detergent compartment (II). Then, apply an appropriate amount of detergent to the container. Do not exceed the max line which is marked on the inner of the container.



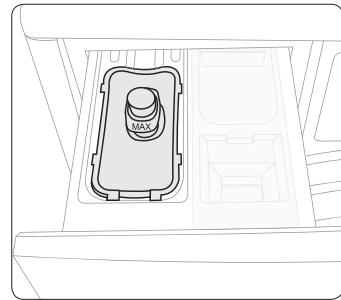





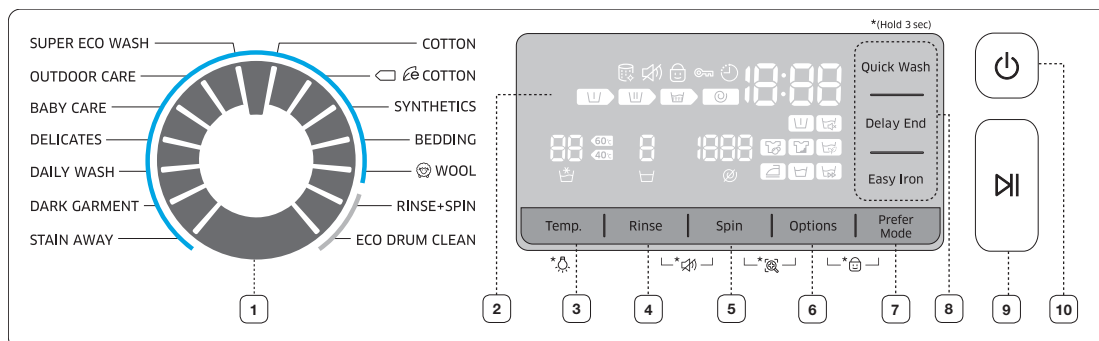

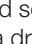
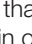

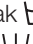
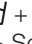
 **CAUTION:** Remove the liquid detergent container if using a powder detergent.

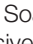

Operations

Control panel



1	Course Selector	Turn the dial to select a course.
2	Display area	Displays information of remaining washing time, and settings.
3	Temp.	Press to change the water temperature for the current course. Press and hold for 3 seconds to turn on/off the Drum Light.
4	Rinse	Press to change the rinse times for the current course. You can set the rinse times up to 5.
5	Spin	Press to change the spinning speed for the current course. <ul style="list-style-type: none"> • Rinse Hold : The final rinse cycle is suspended so that the laundry remains in the water. To unload the laundry, run a drain or spin cycle. • No Spin : The drum does not spin after the final drain cycle.
6	Options	Press to select an option. Each time you press this button, the option selection changes in this sequence: Soak  > Intensive  > Prewash  > Soak  + Intensive  > Soak  + Prewash  > Intensive  + Prewash  > Soak  + Intensive  + Prewash  > off
7	Prefer Mode	Press to enter custom options screen. 3 custom options are available but multiple selection is not allowed.
8	Frequent options	Three frequent options are provided separately for easy access. To select or deselect, press the corresponding button.
9	 Start/Pause	Press to start or stop an operation.
10	 Power	Press to turn on/off the washing machine.

Simple steps to start

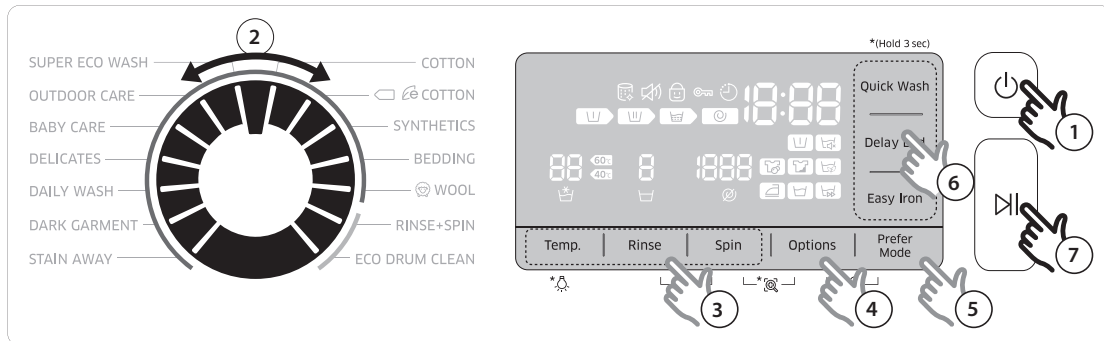

1. Press the **Power** button to turn on the washing machine.
2. Turn the Course Selector to select a course.
3. Change the course settings (**Temperature**, **Rinse**, and **Spin**) as necessary.
4. To add an option, press the **Options** button repeatedly until the corresponding option icon(s) turns on.
5. To select a preferred mode, press the **Prefer Mode** button repeatedly until the corresponding mode icon turns on.
6. To add a frequent option, press the corresponding button (**Quick wash**, **Delay End**, and **Easy Iron**).
7. Press the **Start/Pause** button.

To change the course during operation





1. Press the **Start/Pause** button to stop operation.
2. Select a different course.
3. Press the **Start/Pause** button again to start the new course.

Course overview



Standard courses

Course	Description & Max load (kg)	
COTTON	<ul style="list-style-type: none"> For cottons, bed linens, table linens, underwear, towels, or shirts. The washing time and the number of rinse cycles are automatically adjusted according to the load. 	Max
 COTTON	<ul style="list-style-type: none"> Optimal performance with lower energy for cotton fabrics, bed linens, table linens, underwear, towels, or shirts. 	Max
SYNTHETICS	<ul style="list-style-type: none"> For blouses or shirts that are made of polyester (diolen, trevira), polyamide (perlon, nylon), or the like. 	3.5
BEDDING	<ul style="list-style-type: none"> For bed spreads, bed sheets, bedding covers, etc. For best results, wash only 1 type of bedding and make sure the load weighs less than 2 kg. 	2
WOOL	<ul style="list-style-type: none"> Specific for machine-washable wool for loads less than 2.0 kg. The wool course features gentle cradling and soaking to protect the wool fibres from shrinkage/distortion. A neutral detergent is recommended. 	2
SUPER ECO WASH	<ul style="list-style-type: none"> Low-temperature Eco Bubble contributes to power saving. 	4
OUTDOOR CARE	<ul style="list-style-type: none"> For mountain clothes, skiwear, and sportswear that are made of functional materials such as spandex, stretch, and micro-fiber 	2
BABY CARE	<ul style="list-style-type: none"> Featuring a high-temperature wash and extra rinses to ensure that no powder detergent remains. 	4
DELICATES	<ul style="list-style-type: none"> For sheer fabrics, bras, lingerie (silk), and other handwash-only fabrics. 	2
DAILY WASH	<ul style="list-style-type: none"> Fast completion within approximately an hour for daily items such as underwear and shirts. 	4
DARK GARMENT	<ul style="list-style-type: none"> Featuring additional rinses and reduced spinning to ensure that the laundry is washed gently and rinsed thoroughly. 	4
STAIN AWAY	<ul style="list-style-type: none"> Featuring the soaking cycle to effectively remove stains from the laundry. During the soaking cycle, the drum stops rotating. This is not a system failure. 	4
RINSE+SPIN	<ul style="list-style-type: none"> Featuring an additional rinse after applying fabric softener to the laundry. 	-
ECO DRUM CLEAN	<ul style="list-style-type: none"> Specific to drum cleaning and removes dirt and bacteria from the drum. Perform once every 40 washes with no detergent or bleach applied. Make sure the drum is empty. Do not use any cleaning agents for cleaning the drum. 	-

Options

Option	Description
 Prewash	<ul style="list-style-type: none"> This will add a preliminary washing cycle before the main wash cycle.
 Intensive	<ul style="list-style-type: none"> For badly soiled laundry. The operation time for each cycle is longer than normal.
 Soak	<ul style="list-style-type: none"> This option effectively removes stains by soaking the laundry. Each soak cycle spins the drum for 1 minute and stands still for 4 minutes, totaling 6 times for 30 minutes.
- Quick Wash	<ul style="list-style-type: none"> Specific to less soiled garments with less than a 2kg load. It takes about 15 minutes, depending on the conditions such as the water pressure, water hardness, and/or extra options selected. The Quick Wash time increases in this sequence: Off > 15 min > 20 min > 30 min > 40 min > 50 min > 60 min. A recommended amount of detergent is less than 20g (for a 2kg load).
 Delay End	<ul style="list-style-type: none"> The displayed time refers to the end time of a selected course. You can set the time of Delay End in hourly units more than estimated time of current cycle. Set the Delay End time between 1 hour and 19 hours.
 Easy Iron	<ul style="list-style-type: none"> The spinning speed increases to reduce wrinkles of the laundry. Set the spinning speed up to 800 rpm.

Prefer Mode

Mode	Description
 Speed Wash	<ul style="list-style-type: none"> This changes the course settings to reduce the overall washing time. The recommended laundry load is less than 4.0 kg for the COTTON course with Speed Wash enabled.
 Eco Wash	<ul style="list-style-type: none"> This changes the course settings to save the overall power consumption.
 Silent Wash	<ul style="list-style-type: none"> This changes the course settings to reduce operating noise and vibration.

Delay End

You can set the washing machine to finish the current course at specific hours later.

This is useful if you want to finish the wash by the time you come home from business.

1. Select a course. Then change the course settings if necessary.
2. Press the **Delay End** button repeatedly to set the Delay End time.
3. Press the **Start/Pause** button.

Case study

You want to finish a two-hour course after 3 hours from now. For this, you add the Delay End option to the current course with the 3-hour setting, and press the **Start/Pause** button at 2:00 p.m. Then, what happens? The washing machine starts operating at 3:00 p.m., and ends at 5:00 p.m. Provided below is the time line for this case.



Settings

Child Lock

To prevent accidents by children or infants, Child Lock locks all buttons.

- To set or release the Child Lock, press and hold the **Options** and **Prefer Mode** buttons simultaneously for 3 seconds.



To add detergent or more laundry in the drum, or to change the course settings in the Child Lock state, you must first release the Child Lock.

Sound

Mute or unmute the sound.

- To mute or unmute the sound, press and hold the **Rinse** and **Spin** buttons simultaneously for 3 seconds.

Drum Light

- To turn the Drum Light on or off, press and hold the **Temp.** button for 3 seconds.
- The drum light turns off automatically after 5 minutes.

Maintenance

Keep the washing machine clean to prevent deteriorated performance, and to preserve the life cycle.

Eco Drum Clean

Perform this course regularly to clean the drum, and to remove bacteria from it.

1. Press the **Power** button to turn on washing machine.
2. Turn the **Course Selector** to select a **Eco Drum Clean**.
3. Press the **Start/Pause** button.



The water temperature for Eco Drum Clean is set to 70 °C, which cannot be changed.



CAUTION: Do not use any cleaning agents for cleaning the drum. Chemical residues in the drum deteriorates the washing performance.

Eco Drum Clean reminder

The Eco Drum Clean reminder  appears on the main screen once every 40 washes.

Run the Eco Drum Clean cycle. It is advisable to perform the Eco Drum Clean regularly.

When you first see this reminder, you can ignore the reminder for 6 consecutive times. From the 7th wash, the reminder does not appear. However, it appears again on the second 40th wash.

Smart check

To enable this function, you must first download the “**Samsung Smart Washer**” app from Google Play or App Store, and install it on a mobile device featuring the camera operation.

The Smart Check function has been optimized for:

Galaxy & iPhone series (cannot be supported for some models)

1. Press and hold the **Spin** and **Options** buttons simultaneously for 3 seconds to enter the Smart Check mode.
2. The washing machine starts the self-diagnosis procedure, and display an error code if an error is found.
3. Run the **Samsung Smart Washer** app on your mobile device, and tap **Smart Check**.
4. Present the mobile device to the washing machine's display panel so that the mobile device and the washing machine face each other. Then, the error code will be recognized automatically by the app.
5. When the error code is recognized correctly, the app provides detailed information for the error with further actions.



- The function name, Smart Check, may differ depending on the language.
- If the washing machine reflects light on the display, the app may fail to recognize the error code.
- If the app fails to recognize the Smart Check code consecutively, enter the error code manually onto the app screen.

Emergency drain

In case of a power failure, drain the water inside the drum before taking out the laundry.

1. Unplug the power cord of the washing machine from the main socket.
2. Gently press the top area of the filter cover to open.

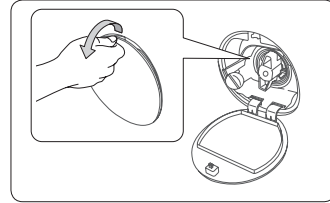

3. Gently pull out the emergency drain tube.

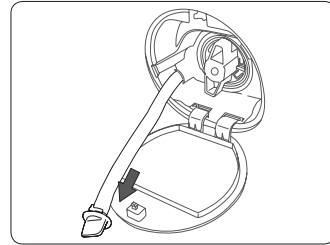

4. While holding the end of the drain tube, open the tube cap.

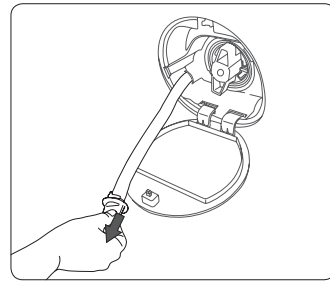

5. Let the water run into a container.
6. Close the tube cap, and reinsert the drain tube.
7. Close the filter cover.

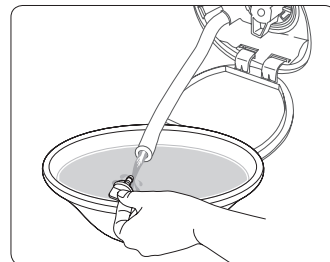

Cleaning

Surface of the washing machine

Use a soft cloth with a nonabrasive household detergent. Do not spray water onto the washing machine.

Mesh filter

Clean the mesh filter of the water supply hose once or twice a year.

1. Turn off the washing machine, and unplug the power cord.
2. Close the water tap.
3. Loosen and disconnect the water supply hose from the back of the washing machine. Cover the hose with a cloth to prevent water from gushing out.
4. Use pliers to pull out the mesh filter from the inlet valve hole.
5. Soak the mesh filter deeply in water so that the threaded connector is also soaked.
6. Dry the mesh filter completely in the shade.
7. Reinsert the mesh filter into the water supply hose, and place the water supply hose in the original position.
8. Open the water tap.

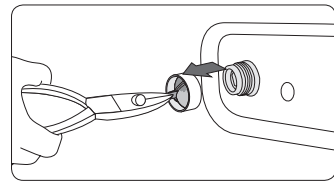
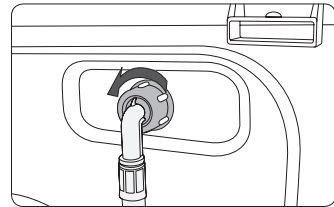

 If the mesh filter is clogged, an error code of “**4E**” appears on the screen.

Debris filter

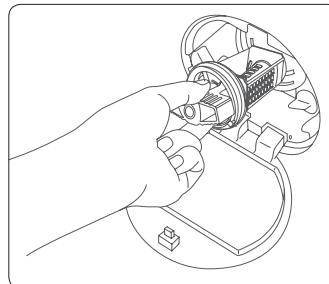

It is advisable to clean the debris filter 5 or 6 times a year to prevent its clogging. A clogged debris filter may reduce the bubble effect.

1. Turn off the washing machine, and unplug the power cord.
2. Drain the remaining water inside the drum by referring to “Emergency drain” on page 31.
3. Open the filter cover using a coin or key.
4. Turn the debris filter cap to the left, and drain off the remaining water.
5. Remove the debris filter.

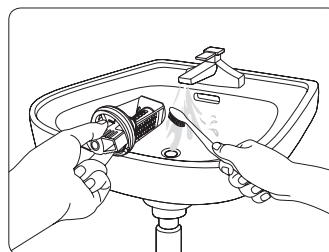

6. Clean the debris filter using soft brushes. Make sure the drain pump propeller inside the filter is unclogged.
7. Reinsert the debris filter, and turn the filter cap to the right.



-  • To open the safety filter cap, push in and turn it anticlockwise. The spring of the cap helps to open the cap.
- To close the safety filter cap, turn it clockwise. The spring makes a rattling sound, which is normal.
-  • If the debris filter is clogged, an error code of “5E” appears on the screen.

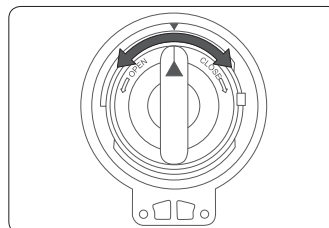

CAUTION

- Make sure the filter cap is closed properly after cleaning the filter. Otherwise, this may cause a leak.
- Make sure the filter is inserted properly after cleaning it. Otherwise, this may cause an operational failure or a leak.

Detergent drawer

1. While holding down the **release lever (A)** on the inner of the drawer, slide open the drawer.
2. Remove the **release lever** and the liquid detergent container from the drawer.

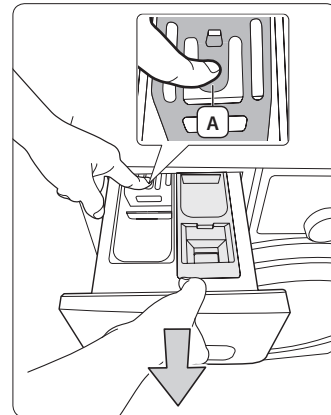

3. Clean the drawer components in flowing water using a soft brush.

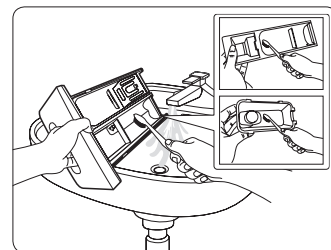

4. Clean the drawer recess using a soft brush.
5. Reinsert the **release lever (A)** and the liquid detergent container to the drawer.
6. Slide the drawer inward to close it.



-  To remove remaining detergent, perform the Rinse + Spin course with the drum being empty.

Recovery from freezing

The washing machine may freeze when it drops below 0 °C.

1. Turn off the washing machine, and unplug the power cord.
2. Pour warm water over the water tap to loosen the water supply hose.
3. Disconnect the water supply hose, and soak it in warm water.
4. Pour warm water into the drum and leave it for about 10 minutes.
5. Reconnect the water supply hose to the water tap.



If the washing machine still doesn't operate normally, repeat the above steps until it operates normally.

Care against an extended time of disuse

Avoid leaving the washing machine unused for an extended time.

If this is the case, drain the washing machine and unplug the power cord.

1. Turn the Course Selector to select a **RINSE+SPIN**.
2. Empty the drum, and press **Start/Pause** button.
3. When the course is complete, close the water tap and disconnect the water supply hose.
4. Turn off the washing machine, and unplug the power cord.
5. Open the door to let air circulate through the drum.

Troubleshooting

Checkpoints

If you encounter a problem with the washing machine, first check the table below and try the suggestions.

PROBLEM	SOLUTION
Will not start	<ul style="list-style-type: none">• Make sure your washing machine is plugged in.• Make sure the door is firmly closed.• Make sure the water source tap(s) are turned on.• Make sure to press the Start/Pause button.
Has no water or not enough water	<ul style="list-style-type: none">• Turn the water tap on fully.• Make sure the water source hose is not frozen.• Straighten the water intake hoses.• Clean the filter on the water intake hose.
Has detergent remaining in the detergent drawer after the wash cycle is complete	<ul style="list-style-type: none">• Make sure your washing machine is running with sufficient water pressure.• Make sure the detergent is added to the center of the detergent drawer.
Vibrates or is too noisy	<ul style="list-style-type: none">• Make sure your washing machine is on a level surface. If the surface is not level, adjust the washing machine feet to level the appliance.• Make sure that the shipping bolts are removed.• Make sure your washing machine is not touching any other object.• Make sure the laundry load is balanced.
The washing machine does not drain and/or spin	<ul style="list-style-type: none">• Straighten the drain hose. Eliminate kinked hoses.• Make sure the debris filter is not clogged.
Door is locked shut or will not open.	<ul style="list-style-type: none">• The door will not open until 3 minutes after the machine stops or the power turns off.

If a problem persists, contact a local Samsung service center.

Information codes

If the washing machine fails to operate, you may see an information code on the screen. Check the table below and try the suggestions.

CODE SYMBOL	SOLUTION
dE	<ul style="list-style-type: none"> • Make sure the door is firmly closed. • Make sure that laundry is not caught in the door.
4E	<ul style="list-style-type: none"> • Make sure the source water tap is turned on. • Check the water pressure. • Clean the mesh filters of water hose.
5E	<ul style="list-style-type: none"> • Clean the debris filter. • Make sure the drainage hose is installed correctly. • Clean the water hose mesh filter.
UE	<ul style="list-style-type: none"> • The laundry load is unbalanced. Redistribute the load. If only one item of clothing needs washing, such as a bathrobe or pair of jeans, the final spin result might be unsatisfactory and an "UE" error message will be shown in the display window.
cE/3E	<ul style="list-style-type: none"> • Call the after-sales service.
Sd/Sud	<ul style="list-style-type: none"> • This occurs when too much foaming is detected. It is also displayed while foaming is removed. When the removal is finished, the normal cycle proceeds.(This is one of the normal operations. It is an error for preventing non-sensing faults.)
Uc	<ul style="list-style-type: none"> • If the voltage of the supplied power is instable, the washing machine will be paused to protect its electric devices. • If the correct voltage is supplied, the cycle will resume automatically.

If any information code keeps appearing on the screen, contact a local Samsung service center.

Specifications

Protecting the environment





























- This appliance is manufactured from recyclable materials. If you decide to dispose of this appliance, please observe local waste disposal regulations. Cut off the power cord so that the appliance cannot be connected to a power source. Remove the door so that animals and small children cannot get trapped inside the appliance.
- Do not exceed the detergent quantities recommended in the detergent manufactures' instructions.
- Use stain removal products and bleaches before the wash cycle only when strictly necessary.
- Save water and electricity by only washing full loads (the exact amount depends upon the program used).

Declaration of conformity

This appliance complies with European safety standards, EC directive 93/68 and EN Standard 60335.

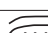
Fabric care chart

The following symbols provide garment care directions. The care labels include four symbols in this order: washing, bleaching, drying and ironing (and dry cleaning when necessary). The use of symbols ensures consistency among garment manufacturers of domestic and imported items. Follow the care label directions to maximize garment life and reduce laundry problems.

	Resistant material		Can be ironed at 100 °C max
	Delicate fabric		Do not iron
 	Item may be washed at 95 °C		Can be dry cleaned using any solvent
 	Item may be washed at 60 °C		Dry clean with perchloride, lighter fuel, pure alcohol or R113 only
 	Item may be washed at 40 °C		Dry clean with aviation fuel, pure alcohol or R113 only
 	Item may be washed at 30 °C		Do not dry clean
	Item may be hand washed		Dry flat
	Dry clean only		Can be hung to dry
	Can be bleached in cold water		Dry on clothes hanger
	Do not bleach		Tumble dry, normal heat
	Can be ironed at 200 °C max		Tumble dry, reduced heat
	Can be ironed at 150 °C max		Do not tumble dry





Sheet of household washing machines



The design and specifications are subject to change without notice for quality improvement purposes.

According to Regulation (EU) No. 1061/2010

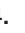
Samsung				
Model Name		WW80H7600E*	WW90H7600E*	
Capacity	kg	8	9	
Energy Efficiency				
A+++ (highest efficiency) to D (least efficient)		A+++	A+++	
Energy Consumption				
Annual Energy Consumption (AE_C) ¹⁾	kWh/yr	151	151	
Energy Consumption (E_t.60) Cotton 60 °C at full load	kWh	0.78	0.80	
Energy Consumption (E_t.60.1/2) Cotton 60 °C with partial load	kWh	0.66	0.64	
Energy Consumption (E_t.40.1/2) Cotton 40 °C with partial load	kWh	0.50	0.50	
Weighted power off-mode (P_o)	W	0.45	0.45	
Weighted power in left-on mode (P_l)	W	10	10	
Annual water consumption (AW_c) ²⁾	L/yr	9400	9400	
Spin efficiency class ³⁾				
A (most efficient) to G (least efficient)		A	A	
Maximum Spin Speed	rpm	1600	1600	
Residual moisture	%	44	44	
Programs to which the information on the label and the Sheet relate		i Cotton 60 °C and 40 °C ⁴⁾		
Program duration of the standard program				
Cotton 60 °C at full load	min	270	270	
Cotton 60 °C for partial load	min	250	250	
Cotton 40 °C with partial load	min	230	230	
Weighted time in left-on mode	min	8	8	
Airborne noise emissions				
Wash	dB (A) re 1 pW	52	52	
Spin	dB (A) re 1 pW	76	76	
Dimensions				
Unit dimensions	Height	mm	850	850
	Width	mm	600	600
	Depth ⁵⁾	mm	600	600
Net weight	kg	76	76	
Gross weight	kg	78	78	
Package weight	kg	2	2	
Water Pressure	kPa	50-800		
Electrical connection				
Voltage	V	220-240		
Power consumption	W	2000-2400		
Frequency	Hz	50		
Name of company		Samsung Electronics Co., Ltd.		





1. Annual energy consumption is based on 220 standard washing cycles for  COTTON course at 60 °C and 40 °C at full and partial load, and the consumption of off and left-on modes. Actual energy consumption will depend on how the appliance is used.
2. Annual water consumption is based on 220 standard washing cycles for  COTTON course at 60 °C and 40 °C at full and partial load. Actual water consumption will depend on how the appliance is used.
3. Spin extraction is very important when you use a clothes dryer to dry your clothes.
The energy for drying costs much higher than the energy for washing.
Wasing with the high spin saves more energy in drying your clothes in a clothes dryer.
4. The  COTTON 60 °C and  COTTON 40 °C programs are the 'standard cotton 60 °C program' and the 'standard cotton 40 °C program'. They are suitable to clean normally soiled cotton laundry and they are the most efficient (concerning water and energy consumption) for this type of laundry.
Please run Calibration Mode after the installation (refer to the "Run Calibration mode (recommended)" section on page 18).
In these programs the actual water temperature may differ from the declared temperature.
5. Distance to the wall from the unit is not included in the depth dimension.

Sheet of household washing machines

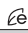
 The design and specifications are subject to change without notice for quality improvement purposes.

According to Regulation (EU) No. 1061/2010

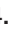
Samsung			
Model Name		WW80H7410E*	WW90H7410E*
Capacity	kg	8	9
Energy Efficiency			
A+++ (highest efficiency) to D (least efficient)		A+++	A+++
Energy Consumption			
Annual Energy Consumption (AE_C) ¹⁾	kWh/yr	136	151
Energy Consumption (E_t.60) Cotton 60 °C at full load	kWh	0.66	0.77
Energy Consumption (E_t.60.1/2) Cotton 60 °C with partial load	kWh	0.63	0.67
Energy Consumption (E_t.40.1/2) Cotton 40 °C with partial load	kWh	0.48	0.51
Weighted power off-mode (P_o)	W	0.45	0.45
Weighted power in left-on mode (P_l)	W	10	10
Annual water consumption (AW_c) ²⁾	L/yr	8400	9400
Spin efficiency class ³⁾			
A (most efficient) to G (least efficient)		A	A
Maximum Spin Speed	rpm	1400	1400
Residual moisture	%	44	44
Programs to which the information on the label and the Sheet relate		 Cotton 60 °C and 40 °C ⁴⁾	
Program duration of the standard program			
Cotton 60 °C at full load	min	270	270
Cotton 60 °C for partial load	min	250	250
Cotton 40 °C with partial load	min	230	230
Weighted time in left-on mode	min	8	8
Airborne noise emissions			
Wash	dB (A) re 1 pW	52	52
Spin	dB (A) re 1 pW	74	74
Dimensions			
Unit dimensions	Height	mm	850
	Width	mm	600
	Depth ⁵⁾	mm	600
Net weight	kg	73	73
Gross weight	kg	75	75
Package weight	kg	2	2
Water Pressure	kPa	50-800	
Electrical connection			
Voltage	V	220-240	
Power consumption	W	2000-2400	
Frequency	Hz	50	
Name of company		Samsung Electronics Co., Ltd.	

1. Annual energy consumption is based on 220 standard washing cycles for  COTTON course at 60 °C and 40 °C at full and partial load, and the consumption of off and left-on modes. Actual energy consumption will depend on how the appliance is used.
2. Annual water consumption is based on 220 standard washing cycles for  COTTON course at 60 °C and 40 °C at full and partial load. Actual water consumption will depend on how the appliance is used.
3. Spin extraction is very important when you use a clothes dryer to dry your clothes.
The energy for drying costs much higher than the energy for washing.
Wasing with the high spin saves more energy in drying your clothes in a clothes dryer.
4. The  COTTON 60 °C and  COTTON 40 °C programs are the 'standard cotton 60 °C program' and the 'standard cotton 40 °C program'. They are suitable to clean normally soiled cotton laundry and they are the most efficient (concerning water and energy consumption) for this type of laundry.
Please run Calibration Mode after the installation (refer to the "Run Calibration mode (recommended)" section on page 18).
In these programs the actual water temperature may differ from the declared temperature.
5. Distance to the wall from the unit is not included in the depth dimension.

Information of main washing programmes

Model	Course	Temp (°C)	Capacity (kg)	Program Time (min)	Residual Moisture Content (%)	Water Consumption (ℓ/cycle)	Energy Consumption (kWh/Cycle)
WW80H7600E*	COTTON	20	4.0	129	49	53	0.37
	COTTON	40	4.0	230	44	36	0.50
		60	8.0	270	41	49	0.78
			4.0	250	44	36	0.66
	SYNTHETICS	40	3.5	139	29	56	0.61
WW80H7410E*	COTTON	20	4.0	129	50	53	0.38
	COTTON	40	4.0	229	44	35	0.48
		60	8.0	269	41	42	0.66
			4.0	249	44	35	0.63
	SYNTHETICS	40	3.5	139	30	53	0.61
WW90H7600E*	COTTON	20	4.5	129	49	53	0.39
	COTTON	40	4.5	230	44	36	0.50
		60	9.0	270	41	49	0.80
			4.5	250	44	36	0.64
	SYNTHETICS	40	3.5	139	29	56	0.61
WW90H7410E*	COTTON	20	4.5	129	50	57	0.40
	COTTON	40	4.5	229	44	40	0.51
		60	9.0	269	41	45	0.77
			4.5	249	44	40	0.67
	SYNTHETICS	40	3.5	139	30	53	0.61

The values on the table have been measured under the conditions specified in Standard IEC60456/EN60456. Actual values will depend on how the appliance is used.

Memo

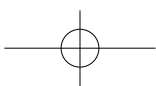
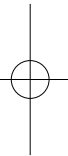
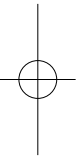
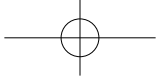

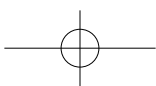
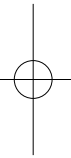
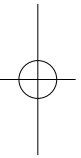
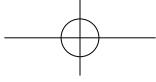



QUESTIONS OR COMMENTS?

Country	CALL	OR VISIT US ONLINE AT
U.K.	0330 SAMSUNG (7267864)	www.samsung.com/uk/support

Code No. DC68-03403Q-03_EN