

# Jabra MOTION™ OFFICE

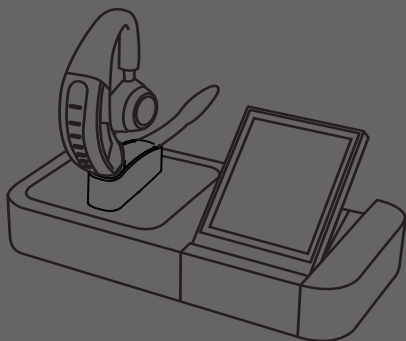

User Manual

1. WELCOME .....	4
2. PRODUCT OVERVIEW .....	6
2.1 TOUCHSCREEN BASE	
2.2 HEADSET	
2.3 BLUETOOTH ADAPTER (JABRA LINK 360™)	
2.4 OPTIONAL ACCESSORIES	
3. HOW TO WEAR.....	9
3.1 HEIGHT ADJUSTMENT	
3.2 LEFT OR RIGHT WEARING-STYLE	
3.3 EARGEL POSITIONING	
4. HOW TO CHARGE .....	11
4.1 CHARGE USING THE BASE	
4.2 CHARGING USING THE USB CABLE	
4.3 BATTERY STATUS ON THE HEADSET	
5. HOW TO CONNECT .....	13
5.1 CONNECT USING THE SETUP WIZARD (RECOMMENDED)	
5.2 CONNECT TO A DESK PHONE	
5.3 CONNECT TO A PC OR MAC	
5.4 CONNECT TO A BLUETOOTH DEVICE	
5.5 CONNECT TO AN NFC DEVICE	
5.6 TRANSFER AUDIO BETWEEN NFC DEVICE AND HEADSET	
5.7 CONNECT USING THE BLUETOOTH ADAPTER (JABRA LINK 360)	
5.8 RECONNECT WITH THE BLUETOOTH ADAPTER	

6. HOW TO USE .....	24
6.1 USING THE TOUCHSCREEN	
6.2 USING THE HEADSET	
6.3 MULTIPLE CALL HANDLING	
6.4 BUSYLIGHT	
7. MOTION SENSOR CONTROLS.....	31
7.1 CALL ASSIST	
7.2 POWER NAP	
7.3 INTELLIGENT VOLUME CONTROL	
8. SOFTWARE .....	34
8.1 JABRA CONNECT™	
8.2 JABRA PC SUITE™	
8.3 UPDATE HEADSET FIRMWARE	
8.4 CUSTOMIZE HEADSET SETTINGS	
9. ADVANCED FEATURES .....	36
9.1 WIRELESS RANGE	
9.2 VOICE COMMANDS	
9.3 HOT DESKING	
9.4 THEFT PROTECTION	
10. SUPPORT .....	43
10.1 FAQ	
10.2 SAFETONE COMPLIANCE MODE	
10.3 HOW TO CARE FOR YOUR HEADSET	
11. TECHNICAL SPECIFICATIONS .....	45

# 1. WELCOME

Thank you for using the Jabra Motion™ Office. We hope you enjoy it!

## **HEADSET FEATURES**

- Motion sensor technology
- Power Nap for extended battery performance
- Intelligent volume control
- NFC technology
- Volume touch controls
- Voice controls
- HD Voice and A2DP music streaming audio
- Wireless freedom - Up to 100m/300ft
- Noise Blackout™ 3.0
- Wind noise protection
- Jabra SafeTone™
- Busylight indicator
- Adjustable height for perfect fit

## **TOUCHSCREEN BASE FEATURES**

- 2.4 inch color touchscreen
- Desk phone, PC and Mac, and Bluetooth® mobile device connectivity
- Touchscreen-guided setup for desk phone, PC and Mac, and mobile device connections
- Touchscreen call control for all connected phones
- On-screen caller ID (mobile devices, PC and Mac only)
- Touchscreen Dial-pad (mobile devices and supported softphones only)
- Headset recharge docking cradle

## 2. PRODUCT OVERVIEW

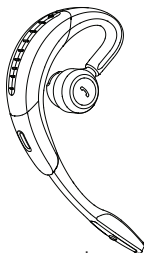

Headset

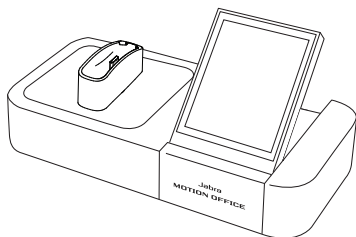

Touchscreen base



Wall charger



Micro-USB cable  
(long)

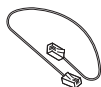

Telephone cable

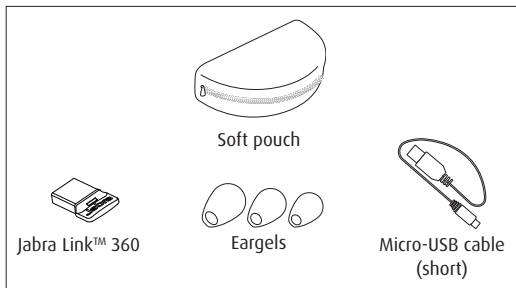

## 2.1 TOUCHSCREEN BASE

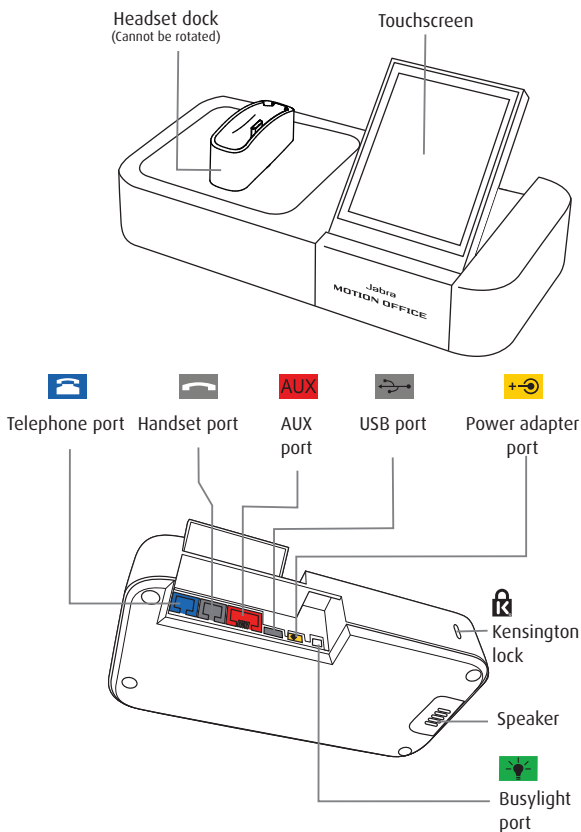

## 2.2 HEADSET

---

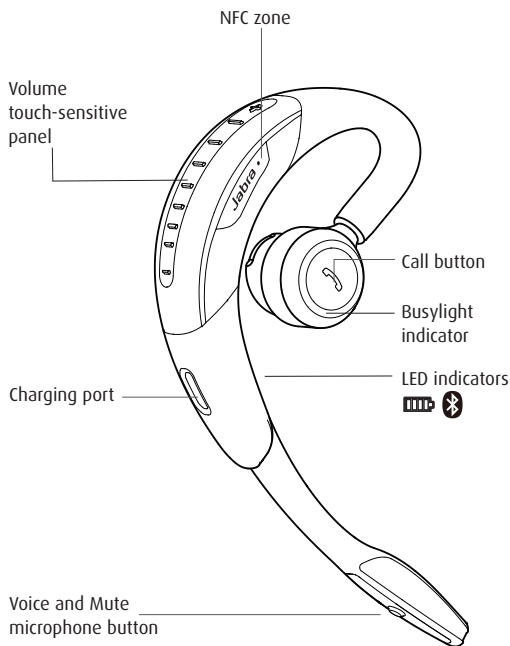



## 2.3 BLUETOOTH ADAPTER (JABRA LINK 360™)

---

The Bluetooth adapter (Jabra Link 360) is a plug-and-play Bluetooth adapter that connects the headset to your PC, without using the base.

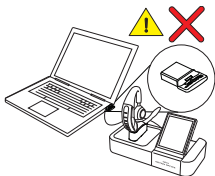

**IMPORTANT!** The Bluetooth adapter and the Jabra Motion Office base should NOT be plugged in to a PC at the same time.

## 2.4 OPTIONAL ACCESSORIES

---

All accessories are available at [jabra.com](http://jabra.com).



Jabra Motion  
headset



GN1000  
handset lifter



USB car charger



Jabra Link 360



Eargels  
(3 sizes)



Soft pouch



Base power  
supply



Micro-USB cable

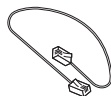

Telephone cable



USB power supply

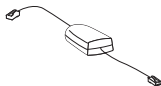

EHS cable  
(Jabra Link)



Travel & Charge  
kit

## 3. HOW TO WEAR

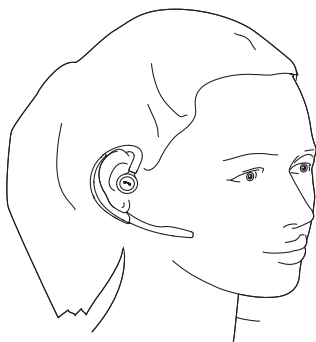

### 3.1 HEIGHT ADJUSTMENT

---

Get the perfect fit for your ear by adjusting the height of the speaker up or down.

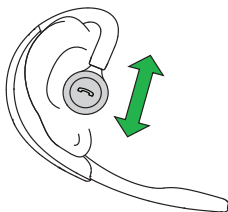

## 3.2 LEFT OR RIGHT WEARING-STYLE

---

The headset can be worn on the left or right ear. To switch ear:

1. Pull the speaker all the way down.
2. Rotate the speaker 180°.
3. Twist the eargel around to fit.

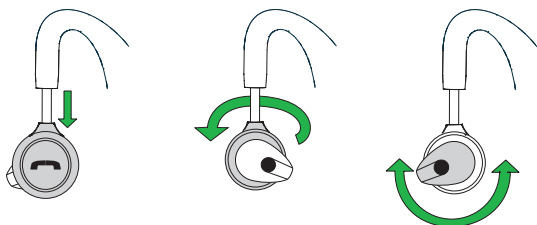

## 3.3 EARGEL POSITIONING

---

For optimal audio quality rotate the eargel for best fit. It is recommended to try all three eargel sizes to find the optimal fit.

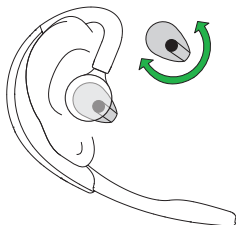

## 4. HOW TO CHARGE

### 4.1 CHARGE USING THE BASE

---

When the headset is docked in the base, and the base is connected to power, the headset will be charged.

The battery indicator  on the touchscreen indicates that the headset is charging.



### 4.2 CHARGE USING THE USB CABLE

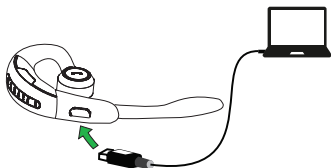

---

Plug the headset into any available USB port on your PC using the supplied USB cable.



## 4.3 BATTERY STATUS ON THE HEADSET

---

	IN USE	WHEN CHARGING
	50% - 100%	100%
	10% - 50%	50% - 100%
	0% - 10%	0% - 50%

---

**NOTE:** It takes up to 2 hours to fully charge the headset.

# 5. HOW TO CONNECT

## 5.1 CONNECT USING THE SETUP WIZARD (RECOMMENDED)

---

1. Plug the Jabra Motion Office base into a power supply.
2. The setup wizard automatically starts the first time the base is turned on.



**NOTE:** The setup wizard can be accessed at any time via the touchscreen menu (tap  on the touchscreen to open the settings menu, and then tap 'Phone Settings' > 'Setup wizard').

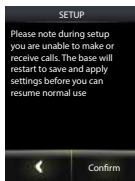
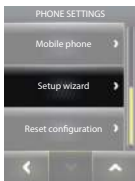



## 5.2 CONNECT TO A DESK PHONE

---

### DESK PHONE WITH A HEADSET PORT

This type of desk phone has a dedicated headset port (usually at the back of the phone).

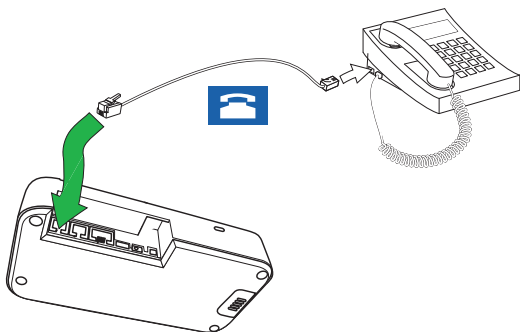

1. Plug the supplied telephone cable into the port marked  on the Jabra Motion Office base.
2. Connect the telephone cable to the headset port  on the desk phone.





## DESK PHONE WITHOUT A HEADSET PORT

This type desk phone does not have a dedicated headset port.

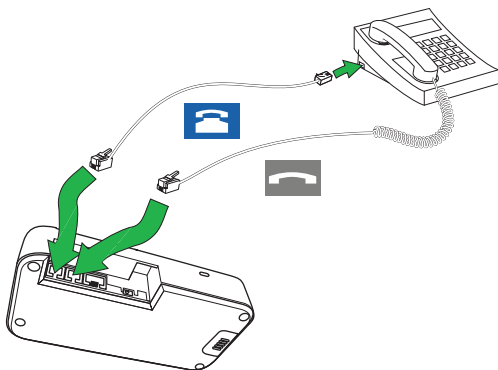

1. On the desk phone, unplug the handset cable from the phone body
2. Connect the handset cable to the port marked  on the base
3. Plug the supplied telephone cable into the port marked  on the base
4. Connect the telephone cable into the handset port on the desk phone.



## 5.3 CONNECT TO A PC OR MAC

---

Connecting to a PC or Mac allows connectivity with a softphone (e.g. Skype). Supported softphones have full functionality with the headset, such as answering and ending calls with the headset multi-function button.

1. Plug the supplied USB cable into the port marked  on the Jabra Motion base and then into your PC or Mac.
2. Download and install Jabra PC Suite from [www.jabra.com/pcsuite](http://www.jabra.com/pcsuite), or install Jabra Suite for Mac from [www.jabra.com/support/jabra-mac-suite](http://www.jabra.com/support/jabra-mac-suite)
3. Tap  on the touchscreen to open the settings menu, and then tap 'Phone Settings' > 'Enable Softphone'. If your softphone is not supported, select 'None (audio only)'.

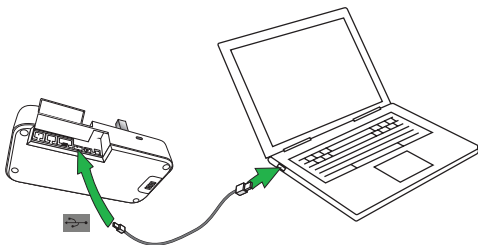

## 5.4 CONNECT WITH A BLUETOOTH DEVICE

---

### CONNECT USING THE HEADSET

1. While pressing the **Call** button, open the flip boom-arm. Release the **Call** button when the Bluetooth light flashes blue.
2. Wear on the ear and follow the voice-guided connection instructions.

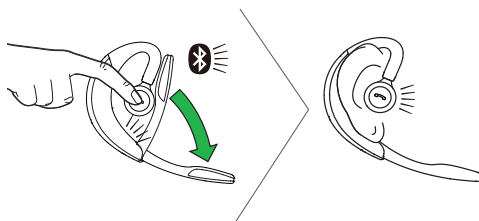

### CONNECT USING THE TOUCHSCREEN

1. Tap the tool icon  on the touchscreen to open the settings menu, and then tap 'Phone Settings' > 'Mobile phone' > 'Setup mobile phone'.
2. Follow the touchscreen instructions to connect to your Bluetooth device.

## 5.5 CONNECT WITH AN NFC DEVICE

---

1. Ensure that NFC is enabled on your mobile device.
2. Open the flip boom-arm on the headset.
3. Locate and gently tap the NFC zone on the headset against the NFC zone on your mobile device. The mobile device will announce that the headset is now paired when the connection is successful.

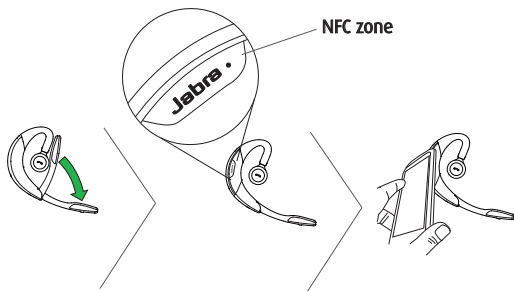

**NOTE:** NFC devices have NFC implemented in different ways. The size and sensitivity of the NFC zone and how to connect the headset may vary between devices.

## 5.6 TRANSFER AUDIO BETWEEN NFC DEVICE AND HEADSET

---

To transfer a call to/from the headset to your connected NFC device, gently tap the NFC zones of the headset and device.

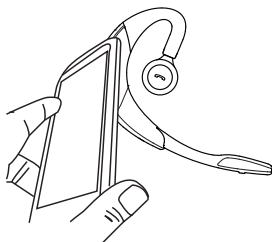

**NOTE:** NFC devices have NFC implemented in different ways. Depending on the NFC device, this feature might not be available.

## 5.7 CONNECT USING THE BLUETOOTH ADAPTER (JABRA LINK 360)

---

The Bluetooth adapter (Jabra Link 360) is a plug-and-play Bluetooth adapter that connects the headset to your PC, without need for the base.

The Bluetooth adapter and the headset are already pre-paired.

1. Plug the Bluetooth adapter (Jabra Link 360) into any available USB port on your PC.
2. Open the flip boom-arm on the headset to connect the headset to the Bluetooth adapter.
3. The connection is established when the LED on the Bluetooth adapter stops flashing and shows a solid blue light.

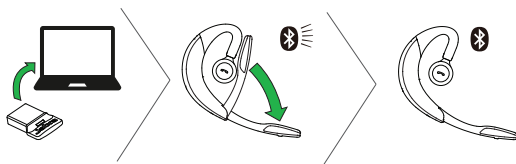

**IMPORTANT!** The Bluetooth adapter and the Jabra Motion Office base should NOT be plugged in to a PC at the same time.

## 5.8 RECONNECT WITH THE BLUETOOTH ADAPTER

---

1. Remove the Bluetooth adapter (Jabra Link 360) from the PC.
2. While pressing the **Call** button, open the flip boom-arm on the headset. Release the **Call** button when the Bluetooth indicator flashes blue.
3. Wear the headset and follow the voice-guided pairing instructions.
4. Plug the Bluetooth adapter into the PC to automatically connect to the headset. Connection can take up to 1 minute.

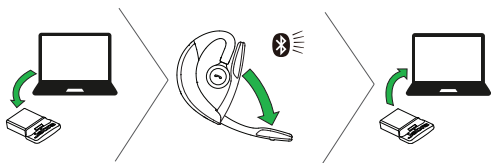

# 6. HOW TO USE

## 6.1 USING THE TOUCHSCREEN

---





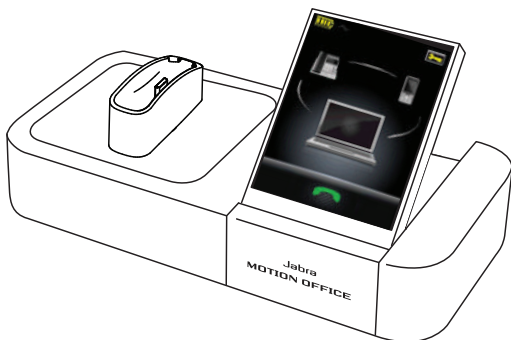



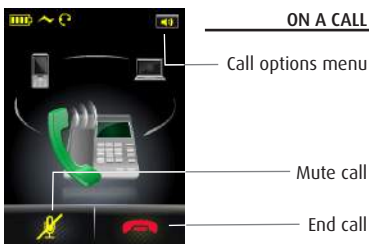
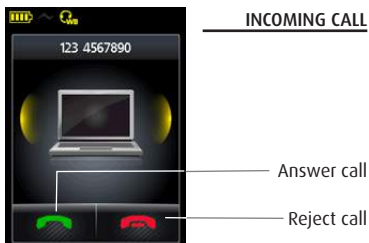
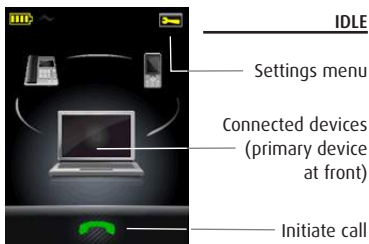

The Jabra Motion Office touchscreen enables you to connect and configure the Jabra Motion Office, manage call handling, and manage the base, headset and phone settings.

Tap the screen with your finger to activate icons, scroll up/down a menu, select a target phone and make, answer or end calls.







	Tap a connected device to switch primary device
	Tap to start a call on the selected primary device
	Tap to end the current call
	Tap to mute the current call. Tap again to unmute
	Indicates current battery level
	Indicates the headset is docked
	Indicates an open audio connection between the base and the headset. If the headset icon has an WB on it, it indicates HD voice audio is active
	Tap to open the settings menu. The menu is only available when not on a call
	Tap to open the call options menu. The menu is only available when on a call
	Tap to activate voice commands on your phone

## 6.2 USING THE HEADSET

---

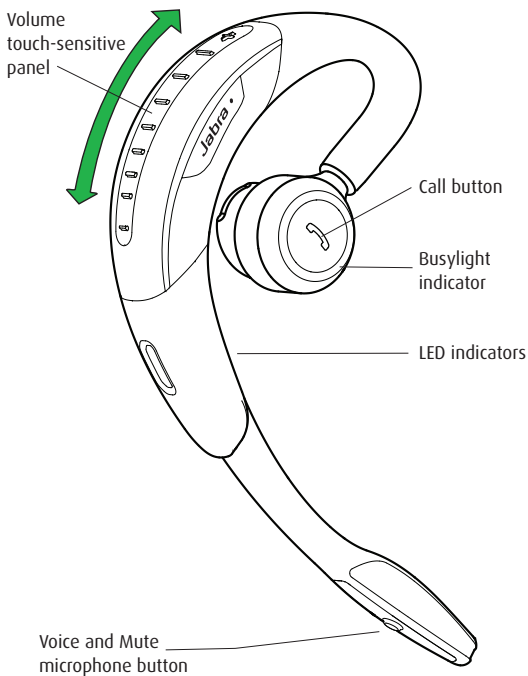



On/off

Open or close the flip boom-arm



Answer call

Open the flip boom-arm, or tap the **Call** button if the boom-arm is open

End call

Close the boom-arm, or tap the **Call** button

Talk time status

When not on a call, tap the **Call** button to hear the remaining talk time



Reject call

Double-tap the **Call** button when there is an incoming call

Redial last number

Double-tap the **Call** button when not on a call

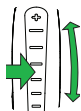

Adjust speaker volume

Slide a finger up/down the **Volume** touch-sensitive panel

Voice commands

Tap the **Voice and Mute microphone** button when not on a call, until you hear 'Say a command'. Say 'What can I say?' for a list of voice commands



Mute/un-mute microphone

Tap the **Voice and Mute microphone** button during a call to mute the microphone. Tap again to un-mute.

## 6.3 MULTIPLE CALL HANDLING

---

The headset or base can accept and handle multiple calls simultaneously.

### HEADSET

---



End current call and answer incoming call

Tap the **Call** button

Switch between held call and active call

Press and hold (2 secs) the **Call** button

Put current call on hold and answer incoming call

Press and hold (2 secs) the **Call** button



Reject incoming call

Double-tap the **Call** button

## 6.4 BUSYLIGHT

---

The Busylight indicator on the headset has 2 features.

**Incoming call**  
(fast flash)

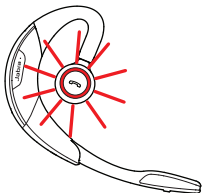

**On a call**  
(slow flash)

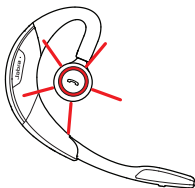

An external Jabra Busylight™ can also be connected to the base via the busylight port.

**NOTE:** The Busylight indicator in the headset is default enabled, and can be disabled using Jabra PC Suite or the Jabra Connect app.

## 7. MOTION SENSOR CONTROLS

### 7.1 CALL ASSIST

---

If the flip boom-arm is open, simply pick up the headset from the desk to your ear to automatically answer an incoming call.

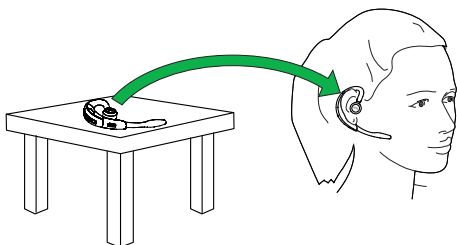

**NOTE:** Call Assist is default enabled, and can be disabled using Jabra PC Suite or the Jabra Connect app.

## 7.2 POWER NAP

---

To extend battery life always close the flip boom-arm when the headset is not in use. If the flip boom-arm is left open the headset will enter Power Nap mode when it has not been moved for 60 minutes (when Bluetooth connected), or 15 minutes (when Bluetooth not connected). The headset will announce 'Power Off' when it enters Power Nap mode.

To exit Power Nap mode, move or pick up the headset. The headset will announce 'Power On' when exiting Power Nap mode.

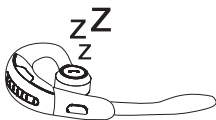

**NOTE:** If the headset is in Power Nap mode for 24 hours, the headset will automatically turn off 100% to preserve battery. To turn the headset back on, close the flip boom-arm and then open it.

Power Nap is default enabled, and can be disabled using Jabra PC Suite or the Jabra Connect app.



## 7.3 INTELLIGENT VOLUME CONTROL

---

The headset uses Intelligent Volume Control to adjust the headset speaker volume depending on the motion of the wearer, and the sounds of the surrounding environment (e.g. automatically increasing the speaker volume on an active call when walking or entering a noisy environment).

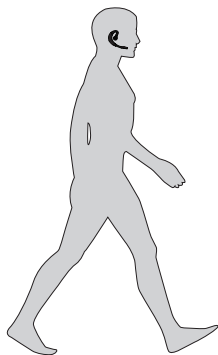

**NOTE:** Intelligent Volume Control is default enabled, and can be disabled in Jabra PC Suite or the Jabra Connect app.

## 8. SOFTWARE

### 8.1 JABRA CONNECT™

---

Jabra Connect is a smartphone app designed to be used when connected to the headset via the Bluetooth adapter (without the base). The app enables call control and configuration of Jabra Motion Office headset.

Android download - Google Play  
iOS download - App Store

### 8.2 JABRA PC SUITE™

---

Jabra PC Suite is PC software designed to support, manage and enable optimal functionality for Jabra devices. It is highly recommended to download and install Jabra PC Suite.

Download the latest version - [jabra.com/pcsuite](http://jabra.com/pcsuite)

### 8.3 UPDATE HEADSET FIRMWARE

---

Firmware updates improve performance or add new functionality to Jabra devices. Firmware can be updated using Jabra PC Suite.

## 8.4 CUSTOMIZE HEADSET SETTINGS

---

Jabra Motion Office settings can be customized using Jabra PC Suite, Jabra Connect mobile app or the Touchscreen settings menu.

### **JABRA CONNECT, JABRA PC SUITE & TOUCHSCREEN SETTINGS**

- Busylight indicator
- Power Nap mode
- Intelligent Volume Control
- Voice controls
- Sound profiles (equalizer)
- Mute reminder tone
- Call assist

### **JABRA PC SUITE & TOUCHSCREEN ONLY SETTINGS**

- Jabra Safetone™
- Wireless range (and density performance)
- Automatic PC Audio detection
- Target softphone for outgoing calls
- Connect/Pairing (Headset and Bluetooth adapter)
- Base settings (e.g. touchscreen language, touchscreen backlight level, touchscreen ringer volume)

## 9. ADVANCED FEATURES

### 9.1 WIRELESS RANGE

---

The wireless range of the headset, the base or Bluetooth adapter (Jabra Link 360) can be changed using the touchscreen, or using Jabra PC Suite on your PC.

By default, the wireless range is set to Normal. If many units are in close vicinity it is recommended to set the wireless range to Low or Very Low to improve the audio quality and density performance.

#### **CHANGE HEADSET WIRELESS RANGE**

1. Tap the  on the touchscreen.
2. Tap Base settings > Wireless range.
3. Tap to select the wireless range required: Very low, Low or Normal. Normal is default selected.
4. Tap confirm to apply the settings, and reset the base.

#### **CHANGE BLUETOOTH ADAPTER WIRELESS RANGE**

The Bluetooth adapter's wireless range can be adjusted between Normal (default), Low and Very low using Jabra PC Suite.

## **WIRELESS RANGE INFORMATION**

The Jabra Motion Office and the Jabra Link 360 support a maximum wireless range of up to 100m (300ft). Maximum range between the headset and a mobile device e.g. a smartphone or tablet is up to 10m (33ft). Physical obstructions and electromagnetic interference may shorten this range.

Headset sound quality may slowly deteriorate the further the headset is away from the touchscreen base, Bluetooth adapter or mobile device, and may improve the closer the headset is to the touchscreen base, Bluetooth adapter or the mobile device.

## **HEADSET OUT OF RANGE**

If the headset is on a call when moved out of range the audio will be lost, however the call will remain active for 120 seconds. To restore audio to the call, move the headset back into range of the touchscreen base, Bluetooth adapter or the mobile device.

## 9.2 VOICE COMMANDS

---

Voice commands are on by default. To turn voice commands on/off:

1. Press and hold the **Voice and Mute microphone** button while opening the flip boom-arm.
2. Release the the **Voice and Mute microphone** button when the flip boom-arm is open.

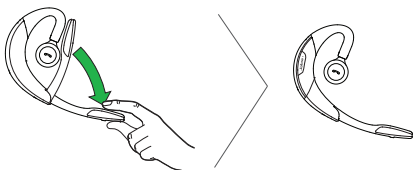

**NOTE:** Voice commands can be disabled in Jabra PC Suite, the Jabra Connect app, or by using the headset.

## CHANGE VOICE LANGUAGE

The default language for voice commands and voice guidance can be changed using Jabra PC Suite.

### LIST OF VOICE COMMANDS

What can I say?	Hear a list of all voice commands
Answer	Answer incoming call
Ignore	Reject incoming call
Pair new device	Enter pairing mode
Redial	Redial last number dialed
Call back	Call the phone number that last called you
Battery	Hear current battery status
Cancel	Cancel voice command
Phone commands	Turns on the connected device's phone commands (e.g. Siri)

### LIST OF VOICE GUIDANCE

Power on
Power off
Welcome. You are now ready for pairing. Go to the Bluetooth menu on your phone...
Pairing cancelled

## LIST OF VOICE GUIDANCE

Pairing failed

---

Connected (Headset connected to base)

---

Disconnected (Headset disconnected from base)

---

Mobile connected (Headset connected to Bluetooth device e.g. Smartphone/Tablets)

---

Mobile disconnected (Headset disconnected from Bluetooth device e.g. Smartphone/Tablets)

---

PC connected (Headset connected to PC via Jabra Link 360 Bluetooth Adapter)

---

PC disconnected (Headset disconnected from PC)

---

Two devices connected

---

Not connected

---

Redialing

---

Mute on / Mute off

---

Call from (name or number from phone address book)

---

Unknown caller

---

Low battery

---



## LIST OF VOICE GUIDANCE

Your remaining talk time is...

---

Say a command

---

Voice on

---

Voice off

---

## 9.3 HOT DESKING

---

Connect any Jabra Motion headset to any Jabra Motion Office Base. Headset must have the latest firmware version installed.

When a new Jabra Motion headset is docked into any Jabra Motion Office base, the touchscreen will prompt you that a new headset had been detected. Tap 'Yes' to accept the new headset, or tap 'No' to reject the new headset.

## 9.4 THEFT PROTECTION

---

The Jabra Motion Office base has a Kensington Security Slot for attaching a security cable. To secure the base to your desk, attach any safety cable usable with the Kensington Security Slot.

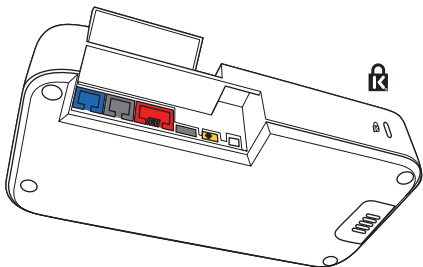

# 10. SUPPORT

## 10.1 FAQ

---

View the full FAQ at [jabra.com/motionoffice](http://jabra.com/motionoffice).

## 10.2 SAFETONE COMPLIANCE MODE

---

For compliance with EU Directive 2003/10/EC (Noise at work) and Australian G616 guidelines set the headset into the desired compliance/guideline mode.

1. Install and open Jabra PC Suite Control Center.
2. In Control Center, set the desired mode by ticking off the box 'SafeTone protection' in the section 'Audio protection'.

Alternatively Safetone can be enabled using the touchscreen. Open the settings menu, and select 'Headset Settings' and then 'Audio Protection'

### **FOR TCO COMPLIANCE:**

1. Install and open Jabra PC Suite Control Center.
2. In Control Center, set the desired mode by adjusting the 'Wireless range' to 'Low' or 'Very low'.

## 10.3 HOW TO CARE FOR YOUR HEADSET

---

- Always store the headset with the power off and safely protected
- Avoid storage at extreme temperatures (above 35°C/95°F or below -20°C/-4°F). This can shorten battery life and may affect headset operation
- Do not expose the headset to rain/liquids

# 11. TECHNICAL SPECIFICATIONS

HEADSET	DESCRIPTION
Weight:	17.5g
Dimensions:	L 53.5mm x W 16mm x H 24mm
Microphones:	2 Omni-directional microphones with Jabra Noise Blackout technology
Speaker:	Micro dynamic, 14.8mm
Operating range:	Up to 100m (300 feet), Class 1
Bluetooth version:	4.0
Paired devices:	Up to 8 stored devices, 2 connected devices at same time (Multiuse™)
Supported Bluetooth profiles:	A2DP (v1.6), Hands free profile (v1.6), Headset profile (v1.2)
Talk time:	Up to 8 hours Up to 6.5 hours (with Busylight on)
Standby time:	Up to 15 days
Operating temperature:	-10°C to 60°C (14°F to 140°F)
Storage temperature:	-20°C to 35°C (-4°F to 95°F)
AC power supply	100-240V, 50-60Hz
Pairing passkey or PIN:	0000

TOUCHSCREEN BASE	DESCRIPTION
Dimensions:	L 160mm x W 94mm x H 82mm
Touchscreen:	2.4 inch touch-sensitive TFT. QVGA resolution
Audio:	Built-in speaker
Audio bandwidth:	HD voice (wideband), A2DP (music streaming), Narrowband,
Desk phone connections:	RJ-9 for handset, RJ-9 for phone body (or headset port), RJ-45 for AUX (for electronic hookswitch or GN1000 handset lifter)
Remote call control standards:	GN1000, Jabra IQ EHS, Cisco, DHSG and MSH. Each requires additional cabling and/or equipment available separately; more may become available in future and added via firmware upgrade. GN1000 is supported by default and requires no additional configuration
PC connection:	USB 2.0 Micro-USB
Bluetooth version:	4.0
Bluetooth range:	Up to 100m (300ft), Class 1
Busylight connector:	2.5mm jack connector (available as an accessory)
Theft protection:	Kensington Security Slot standard

<b>BLUETOOTH ADAPTER (JABRA LINK 360)</b>	<b>DESCRIPTION</b>
PC connection:	USB 2.0
Bluetooth version:	4.0
Bluetooth range:	Up to 100m (300 feet), Class 1
Bluetooth profiles:	A2DP (v1.2), Hands free profile (v1.6)
Simultaneous Bluetooth connections:	1
Bluetooth audio bandwidth	HD voice (wideband), A2DP
Visual indicators:	Multicolor LED

