



The Unitech MS100 Linear Imager Scanner
Installation Instructions & Popular Configuration Settings

SETUP AND INSTALLATION

The following steps will show you how to install your scanner.

CONNECT TO HOST VIA USB

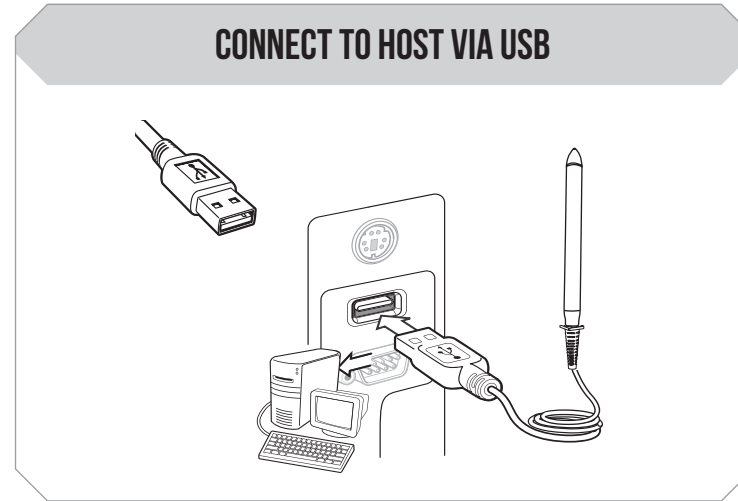

Plug the interface cable into a free USB port of a host computer.

CONNECT TO HOST VIA RS232

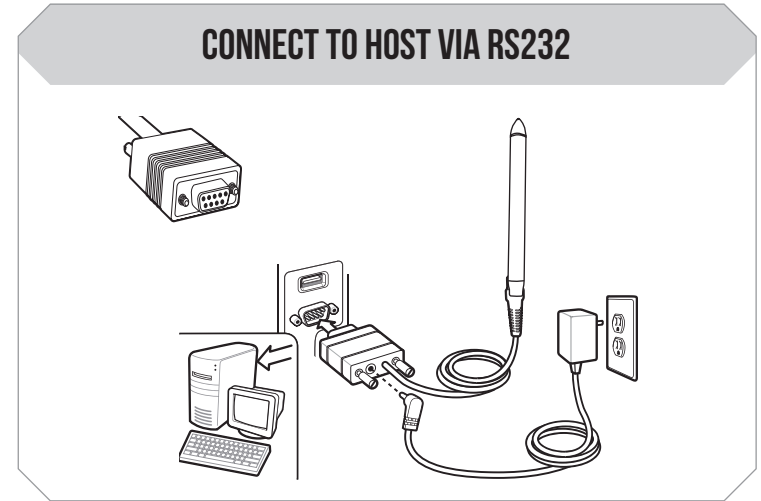

Plug the interface cable into the RS232 port of a host computer.
Plug the power supply cable into the RS232 connector and into an electrical outlet.*

CONNECT TO HOST VIA PS/2

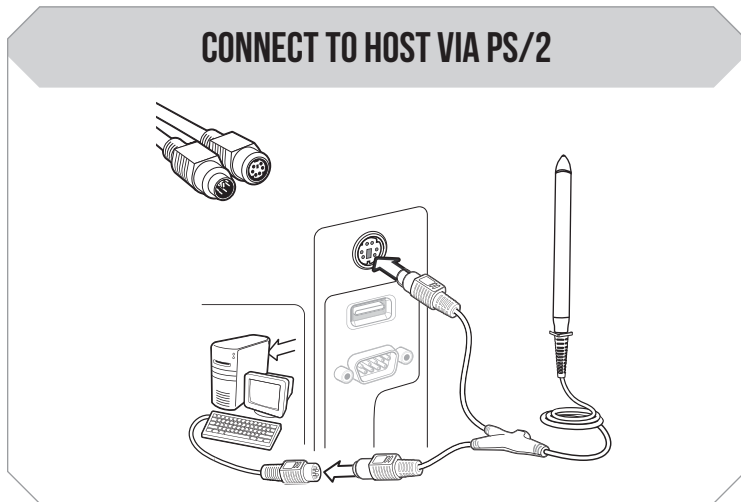

Plug the interface cable into a free USB port of a host computer.

TEST & FINISH

Open a word processing program such as Microsoft Word or Notepad on your host. Now scan the following barcode:



If the word "Unitech" appears on the screen you have successfully installed your scanner. Congratulations!

SETTINGS AND CONFIGURATION

The following section covers the most common configuration settings for your MS100 scanner.

For additional configuration options please visit unitechscanners.com/MS100 and select the "Download" tab. You will find the User's Manual and a variety of other resources.

TAB MODE



Tab Mode



You may wish to set your scanner to "Tab Mode." In this mode, data will tab over to the next column as you scan instead of jumping to the next line. Scan the top barcode then the bottom barcode to switch to Tab Mode from the default Enter Mode.

DEFAULT SETTINGS



Factory Default

Scan here to switch back to Enter Mode. This barcode will also return your scanner to its original factory settings, a useful feature for troubleshooting purposes.

HOW CAN WE HELP YOU?

The MS100 is a plug-and-play pen scanner.* It does not require a driver and should be recognized as a generic HID device by your computer, similar to a standard keyboard. This allows you to scan into any field that you could normally type into.

Unitech's professional support team is available to quickly answer questions or technical-related issues. Should equipment issues occur, please contact a Unitech Service Representative at (800) 861-8648 for more information.

*RS232 connections may require additional software