

Installation Instructions

telehook

Furniture Mount

Component Checklist

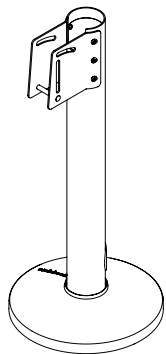

Pole Assembly



Mounting Bracket (x2)

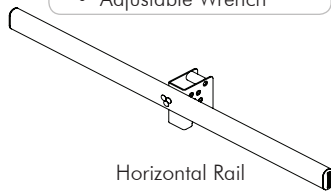

Horizontal Rail



Top Cap

Tools Required:

- 8mm Drill Bit
- 50mm Hole Saw
- Adjustable Wrench

HARDWARE

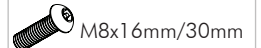
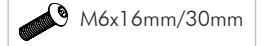

M6x10 Security Screw (x3)

M6 Washer (x7)
M8 Washer (x4)

Display Mounting Screws (x4 each)

M6 Spacer (x4)
M8 Spacer (x4)

IMPORTANT INFORMATION:

! IMPORTANT - Install Telehook Furniture Mount as per installation instruction.

- ! This product supports a maximum load of 35kg (77lbs.).
- ! This product has a universal mounting hole pattern that suits a broad range of TV's: From 100-600mm in width and 100-400mm in height.
- ! The manufacturer accepts no responsibility for incorrect installation.

Step 1. Check Components

Check you have received against the component checklist and hardware above.

Step 2. Limit Rotation and Position

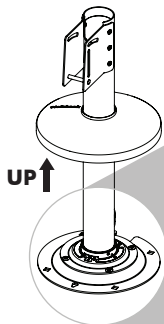

The Limit of Rotation is dependant on the location of the Set Screw.

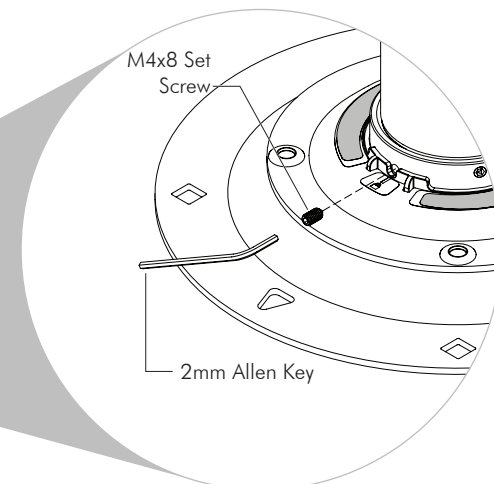

NOTE: Use 2mm Allen Key to remove and insert M4x8 Grub Screw to the desired hole position.

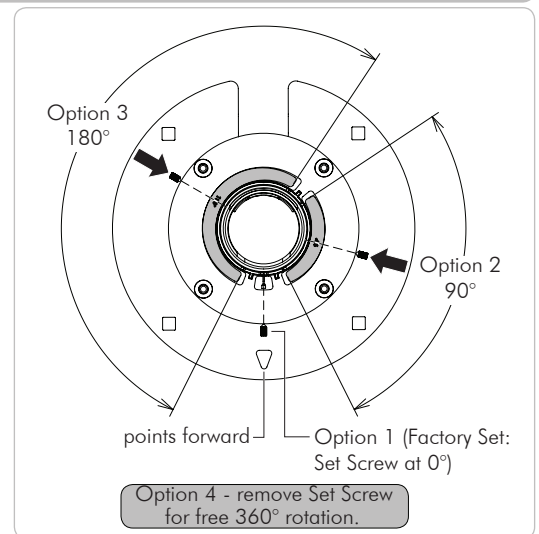

Step 3. Check Space

Before installing your TH-FM check your proposed location has enough space for the amount of rotation you are planning to use.

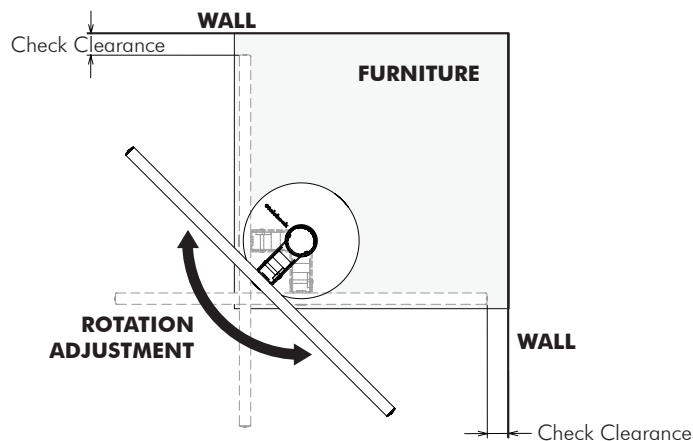

Step 4. Cable Management

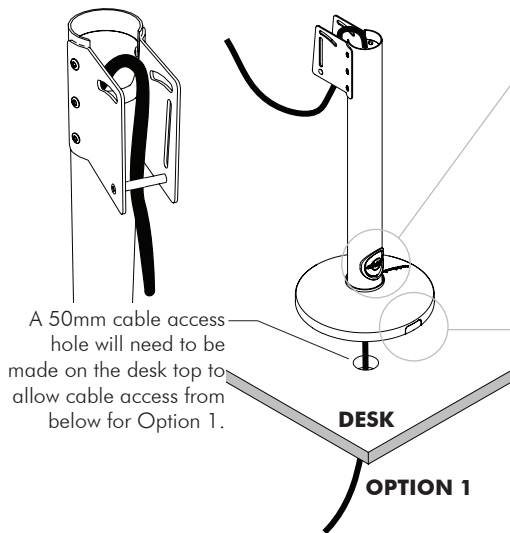

OPTION 2

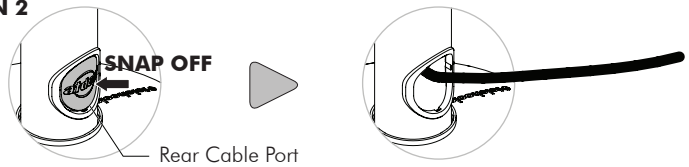

OPTION 3

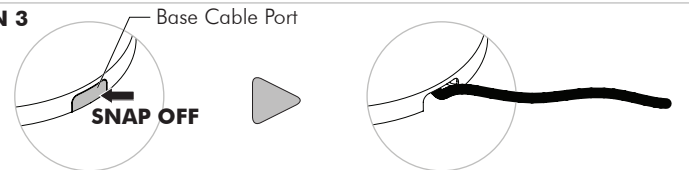

NOTE: The cable needs to be in place BEFORE the furniture mount is attached to the furniture top when using this configuration.

Step 5. Locate and Secure the Furniture Mount

OPTION 1

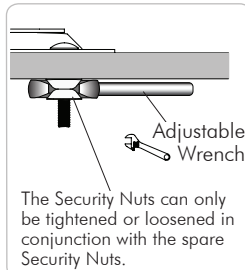
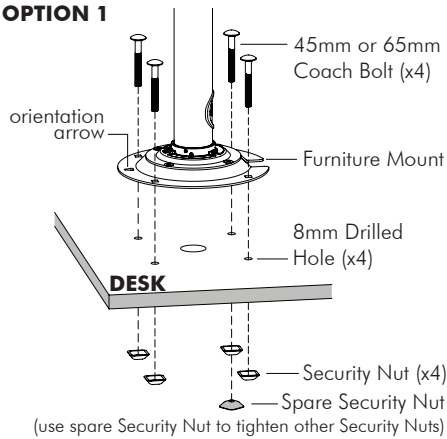

NOTES:

1. Use 45mm Coach Bolt for 15-25mm surface thickness and 65mm Coach Bolt for 25mm-45mm surface thickness.
2. Remove the spare Security Nut after tightening other Security Nuts. Keep it in a safe place for future usage.

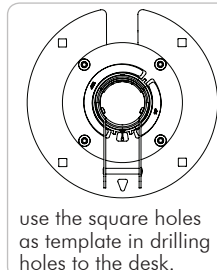

OPTION 2

Atdec recommends a good quality Brand Name contact adhesive. Please follow directions on the product.

APPLY ADHESIVE

GLASS or STONE SURFACE

NOTE: If Option 2 is preferred to secure your Furniture Mount, all cables need to be in place before the Furniture Mount is attached to the surface.

Step 6. Install the Horizontal Rail

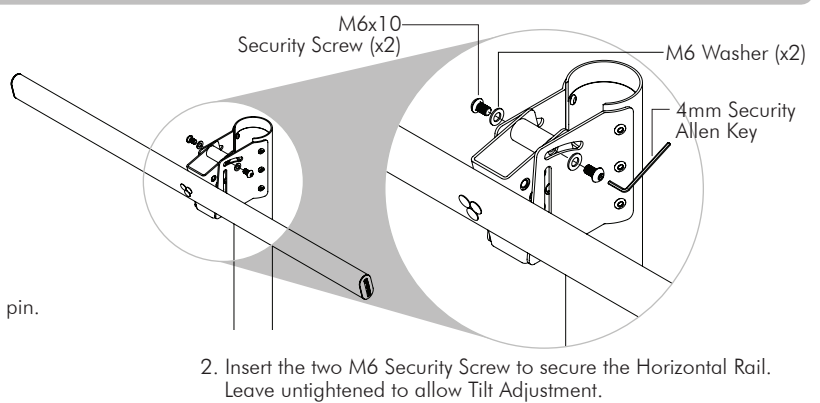
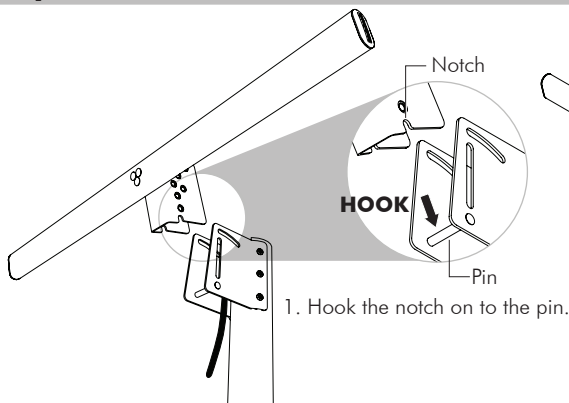

Step 7. Tilt Adjustment

OPTION 1: -5° to +20° Free Tilt Adjustment

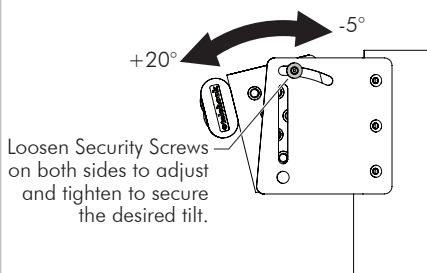

OPTION 2: 5° Incremental Tilt Adjustment from -5° to +20°

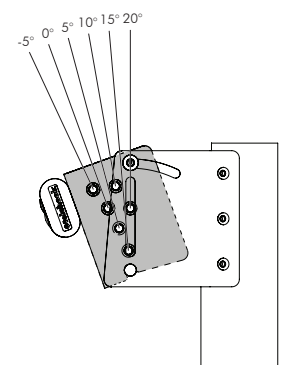
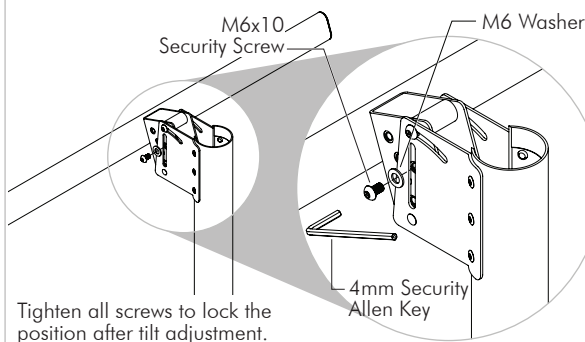

Step 8. Attach Bracket Mount to Display

The mounting brackets support hole configurations from 100x100mm to 600x400mm.

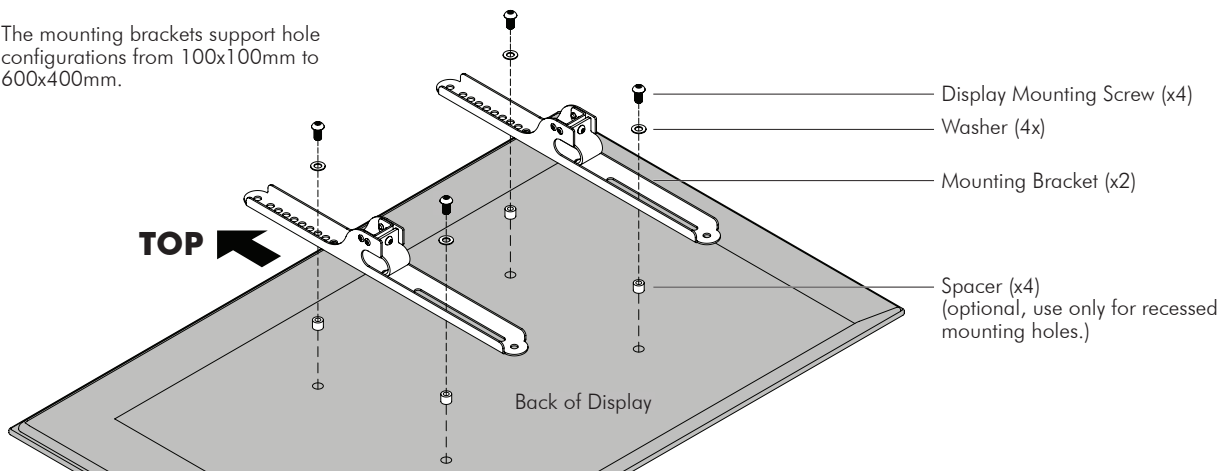

Step 9. Attach Bracket Mount with Display to Horizontal Rail

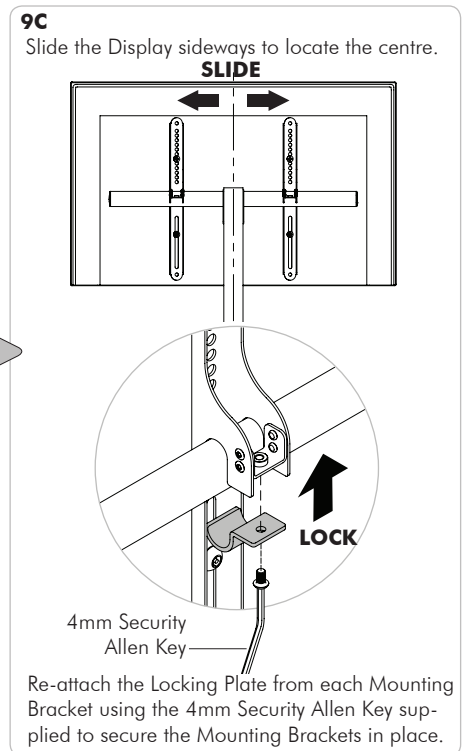
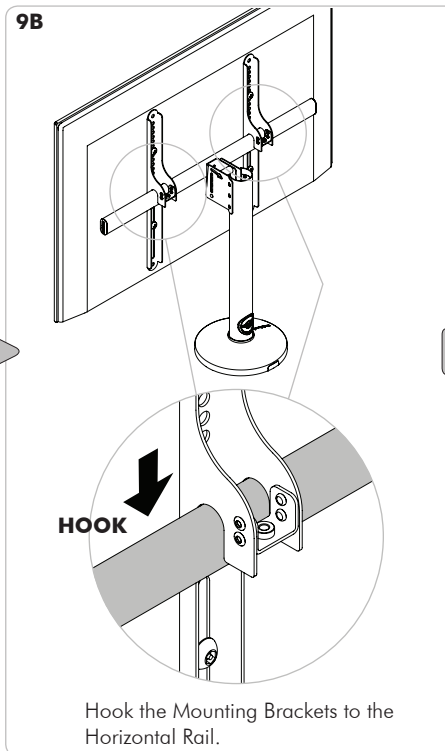
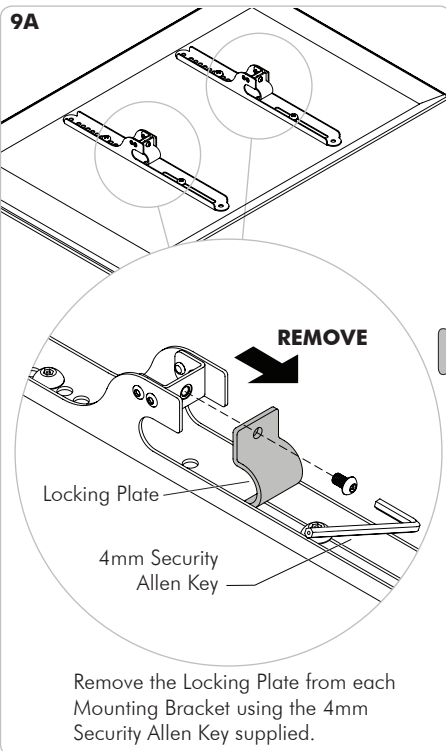

Step 10. Insert the Top Cap and Push down Base Cover in place

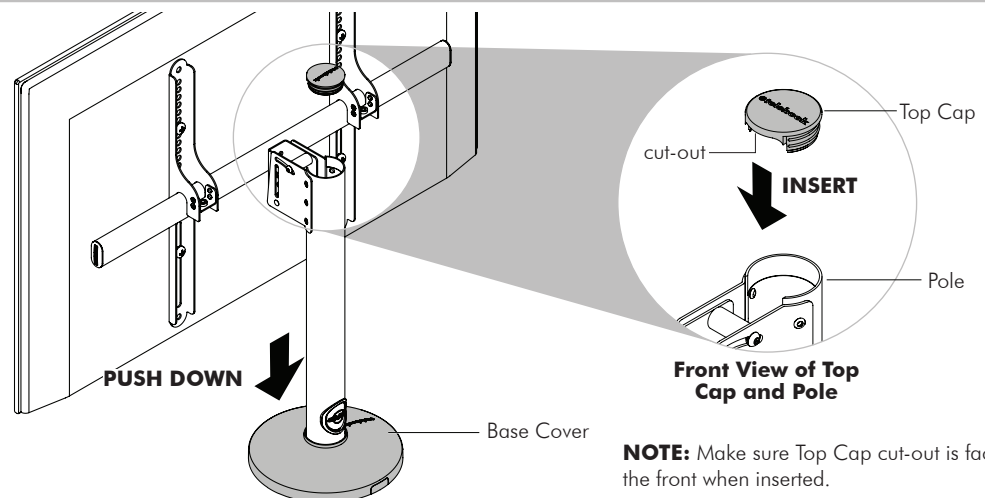

Installation Complete



No portion of this document or any artwork contained herein should be reproduced in any way without the express written consent of Atdec Pty Ltd. Due to continuing product development, the manufacturer reserves the right to alter specifications without notice. Published 30.07.12 ©