

# 3M

## mobileprojector



quick  
start



quick start .....	4
démarrage rapide .....	14
kurzanleitung .....	24
inicio rápido .....	34
guida rapida .....	44
snelstartgids .....	54
快速入门指南 .....	64
快速入門指引 .....	74
クイックスタートガイド .....	84
빠른 시작 가이드 .....	94

English

Français

Deutsch

Español

Italiano

Nederlands

简体中文

繁體中文

日本語

한국어

## Thank You

Thank you for purchasing the mobile projector from 3M. Now you can enjoy your favorite movies, TV shows, videos, and photo slideshows in larger than life viewing – on walls, floors, and even ceilings! This little projector can project images from other devices, with additional cables (sold separately).

## Important Notice

Before using this product, please read all warning and caution statements in the Product Safety Guide.

## Warranty

The 3M™ Mobile Projector MP220 (the “3M product”) is warranted to be free from defects in material or manufacture for a period of 1 year from the date of purchase. If the product needs service please call 1-866-631-1656. For the detailed terms and conditions of the Warranty, refer to the Product Safety and Warranty Guide or contact us at 1-866-631-1656 or [meetings@mmm.com](mailto:meetings@mmm.com) or go to [www.3mpocketprojector.com/support](http://www.3mpocketprojector.com/support).

## Customer Support

For manuals, frequently asked questions, and technical support, call 1-866-631-1656 (Toll Free in the US) or go to [www.3mpocketprojector.com/support](http://www.3mpocketprojector.com/support).

## Updating Software

For information on updating your MP220, please go to <http://www.3mpocketprojector.com/support>.

## Remove Battery Protective Film

The mobile projector comes with a partially charged battery. Before use, remove the protective film and fully charge the battery.

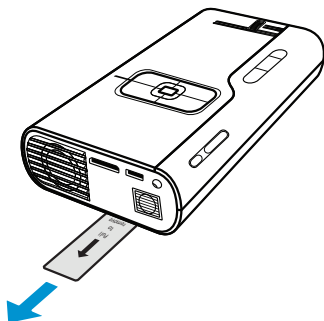

## Assemble the Power Adapter

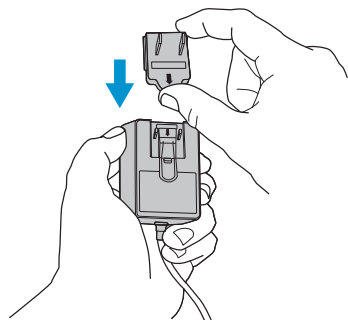

## Charge the Battery

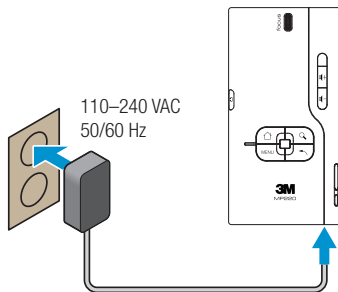

3 hours

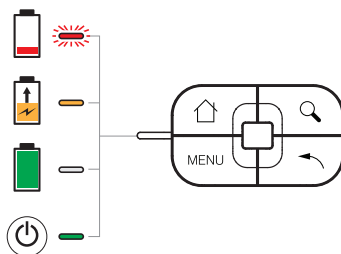

## Parts

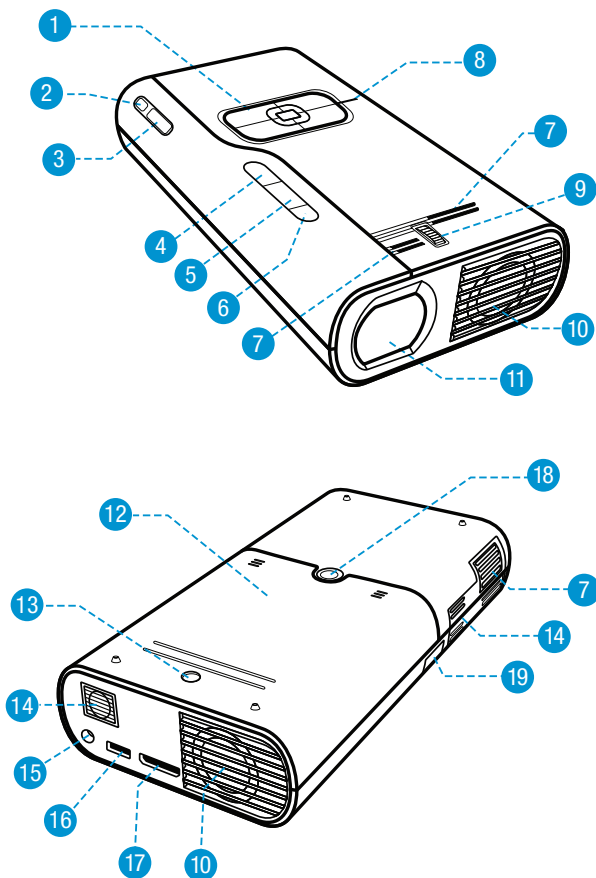

- 1 Navigation panel
- 2 Power On/Off – Powers the projector on and off, or turns off the lamp.
- 3 microSD card slot – Accepts a 32GB or less microSD card.
- 4 Volume down – Turns down speaker or audio out output.
- 5 Volume up – Turns up speaker or audio out output.

- 6 **IR sensor** – Accepts commands from 3M remote control. Remote control sold separately.
- 7 **Air vents** – Do not block fans or vents while projector is operating or cooling down. This will cause projector to overheat and automatically turn off.
- 8 **Status indicator LED**
- 9 **Focus wheel** – Adjusts to sharpen image.
- 10 **Cooling fans** – Do not block fans or vents while projector is operating or cooling down. This will cause projector to overheat and automatically turn off.
- 11 **Lens**
- 12 **Battery compartment**
- 13 **Battery cover securing screw**
- 14 **Speakers**
- 15 **DC power in** – Powers the projector or charges the battery using the 3M power supply.
- 16 **USB** – Transfer files back and forth from your computer to the projector. Attach a USB computer mouse, or keyboard. Access files on USB memory stick.
- 17 **VGA-AV** – Connect the 3M VGA or Video cable to your computer, DVD Player, or other video device and project its image. Cables sold separately.
- 18 **Tripod Mount**

- 19 **Earphone jack** – Attach earphones or computer speakers.

## Navigation Panel

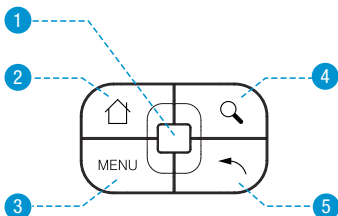

- 1 **Touch sensor** – Moves pointer around screen or chooses between available menu items.
- 2 **Home key** – Press to open the Home screen. Press and hold to open recently used applications.
- 3 **Menu key** – Press to open the menu for the current screen or application.
- 4 **Mode key** – Press and hold to open the mouse mode menu.
- 5 **Back key** – Press to open previous screen or closes onscreen keyboard.

## Turn the Projector On

Press the power button momentarily. Note that the projector might take some time to fully power on.

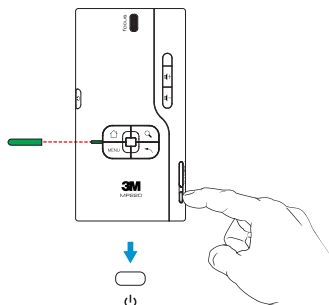

## Turn the Projector Off

- 1 Press and hold the power button until the **Device options** menu appears on the screen.
- 2 Select **Power off** from the menu.
- 3 Confirm that you wish to turn the projector off by selecting **OK**.

## Turn the Lamp Off

To turn the projector lamp off, press and quickly release the power button.

To turn the lamp back on, press any button.

*Note: When only the lamp is off, the projector continues to use a small amount of power. Do not place projector into a bag in this state as it can easily be turned back on.*

## Using the Touch Sensor

The touch sensor detects the movement of your finger and moves the cursor on the screen accordingly. Depending on how you like to navigate, the touch sensor can be used in one of two modes, as follows:

- **Trackball mode** - Jumps from one menu item to the next in a similar way to most mobile phone menus.
- **Mouse mode** - Moves the cursor around the screen just like on a computer.

No matter which mode is being used, clicking the touch sensor will select the highlighted option (or the option under the cursor), just like left-clicking on a standard computer mouse.

### Switching Between Touch Sensor Modes

To switch between touch sensor modes, press and hold the Search key until the **Touch sensor mode switch** message appears. Click **OK** to confirm that you want to switch modes.

*Note that on some screens one mode may be better than the other in order to easily select all available options.*

## Initial Setup

The first time you switch on your MP220, you will need to set up your language and the time & date.



## Setting your Language

- 1 Click **Locale**.
- 2 Choose your language. If your language does not appear on the screen, you may have to scroll down.

## Setting the Date & Time

To set the date and time, click **Date & Time**.

### Setting the time

- 1 Click on **Set time**.
- 2 Click on the + or - to change the hours and minutes.
- 3 To change from AM to PM, click on **AM**.
- 4 Once finished, click **Set**.

*Note: Clicking and holding + or - will cycle through the hours or minutes.*

### Setting the date

- 1 Click on **Set date**.
- 2 Click on the + or - to change the month, day and year.
- 3 Once finished, click **Set**.

*Note: Clicking and holding + or - will cycle through the days, months or years.*

To return to the Home screen, press the Home key on the navigation panel.

## Install Optional microSD Card

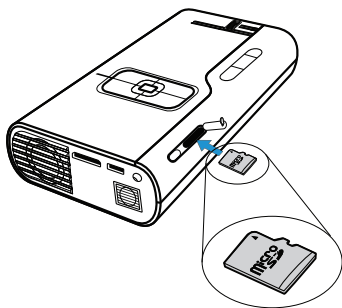

To insert or remove the microSD card, press it in until it clicks.

*Note: Before you remove the microSD from the projector, you should unmount it first, as follows:*

- 1 From the Home screen click on the applications icon  at the bottom of the screen.
- 2 Click on the Settings icon.
- 3 Select SD card & local storage.
- 4 Select Unmount SD card.

## Transfer files to the projector

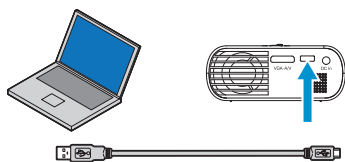

*Note: The USB cable is for the transfer of data only and cannot be used to project an image directly from your computer.*

### USB cable

Type of devices that may transfer data to projector:

- Computers
- Netbooks
- Tablets

### Connector on device and projector

- Computer: USB Type A connector
- Projector: Micro USB Type AB connector

## Access Files on the projector from your computer

- 1 Turn on the projector and make sure the Home screen is displayed on the touch screen.
- 2 Connect the USB cable to the projector.
- 3 Connect the USB cable to the computer.

- 4 Notification appears that USB is connected.
- 5 Click **Turn on USB storage**.
- 6 The projector and the microSD will be detected as a removable drive by the computer. The drive labeled "Internal" is the projector's on-board memory, and "Removable Disk" is the microSD card in the projector SD card slot.
- 7 Now you are ready to access files on the projector from your computer in the computer's file browser.

### Before disconnecting the projector from the computer's USB port

You must properly eject the removable drives on your computer or you may lose data.

Eject both removable drives on your computer operating system, as follows:

**Eject a drive on computers running Microsoft Windows:** Open Windows Explorer, right-click the drive, and click Eject from the context menu.

**Eject a drive on a computer running Apple Mac OS 10:** Open finder, choose the drive, and then choose File>Eject

## Viewing Photos

The MP220 can display photos from internal memory or from a microSD card.

To view photos, follow the steps below:

- 1 From the Home screen, click on the Apps icon  at the bottom of the screen.
- 2 Select the Gallery icon.
- 3 Select the album you would like to view.
- 4 Select the image you would like to see.
- 5 Use the displayed controls to navigate your photos.



**Single view** - Press to display an image in the selected album in actual size.



**Play Slideshow** - Press to start slideshow.



**Zoom in** - Press to zoom in on the current image. This button may be pressed several times to increase zoom.



**Zoom out** - Press to zoom out of the current image.



**Original size** - When in zoom mode, press to return image to original size.



**Fullscreen** - Press to stretch the current image to fill the screen.

## Listening to Music

The MP220 can play music from internal memory or from a microSD card.

To listen to music, follow the steps below:

- 1 From the Home screen, click on the Media tab.
- 2 Select the Music icon.
- 3 Select the artist, album, song or playlist you would like to listen to, or select **Now playing** to hear the track currently being played.
- 4 Use the displayed controls to control your music.



**Playlist** - Press to show a list of tracks in the current playlist.



**Random mode** - Press to switch between random or sequential track order.



**Repeat mode** - Press to turn repeat mode on or off.



**Skip back** - Press to skip to previous track. Press and hold to rewind within the current track.



**Play/pause** - Press to play or pause the current track.



**Skip forward** - Press to skip to next track. Press and hold to fast forward within the current track.

## Watching Videos

The MP220 can play videos from internal memory or from a microSD card.

To play a video, follow the steps below:

- 1 From the Home screen, click on the Apps icon  at the bottom of the screen.
- 2 Select the Video Player icon.
- 3 Select the video you would like to play.
- 4 Use the displayed controls to control your video.

*Note: If no controls are visible, click on the screen to make them appear.*



**Rewind** - Press and hold to rewind within the current track.



**Play/pause** - Press to play or pause the current track.



**Fast forward** - Press and hold to fast forward within the current track.

## Documents To Go®

The MP220 comes with Documents To Go software. With this software, you can open and view many different office and pdf files from internal memory or from a microSD card.

To open an office or pdf file, follow the steps below:

- 1 From the Home screen, click on the Apps icon  at the bottom of the screen.
- 2 Select the Documents To Go icon.
- 3 Select **Local Files**.
- 4 Browse to the location of the file you wish to open.

Use the optical mouse in Trackball mode to navigate documents as follows:

- Swipe up/down to scroll up/down.
- Swipe left/right to either scroll left/right, or to move between pages, depending on the type of document being viewed.

## File Compatibility

For detailed information about file compatibility, please go to <http://www.3mpocketprojector.com/support>.

## Replacement Accessories

Call 1-866-631-1656 to order 3M accessories.

Description	3M Part Number	Consumer UPC
Power Adapter with US, EU, UK, AUS plugs	78-6972-0033-1	0 51125 63407 6
Lithium-Ion Battery	78-6972-0053-9	0 51125 63447 2

## Optional Accessories

Description	3M Part Number	Consumer UPC
AV Video Cable	78-6972-0031-5	0 51125 63405 2
VGA Cable	78-6972-0030-7	0 51125 63404 5
Component AV cable	78-6972-0032-3	0 51125 63406 9
3M Adapter Cable for Apple®	78-6972-0034-9	0 51125 63408 3
Remote Control	78-6972-0074-5	0 51125 63482 3

3M is a trademark of 3M Company. All other trade names referenced are the service marks, trademarks or registered trademarks of their respective companies.



**Mobile Interactive Solutions  
3M Austin Center**

6801 River Place Blvd.  
Austin, TX 78726-9000  
866-631-1656  
[www.3MPocketProjector.com](http://www.3MPocketProjector.com)  
[meetings@mmm.com](mailto:meetings@mmm.com)



78-6971-1589-3

Please Recycle. Printed in China.  
© 3M 2011. All Rights Reserved.  
78-6971-1589-3-B-1