



# USER'S GUIDE

V:1047-0103-12



## ITP152 Tower Soundbar

---

For the most up-to-date version of this User's Guide, go to **[www.ilive.net](http://www.ilive.net)**

# Warnings and Precautions

- **CAUTION:** TO PREVENT ELECTRIC SHOCK, MATCH WIDE BLADE OF PLUG TO WIDE SLOT, FULLY INSERT.
- **WARNING:** To reduce the risk of fire or electric shock, do not expose this apparatus to rain or moisture.
- **AVERTISSEMENT:** Pour réduire le risque d'incendie ou de choc électrique, ne pas exposer cet appareil sous la pluie et l'humidité.
- **CAUTION:** Use of any controls or adjustments or performance of procedures other than those herein specified may result in hazardous radiation exposure.
- **WARNING:** Changes or modifications to this unit not expressly approved by the party responsible for compliance could void the user's authority to operate the equipment.
- **WARNING:** Do not place the unit on top of any soft, porous, or sensitive surfaces to avoid damaging the surface. Use a protective barrier between the unit and surface to protect the surface.
- **WARNING:** Use of this unit near fluorescent lighting may cause interference regarding use of the remote. If the unit is displaying erratic behavior move away from any fluorescent lighting, as it may be the cause.
- **CAUTION:** Danger of explosion if battery is incorrectly replaced. Replace only with the same or equivalent type.
- **PRÉCAUTION:** *Danger d'explosion si les piles sont remplacées de façon incorrect. Remplacer les piles seulement par le même type de pile ou l'équivalent.*

- **WARNING:** The battery, batteries, and battery pack shall not be exposed to excessive heat such as sunshine, fire, or the like.
- **WARNING:** Shock hazard - Do Not Open.
- **AVIS:** *RISQUE DE CHOC ÉLECTRIQUE - NE PAS OUVRI*

Mains Plug or Direct plug-in adapter is used as disconnect device and it should remain readily operable during intended use. In order to disconnect the apparatus from the mains completely, the Mains Plug or Direct plug-in adapter should be disconnected from the mains socket outlet completely.

*La fiche d'alimentation ou adaptateur de courant est utilisé comme dispositif de déconnexion et doit rester accessible pendant l'utilisation. Pour mettre l'appareil hors tension, la fiche ou adaptateur de courant doit être débranché de la prise de courant.*

Do not mix old and new batteries.  
Do not mix alkaline, standard (carbon-zinc), or rechargeable (ni-cad, ni-mh, etc) batteries.  
*No mezcle baterías viejas y nuevas.  
No mezcle baterías alcalinas, estándar (carbono-zinc) o recargables (ni-cad, ni-mh, etc.).*



**WARNING:** TO REDUCE THE RISK OF ELECTRIC SHOCK, DO NOT REMOVE COVER (OR BACK). NO USER-SERVICEABLE PARTS INSIDE. REFER SERVICING TO QUALIFIED SERVICE PERSONNEL.



The lightning flash with arrowhead symbol, within an equilateral triangle, is intended to alert the user to the presence of uninsulated "dangerous voltage" within the product's enclosure that may be of sufficient magnitude to constitute a risk of electric shock to persons.



The exclamation point within an equilateral triangle is intended to alert the user to the presence of important operating and maintenance (servicing) instructions in the literature accompanying the appliance.

# Important Safety Instructions

1. Read these Instructions.
  2. Keep these Instructions.
  3. Heed all Warnings.
  4. Follow all instructions.
  5. Do not use this apparatus near water.
  6. Clean only with a dry cloth.
  7. Do not block any ventilation openings. Install in accordance with the manufacturer's instructions.
  8. Do not install near any heat sources such as radiators, heat registers, stoves, or other apparatus (including amplifiers) that produce heat.
  9. Do not defeat the safety purpose of the polarized or grounding - type plug. A polarized plug has two blades with one wider than the other. A grounding type plug has two blades and a third grounding prong. The wide blade or the third prong are provided for your safety. When the provided plug does not fit into your outlet, consult an electrician for replacement of the obsolete outlet.
  10. Protect the power cord from being walked on or pinched particularly at plugs, convenience receptacles, and the point where they exit from the apparatus.
  11. Only use attachments/accessories specified by the manufacturer.
- 
12.  Use only with a cart, stand, tripod, bracket, or table specified by the manufacturer, or sold with the apparatus. When a cart is used, use caution when moving the cart/apparatus combination to avoid injury from tip-over.
- 
13. Unplug this apparatus during lightning storms or when unused for long periods of time.
  14. Refer all servicing to qualified service personnel. Servicing is required when the apparatus has been damaged in any way, such as power-supply cord or plug is damaged, liquid has been spilled or objects have fallen into the apparatus, the apparatus has been exposed to rain or moisture, does not operate normally, or has been dropped.
- 

**Special note:** When placing your unit on a lacquered or natural finish, protect your furniture with a cloth or other protective material.

## FCC Warnings

**WARNING:** Changes or modifications to this unit not expressly approved by the party responsible for compliance could void the user's authority to operate the equipment.

**NOTE:** This equipment has been tested and found to comply with the limits for a Class B digital device, pursuant to Part 15 of the FCC Rules. These limits are designed to provide reasonable protection against harmful interference in a residential installation. This equipment generates, uses, and can radiate radio frequency energy and, if not installed and used in accordance with the instructions, may cause harmful interference to radio communications. However, there is no guarantee that interference will not occur in a particular installation. If this equipment does cause harmful interference to radio or television reception, which can be determined by turning the equipment off and on, the user is encouraged to try to correct the interference by one or more of the following measures:

- Reorient or relocate the receiving antenna.
- Increase the separation between the equipment and receiver.
- Connect the equipment into an outlet on a circuit different from that to which the receiver is connected.
- Consult the dealer or an experienced radio/TV technician for help.

## Additional Warnings

- The apparatus shall not be exposed to dripping or splashing and that no objects filled with liquids, such as vases, shall be placed on apparatus.  
*L'appareil ne doit pas être exposé aux écoulements ou aux éclaboussures et aucun objet ne contenant de liquide, tel qu'un vase, ne doit être placé sur l'objet.*
- Battery shall not be exposed to excessive heat such as sunshine, fire or the like.  
*Les piles ne doivent pas être exposées à de forte chaleur, tel qu'à la lumière du soleil, au feu ou autres choses de semblable.*
- Caution marking is located at the rear or bottom of the apparatus.  
*Attention marquage est situé sur le panneau arrière ou inférieur de l'unité.*
- The marking information is located at the rear or bottom of apparatus.  
*Le marquage est situé sur le panneau arrière ou inférieur de l'unité.*



This symbol indicates that this product incorporates double insulation between hazardous mains voltage and user accessible parts.

## Tower Soundbar

### Features

- Made for iPod and iPhone
- Plays and charges docked iPod and iPhone
- 2.1 channel stereo sound
- FM Radio (PLL)
- Station memory presets (20 FM)
- Last station memory
- Direct access to FM stations
- Built-in FM wire antenna
- iPod and iPhone controls
- Universal Dock for iPod and iPhone: supports universal dock adapters
- iPod and iPhone authentication IC
- Component video output
- Subwoofer output
- RCA stereo audio inputs
- 3.5mm audio input
- Bass controls
- Digital volume control
- Built-in stereo speakers
- Built-in subwoofer
- Full-function remote
- Cloth speaker grill
- Negative LCD display with white backlight
- Digital clock
- AC power: built-in AC power cable

### Included

- Remote control: requires 2 AAA batteries (included)
- 5 dock adapters for iPod and iPhone

## Table of Contents

<b>Tower Soundbar</b> .....	4
Features	
Included	
<b>Table of Contents</b> .....	5
<b>Introduction</b> .....	6
<b>Setup</b> .....	8
Power	
Remote	
<b>Clock &amp; Radio</b> .....	9
Setting the Clock	
Auto Time Sync	
Tuning the FM Radio	
Saving a Radio Station as a Preset	
Tuning to a Saved Preset Station	
<b>iPod/iPhone and Line in</b> .....	10
Docking an iPod or iPhone	
Playing an iPod or iPhone	
Using the 3.5mm Audio Input (Line)	
Auto Time Sync	
<b>Audio Input, Subwoofer Output &amp; Video Output</b> .....	11
Using the Audio Input	
Using the Subwoofer Output	
Using the Component Video Output	
<b>Company Information</b> .....	12
International Support	
Contact Information	
Green Initiative	

## Introduction

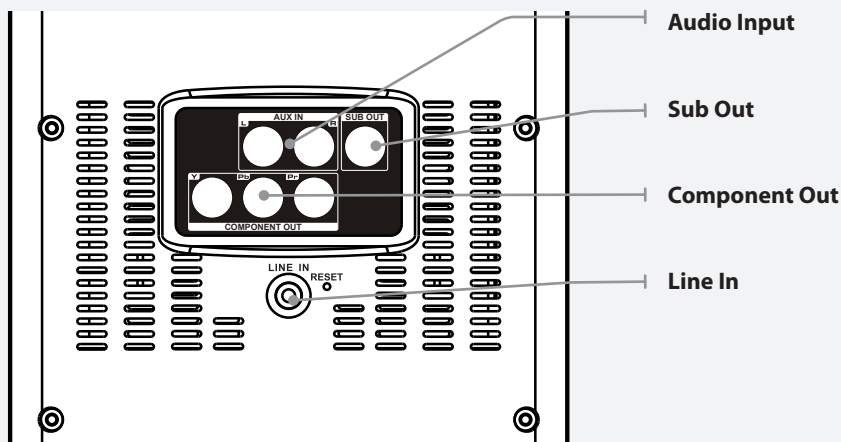
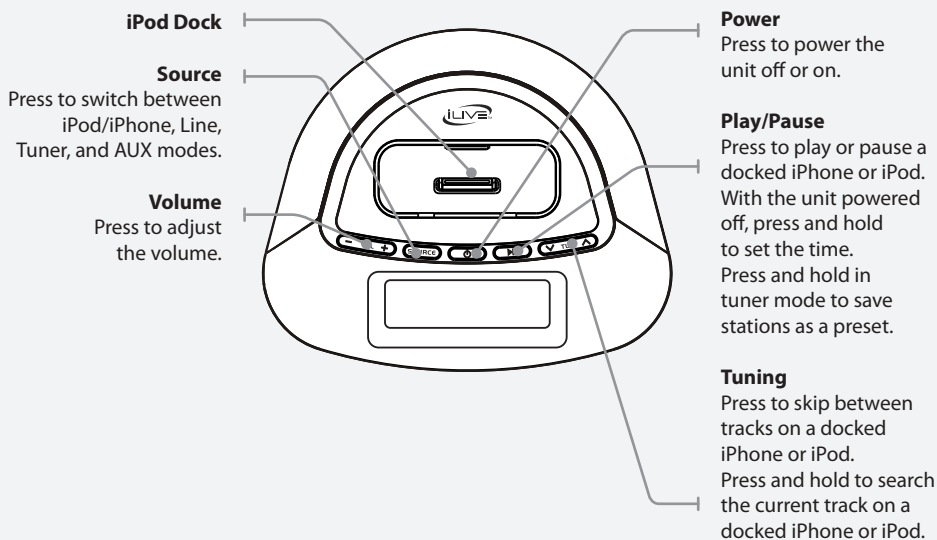

**Mute**  
Press to mute the volume.

**Power**  
Press to power the unit off or on.

**Number Keypad**

**Clock Sync**  
Press and hold to sync the clock with the docked iPod or iPhone.

**Playlist**  
Press to cycle through playlists on a docked iPhone or iPod.

**Album**  
Press to cycle through albums on a docked iPhone or iPod.

**Treble**  
Press to adjust the treble.

**Sleep**  
Press repeatedly to set the sleep timer.

**iPod (+/-) / Tun (+/-)**  
Press to tune the FM radio.  
Press to skip between tracks on a docked iPhone or iPod.  
Press and hold to search the current track on a docked iPhone or iPod.

**Chapter**  
Press to cycle through chapters on a docked iPhone or iPod.

**Source**  
Press to switch between iPod/iPhone, Line, Tuner, and AUX modes.

**Dimmer**  
Press to adjust the brightness of the display.

**Repeat/ST**  
Press to repeat the current track, or album.  
Press to switch between FM Mono and FM ST. when in Tuner mode.

**Menu**  
Press to cycle through the menus on a docked iPhone or iPod.

**Bass**  
Press to adjust the bass.

**Clockview/Shuffle**  
Press & hold to play songs from a docked iPhone or iPod in a random order.  
Press to view the time in playback mode.

**Select**  
Press to make selections on a docked iPhone or iPod.

**iPod Menu (▲▼)**  
Press to navigate up and down the menus on a docked iPhone or iPod.

**Volume**  
Press to adjust the volume.

**Time Set/Mem/Play/Pause**  
Press to play or pause a docked iPhone or iPod.  
With the unit powered off, press and hold to set the time.  
Press in Tuner mode to save stations as presets.

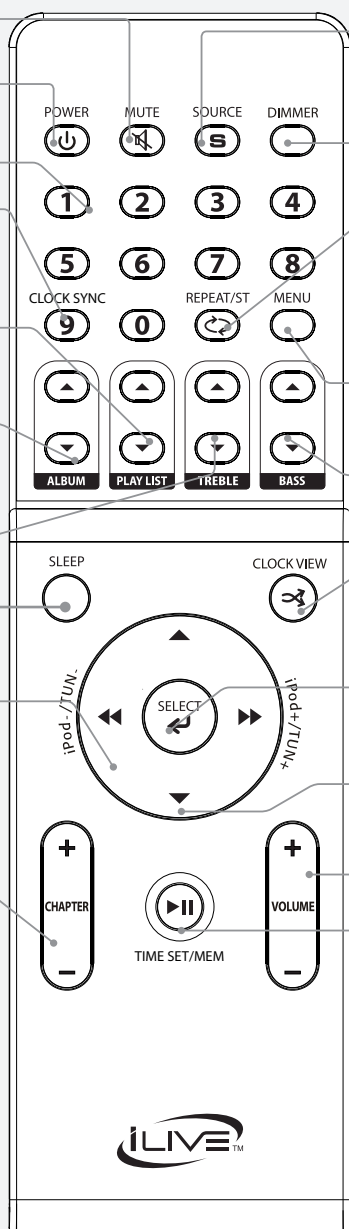

## Setup

### Power

AC power: built in AC power cord.

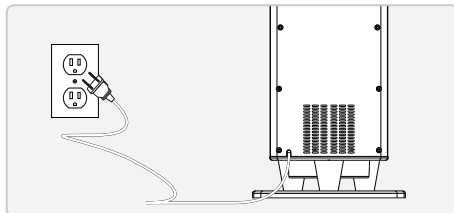

### Remote

Requires 2 AAA batteries (not included)

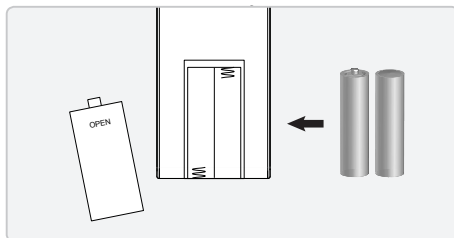

## Clock & Radio

### Setting the Clock

1. Press the **Power** button to turn the tower speaker off.
2. Press and hold the **Time Set** button on the remote or the **Play/Pause** button on the unit for 3 seconds.
3. Press the **Tuning** buttons to adjust the hour.
4. Press the **Time Set** button on the remote or the **Play/Pause** button on the unit.

*The hour on the DISPLAY will begin blinking.*

5. Press the **Tuning** buttons to adjust the minute.
6. Press the **Time Set** button on the remote or the **Play/Pause** button on the unit to finish setting the time.

*The minute on the DISPLAY will begin blinking.*

### Auto Time Sync

1. Follow the instructions for Docking an iPod or iPhone.
2. The clock will automatically set to the time of the docked iPhone.

*Auto time sync will not work with all iPods.*

### Tuning the FM Radio

1. Press the **Power** button to turn the tower speaker on.
2. Press the **Source** button to switch to Tuner mode.
3. "Tuner" will appear on the display.
4. Press the **Tuning** buttons to adjust the FM radio station.

### Saving a Radio Station as a Preset

1. Follow the instructions for Tuning the FM Radio.
2. Press and hold the **Time Set/Mem** button on the remote or the **Play/Pause** button on the unit.
3. Press the **Tuning** buttons to select a preset (P01-P20).
4. Press the **Time Set/Mem** button on the remote or the **Play/Pause** button on the unit to save the current station to the selected preset.

### Tuning to a Saved Preset Station

1. In Tuner mode, press the **Time Set/Mem** button on the remote or the **Play/Pause** button on the unit repeatedly to cycle through saved presets.

## iPod/iPhone and Line in

### Docking an iPod or iPhone

1. Connect the iPod or iPhone to the **iPod Dock**.
2. When the speaker is plugged in and using AC power, the docked iPod or iPhone will charge.

### Playing an iPod or iPhone

1. Follow the instructions for Docking an iPod or iPhone.
2. Press the **Source** button on the remote or the unit to switch to iPod/iPhone mode.
3. Press the **Play/Pause** button on the docked iPod or iPhone to begin playing the docked iPod or iPhone.

### Using the 3.5mm Audio Input (Line)

*Requires a 3.5mm audio cable (not included)*

1. Use a 3.5mm audio cable to connect an MP3 player or other audio source to the **Line Input** on the tower speaker.
2. Press the **Power** button to power the tower speaker on.
3. Press the **Source** button to switch the tower speaker to Line mode.
4. "Line" will appear on the display.
5. Audio played through the connected MP3 player or other audio source will now play through the tower speaker.

## Audio Input, Subwoofer Output & Video Output

### Using the Audio Input

1. Requires an RCA audio cable (not included)
2. Use an RCA audio cable to connect an MP3 player or other audio source to the **Audio Input** on the tower speaker.
3. Press the **Power** button to power the tower speaker on.
4. Press the **Source** button to switch the tower speaker to AUX mode.
5. "AUX " will appear on the display.
6. Audio played through the connected MP3 player or other audio source will now play through the tower speaker.

### Using the Subwoofer Output

*Requires an RCA audio cable (not included)*

1. Use an RCA cable (not included) to connect an external subwoofer to the **Subwoofer Output**.
2. When audio is played through any source, the bar speaker will automatically use the connected subwoofer.

### Using the Component Video Output

*Requires a component video cable (not included).*

1. Connect a component video cable (not included) to the **Component Video Output** and a television.
2. Adjust the connected television to the correct input setting.
3. Press the **Source** button on the remote to switch to iPod/iPhone Mode.
4. Video played through the docked iPhone or iPod will now play on the connected television.

## Company Information

### International Support

To download this User's Guide in English, Spanish, or French, or to get answers to frequently asked questions, visit the support section at [www.ilive.net](http://www.ilive.net).

Para descargar este Manual del Usuario en inglés, español y francés, o para obtener respuestas a preguntas frecuentes, visite la sección de apoyo en [www.ilive.net](http://www.ilive.net).

Pour télécharger ce guide de l'utilisateur en anglais, espagnol ou français, ou pour obtenir des réponses à des questions fréquemment posées, consultez la rubrique d'assistance sur [www.ilive.net](http://www.ilive.net).

### Contact Information

**Phone:** 1-888-999-4215

**Email:** [customerservice@ilive.net](mailto:customerservice@ilive.net)

**Parts Email:** [partsinfo@dpi-global.com](mailto:partsinfo@dpi-global.com)

**Website:** [www.ilive.net](http://www.ilive.net)

### Green Initiative



Environmental Commitment to 'Protect for Today and Sustain for Tomorrow' On a continual basis DPI, Inc. is making efforts to sustain the environment and improve the recyclability of its products and packaging.

Focusing on "protecting for today and sustaining for tomorrow" DPI, Inc. has committed to reducing packaging size, increasing the usage of recyclable plastics, and ensuring that packaging and manuals are made with up to 85% recycled material. In addition to material consideration, DPI, Inc. has also focused on the finer details that positively impact the environment such as employing the usage of soy-based inks.

DPI, Inc. also ensures that the factories that produce the company's wide variety of consumer electronics adhere to environmentally friendly air and water restrictions. This is yet another example that every step of the way DPI, Inc. is making efforts to lessen any impact on the environment.

In 2011 DPI, Inc. also began conversations with Energy Star in order to ensure that the consumer electronics being produced meet high standards of energy efficiency. The ultimate goal is keeping energy costs for consumers low while providing quality, feature-rich products.