

## Component Checklist

## Tools Required:

Phillips head screwdriver  
Wire cutters  
Power drill  
6mm (1/4") drill bit  
6mm (1/4") masonry drill bit  
Claw hammer  
Jigsaw/Hole cutter  
Spirit level

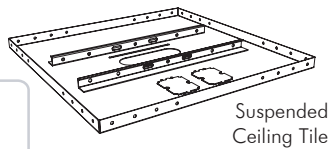

Suspended Ceiling Tile

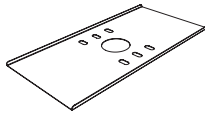

Cover Plate



1.5" NPT Mounting Collar

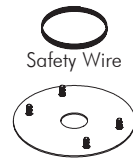

Pole Lower Mounting Plate

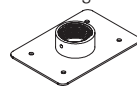

1.5" NPT Upper Mounting Plate



Pole Upper Mounting Plate



1.5" NPT Lower Mounting Plate

## Hardware

M6 Washer (x8)

Safety Clamp (x2)  
Lag Eye Bolt (x4)

Concrete Anchor Bolt (x4)



3mm Allen Key



M6 Wing Nut (x4)



Turnbuckle (x4)



M6 Set Screw (x2)



M6x16mm Screw (x4)

## IMPORTANT INFORMATION:

**! IMPORTANT - Install Telehook Projector - Suspended Ceiling Tile 24" as per Installation Instructions.**

- ! Compatible with 1.5" NPT Pole Mounts, Atdec Pole Mount (TH-WH-PJ-CM), Atdec Flush Mount (TH-WH-PJ-FM), Atdec ProAv Projector Ceiling Mount (TH-PF) and Atdec pole accessories (TH-PPA-18-25, TH-PPA-24-48 & TH-PPE-24).
- ! Maximum weight capacity 22.7kg (50lbs).
- ! The manufacturer accepts no responsibility for incorrect installation.

## Step 1. Check Components

Check you have received all parts against the Component Checklist and Hardware above.

## Step 2. Remove Existing Ceiling Tile

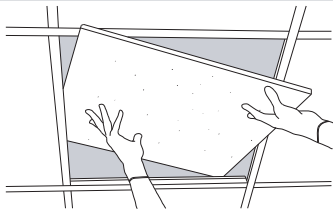

Remove existing ceiling tile from ceiling grid where the product is going to be installed.

**TIP:** Also temporarily remove an adjacent ceiling tile to allow easy access to the product during installation.

## Step 3. Fix Anchors to True Ceiling

Uncoil Support Wire and cut into 4 equal lengths. Select the anchoring method appropriate to your ceiling (see below).

**NOTE:** Each anchor point should be directly above each corner of the Suspended Ceiling Tile.

## Wooden Joists

Drill 4x Ø6mm holes, at least 50mm deep (4x Ø1/4" holes, 2" deep).  
Fully screw Lag Eye bolts into wooden joists.

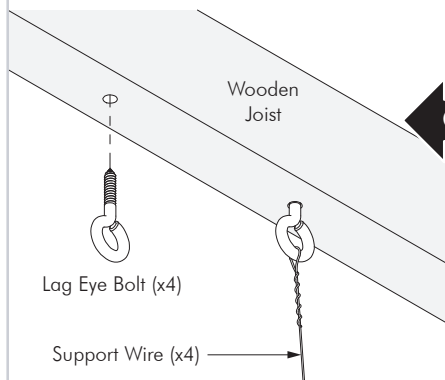

Thread one end of each support wires through a Lag Eye Bolt, and wrap 5 times to secure.

## Solid Concrete

Drill 4x Ø6mm holes, 36mm deep (4x Ø1/4" holes 1 1/2" deep).  
Tap anchors into hole to an embedded depth of at least 25mm deep (1" deep).  
Using a claw hammer, pull anchor out 6mm (1/4") to activate anchor.

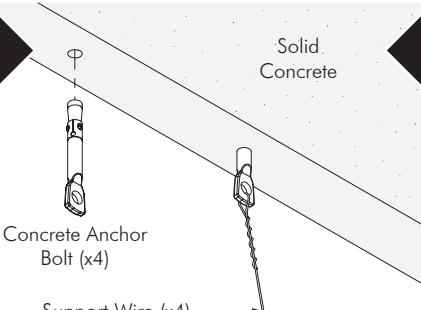

Thread one end of each support wires through a Lag Eye Bolt, and wrap 5 times to secure.

## Truss Beams

Thread one end of Support Wires through the trusses, and wrap 5 times to secure.

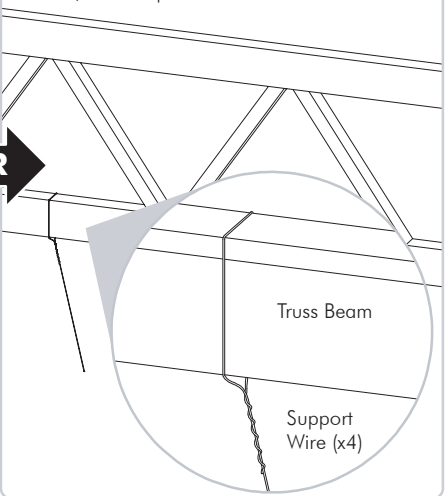

## Step 4. Attach Turnbuckles onto Support Wires

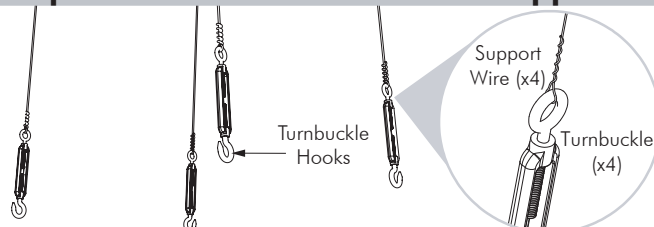

Loop each dangling Support Wire through a Turnbuckle, and wrap 5 times to secure.

Make sure that the position of the x4 Turnbuckles are approximately at the same height.

**TIP:** The turnbuckle hooks should be level with the top of ceiling grid.

## Step 5. Assemble Projector Mount Interface onto Suspended Ceiling Plate

### 1.5" NPT mount interfaces

(Included) (compatible with Atdec pole accessories & 1.5" NPT poles)

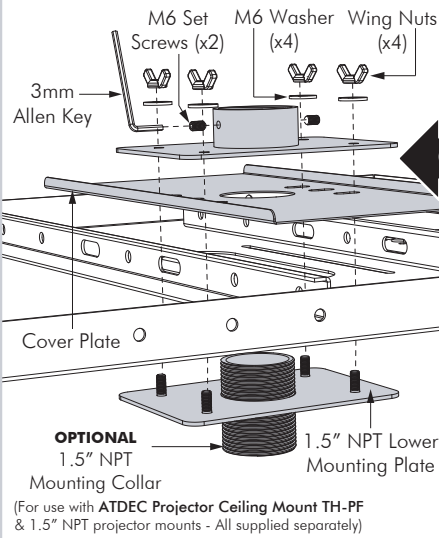

### Atdec Pole Mount

(TH-WH-PJ-CM supplied separately)

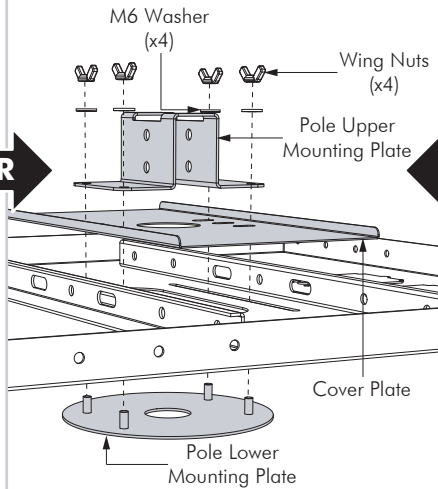

### Atdec Flush Mount

(TH-WH-PJ-FM supplied separately)

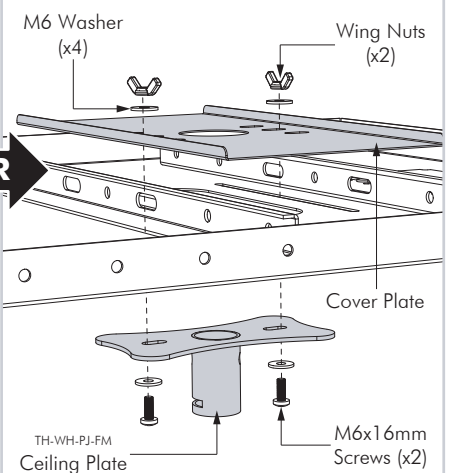

## Step 6. Hook Suspended Ceiling Tile

Hook Suspended Ceiling Tile to the Turnbuckles.  
Twist Turnbuckles for height adjustment.  
The Suspended Ceiling Tile should sit flush in ceiling grid.

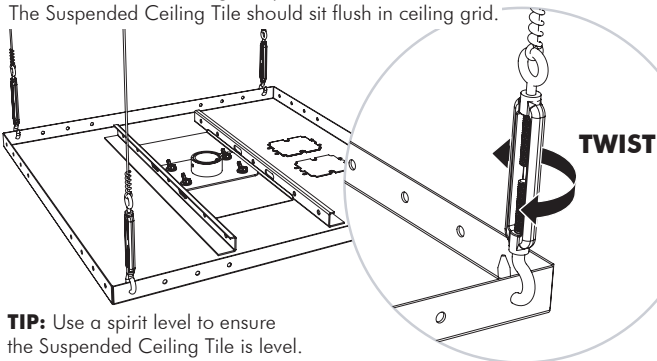

## Step 7. Fix Safety Wire

Thread one end of the Safety Wire through a Lag Eye Bolt, Concrete Anchor, or Truss and clamp using Safety Clamp.

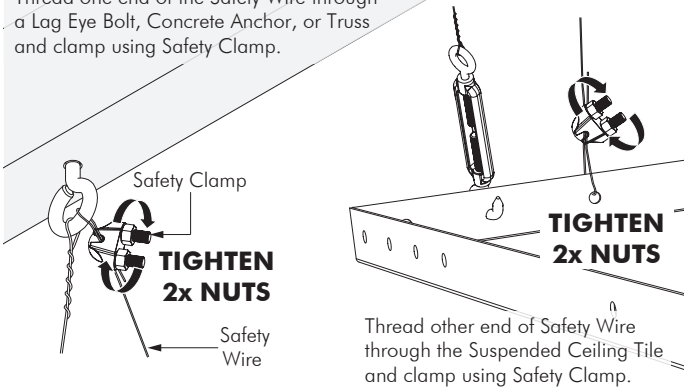

## Step 8. Install Projector Mount and Ceiling Cover

(choose Ceiling Cover to suit projector mount)

### Atdec Pole Accessories

(TH-PPA-18-25, TH-PPA-24-48 & TH-PPE-24 supplied separately)  
or 1.5" NPT Pole Mount (supplied separately)

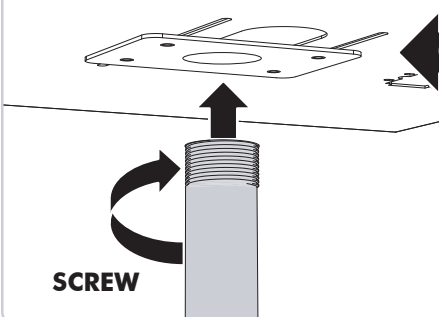

### Atdec Pole Mount

(TH-WH-PJ-CM supplied separately)

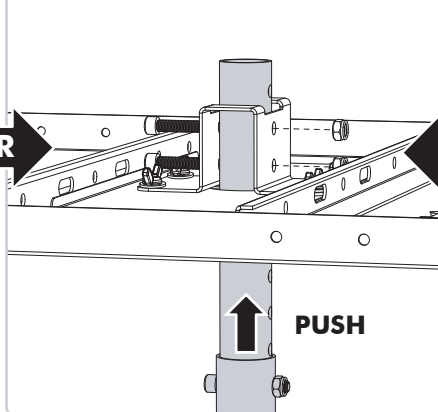

### Atdec Flush Mount

(TH-WH-PJ-FM supplied separately)

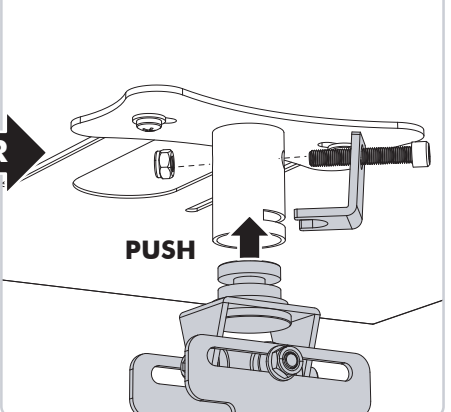

**Installation Complete** - Ready to install Projector

