



# Intimus 5B

5.25" 2-Way Bookshelf Speaker

## Owner's Guide



18151 SW Boones Ferry Road, Portland OR 97224 - 888.880.8992

### Features

- 1" Audiophile-grade silk-dome tweeter
- 5.25" Woven fiberglass composite woofer
- HD-X3™ Impedance leveling crossover technology
- Magnetic shielding
- Furniture-grade finish
- 5-Way gold-plated binding posts
- Anti-Resonant Cabinet
- Acoustically transparent grille

### Specifications

Frequency Response: (+/- 3dB) 75-20,000 Hz  
(+/- 6dB) 62-22,000 Hz

Nominal Impedance: 6 Ohms

Sensitivity: 84 dB

Recommended Power: 50 - 150 Watts

Driver Configuration: 2-Way

Enclosure: Ported, 1" HDF

Dimensions: 12" H x 6.75" W x 8" D

Weight: 14 lbs.

### Connections

To connect your speaker to your receiver you will need standard 2 conductor, stranded speaker wire. For instructions on installation, please read below.

### Preparing the Wire

- 1) Separate the last 4" of your speaker wire into two pieces.
- 2) Strip 1/2" off the shielding off of the end of each wire (see A below).
- 3) Twist the exposed copper strands with your fingers until they are tightly unified. Be sure there are no "flyaway" strands (see B below).

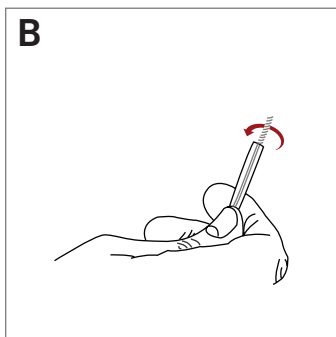
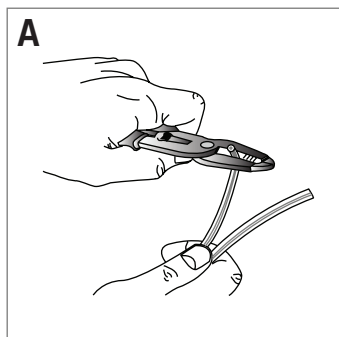

### If You're Using Bare Wire

- 1) Unscrew the binding posts on the back of your speaker by turning counter-clockwise.
- 2) Insert the bare speaker wire into the hole in the binding post and tighten it securely by turning clockwise.

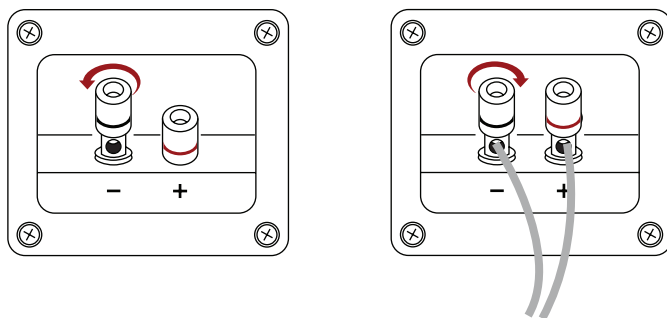

### If You're Using Banana Plugs

- 1) Be sure to follow the instructions on your banana plugs to attach them to the wire.
- 2) Screw the binding posts in completely by turning clockwise.
- 3) Insert them into the open end of the binding post.

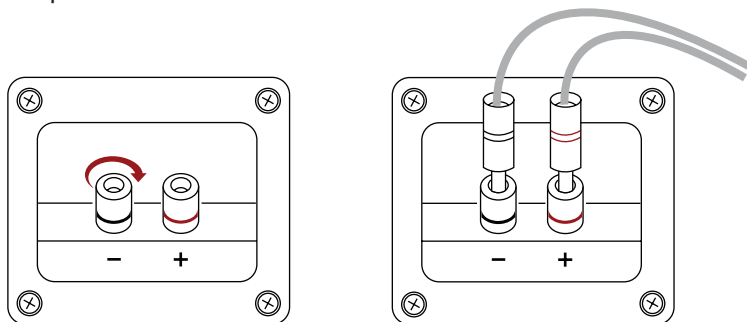

**Note:** As you make your connections, be sure to connect the positive terminals on your receiver to the positive terminals on your speakers. Most two conductor wire has screen printing on one side to help you differentiate between the two strands (see image below).

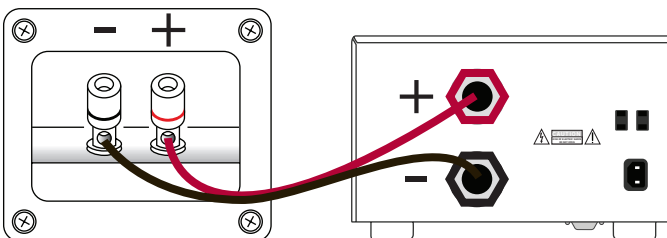

### Placement Recommendations

Each room is unique and unless the room was specifically designed to be a home theater, its acoustic properties will not be perfect. However, the following guidelines will help you get the most out of your speakers. Try to match the placement diagrams below as closely as you can. If you're using them as a surround speakers, they should be placed about two feet above the listeners' ears. Also, don't be afraid to experiment with placement. Often a small difference in placement can yield a big improvement in sound.

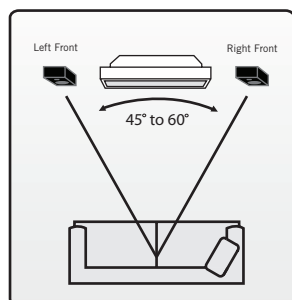

Ideal Stereo Placement

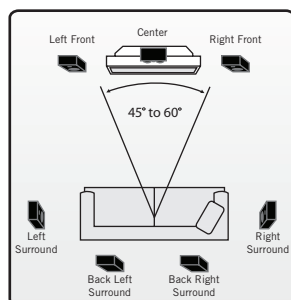

Ideal Home Theater Placement

### Setup

Setting up speakers through your multi-channel receiver only requires a few simple steps. You may have a receiver that has an auto calibration microphone, and while these are convenient, they are not always accurate. For best results, we recommend accessing the setup menu of your receiver and manually setting up the speakers. Most modern receivers use an On Screen Display setup menu (OSD) that makes setup a breeze.

1) In your receiver's setup menu, go to "Speaker Setup" or "Speaker Configuration". The setting for this speaker should be "Small" (See 1 below).

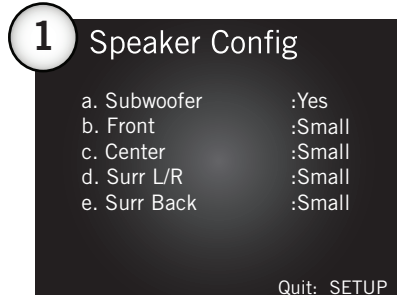

2) In the crossover menu, select a crossover point of 80Hz. If you'd like, you may set the crossover point anywhere from 80Hz - 100Hz to satisfy your listening tastes. (If your speakers are set to "Large" your receiver should automatically bypass the crossover.)

3) In the speaker distance menu, measure and input the distance between your primary listening position and your speakers (see 2 below).

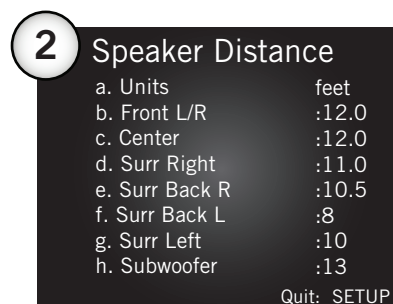

4) In the channel level menu you can set the volume level for each of the speakers in your system (see 3 below). The goal is to adjust each speaker to be the same loudness at your listening position. You can set this by ear, but we recommend using an SPL meter for best results. An SPL meter can be purchased on our website. [www.aperionaudio.com](http://www.aperionaudio.com).

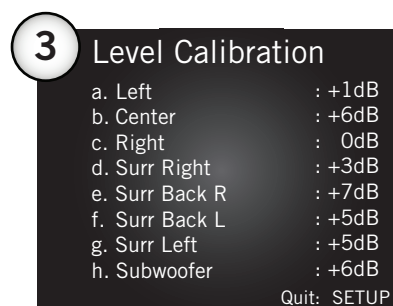

## Express Limited Warranty

Aperion Audio provides a **transferable ten (10) year limited warranty on our speakers**; a **transferable three (3) year limited warranty on our subwoofer amplifiers**; and a **non-transferable lifetime limited warranty on our cables**. No other warranty, implied or otherwise, is created or honored by Aperion Audio. These warranties cover all defects in material and workmanship with the following specific exceptions:

- Damage caused by improper installation or adjustment
- Damage caused by accident, unreasonable use, or neglect
- Damage caused by an act of God
- Damage from failure to follow instructions contained in the Owner's Manual
- Damage from repairs performed by someone not authorized by Aperion Audio
- Any unit on which the serial number has been effaced, modified, or removed
- Damage occurring during shipment, other than that arranged by Aperion Audio
- Units which have been altered or modified in design, appearance or construction

This warranty covers only the actual defects within the products themselves. IT DOES NOT cover costs of installation in (or removal from) a fixed installation, or normal set-up, claims based on any misrepresentation by the seller, or performance variations resulting from installation related circumstances such as signal quality, AC power or incompatibilities with other system components.

During the warranty period, Aperion Audio will, at its option, either repair the defect, or replace the defective product, or the defective parts, or components thereof with the then current product/component in use by Aperion Audio, at no charge to the owner for parts and labor covered by this warranty. If necessary repairs are not covered by this warranty, or if a unit is examined which is not in need of repair, you will be charged for the repairs and/or the examination.

If non-warranted repairs are needed, we will notify you of the estimated cost and ask for your authorization to perform said repairs. You must pay shipping charges incurred in getting your product to Aperion Audio. We will pay the return shipping charges if the repairs are covered by the warranty. Please save the original shipping cartons, as the unit **MUST** be returned in the original carton and packing. (Replacement cartons are available at a modest charge.)

## Contact Us

If you have any questions, comments, or concerns, please don't hesitate to contact us.

[www.aperionaudio.com](http://www.aperionaudio.com)  
[customerservice@aperionaudio.com](mailto:customerservice@aperionaudio.com)  
[sales@aperionaudio.com](mailto:sales@aperionaudio.com)

Aperion Audio Forum:  
<http://www.aperionaudio.com/community/forums/>

Frequently Asked Questions (FAQ)  
<http://www.aperionaudio.com/catalog/Help,7.aspx>

Aperion University  
<http://www.aperionaudio.com/catalog/Aperion-University,2.aspx>

1.888.880.8992  
18151 SW Boones Ferry Road  
Portland, OR. 97224