



INSTALLATION INSTRUCTIONS FOR PART 95-5819

APPLICATIONS **FORD** **F-150 (XL Models Only) 2009**

95-5819

KIT FEATURES

- Double DIN Radio Provision
- Stacked ISO Mount Units Provision



KIT COMPONENTS

- A) Double DIN Radio Housing
- B) Double DIN Brackets

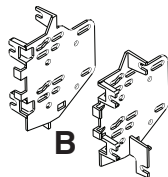
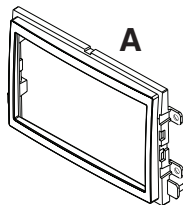

WIRING AND ANTENNA CONNECTIONS (Sold Separately)

Wire harness:

- 70-5520 Ford harness 2003-up

Antenna adapter:

- 40-CR10 Chrysler antenna adapter 2002-up

TOOLS REQUIRED:

- Cutting Tool
- Phillips Screwdriver
- Socket Wrench

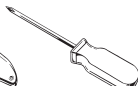

1-800-221-0932



www.metraonline.com

© COPYRIGHT 2009 METRA ELECTRONICS CORPORATION



95-5819

TABLE OF CONTENTS

Dash Disassembly

- FORD F-150 2009 (XL Models Only).....1

Kit Assembly

- Double DIN Radio Provision / Stacked ISO Mount Units Provision 2

Final Assembly3

***Note:**

Refer also to the instructions included with the aftermarket radio.



KNOWLEDGE IS POWER

Enhance your installation and fabrication skills by enrolling in the most recognized and respected mobile electronics school in our industry.

Log onto www.installerinstitute.com or call 800-354-6782 for more information and take steps toward a better tomorrow.

FORD F-150 (XL Models Only) 2009

- 1 Disconnect the negative battery terminal to prevent an accidental short circuit.
- 2 Unclip and remove the switch panel to the right of the cigarette lighter then remove the (1) 9/32" screw exposed. (Figure A)
- 3 Remove the rubber pad at the top of the radio trim panel then remove the (2) 9/32" screws exposed. (Figure B)
- 4 Unclip and pull the side panels containing the a/c vents away from the radio trim panel. ***Note: It is not necessary to remove the panels completely.*** (Figure C)
- 5 Unclip and remove the radio trim panel. (Figure D)
- 6 Remove (4) 9/32" screws to remove the factory radio.

Continue to kit assembly.

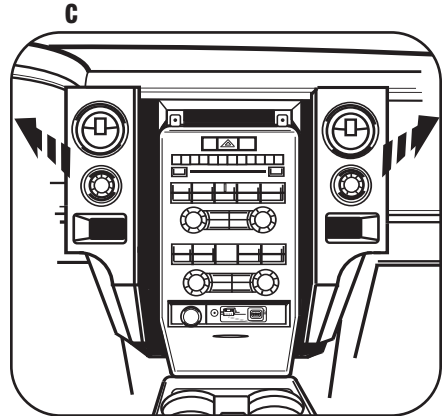
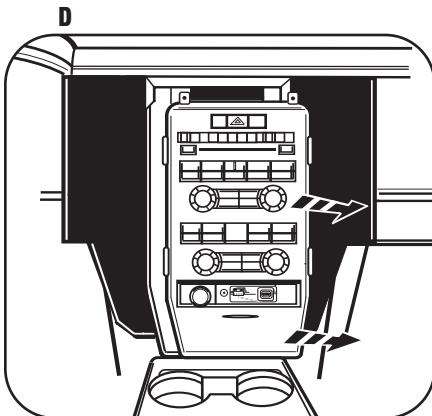
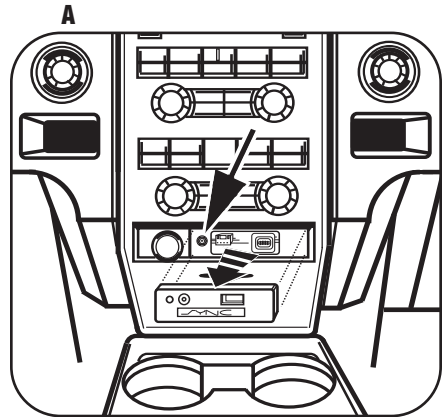

DOUBLE DIN RADIO PROVISION OR STACKED ISO MOUNT UNIT(S) PROVISION

****Note:** Refer also to the instructions included with the aftermarket radio.*

- 1 Slide the appropriate side bracket over the mounting legs of the Double DIN trim plate aligning the holes in the trim plate and the bracket and rotate inward.

Note: The notch in the housing should be on top. (Figure A)

- 2 Slide the Double DIN or stacked ISO mount units into the bracket/radio housing assembly and secure the Double DIN or stacked ISO mount units to the assembly using the screws supplied with the Double DIN or stacked ISO mount units. (Figure B)

- 3 Cut and remove half of the top (2) mounting legs with the brackets attached. (Figure C)

Continue to final assembly.

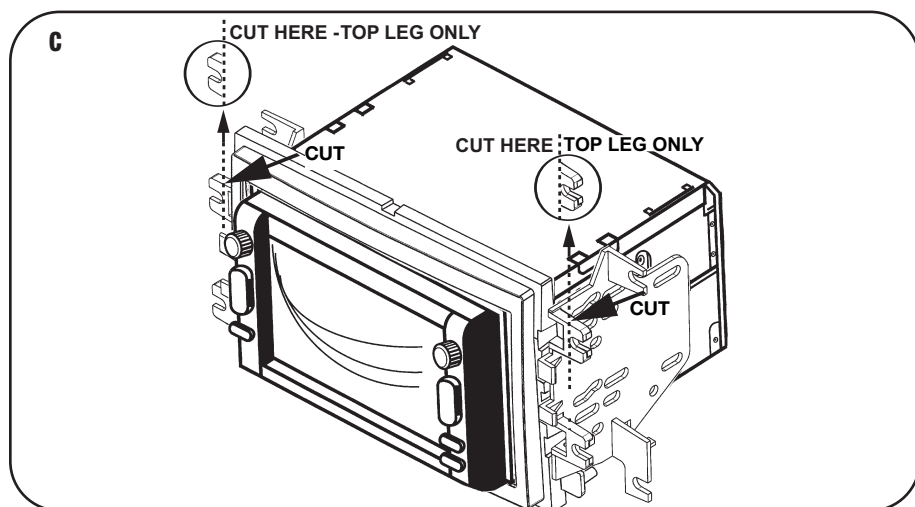
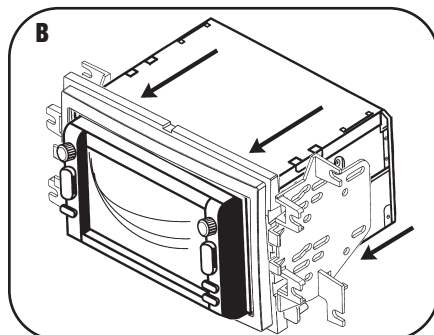
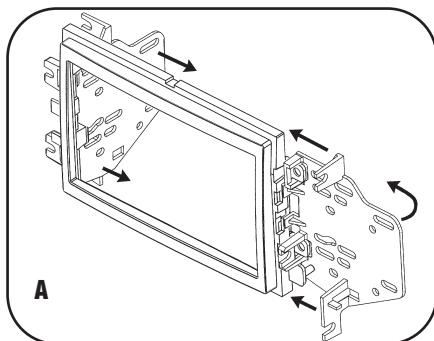

FINAL ASSEMBLY

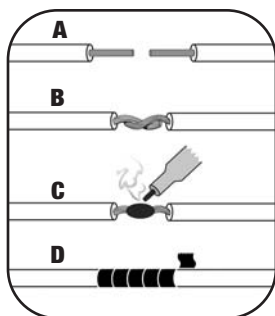

(A) Strip wire ends back 1/2"

B) Twist ends together

C) Solder

D) Tape

- 1** Locate the factory wiring harness in the dash. Metra recommends using the proper mating adapter and making the connections as shown. (Isolate and individually tape off the ends of any unused wires to prevent electrical short circuit).
- 2** Re-connect the negative battery terminal and test the unit for proper operation.
- 3** Position the factory bracket/aftermarket radio assembly into the dash and secure using the factory hardware.
- 4** Secure the Double DIN radio housing to the sub dash using the factory hardware.
- 5** Reassemble the rest of the dash in reverse order of disassembly.

FINAL WIRING CONNECTIONS

Make wiring connections using the EIA color code chart shown below and the instructions included with the head unit. Metra recommends making connections shown below; Strip, Splice, Solder, Tape. Isolate and individually tape off ends of any unused wires to prevent electrical short circuit.

METRA / EIA WIRING CODE

12V Ignition / Acc.	Red	Right Front (+)	Gray
12V Batt / Memory.	Yellow	Right Front (-).	Gray/ Black
Ground.	Black*	Left Front (+)	White
Power Antenna.	Blue	Left Front (-).	White / Black
Amp Turn-On	Blue / White	Right Rear (+)	Violet
Amp Ground.	Black / White	Right Rear (-)	Violet / Black
Illumination	Orange	Left Rear (+)	Green
Dimmer	Orange / White	Left Rear (-).	Green / Black

***NOTE: When a Black wire is not present, ground radio to vehicle chassis. All colors may not be present on all leads due to manufacturer's specifications.**



95-5819

NOTES

This image shows a single sheet of white paper with horizontal ruling lines. The lines are evenly spaced and run across the width of the page. There are no margins, text, or other markings on the paper.



NOTES

[illegible]

95-5819 INSTRUCTIONS



1-800-221-0932



www.metraonline.com

REV. 05/22/09 © COPYRIGHT 2009 METRA ELECTRONICS CORPORATION INST95-5819