



HP ZBook Studio 16 inch G10 Mobile Workstation PC Wolf Pro Security Edition (894F3UT)

Overview

Powerfully immersive. Perfectly sized

Be ready when inspiration strikes. Packed with professional performance in an incredibly sleek PC that comfortably fits in your bag, the ZBook Studio is engineered to get you in the zone and help you stay focused. Now you can build complex assemblies, render in real time or visualize data—from anywhere.

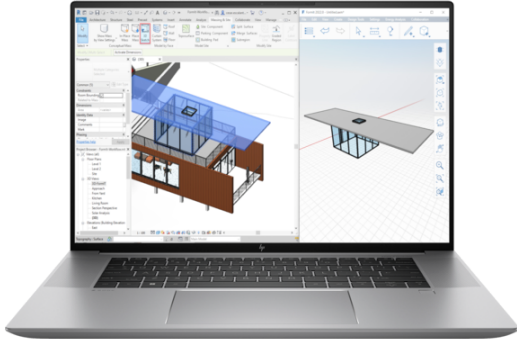

Pro-grade performance for your biggest projects

Push your 3D workflows further with an Intel® CPU,[1] integrated or discrete graphics[2] and upgraded memory.

See more of your content with less scrolling

Bring projects to life on a brilliant display and 16:10 aspect ratio so you can see more vertical content.

Create and collaborate on the go

Work effectively on a light laptop with a long-lasting battery and AI Noise Suppression software.[5]

A work laptop you'll want to game on

Enjoy fast, smooth gameplay with an NVIDIA RTX™ professional or GeForce RTX™ GPU.[2] Highlight favorite keys and create custom key maps with Z Light Space software[9] and a RGB keyboard with per-key LED backlighting. [8]

Features

Windows 11

Work anywhere without compromising on performance or security with Windows 11 powered by HP's collaboration and connectivity technology.

Intel® Core™ i9 processor

Get high-end performance for intensive tasks like rendering and video editing with the Intel® Core™ i9 processor.^[1]

HP Z Turbo Drive High-speed Storage

Work without limits in any location with local PCIe storage that's up to 6x faster than SATA SSD, and up to 21x faster than traditional HDD storage.^[3]

HP Fast Charge

Ultra-fast recharge takes you from zero to 50% charge in just 30 minutes.^[4]

Spill-resistant Keyboard

Accidents happen - which is why we designed our keyboard with a drain hole, so minor spills flow out the bottom for easy cleanup.

Industry-leading security features

Advanced security features come standard. System safeguards like HP Sure Start – the industry's first self-healing BIOS – mean your device is locked down tight, so your data and identity are too.

[1] Multicore is designed to improve performance of certain software products. Not all customers or software applications will necessarily benefit from use of this technology. Performance and clock frequency will vary depending on application workload and your hardware and software configurations. Intel's numbering, branding and/or naming is not a measurement of higher performance.

[2] Optional feature that must be configured at purchase.

[5] AI Noise Reduction is delivered automatically through Windows update or can be downloaded from <https://support.hp.com/us-en/drivers> when available. Requires Windows 10 or higher, compatible with internal PC speakers, microphone and analog headsets. The DNN Noise Reduction setting can be configured through the Application HP Audio Control.

[8] RGB keyboard is an optional, configurable feature. Available only in the US, UK, Germany and France only.

[3] For hard drives, GB = 1 billion bytes. TB = 1 trillion bytes. Actual formatted capacity is less. Up to 30GB (for Windows 10) of system disk is reserved for system recovery software.

[4] Recharges the battery up to 50% within 30 minutes when the system is off or in standby mode. Power adapter with a minimum capacity of 65 watts is required. After charging has reached 50% capacity, charging will return to normal. Charging time may vary +/-10% due to System tolerance.

Specifications

Operating system	Windows 11 Pro ^[1]
Processor family	13th Generation Intel® Core™ i9 processor
Processor	Intel® Core™ i9-13900H (up to 5.4 GHz with Intel® Turbo Boost Technology, 24 MB L3 cache, 14 cores, 20 threads)
Memory	64 GB DDR5-5600 MHz RAM (2 x 32 GB)
Memory Slots	2 SODIMM; supports dual channel
Internal Storage	2 TB PCIe® NVMe™ TLC SSD
Memory card device	1 microSD 7.1 media card reader
Graphics	Integrated
Graphics (integrated)	Intel® Iris® Xe Graphics
Display	40.6 cm (16") diagonal, WQUXGA (3840 x 2400), OLED, touch, UWVA, BrightView, micro-edge, 400 nits, 100% DCI-P3
Display	16" diagonal, WQUXGA (3840 x 2400), OLED, touch, UWVA, BrightView, micro-edge, 400 nits, 100% DCI-P3 ^[15,16,27,29]
Display size (diagonal)	40.6 cm (16")
Display size (diagonal)	16"
Audio	Audio by Bang & Olufsen, Quad-speaker audio (2 tweeters & 2 Quad woofers), 2 Top Facing Microphone dual array digital microphones, functions keys for volume up and down, combo microphone/headphone jack, HD audio with 200Hz Bass Roll off
Minimum dimensions (W x D x H)	35.6 x 24.2 x 1.9 cm (non-touch); 35.6 x 24.2 x 1.8 cm (touch)
Minimum dimensions (W x D x H)	14.02 x 9.54 x 0.76 in (non-touch); 14.02 x 9.54 x 0.72 in (touch)
Weight	Starting at 1.73 kg (Weight varies by configuration and components.)
Weight	Starting at 3.81 lb (Weight varies by configuration and components.)
Keyboard	HP RGB Z Command Keyboard – spill-resistant, full-size, backlit keyboard with drain and DuraKeys
Pointing device	ClickPad Glass with multi-touch gesture support, taps enabled as default
Camera	720p HD IR camera
Ports	1 power connector; 1 headphone/microphone combo; 2 Thunderbolt™ 4 with USB4™ Type-C® 40Gbps signaling rate (USB Power Delivery, DisplayPort™ 1.4, HP Sleep and Charge) ^[12]
Ports	1 Super Speed USB Type-A 5Gbps signaling rate (charging); 1 SuperSpeed USB Type-C® 10Gbps signaling rate (USB Power Delivery, DisplayPort™ 1.4)
Wireless	Intel® Wi-Fi 6E AX211 (2x2) and Bluetooth® 5.3 wireless card, vPro®
Power	200 W external AC power adapter ^[48]
Battery type	HP Long Life 6-cell, 86 Wh Li-ion polymer

Battery recharge time	Supports battery fast charge: approximately 50% in 30 minutes
Ecolabels	TCO Certified
Energy star certified	ENERGY STAR® certified
Management features	HP Power Manager ^[13]
Sustainable impact specifications	Low Halogen
Security management	Absolute persistence module; HP Credential Manager; HP Power On Authentication; Master Boot Record security; Pre-boot authentication; Windows Defender; HP Manageability Integration Kit; HP BIOSphere Gen6; HP Sure Start Gen6; HP Sure Admin; HP Image Assistant; Nano Security Lock Slot; HP Image Assistant Gen4.6; HP Client Security Manager Gen7; Trusted Platform Module TPM 2.0; HP Privacy Key ^[8,34,35,37,38,39,43,49]
Software included	Bing search for IE11; HP Hotkey Support; HP Noise Cancellation Software; HP Performance Advisor; HP Support Assistant; Native Miracast support; HP Connection Optimizer; myHP; HP Privacy Settings; Data Science Stack; HP Easy Clean; HP PC Hardware Diagnostics; Windows 10 Cloud Recovery Client; HP Z Light Space; HP Camera & Super Resolution Software; Microsoft 365 and Office (sold separately and Internet access required for activation); HP Presence ^[25,28,30,31,33,51,52]
UPC number	(ABA) 196188217627; (ABL) 196188217634

Additional specifications

Available software	HP Smart Support ^[19]
Battery brand	HP
Battery capacity	86
Battery capacity uom	Wh
Battery cells number	6
Battery life	Long Life
Battery type	Li-ion polymer
Bluetooth version	Bluetooth® 5.3
Camera Infrared	IR
Camera resolution (vertical)	720p
Camera resolution standard	HD
Color gamut	100% DCI-P3
Display	40.6 cm (16") diagonal WQUXGA touch display
Display	16" diagonal WQUXGA touch display
Display backlight	OLED
Display bezel	micro-edge
Display brightness	400
Display brightness uom	nits
Display panel technology	UWVA
Display resolution (pixels)	3840 x 2400
Display size (diagonal) uom	"
Display size (diagonal, imperial)	16
Display size (diagonal, metric)	40.6
Display size (diagonal, metric) uom	cm
Display surface treatment	BrightView
Display touchscreen type	touch screen
ECC memory	non-ECC
External I/O ports footnote number	[12]
Fingerprint reader	Fingerprint Sensor
Graphic card footnote number	[12,18,22,32]
Graphics	Discrete
Graphics (discrete)	NVIDIA RTX™ 4000 Ada Generation Laptop GPU (12 GB GDDR6 dedicated)

Graphics card brand	NVIDIA®
Graphics card memory size	12
Graphics card memory size uom	GB
Graphics card memory type	GDDR6
I/O Port location	Left side
I/O Port location	Right side
Keyboard backlight	backlit
Keyboard features	Spill-resistant
Keyboard protection	Durakeys
Keyboard size	Full-size
Legal tagline	HP recommends Windows 11 Pro for business
Memory and storage	64 GB memory; 2 TB SSD storage
Memory layout (slots & size)	2 x 32 GB
Memory module type	DIMM
Memory size	32
Memory size uom	GB
Memory speed	5600
Memory speed uom	MHz
Memory type	DDR5
Model Number	RTX™ 4000
Number of memory slots	2
Playbook TS icon OS	http://h10003.www1.hp.com/digmedialib/prodimg/lowres/c03905482.png
Playbook TS icon battery life	http://h10003.www1.hp.com/digmedialib/prodimg/lowres/c03905264.png
Playbook TS icon connectivity	http://h10003.www1.hp.com/digmedialib/prodimg/lowres/c08201987.png
Playbook TS icon dimensions NB	https://h10003.www1.hp.com/digmedialib/prodimg/lowres/c08250394.png
Playbook TS icon display NB	http://h10003.www1.hp.com/digmedialib/prodimg/lowres/c08205649.png
Playbook TS icon graphics	https://h10003.www1.hp.com/digmedialib/prodimg/lowres/c08169202.png
Playbook TS icon memory	https://h10003.www1.hp.com/digmedialib/prodimg/lowres/c08267700.png
Playbook TS icon processor	https://h10003.www1.hp.com/digmedialib/prodimg/lowres/c08201972.png
Playbook TS icon storage	http://h10003.www1.hp.com/digmedialib/prodimg/lowres/c08192819.png
Playbook TS icon weight imperial	http://h10003.www1.hp.com/digmedialib/prodimg/lowres/c05790117.png
Playbook TS icon weight metric	https://h10003.www1.hp.com/digmedialib/prodimg/lowres/c08267650.png
Processor Brand	Intel®
Processor cache	24 MB L3
Processor core	14

Processor family	Core™ i9
Processor frequency technology	Intel® Turbo Boost Technology
Processor generation	13th Generation
Processor maximum frequency	5.4
Processor maximum frequency uom	GHz
Processor model	13900
Processor threads	20
Product long name specifications	HP ZBook Studio 16 inch G10 Mobile Workstation PC Wolf Pro Security Edition, 16", touch screen, Windows 11 Pro, Intel® Core™ i9, 32GB RAM, 2TB SSD, NVIDIA® RTX™ 4000
Product short name specifications	HP ZBook Studio 16 inch G10 Mobile Workstation PC Wolf Pro Security Edition, 16", Intel® Core™ i9, 32GB RAM, 2TB SSD
Security Software Licenses	HP Wolf Pro Security Edition (1 year)
Standard memory note	Transfer rates up to 5600 MT/s.
Storage capacity	2
Storage capacity uom 01	TB
Storage interface 01	PCIe®
Storage interface protocol 01	NVMe™
Storage memory technology 01	TLC
Storage type	SSD
Storage type 01	SSD
UNSPSC code	43211503
Wireless Model	Wi-Fi 6E AX211
Wireless antenna	2x2
Wireless standard	Wi-Fi 6E
Wireless supplier	Intel®
vPro enabled	vPro®

[1] Not all features are available in all editions or versions of Windows. Systems may require upgraded and/or separately purchased hardware, drivers, software or BIOS update to take full advantage of Windows functionality. Windows is automatically updated and enabled. High speed internet and Microsoft account required. ISP fees may apply and additional requirements may apply over time for updates. See <http://www.windows.com>.

[8] HP Tamper Lock is an optional feature that must be configured at the factory and requires a supervisor password be established prior to use.

[12] Multi-Function USB-C port works with Discrete Graphics and Intel(r) Iris Xe Graphics. Note: For Nvidia Discrete Gfx, it can support HDMI 2.1 except GPU of QN20-P1 SKU(HDMI2.0 support).

[13] Manage and monitor your battery's performance and condition and customize charging options with the easy-to-use HP Power Manager dashboard.

[15] UHD content required to view UHD images.

[16] HD content required to view HD images.

[19] HP Smart Support automatically collects the telemetry necessary upon initial boot of the product to deliver device-level configuration data and health insights and is available preinstalled on select products, thru HP Factory Configuration Services; or it can be downloaded. For more information about how to enable HP Smart Support or for download, please visit <http://www.hp.com/smart-support>.

[25] Data Science Stack is available on select skus only.

[27] Display options may be limited to specific CPU / GPU Configurations.

[28] HP Z Light space is an optional feature, requires Windows 10 or higher and must be configured at hardware purchase.

[29] Resolutions are dependent upon monitor capability, and resolution and color depth settings.

[30] Available on select HP PCs with Windows 10 and higher and Intel processors.

[31] Miracast is a wireless technology your PC can use to project your screen to TVs, projectors, and streaming media players that also support Miracast. You can use Miracast to share what you're doing on your PC and present a slide show. For more information: <http://windows.microsoft.com/en-us/windows-8/project-wireless-screen-miracast>.

[33] HP Connection Optimizer requires Windows 10.

[34] HP BIOSphere Gen6 features may vary depending on the platform and configuration.

[35] Absolute agent is shipped turned off, and will be activated when customers activate a purchased subscription. Subscriptions can be purchased for terms ranging multiple years. Service is limited, check with Absolute for availability outside the U.S. The Absolute Recovery Guarantee is a limited warranty. Certain conditions apply. For full details visit: <http://www.absolute.com/company/legal/agreements/computrace-agreement>. Data Delete is an optional service provided by Absolute Software. If utilized, the Recovery Guarantee is null and void. In order to use the Data Delete service, customers must first sign a Pre-Authorization Agreement and either obtain a PIN or purchase one or more RSA SecurID tokens from Absolute Software.

[37] HP Manageability Integration Kit can be downloaded from <http://www.hp.com/go/clientmanagement>.

[38] Security lock for security slot is sold separately.

[39] HP Client Security Manager Gen7 requires Windows and is available on the select HP Elite and Pro PCs.

[43] HP Sure Start Gen6 is available on select HP PCs.

[48] 150W Power Adapter is not available with Nvidia RTX™ Graphics

[49] HP Sure Admin requires Windows 10 or higher, HP BIOS, HP Manageability Integration Kit from <http://www.hp.com/go/clientmanagement> and HP Sure Admin Local Access Authenticator smartphone app from the Android or Apple store.

[51] HP Easy Clean requires Windows 10 RS3 and will disable the keyboard, touchscreen, and clickpad only. Ports are not disabled. See user guide for clean.

[52] Select HP Products are enhanced with HP Presence. Features vary by platform. HP conferencing features require Windows and the latest myHP app, available over the air or for download via sofpaq on the HP Support website. Planned availability in spring 2023.

Disclaimer — Copyright

Intel, Core, Optane, Celeron, Pentium, Iris, XMM, and Thunderbolt are trademarks or registered trademarks of Intel Corporation or its subsidiaries in the United States and other countries. AMD, Ryzen, Athlon, and Radeon are trademarks of Advanced Micro Devices, Inc. Bluetooth is a trademark owned by its proprietor and used by HP Inc. under license. NVIDIA and GeForce are trademarks and/or registered trademarks of NVIDIA Corporation in the U.S. and other countries. USB Type-C® and USB-C® are registered trademarks of USB Implementers Forum. DisplayPort™ and the DisplayPort™ logo are trademarks owned by the Video Electronics Standards Association (VESA®) in the United

States and other countries. McAfee and McAfee LiveSafe are trademarks or registered trademarks of McAfee LLC in the United States and other countries. ENERGY STAR is a registered trademark of the U.S. Environmental Protection Agency. All other trademarks are the property of their respective owners.

© Copyright 2023 HP Development Company, L.P. The information contained herein is subject to change without notice. The only warranties for HP products and services are set forth in the express warranty statements accompanying such products and services. Nothing herein should be construed as constituting an additional warranty. HP shall not be liable for technical or editorial errors or omissions contained herein.

Generated by Dynamic Collateral Tool – (ww-en) – Jun 06, 2023 3:30 AM UTC+0000