

HP ZBook Studio 16 inch G10 Mobile Workstation PC Wolf Pro Security Edition (894F2UT)

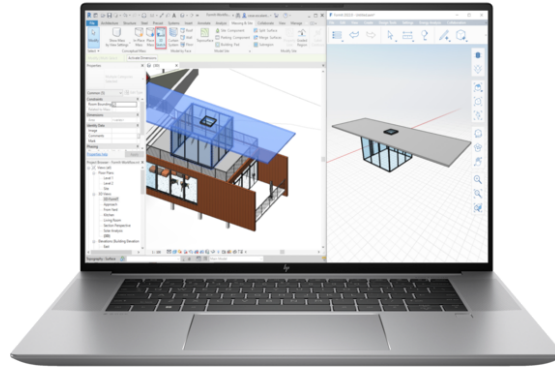

Powerfully immersive. Perfectly sized

Be ready when inspiration strikes. Packed with professional performance in an incredibly sleek PC that comfortably fits in your bag, the ZBook Studio is engineered to get you in the zone and help you stay focused. Now you can build complex assemblies, render in real time or visualize data—from anywhere.



HP recommends Windows 11 Pro for business

Pro-grade performance for your biggest projects

Push your 3D workflows further with an Intel® CPU, [1] integrated or discrete graphics [2] and upgraded memory.

See more of your content with less scrolling

Bring projects to life on a brilliant display and 16:10 aspect ratio so you can see more vertical content.

Create and collaborate on the go

Work effectively on a light laptop with a long-lasting battery and AI Noise Suppression software. [5]

Featuring

Windows 11

Work anywhere without compromising on performance or security with Windows 11 powered by HP's collaboration and connectivity technology.

Intel® Core™ i9 processor

Get high-end performance for intensive tasks like rendering and video editing with the Intel® Core™ i9 processor. [1]

HP Z Turbo Drive High-speed Storage

Work without limits in any location with local PCIe storage that's up to 6x faster than SATA SSD, and up to 21x faster than traditional HDD storage. [3]

HP Fast Charge

Ultra-fast recharge takes you from zero to 50% charge in just 30 minutes. [4]

Spill-resistant Keyboard

Accidents happen - which is why we designed our keyboard with a drain hole, so minor spills flow out the bottom for easy cleanup.

Specifications

Operating system	Windows 11 Pro ^[1]
Processor family	13th Generation Intel® Core™ i9 processor
Processor	Intel® Core™ i9-13900H (up to 5.4 GHz with Intel® Turbo Boost Technology, 24 MB L3 cache, 14 cores, 20 threads)
Memory	32 GB DDR5-5600 MHz RAM (2 x 16 GB)
Memory Slots	2 SODIMM; supports dual channel
Internal Storage	1 TB PCIe® NVMe™ TLC SSD
Memory card device	1 microSD 7.1 media card reader
Graphics	Discrete
Graphics (discrete)	NVIDIA® GeForce RTX™ 4080 (12 GB GDDR6X dedicated)
Graphics	Integrated
Graphics (integrated)	Intel® Iris® X ^e Graphics
Display	40.6 cm (16") diagonal, WQUXGA (3840 x 2400), IPS, anti-glare, micro-edge, 500 nits, 100% DCI-P3, HP DreamColor
Display	16" diagonal, WQUXGA (3840 x 2400), IPS, anti-glare, micro-edge, 500 nits, 100% DCI-P3, HP DreamColor ^[15,16,27,29]
Display size (diagonal)	40.6 cm (16")
Display size (diagonal)	16"
Audio	Audio by Bang & Olufsen, Quad-speaker audio (2 tweeters & 2 Quad woofers), 2 Top Facing Microphone dual array digital microphones, functions keys for volume up and down, combo microphone/headphone jack, HD audio with 200Hz Bass Roll off
Minimum dimensions (W x D x H)	35.6 x 24.2 x 1.9 cm (non-touch); 35.6 x 24.2 x 1.8 cm (touch)
Minimum dimensions (W x D x H)	14.02 x 9.54 x 0.76 in (non-touch); 14.02 x 9.54 x 0.72 in (touch)
Weight	Starting at 1.73 kg (Weight varies by configuration and components.)
Weight	Starting at 3.81 lb (Weight varies by configuration and components.)
Keyboard	HP RGB Z Command Keyboard – spill-resistant, full-size, backlit keyboard with drain and DuraKeys
Pointing device	ClickPad Glass with multi-touch gesture support, taps enabled as default
Camera	720p HD IR camera
Ports	1 power connector; 1 headphone/microphone combo; 2 Thunderbolt™ 4 with USB4™ Type-C® 40Gbps signaling rate (USB Power Delivery, DisplayPort™ 1.4, HP Sleep and Charge) ^[12]
Ports	1 Super Speed USB Type-A 5Gbps signaling rate (charging); 1 SuperSpeed USB Type-C® 10Gbps signaling rate (USB Power Delivery, DisplayPort™ 1.4)
Wireless	Intel® Wi-Fi 6E AX211 (2x2) and Bluetooth® 5.3 wireless card, vPro®
Power	200 W external AC power adapter ^[48]
Battery type	HP Long Life 6-cell, 86 Wh Li-ion polymer
Battery recharge time	Supports battery fast charge: approximately 50% in 30 minutes
Ecolabels	TCO Certified
Energy star certified	ENERGY STAR® certified
Management features	HP Power Manager ^[13]
Sustainable impact specifications	Low Halogen
Security management	Absolute persistence module; HP Credential Manager; HP Power On Authentication; Master Boot Record security; Pre-boot authentication; Windows Defender; HP Manageability Integration Kit; HP BIOSphere Gen6; HP Sure Start Gen6; HP Sure Admin; HP Image Assistant; Nano Security Lock Slot; HP Image Assistant Gen4.6; HP Client Security Manager Gen7; Trusted Platform Module TPM 2.0; HP Privacy Key ^[8,34,35,37,38,39,43,49]
Software included	Bing search for IE11; HP Hotkey Support; HP Noise Cancellation Software; HP Performance Advisor; HP Support Assistant; Native Miracast support; HP Connection Optimizer; myHP; HP Privacy Settings; Data Science Stack; HP Easy Clean; HP PC Hardware Diagnostics; Windows 10 Cloud Recovery Client; HP Z Light Space; HP Camera & Super Resolution Software; Microsoft 365 and Office (sold separately and Internet access required for activation); HP Presence ^[25,28,30,31,33,51,52]
UPC number	(ABA) 196188227558; (ABL) 196188227541

Top Recommended Displays, Accessories and Services

No Top Recommended Displays, Accessories and Services

Messaging Footnotes

- [1] Multicore is designed to improve performance of certain software products. Not all customers or software applications will necessarily benefit from use of this technology. Performance and clock frequency will vary depending on application workload and your hardware and software configurations. Intel's numbering, branding and/or naming is not a measurement of higher performance.
- [2] Optional feature that must be configured at purchase.
- [3] For hard drives, GB = 1 billion bytes. TB = 1 trillion bytes. Actual formatted capacity is less. Up to 30GB (for Windows 10) of system disk is reserved for system recovery software.
- [4] Recharges the battery up to 50% within 30 minutes when the system is off or in standby mode. Power adapter with a minimum capacity of 65 watts is required. After charging has reached 50% capacity, charging will return to normal. Charging time may vary +/-10% due to System tolerance.
- [5] AI Noise Reduction is delivered automatically through Windows update or can be downloaded from <https://support.hp.com/us-en/drivers> when available. Requires Windows 10 or higher, compatible with internal PC speakers, microphone and analog headsets. The DNN Noise Reduction setting can be configured through the Application HP Audio Control.

Technical Specifications Footnotes

- [1] Not all features are available in all editions or versions of Windows. Systems may require upgraded and/or separately purchased hardware, drivers, software or BIOS update to take full advantage of Windows functionality. Windows is automatically updated and enabled. High speed internet and Microsoft account required. ISP fees may apply and additional requirements may apply over time for updates. See <http://www.windows.com>.
- [8] HP Tamper Lock is an optional feature that must be configured at the factory and requires a supervisor password be established prior to use.
- [12] Multi-Function USB-C port works with Discrete Graphics and Intel(r) Iris Xe Graphics. Note: For Nvidia Discrete Gfx, it can support HDMI 2.1 except GPU of QN20-P1 SKU(HDMI2.0 support).
- [13] Manage and monitor your battery's performance and condition and customize charging options with the easy-to-use HP Power Manager dashboard.
- [15] UHD content required to view UHD images.
- [16] HD content required to view HD images.
- [25] Data Science Stack is available on select skus only.
- [27] Display options may be limited to specific CPU / GPU Configurations.
- [28] HP Z Light space is an optional feature, requires Windows 10 or higher and must be configured at hardware purchase.
- [29] Resolutions are dependent upon monitor capability, and resolution and color depth settings.
- [30] Available on select HP PCs with Windows 10 and higher and Intel processors.
- [31] Miracast is a wireless technology your PC can use to project your screen to TVs, projectors, and streaming media players that also support Miracast. You can use Miracast to share what you're doing on your PC and present a slide show. For more information: <http://windows.microsoft.com/en-us/windows-8/project-wireless-screen-miracast> .
- [33] HP Connection Optimizer requires Windows 10.
- [34] HP BIOSphere Gen6 features may vary depending on the platform and configuration.
- [35] Absolute agent is shipped turned off, and will be activated when customers activate a purchased subscription. Subscriptions can be purchased for terms ranging multiple years. Service is limited, check with Absolute for availability outside the U.S. The Absolute Recovery Guarantee is a limited warranty. Certain conditions apply. For full details visit: <http://www.absolute.com/company/legal/agreements/computrace-agreement> . Data Delete is an optional service provided by Absolute Software. If utilized, the Recovery Guarantee is null and void. In order to use the Data Delete service, customers must first sign a Pre-Authorization Agreement and either obtain a PIN or purchase one or more RSA SecurID tokens from Absolute Software.
- [37] HP Manageability Integration Kit can be downloaded from <http://www.hp.com/go/clientmanagement> .
- [38] Security lock for security slot is sold separately.
- [39] HP Client Security Manager Gen7 requires Windows and is available on the select HP Elite and Pro PCs.
- [43] HP Sure Start Gen6 is available on select HP PCs.
- [48] 150W Power Adapter is not available with Nvidia RTX™ Graphics
- [49] HP Sure Admin requires Windows 10 or higher, HP BIOS, HP Manageability Integration Kit from <http://www.hp.com/go/clientmanagement> and HP Sure Admin Local Access Authenticator smartphone app from the Android or Apple store.

© Copyright 2023 HP Development Company, L.P. The information contained herein is subject to change without notice. The only warranties for HP products and services are set forth in the express warranty statements accompanying such products and services. Nothing herein should be construed as constituting an additional warranty. HP shall not be liable for technical or editorial errors or omissions contained herein.

Intel, Core, Optane, Celeron, Pentium, Iris, XMM, and Thunderbolt are trademarks or registered trademarks of Intel Corporation or its subsidiaries in the United States and other countries. AMD, Ryzen, Athlon, and Radeon are trademarks of Advanced Micro Devices, Inc. Bluetooth is a trademark owned by its proprietor and used by HP Inc. under license. NVIDIA and GeForce are trademarks and/or registered trademarks of NVIDIA Corporation in the U.S. and other countries. USB Type-C® and USB-C® are registered trademarks of USB Implementers Forum. DisplayPort™ and the DisplayPort™ logo are trademarks owned by the Video Electronics Standards Association (VESA®) in the United States and other countries. McAfee and McAfee LiveSafe are trademarks or registered trademarks of McAfee LLC in the United States and other countries. ENERGY STAR is a registered trademark of the U.S. Environmental Protection Agency. All other trademarks are the property of their respective owners.

