

AMR1C32

Clamp Mount Max 32" Monitor

The AMR1C32 is a clamp-style monitor stand with an adjustable height that supports 1 LCD monitor. The clamp structure of this mount allows for more workspace and many advantages for those wanting to create a more ergonomic and functional environment. SEE MORE and DO MORE™ with features like:

- 90 Degree Monitor Rotation,
- Height Adjustment,
- Cable Management,
- Arm Angle Adjustment, PowerTorque™ Hinge System,
- Aluminum Alloy Structure,
- Easy Installation and VESA Mounting.

Our LCD/LED monitor stand is an advanced display system providing increased efficiency and productivity. This is through the use of our PowerTorque™ Hinge System, which allows for display rotation, swivel and tilt functions. In addition to these features, the device is also compatible with VESA 100x100/75X75 and suitable for monitor sizes 24" to 32".



Specifications

General

Mounting Pattern:	• 200x100/100x100/75x75mm
Material:	• Steel/Aluminum Alloy/Plastic
Weight:	• 3.21 kg (7.08 lbs)

Screw Type:	• M4, M5, M6, M8
Dimensions (W x H x D):	• 226 x 505 x 128 mm 8.9" X 19.88" x 5.04"

Hinge Module

Swivel(Hinge):	• Adjustable
Tilt(Hinge):	• Max. +/-15°
Rotate(Pivot):	• 360°
Torque Adjust:	• User Adjustable

Support Flat Pannel Size:	• 24"-32"
Support Max Weight:	• 15kg (33.1lbs)
Height Adjust Range (Max.)	• 430 mm (16.93")

Warranty and Support

Warranty:	3 Years
Support:	Free technical support (phone/email)

AMR1C32

Clamp Mount Max 32" Monitor

AMR1C32

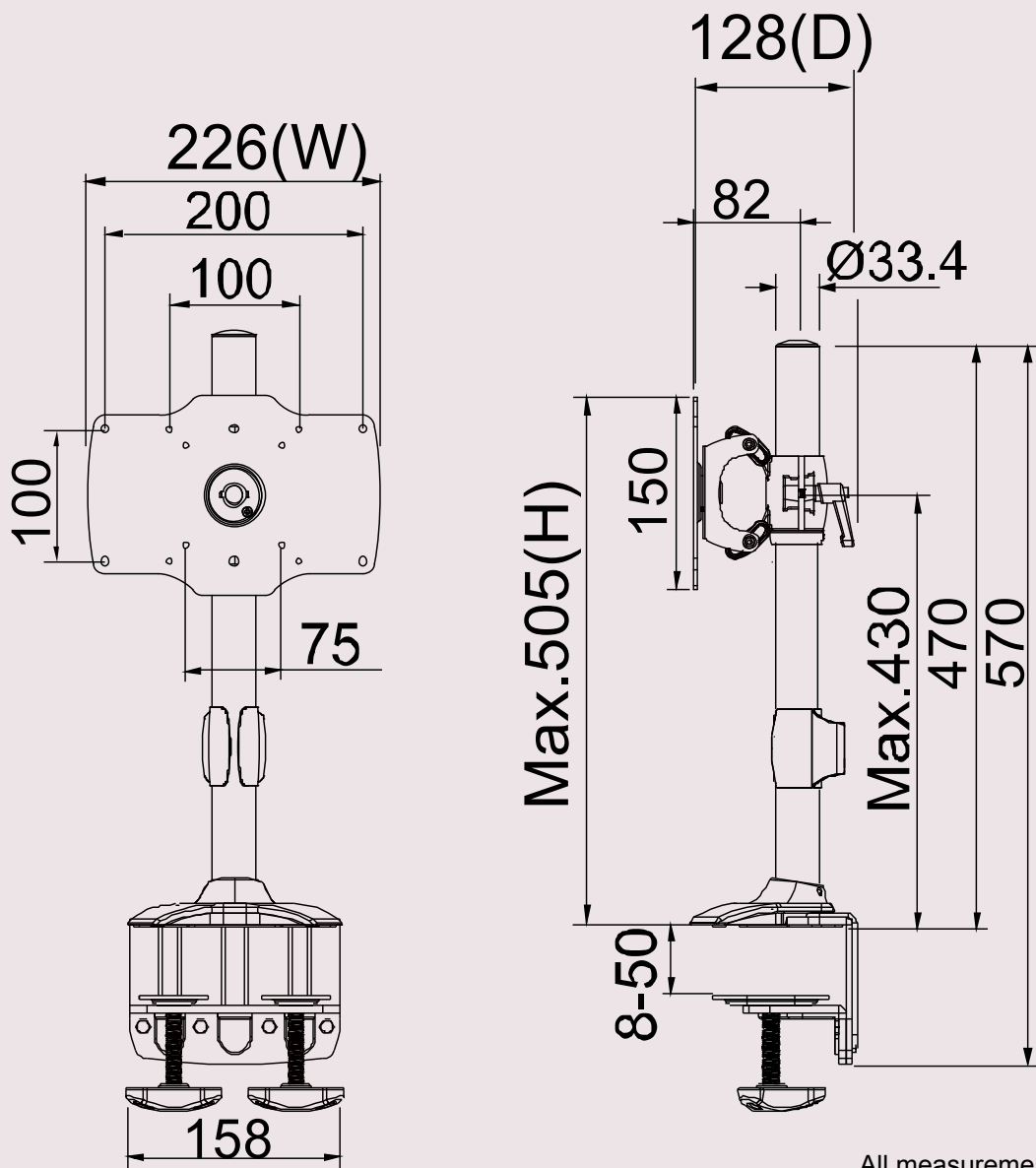

All measurement in mm

www.amer.com / www.amermounts.com

sales@amer.com
1-800-262-9703

Specifications subject to change without notice. Errors and omissions excepted. All trademarks are properties of their respective owners.

Revision 1.03