

# MTMA80 Plus

## Mobility made easy.

Constructed out of high-grade aluminum, the MTMA Plus series provides a mobile mounting solution that is highly durable and lightweight. Each mount comes with a VESA compatible mounting bracket, component tray and upper shelf, allowing you to safely and effortlessly maneuver your TV and accessories. Complementing today's modern TVs, their sleek appearance and integrated cable management make them perfectly suited for any home, school or office environment. Every MTMA Plus unit offers simple height adjustment and quick-release wheel locks, and comes packaged in a heavy-duty, compact box to allow for safe and easy transport. Available in three models to accommodate a wide range of TV sizes.

## FEATURES & SPECIFICATIONS

- Fits most flat panel TVs from 55" to 80"
- Supports TVs up to 150 lb (68 kg)
- Accommodates VESA sizes from 200x200 to 800x500
- Height adjustable between 53" (1.3 m) and 65" (1.6 m)
- Integrated cable management system
- Lightweight but sturdy aluminum body
- Convenient accessory tray and top shelf for storage of remotes, AV equipment and webcam
- Four wheel locks can be applied and released with your foot
- Assembly manual and all TV mounting hardware is included
- Five year warranty
- Shipping box weight: 68.3 lb (31 kg)
- Shipping box dimensions: 41.1" x 21.5" x 8.4" (104.5 x 54.7 x 21.4 cm)
- Product weight: 61.7 lb (28 kg)
- UPC: 800152715193

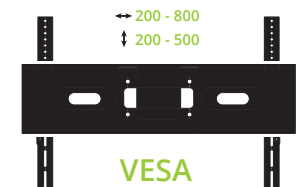
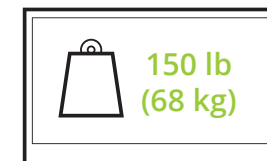
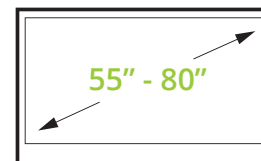



## FITS VESA SIZES TO 800X500

MTMA80 Plus is designed to fit most flat panel TVs from 55" to 80", with VESA sizes ranging from 200x200 to 800x500.



## ADJUSTABLE MIDDLE TRAY

MTMA80 Plus includes an adjustable middle tray that can hold up to 10 pounds (4.5 kg), making it perfectly suited for your laptop, PVR, or other AV hardware.



## EASY HEIGHT ADJUSTMENT

Using the provided Allen key, easily adjust the center of your TV anywhere between 53" (1.3m) to 65" (1.6 m) to find the perfect viewing height. This adjustment should be done with the TV removed.



## TOP SHELF

The top shelf is ideal for placing a camera, making the MTMA80 Plus a perfect display unit for web conferences.



## UNIQUE CABLE MANAGEMENT

Built with two hollow towers, MTMA80 Plus allows you to hide your cables for a clean and professional appearance. Grommets are also provided to keep your cables securely in place.



## EVERYTHING YOU NEED

MTMA80 Plus comes packaged in a compact box with all the mounting bolts, washers and spacers you'll need to secure your TV in place.

## TECHNICAL ILLUSTRATIONS

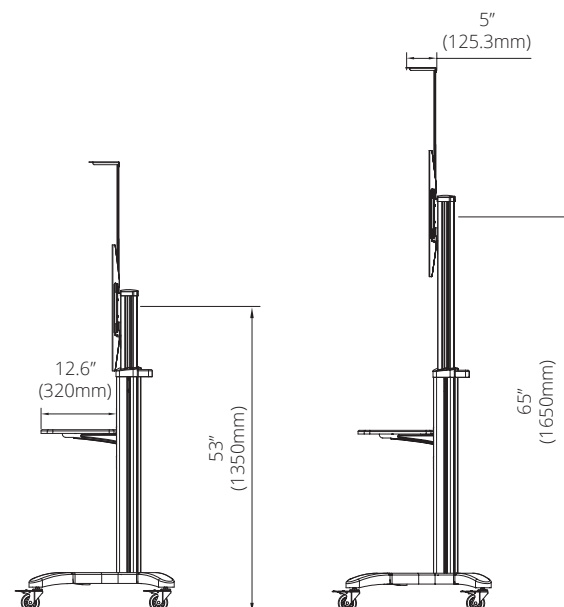
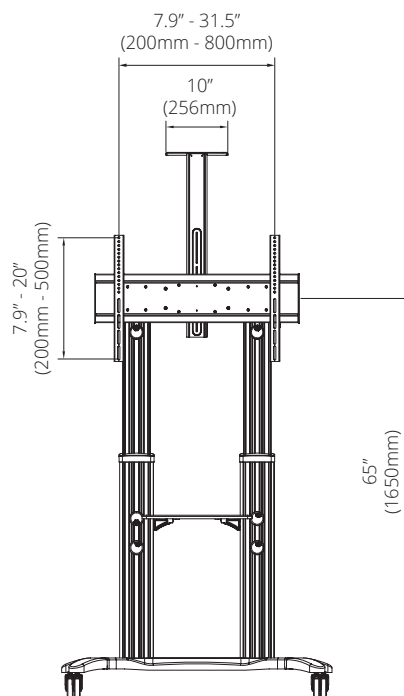
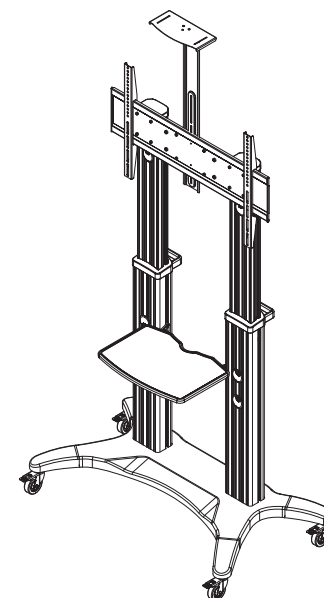
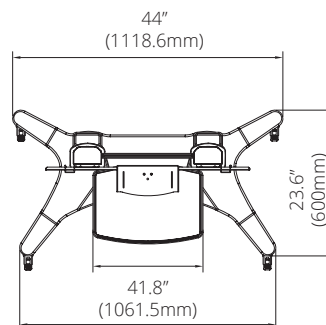

kanto

[www.kantoliving.com](http://www.kantoliving.com) | [sales@kantoliving.com](mailto:sales@kantoliving.com)

Supporting your digital lifestyle™

Kanto Living 2390 Canoe Avenue, Coquitlam, BC, V3K 6C2  
office: 778.284.6942 | fax: 778.284.6945 | toll free: 888.848.2643