



BOSCH



Bosch
WTB84200GB
Tumble dryer

Predecessor:
WTB86300GB

Successor:

EAN code:
4242002847818

sales programme:

WTB84200GB Condenser dryer

Performance

- Energy efficiency class: B
- Capacity: 8 kg
- Energy consumption 561.0 kWh per year, based on 160 drying cycles of the standard cotton programme at full and partial load, and the consumption of the low-power modes. Actual energy consumption per cycle will depend on how the appliance is used
- Energy consumption of the standard cotton programme at full load 4.63 kWh and energy consumption of the standard cotton programme at half load 2.61 kWh
- Power consumption in off-mode 0.1 W and in left-on mode 1 W
- Duration of left-on mode: 0 min
- Programme time of the standard cotton programme at full load 137 min and programme time of the standard cotton programme at partial load 82 min.
- Weighted programme time of the standard cotton programme at full and partial load: 106 min.
- Condensation efficiency class B on a scale from G (least efficient) to A (most efficient).
- Average condensation efficiency of the standard cotton programme at full load 88 % and average condensation efficiency of the standard cotton programme at partial load 88 %.
- Weighted condensation efficiency for the standard cotton programme at full and partial load: 88 %.
- Noise level: 65 dB (A) re 1 pW

Programmes/functions

- Fully electronic control dial for sensor drying, including timed and special programmes
- Special programmes: Woollens, Mixed Load, Timed programme warm, Timed programme cold, Sportswear, Down, Super Quick 40, Shirts 15
- Buttons: start/pause, Low heat, Buzzer, Reduced ironing, Drying length, Fine-tuning for drying level, 24 hours Time Delay

Key features

- Sensitive drying: large galvanised drum and revolution drying system
- AntiVibration design: for greater stability and quietness

Additional features

- LED Display for remaining time and 24 hours time delay, programme status indication, special functions
- Anti crease cycle 120 minutes at the end of the programme
- Drum interior light
- Buzzer to indicate the end of cycle
- Child lock
- Metal door catch

Technical Information

- Dimensions (H X W X D): 84.2 x 59.7 x 63.6 cm
- slide-under installation
- Large white round solid door

Included accessories

Optional accessories

- WMZ20500 Platform with pull-out
- WTZ1110 Condenser drainage kit
- WTZ11400 Stacking kit with pollout shelf
- WTZ20410 Connection set

Alternative colors available

Technical Data

Characteristics

Built-in / Free-standing : Free-standing
Removable top : No
Door hinge : Right
Color / Material body : White
Length electrical supply cord (m) : 145.0
Height of removable worktop (mm) : 842
Dimensions of the product (mm) : 842 x 597 x 636
Net weight (kg) : 40
Drum volume (l) : 112

Consumption and connection features

Connection Rating (W) : 2600
Current (A) : 13
Voltage (V) : 220-240
Frequency (Hz) : 50
Approval certificates : CE, VDE
Drying process : automatic
Capacity cotton (kg) - NEW (2010/30/EC) : 8.0
Standard cotton programme : Cotton cupboard dry
Energy efficiency class - NEW (2010/30/EC) : B
Energy consumption electric dryer, full load - NEW (2010/30/EC) (kWh) : 4.63
Standard cotton programme time at full load (min) : 137
Energy consumption electric dryer, partial load - NEW (2010/30/EC) (kWh) : 2.61
Standard cotton programme time at partial load (min) : 82
Weighted annual energy consumption, electric dryer - NEW (2010/30/EC) (kWh) : 561.00
Power consumption in off-mode - NEW (2010/30/EC) : 0
Power consumption in left-on mode - NEW (2010/30/EC) : 1
Duration of the left-on mode - NEW (2012/30/EC) (min) : 0
Weighted programme time (min) : 106
Condensation efficiency class - NEW (2010/30/EC) : B
Average condensation efficiency full load (%) : 88
Average condensation efficiency partial load (%) : 88
Weighted condensation efficiency (%) : 88



BOSCH

WTB84200GB
Condenser dryer

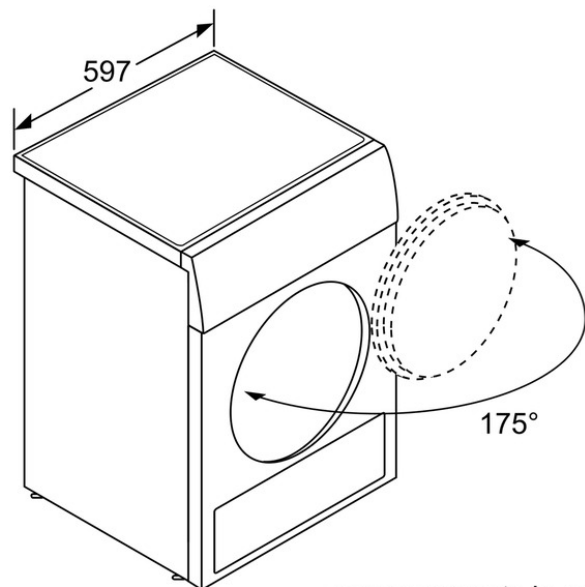

measurements in mm

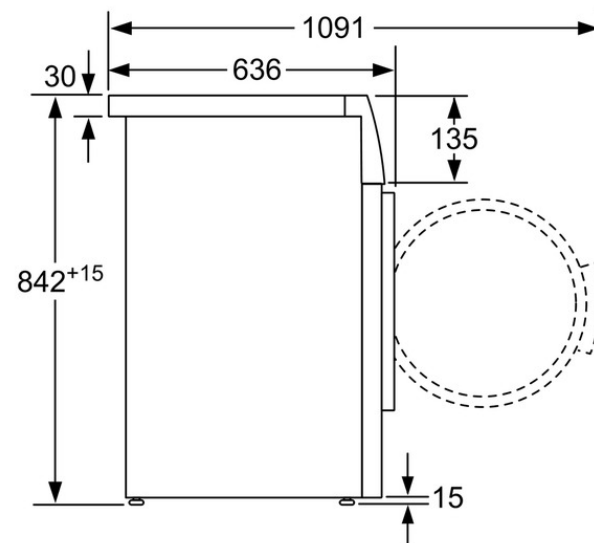

measurements in mm