

EZ630 **NEW!**

1/3" CCD True Day/Night & Wide Dynamic Range Outdoor Bullet with IR LEDs

POLESTAR II
Series



Features

- Super HAD II sensor at 0.05 Lux has 5X better native light sensitivity before DSP low light boost
- Starlight super high sensitivity of 0.0002 Lux/F=1.2 is achieved through a sensitivity increase setting of up to 256x
- Extended IR range of up to 60M (196 ft) with 36 LEDs and variable output
- IR control to manage illumination and conserve energy
- Split glass to prevent internal IR reflections
- Get full motion true day/night images without ghosting
- True Day/Night with ICR module
- Motorized varifocal auto iris lens – choose 2.8-10mm or 9-22mm focal range
- Digital Wide Dynamic Range expansion to deliver properly exposed images despite bright light sources, deep shadows and/or unbalanced lighting in the same scene
- Provides 3D-Noise Reduction to improve picture clarity while enabling DVRs to improve disk storage utilization
- Flexible mounting and positioning – speedy-mount ring fits 4" round electrical box, or remove base to mate with 1" conduit
- E-Z Lock ring at the base is designed with easy to grip tabs to firmly clamp the camera in place, plus a set screw for added security
- Easy to use OSD setup menu with local controls or RS-485 remote control
- Motion detection for 4 configurable zones
- Privacy mask function for 8 configurable zones
- Provides digital zoom (up to 32x)
- Easy bottom access to video test point and lens with OSD menu controls inside weather resistant cover

Dimensions

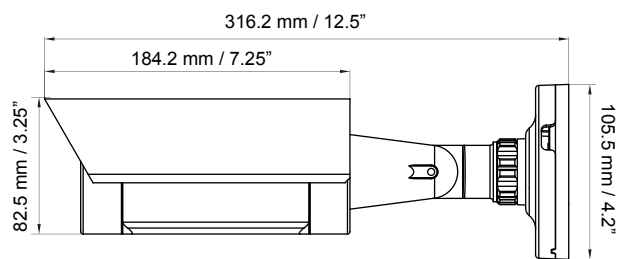

(Unit: mm/inch)

Specifications

Pickup Device	1/3" Sony Super HAD II CCD
Video Format	NTSC / PAL
Picture Elements	768 x 494 (NTSC) / 752 x 582 (PAL)
Horizontal Resolution	560 TVL
Sensitivity	0.05 Lux/F=1.2 (AGC On) 0.0002 Lux/F=1.2 (SENS-UP 256x) / 0 Lux IR On
S/N Ratio	Over 52dB (AGC off)
Electronic Shutter	1/60(1/50) ~ 1/100,000
Video Output	Main Output BNC 1.0V p-p 75Ω, Local test output, cable provided.
Gamma Correction	0.45
Lens Type	DC Iris Varifocal: 2.8-10mm or 9-22mm focal length
Backlight Compensation	OFF/BLC/HS BLC Selectable
Auto Gain Control	Low/Middle/High Selectable
White Balance	ATW/AWB/AWC/Manual/Indoor/Outdoor Selectable
Sync. Mode	Internal/Line lock
Day/Night	Auto/Color/BW/EXT (True Day/Night with ICR control module)
OSD Menu	Multiple functions
IR Emitters	36 long life LEDs
IR Configuration	Split glass isolation prevents internal reflections
IR Wavelength	850nm
IR LED	20,000 hours of operation (min. lifespan)
IR Range	Up to 60M (196 ft)
IR Output	Intelligent Variable Intensity Illumination Energy Management
3D-DNR	Off/On Switchable
Digital WDR	Outdoor/Indoor
Digital Slow Shutter	SENS-UP up to 256X
Mirror	Off/Mirror/V-Flip/Rotate Selectable
Digital Zoom	Off/On selectable up to 32X
Motion Detection	Off/On for 4 selectable zones
Privacy Mask	Off/On for 8 selectable zones
RS-485	Control input for menu/configuration
Power Source	12VDC/24VAC
Power Consumption	12VDC: 8W max. / 24VAC: 9W max.
Operating Temperature	-40°C~50°C / -40°F~122°F (built-in heater)
Weather Resistant	IP66 rated
Heater	Yes, built-in
Dimensions (L x W x H)	316.2 x 105.5 x 82.5 mm / 12.49" x 4.2" x 3.25"
Weight	Approx. 1250 g / 2.275 lbs.
Mounting Pattern	Speedy-Mount Ring mates with 4" round electrical box; base swivel is 1" NPT – remove base plate for coupling to standard conduit fittings.
Certifications	CE / FCC

Ordering Information**

**** Check with your EverFocus sales rep for release date and availability**