

# CCS25669

## Quick User Guide

Using Apple Homekit & Amazon Alexa



COMPUCESSORY®

# Preface

---

## About This Guide

This document provides information about accessing services and functions available with APPSPower Mobile App and how to access them using Amazon Alexa voice assistant.

## Audience

This user guide intended for people who want to use their mobile phone or tablet (iOS) to access remote interactive services for CCS25669 plug using Alexa voice assistant.

## Getting Started

The APPSPower Mobile App enables you to access a core set of remote monitoring using Alexa voice assistant and security system functions. The app designed to be easy to use.

## Introduction for Smart Plug Function and LED Light

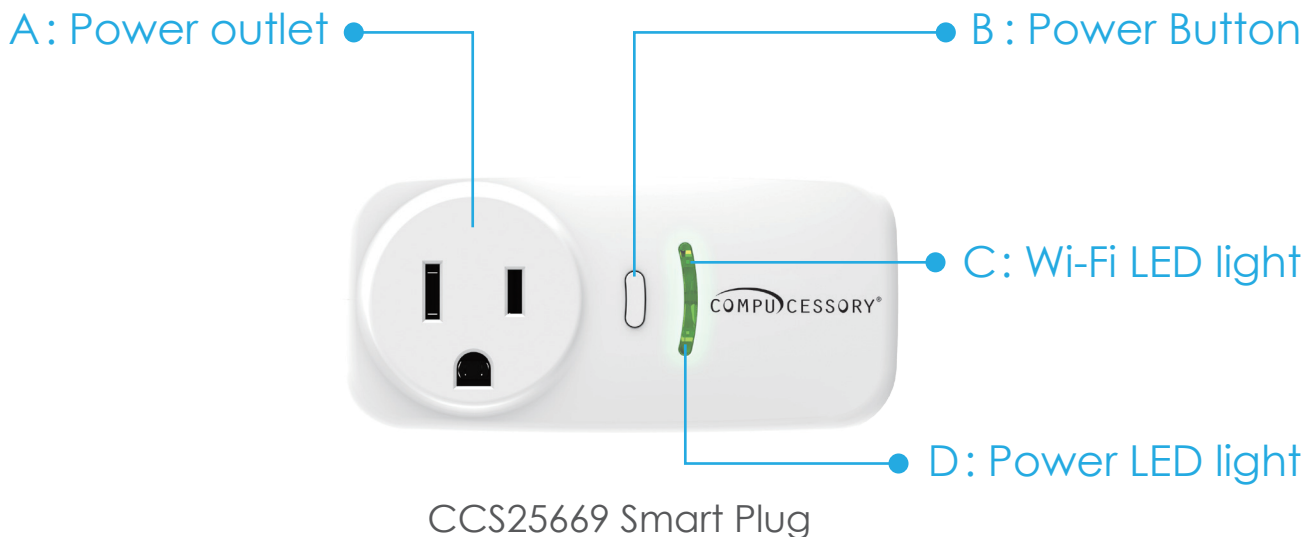

## Connect CCS25669 to Wi-Fi

In order to setup smart plug successfully, please make sure you already have the Wi-Fi access and please operate the following steps within your Wi-Fi signal coverage.



### Step 1:

Plug into an outlet and ensure it is connected to power.

When plugged into power, If you see both indicator lights are on (Wi-Fi LED and Power LED), please make sure you press the power button once to switch off Power LED before you proceed to next step.

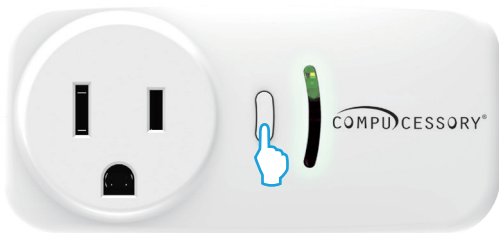

### Step 2:

Begin to press the power button for 10 seconds, you will see the Power LED light on, hold down the button until Power LED light goes off and you should hear a little click sound at the same time. Then you may let go the button and move on to next step.



### Step 3:

Wi-Fi LED blinking fast means now you are in setup mode, you can now move on to APP for setup. Once smart plug is connected to Wi-Fi successfully, it will stay solid green light.

Item	Status
Power Button	Long press 10 seconds: to connect Short press: to manual switch on/off
Wi-Fi LED	Green(blink slowly): not paired / not connected to Wi-Fi Green(blink fast): ready for set up from APP Green(solid): connected to cloud and ready for APP control
Power LED	Green(solid): the Wi-Fi smart plug is switched on Off: the Wi-Fi smart plug is switched off

#### NOTE:

If the Wi-Fi LED does not blink rapidly, please proceed Step 1.

# Connect CCS25669 to Apple Home App

## iOS User

### Connect Wi-Fi Smart Plug to Apple Home APP

Before you begin, Please Note: If you have been using this smart plug before for Apple Home APP, please check your smart Home setting and press **"Remove Accessory"** before you moving to next step.

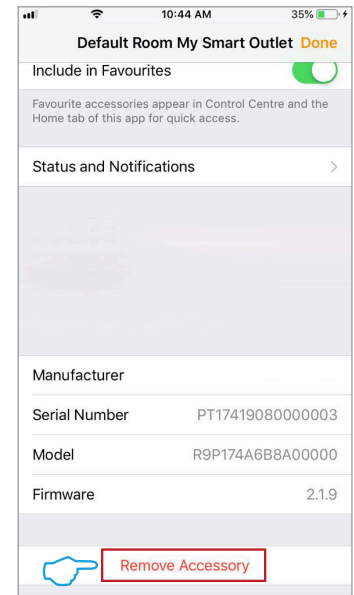

### Connect Wi-Fi Smart Plug to Apple Home App

There are 2 methods to download Apple Home App :

#### Method #1. Search "home app" in App Store & Download

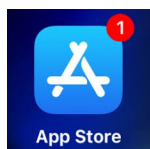

Click and open App Store From iOS device

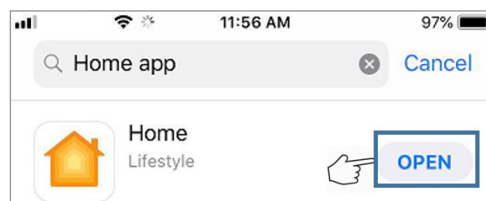

Search and Install/Open Home app



Click and open Home App

#### Method #2. Scan below QR Code & Download



Apple Website

After downloaded Apple Home App from Apple App Store and launch the Apple Home App. Follow the instruction on Apple Official Website:

<https://support.apple.com/en-gb/HT204893>

# Connect CCS25669 to Apple Home App

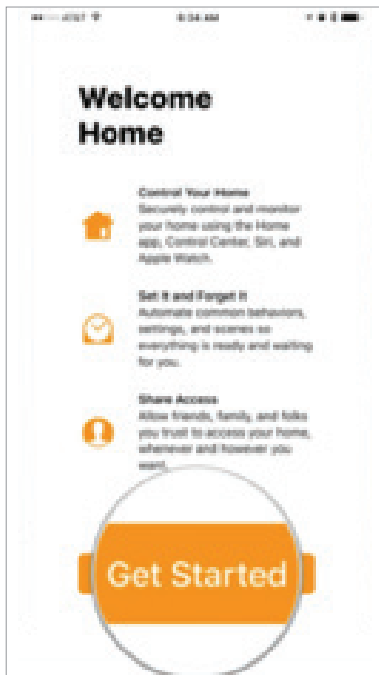

Launch the Home App and follow the steps below to connect accessory to the Home app.

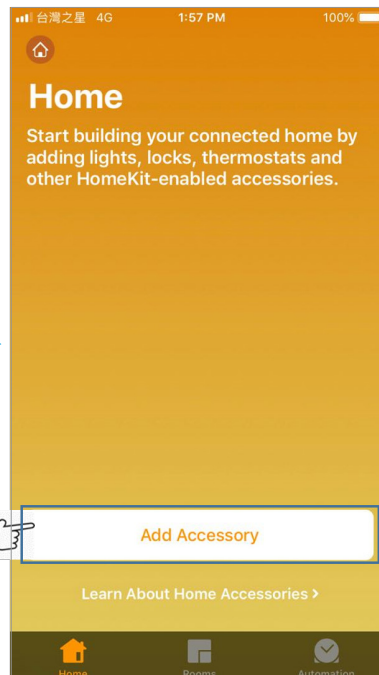

Click on Add Accessory button to add accessory to Home app as shown in the figure.

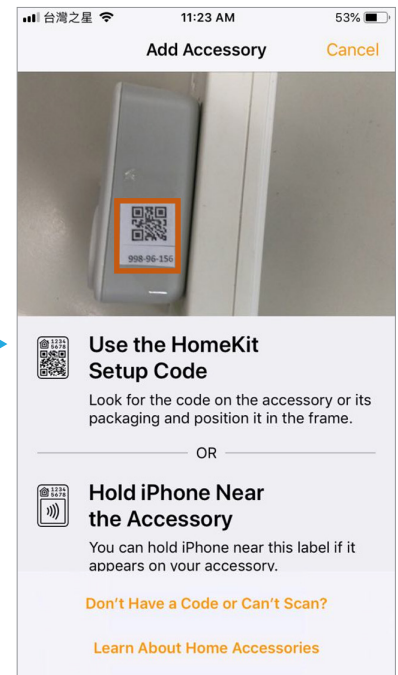

Scan HomeKit Setup Code as shown in the figure.

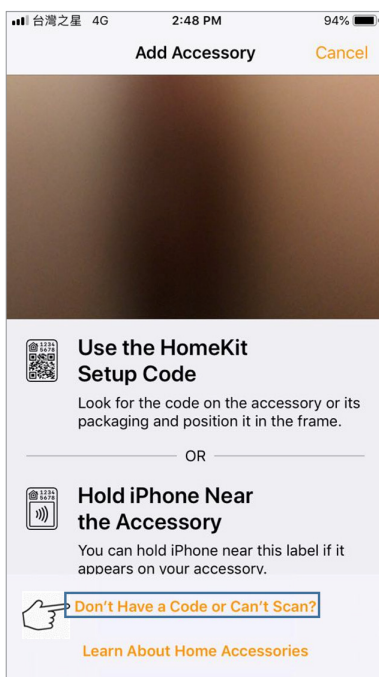

Click on Don't Have a Code or Can't Scan? Button if no scan code or trouble in scanning HomeKit code.

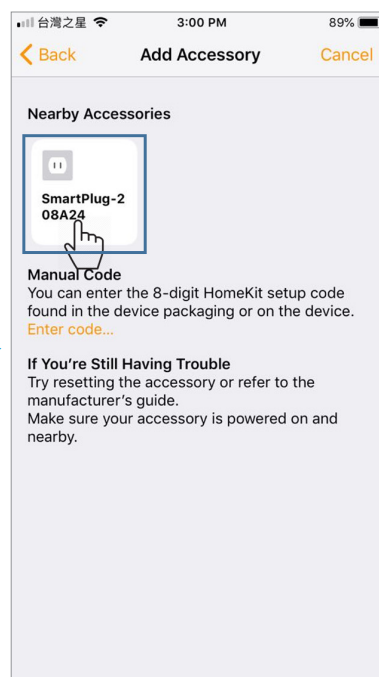

Click on smart plug to be paired as shown in the figure.

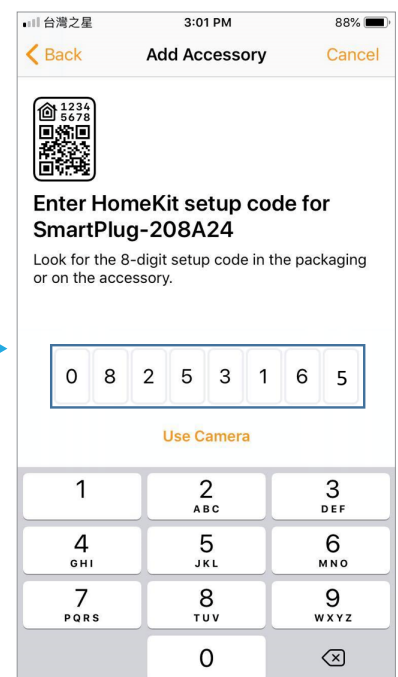

Enter the HomeKit code as shown in the figure.

# Connect CCS25669 to Apple Home App

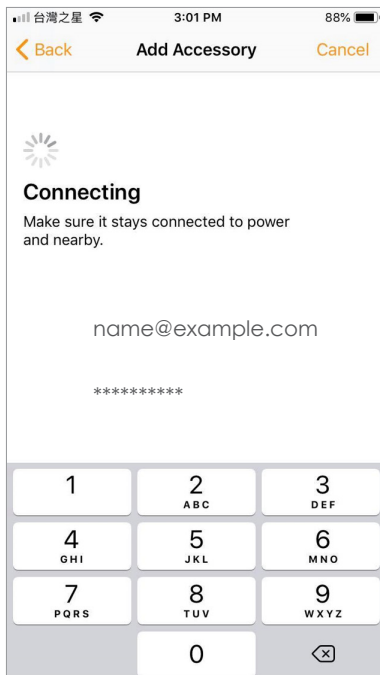

Pairing is under progress.

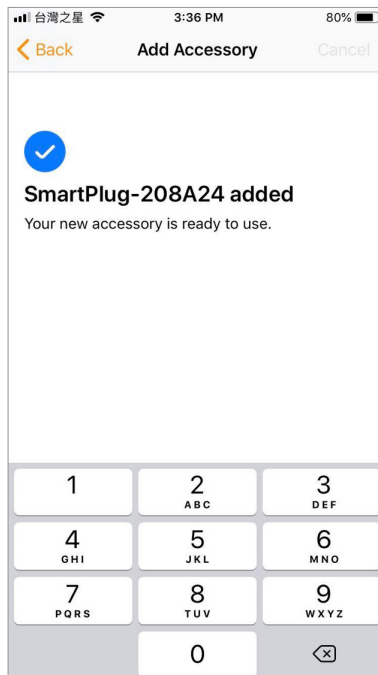

Pairing Completed.

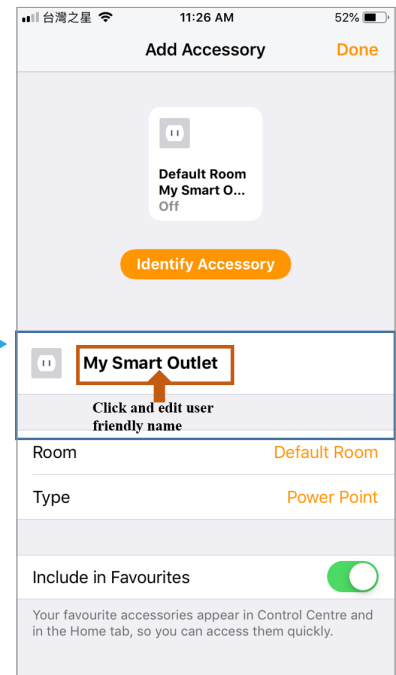

Edit smart plug name to user-friendly name.

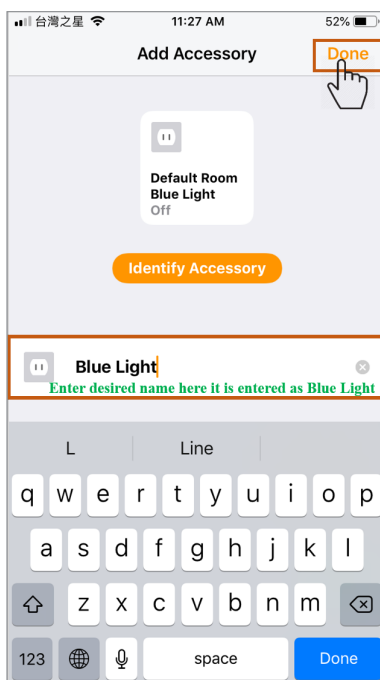

Click on Done button as shown in figure.

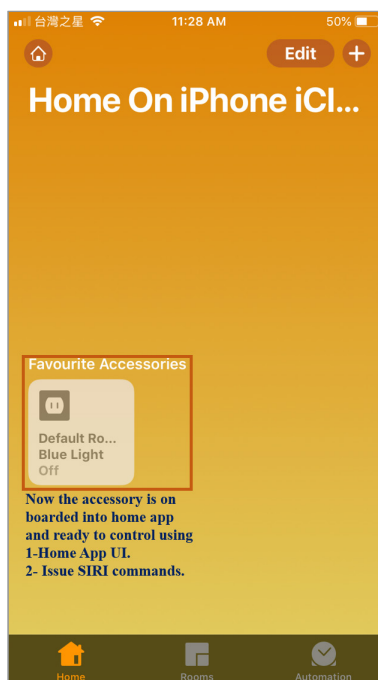

Now Plug is paired successfully to Home app and is ready to be controlled by App or SIRI commands.

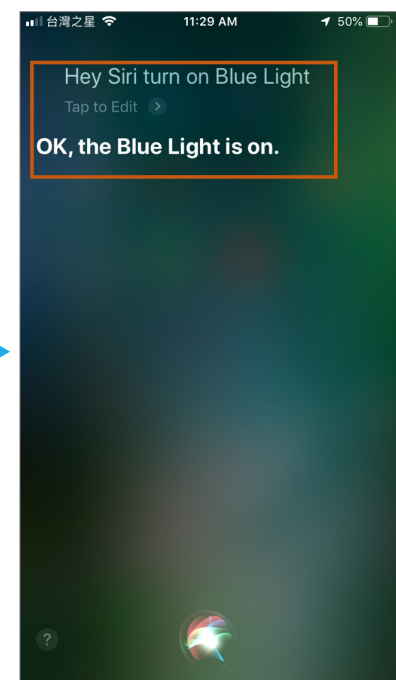

Issue SIRI Voice command to Turn ON Blue Light as shown in the figure.

# Connect CCS25669 to Home App and APPSPower

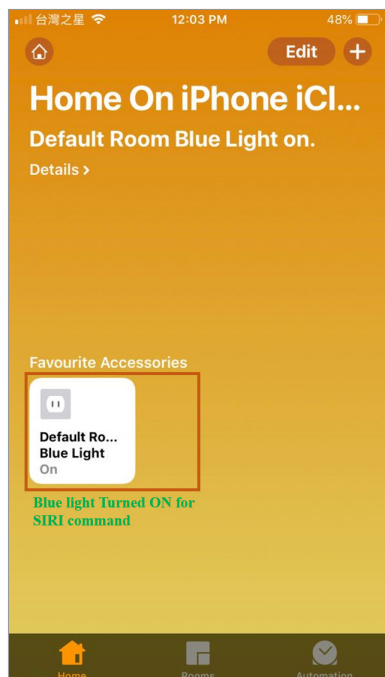

Blue light turned ON for the previous SIRI command.

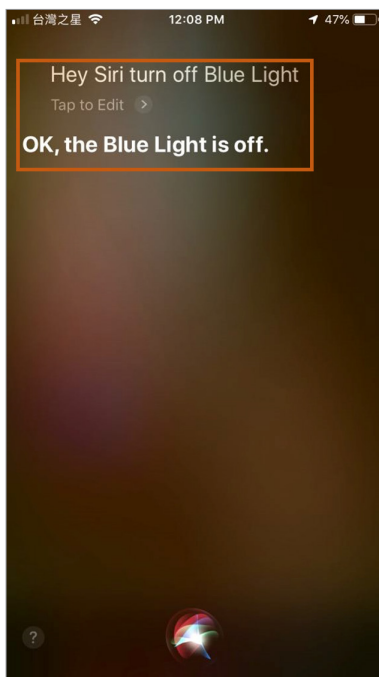

Issue SIRI Voice command to turn OFF Blue Light as shown in the figure

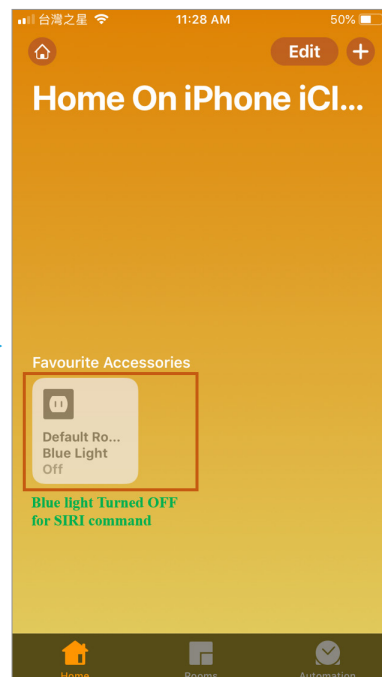

Blue light turned OFF for the previous SIRI command.

## Download APPSPower App

Download and install APPSPower + from App Store or Google Play.





# Connect CCS25669 to APPSPower

## iOS User

### Connect Wi-Fi Smart Plug to APPSPower App

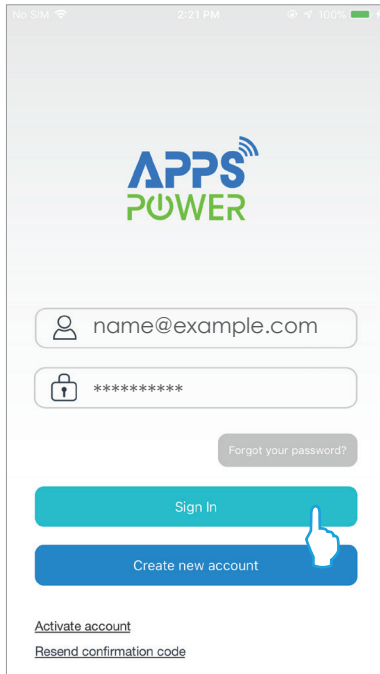

Launch APPSPower App and sign in with your own account

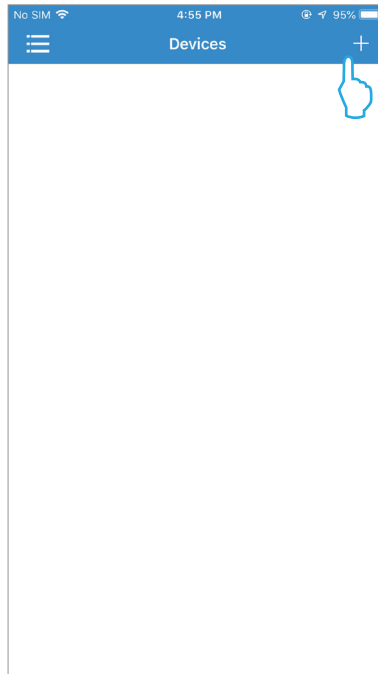

Tap the "+" icon on the upper right corner to add device



Once you click the "+" icon, use the camera on your smart phone to scan the Mac QR Code

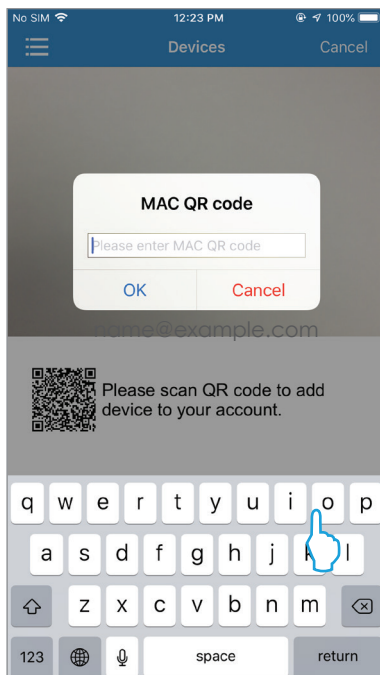

If cannot scan the code, please manually insert 16 digit Mac QR Code

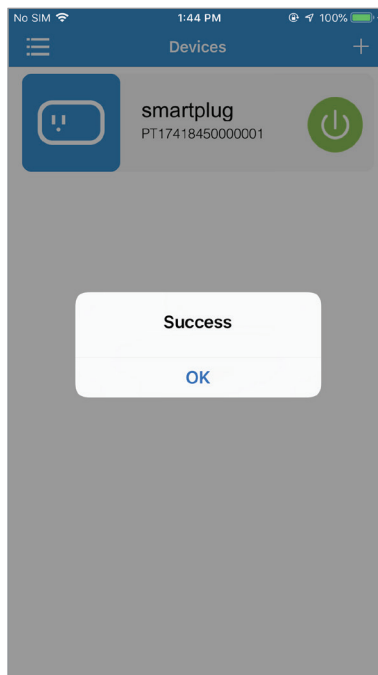

Once the device is added to the APPSPower, the Success notification will pop up, then press OK

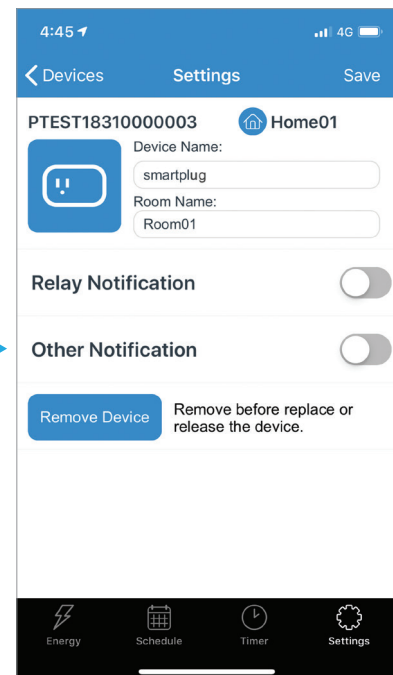

Tap the device icon, you can find and adjust extra features like metering, set up timer and edit information on the tab bars



# Connect CCS25669 to APPSPower

## Android User

### Connect Wi-Fi Smart Plug to APPSPower App

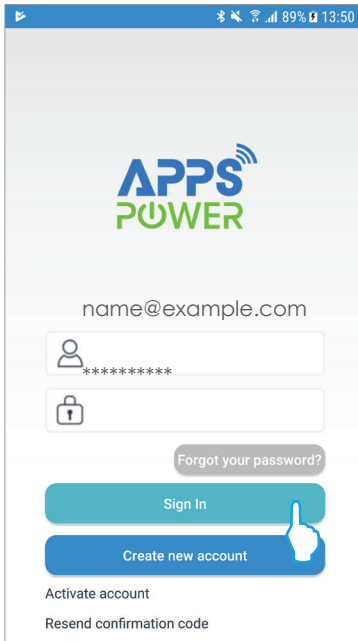

Launch APPSPower App and sign in with your own account

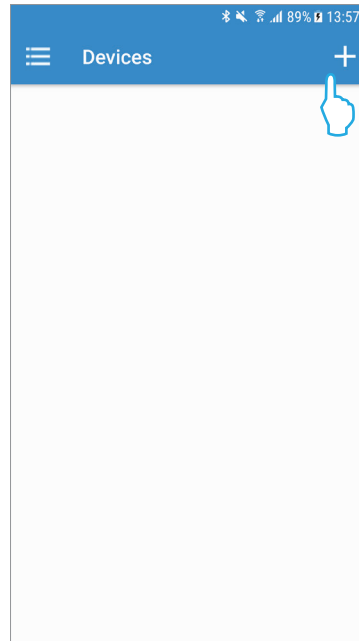

Tap the "+" icon on the upper right corner to add device



Camera will activate and scan the MAC QR code label on device. Successful scan will lead to step 5. If not, please tap "Don't Have a QR Code or Can't Scan?"

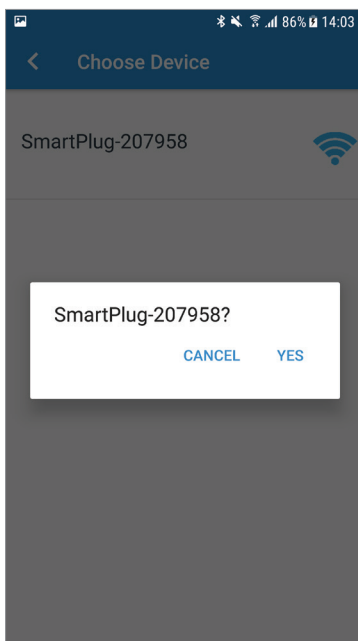

Go to your Wi-Fi setting and search for surrounding Wi-Fi devices. Select SmartPlug - xxxxxx. If SmartPlug is unfound, reset plug as stated in step 1

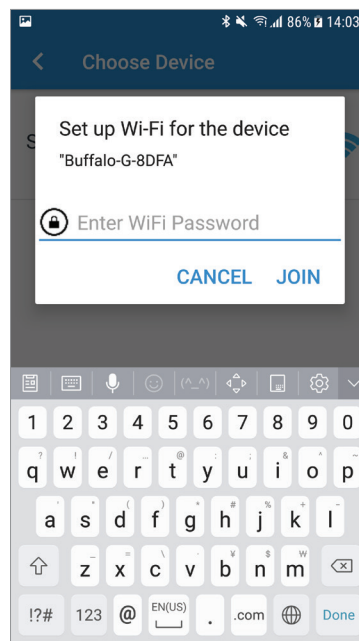

Once you scan or enter the Mac QR Code, please enter your home Wi-Fi password

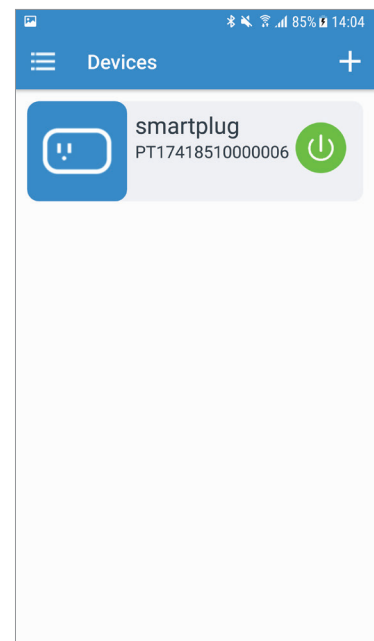

After the device name appear on the Device page, you are all set to go

# Connect CCS25669 to Amazon App and Alexa

Add Alexa voice control to your CCS25669 Wi-Fi smart plug to manage lighting, comfort, other smart home accessories and smart home scenes throughout your entire home.



## Requirements

To use Alexa voice control with your CCS25669 system you must have: An Alexa-compatible device such as an Amazon Echo, Dot, Tap, or FireTV with Voice Remote and an Amazon account at [www.amazon.com](http://www.amazon.com)

## Control Wi-Fi Smart Plug on Amazon Alexa

### Step 1:

Launch Amazon App and sign in with your own account.  
Tap Skill & Games from Menu and search for APPSPOWER

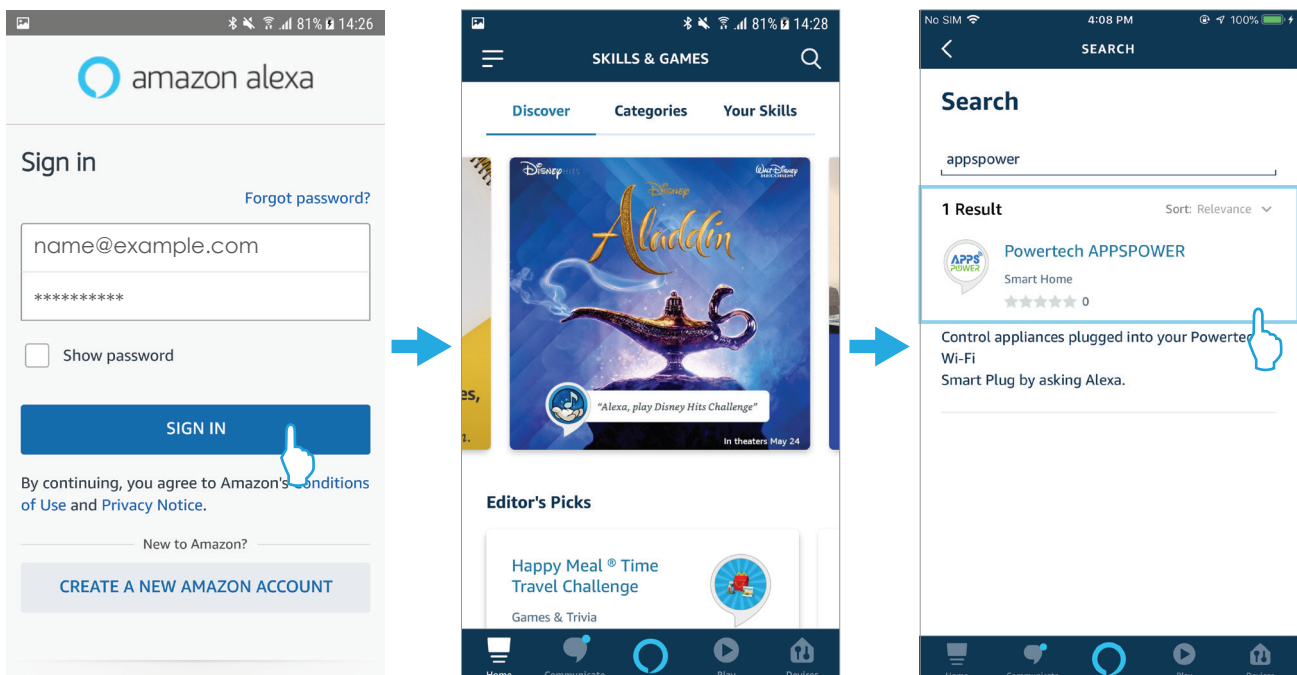

# Connect CCS25669 to Amazon App and Alexa

## Step 2:

Tap ENABLE TO USE and log in with APPSPower App account. The App will remind that "Powertech APPSPower has been successfully linked". Tap "X" to go to the next step

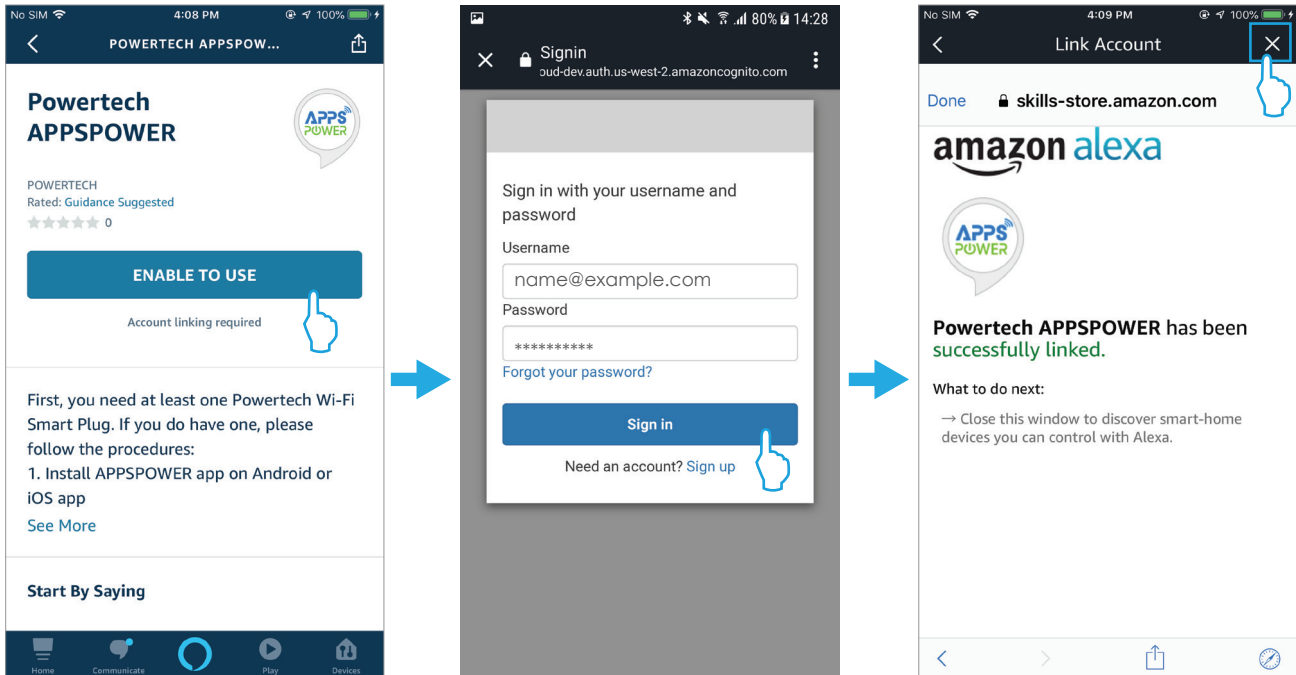

## Step 3:

Tap DISCOVER DEVICES and Alexa will start scanning the devices

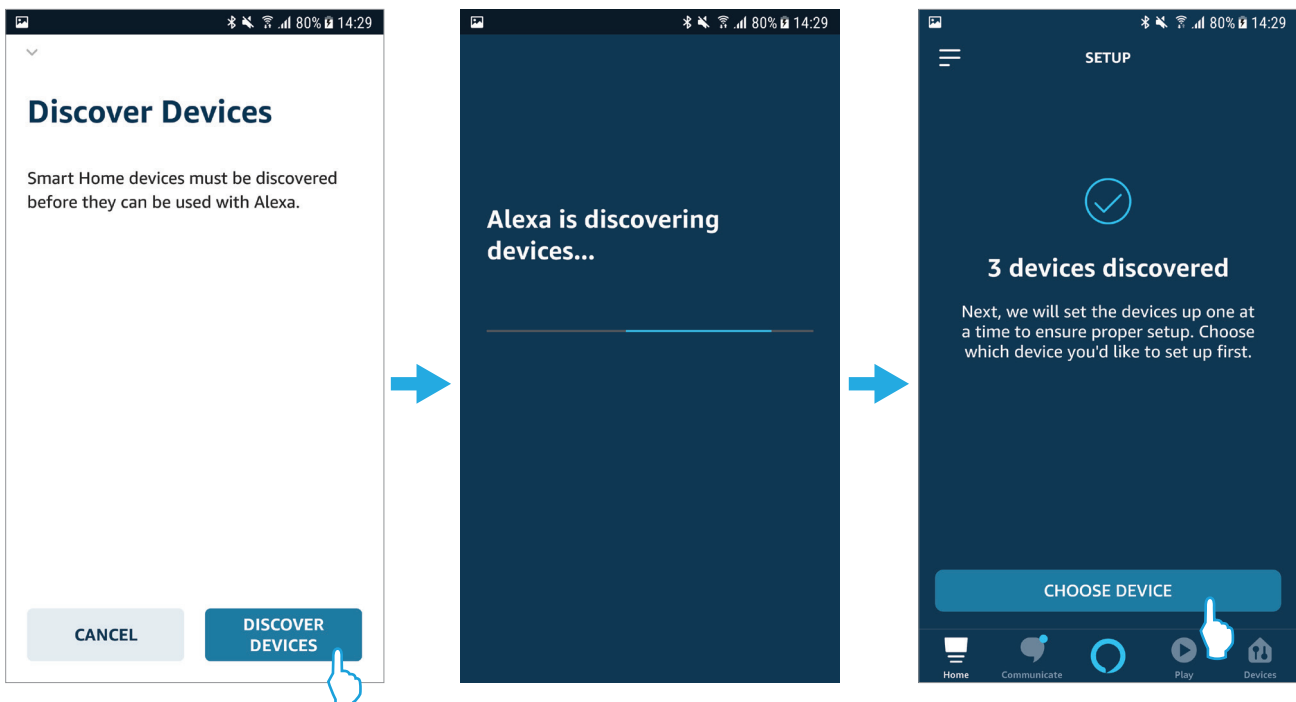

# Connect CCS25669 to Amazon App and Alexa

## Step 4:

You have now completed the setup process. From the bottom tab bar, tap Device and select the device types to view what devices are discovered by Alexa

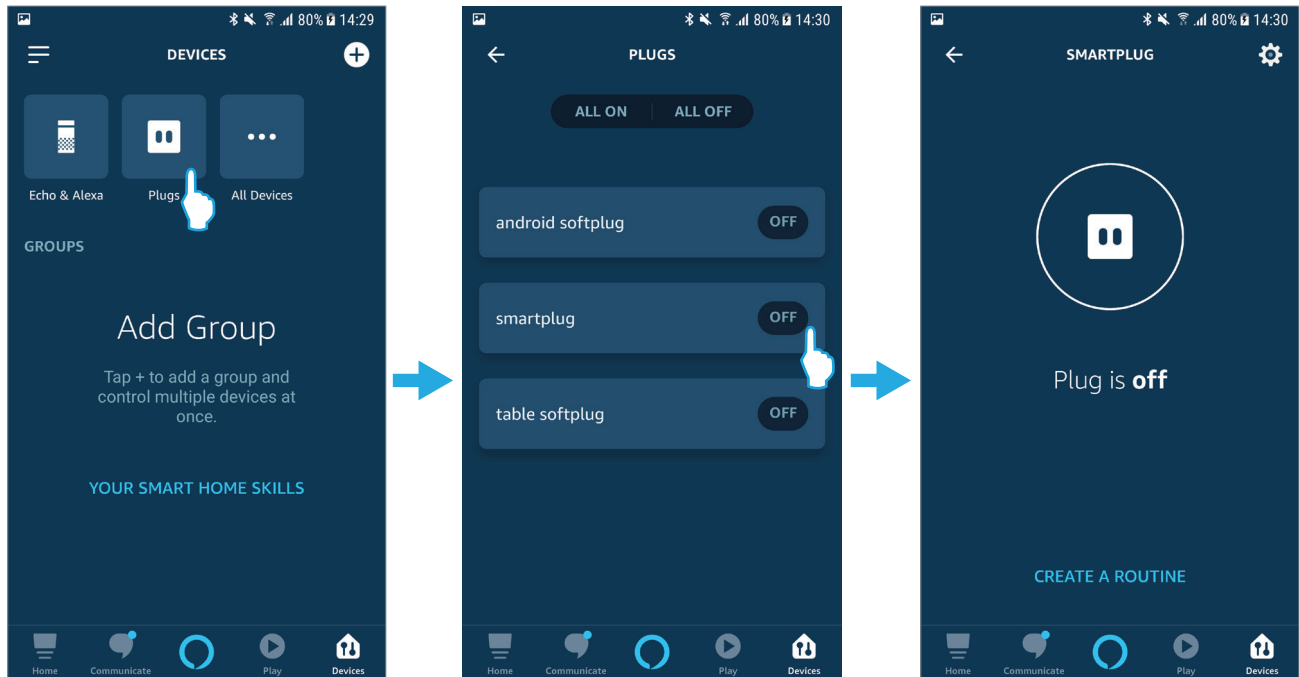

Now, Echo Dot set up and CCS25669 were linked to Alexa and is ready to issue command to control Smart Plug connected accessories.

The example of voice commands:

"Alexa, turn on the smart plug"

"Alexa, turn off the smart plug"

# Troubleshooting Home App and smart plug

---

## Q1- Where should I get Home app?

Download and install/open Home app from App store.

## Q2- After installing Home app, what is the next step?

Create and login to Home app in iOS device.

## Q3- After login to Home app in iOS device what else need to be verified?

Make sure you're logged into your iCloud account.

## Q4- What should I do if Home app stuck on Loading Home screen?

Remove home app, hard reboot (home button + power button), reinstall app, enter settings, open home app configuration, enable iCloud and reset all settings

## Q5- What should I do? If accessory pairing successful and not recognized by SIRI?

Make sure Wi-Fi network used for pairing with HomeKit and Wi-Fi network connected for SIRI is the same.

## Q6- My house using 5GHz or Dual band 2.4GHz/5GHz Wi-Fi, does this support smart plug?

support only 2.4ghz not 5ghz.

## Q7- How many people can access my smart plug?

One smart plug is only able to connect by one smartphone or tablet but homekit provide app share function for user to share smart plug control to others.

## Q8- Can I add a smart plug remotely?

If you have Apple TV (4th generation or later) or Home Pod the center of your home. Control HomeKit-enabled accessories remotely, grant access to the people you trust, and automate accessories to do what you want, when you want.

## Q9- Can I use the smart plug without a smartphone?

If you need to, you can switch the smart plug on/off manually using the Power Switch button on the front panel. The Power LED indicates the switch status.

## Q10- What kind of appliances can I control remotely with the smart plug?

Any home appliances, connected to smart plug can be controlled