

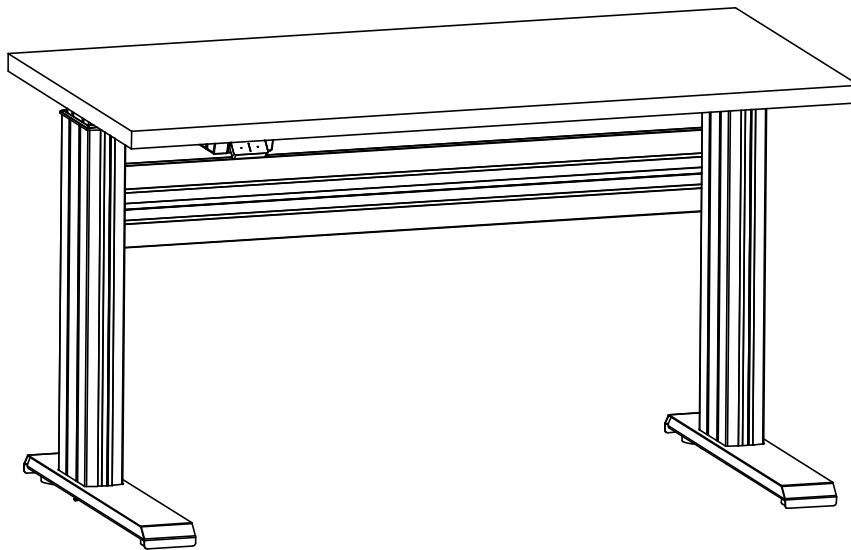

NewHeights Series 4 LT Eficiente 2-Leg Workstation

K&A Manufacturing
6703 Zinser Street
Schofield, WI 54476
Phone: 800.298.4351
Fax: 866.882.9475
www.raproducts.com
8/5/16

Assembly/Operation Instructions



Failure to comply with or observe all assembly, safety, and operation instructions and warnings regarding the use of this product may result in serious property damage or bodily injury.

Make sure no obstacles are in the desk's path and all cords are of appropriate length for the desk. Always maintain a 1" clearance around the table to prevent pinching.

Never assemble (or disassemble) the table or components with the table plugged into a power outlet. This product is for use on a nominal 120-volt circuit and has a grounding plug. Make sure that the product is connected to an outlet having the same configuration as the plug. No adapter should be used with this product.

Read all the instructions before beginning.

The drawing below shows how to distinguish the left leg A from the right leg B. The left leg A has a sticker on the worksurface support indicating the motor gets installed on this leg. The right leg has a sticker on it indicating no motor gets installed on it.

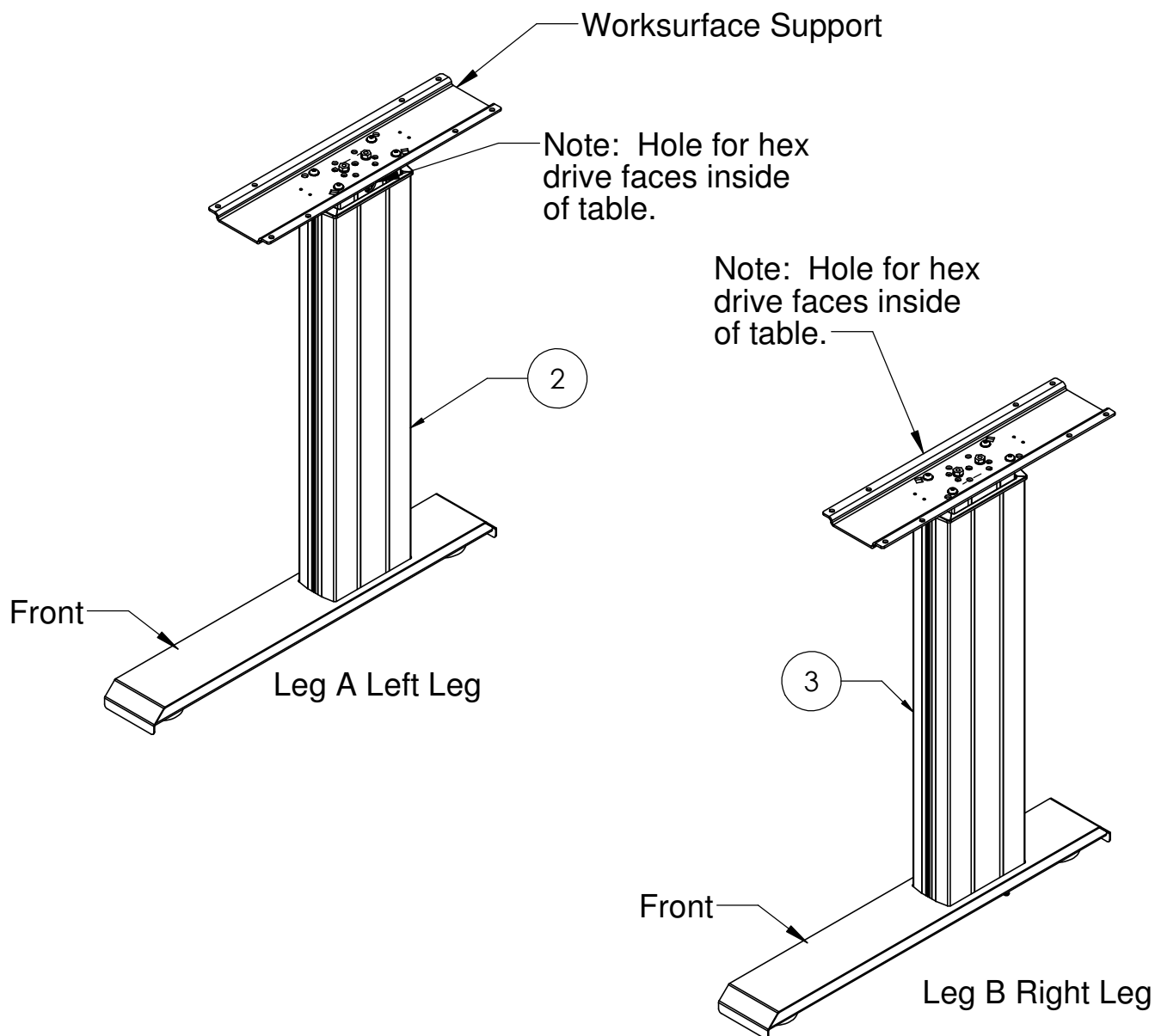



K&A Manufacturing
6703 Zinser Street Schofield, WI 54476
Phone: 800.298.4351
Fax: 866.882.9475
www.raproducts.com

Tools Required for Assembly:
Power Driver W/Adjustable Torque
#2 Phillips Head Driver Bit
#2 Square Head Driver Bit
3/16" Hex Head Driver Bit or
Allen Wrench
Adjustable Wrench
Tape Measure
Level

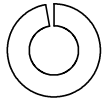

53013

6



53055

7



50072

9

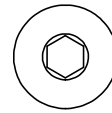

53638

10



51708

12
D

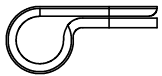

52604

17

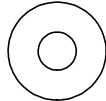

52236

B



53678

C

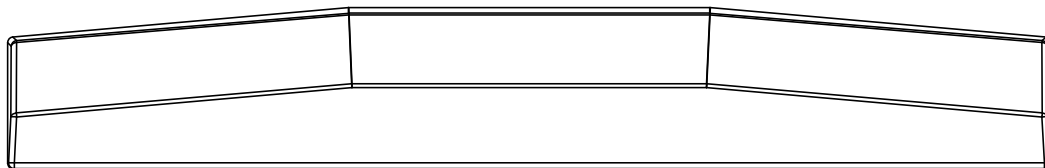

800934

11

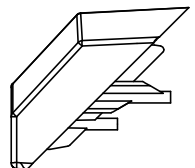

Hardware Pack # 53023
Hardware is Drawn Actual Size

Warranty Information: NewHeights™ products are warranted to be free of defects due to manufacturing or materials as follows: Three years on the gear and/or motor including the control box and switch. Five years on the support brackets, aluminum columns, and feet. We will replace any defective part after inspection by an authorized agent. Costs incurred due to product replacement such as installation labor or transportation are not covered under this warranty. When corresponding with RightAngle™ products, record and provide the model and serial numbers located on the control box.



K&A Manufacturing
6703 Zinser Street Schofield, WI 54476
Phone: 800.298.4351
Fax: 866.882.9475
www.raproducts.com

Step 1: Lay the worksurface **1** on a protected surface with the pilot holes facing up. There are metal inserts installed in the worksurface. These will not be used for this workstation. Place the left leg assembly **2** (Leg A) on the worksurface. The hex drive hole must face the inside of the workstation.

Step 2: Insert the end of the hex rod **3** through the hex drive on the motor assembly **5** and into the hex drive near the top of the leg assembly **2**. See Detail A. You may need to turn the hex rod clockwise slightly using an adjustable wrench to align it with the hex drive.

Step 3: Place (2) lock washers **6** on (2) socket screws **7**. Insert these through the holes in the motor bracket **5** and thread them into the cage nuts pre-installed in the worksurface support. Hand tighten. You will not be able to fully tighten the screws until later in Step 12.

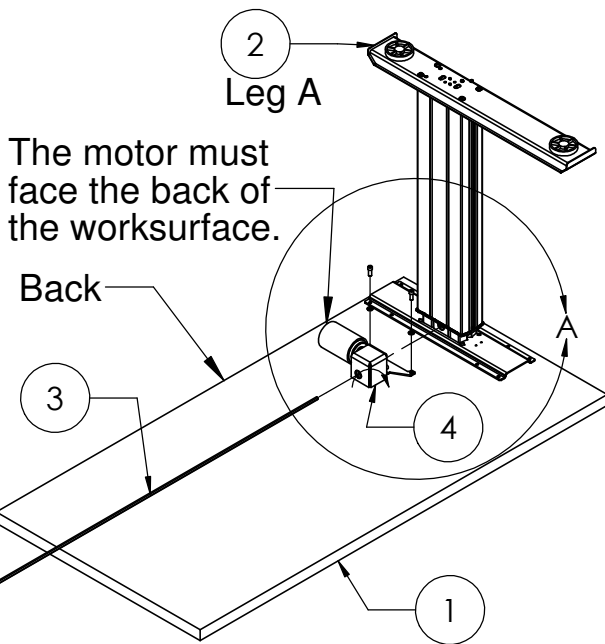

Steps 1-3

ITEM #	PART #	DESCRIPTION	QTY
1	Varies	LT Worksurface	1
2	Varies	LT Leg Assembly Left (Leg A)	1
3	Varies	LT Hex Rod	1
4	Varies	LT Leg Assembly Right (Leg B)	1
5	801064	LT Motor & Bracket Assembly	1
6	53013	Split Lock Washer 1/4"	2
7	53055	Socket Head Cap Screw 1/4-20 x 7/16	2
8	Varies	Series 4 Cross Support	1
9	50072	8 x 3/4 Pan Head Recex Drive Screw	2
10	53638	5/16 x 3/8 Button Socket Cap Screw	4
11	800934	Cross Support End Cap	2
12	51708	M5 x 18mm (7/8") Sq/Ph/Wshr Head Wood Screw	Varies
13	Varies	LT U-Channel	1
14	53476	Snap-On Switch For Smart Control Box	1
15	53464	Smart 1 Control Box	1
16	59169	Wire Management J	1
17	52604	3/16" Cable Clamp	4

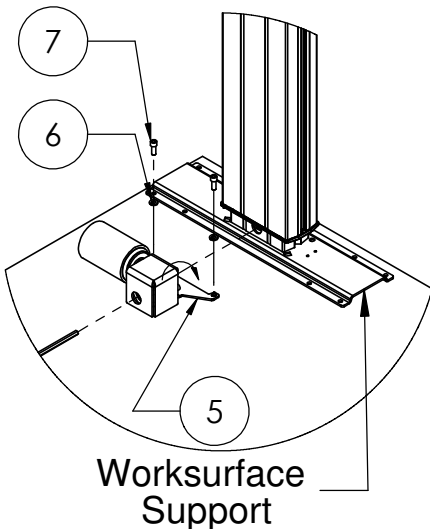

Detail A

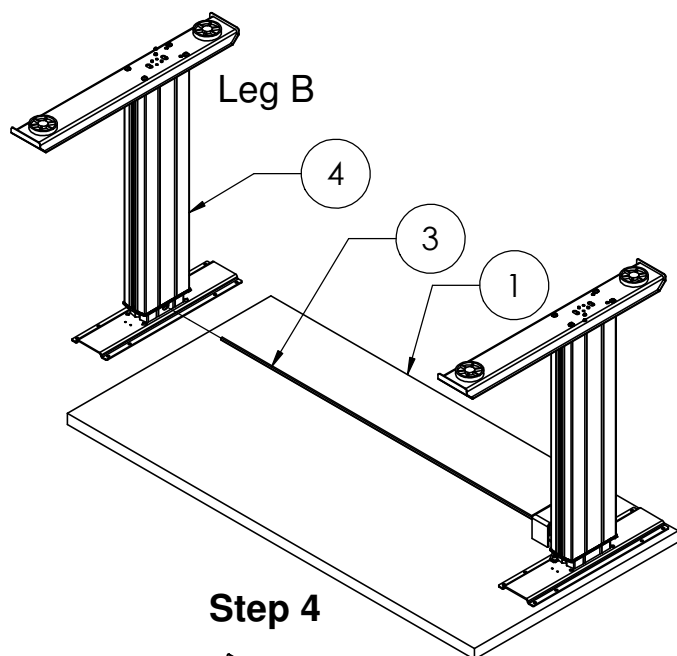

Step 4: Place the right leg assembly **4** (Leg B) on the worksurface **1**. Insert the end of the hex rod **3** into the hex drive on the right leg assembly. You may need to turn the hex rod clockwise slightly with an adjustable wrench to align the hex rod with the hex drive in the right leg assembly. It should take no more than 1/6th of a turn to accomplish this. If you turn it more than 1/6th of a turn, the legs will be at different heights and the worksurface won't be level.

If your worksurface does not have pilot holes, skip Step 5. Go to Step 6.

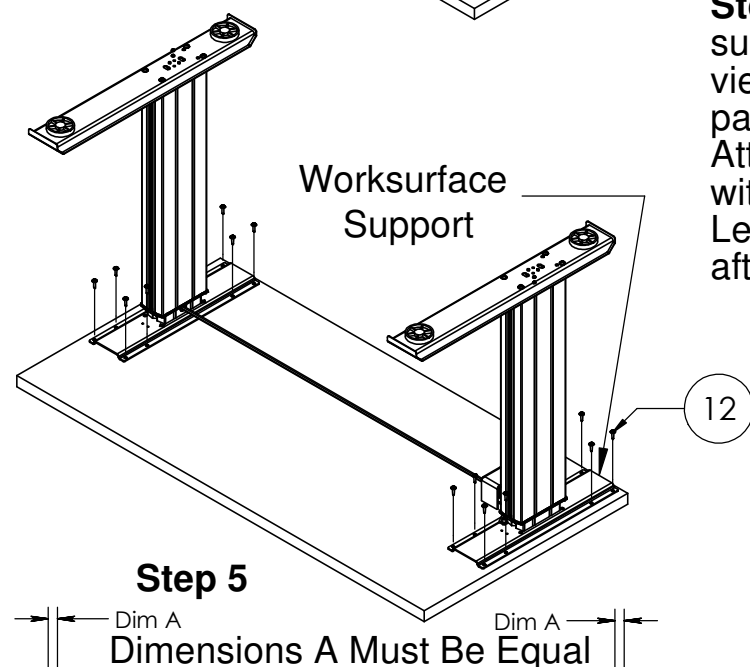

Step 5: Align all the holes in the worksurface supports with the pilot holes in the worksurface. Attach the leg assemblies to the worksurface with (8) wood screws **13** in each leg assembly. Leave the screws loose by about 1/8" until after the cross support **8** is installed.

Step 6 applies to worksurfaces with no pilot holes.

Step 6: Square and align the worksurface supports as shown in the bottom and the side views below. Worksurface supports must be parallel to the edges of the worksurface. Attach the leg assemblies to the worksurface with (8) wood screws **12** in each leg assembly. Leave the screws loose by about 1/8" until after the cross support **8** is installed.

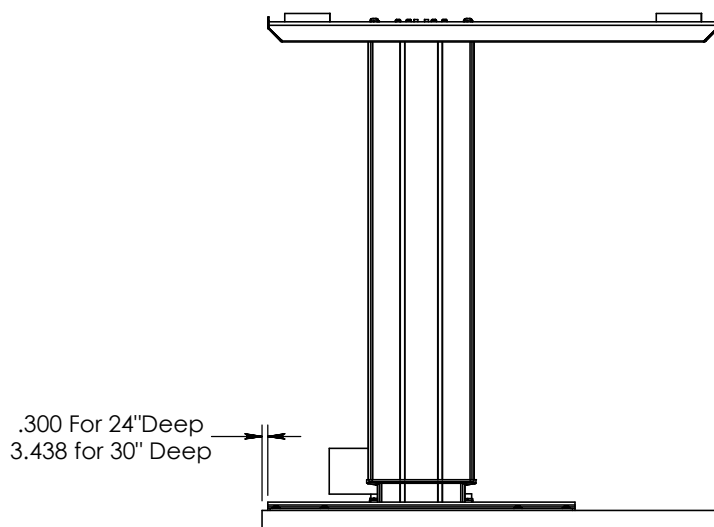
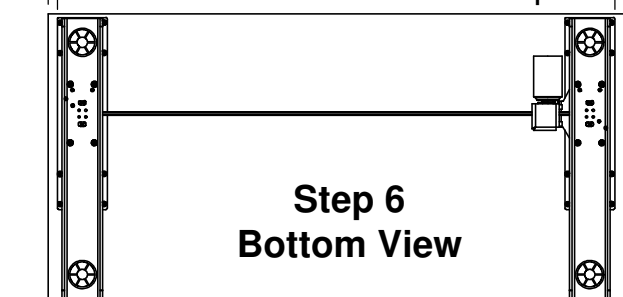

Step 6
Side View

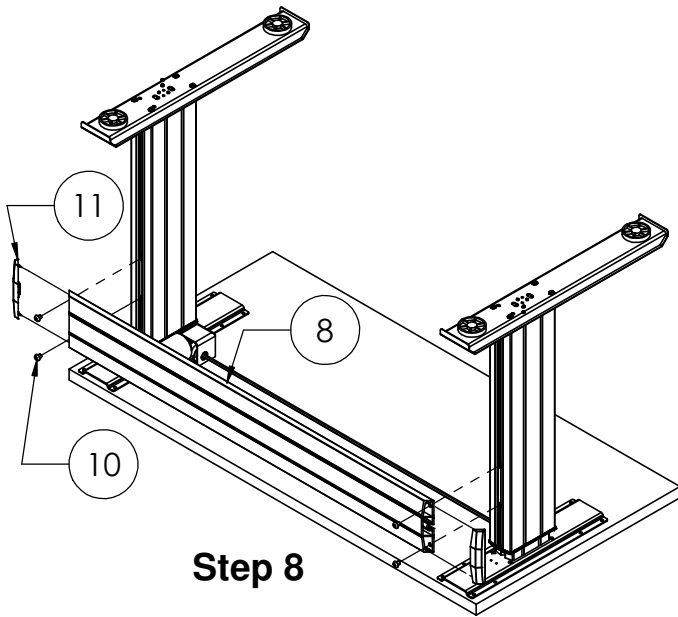

Step 7: With the help of an assistant align the cross support **8** with the stickers on both leg assemblies. See below. Insert (4) socket screws **10** through the holes in the ends of the cross support **8** and thread them into the weld nuts that are held in place by the stickers. Do not fully tighten. Check that the cross support is level and parallel to the worksurface. Fully tighten the socket screws.

Step 8: Insert (2) end caps **11** into the ends of the cross support.

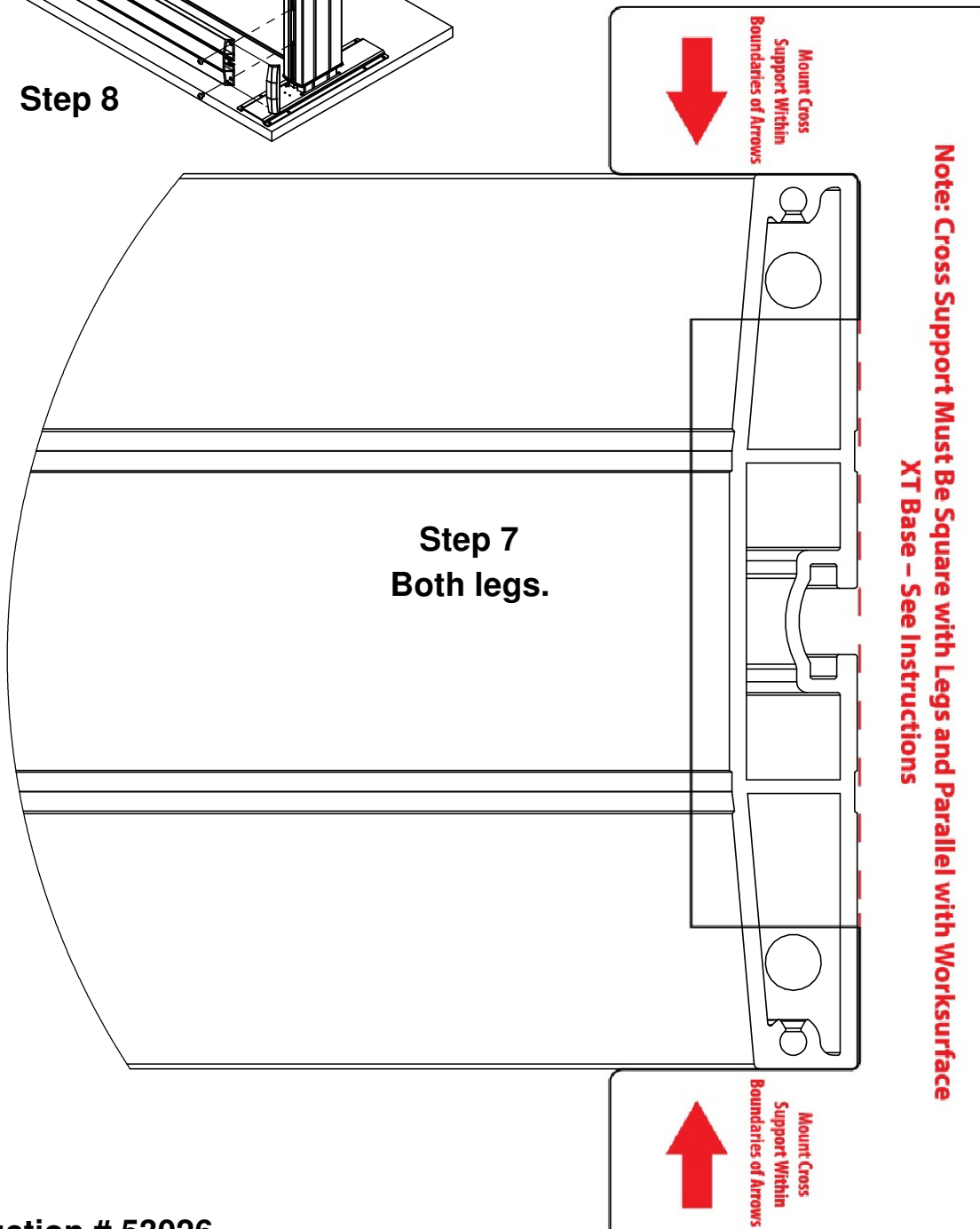

Step 9: Fully tighten the (16) wood screws 12 attaching the leg assemblies 2 (Leg A) and 4 (Leg B) to the worksurface 1. Do not over-tighten the screws. Use a low torque setting on the power driver.

Step 10: Align the holes in the u-channel 13 with the pilot holes in the worksurface 1. Attach it with (8-10) wood screws 12. If your worksurface does not have pilot holes, center the u-channel on the hex rod.

Step 11: Align the holes in the control box 15 with the pilot holes in the worksurface 1. Attach it with (2) recex screws 9. Slide the hand switch 14 onto the end of the control box until it snaps in place. If your worksurface does not have pilot holes, locate the control box and switch as shown. Place the wire management J 16 as shown. Attach it with (1) wood screw 12. No pilot hole is provided. Run the wires from the motor to the control box as shown below. Attach the wire using the clamp 17.

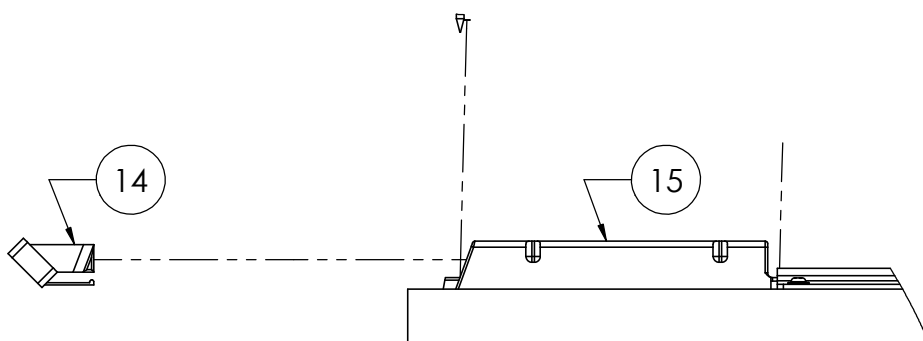
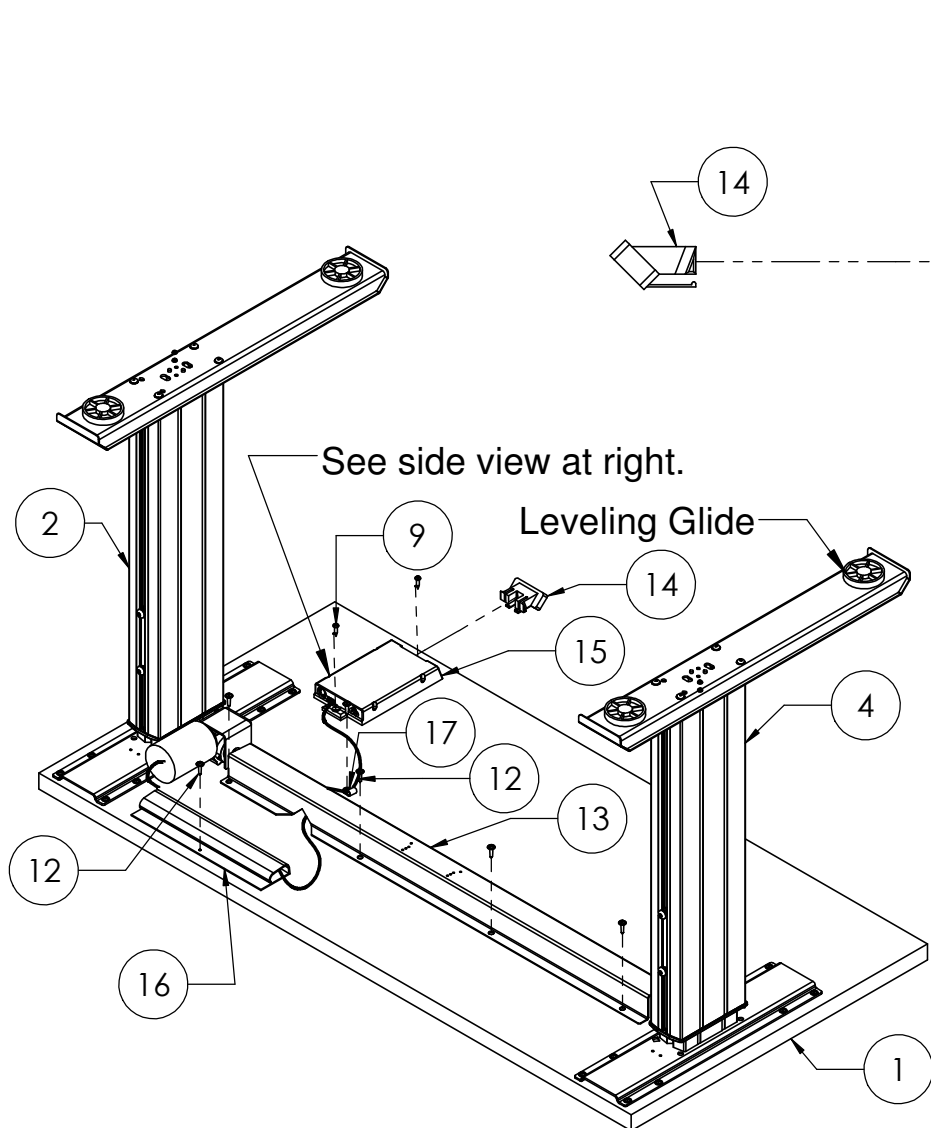

The switch 14 will snap and click into the end of the control box 15.

Side View

Steps 9-11



K&A Manufacturing
6703 Zinser Street Schofield, WI 54476
Phone: 800.298.4351
Fax: 866.882.9475
www.raproducts.com

Operation and Reset Procedure:

Plug the power cord into a standard 110v receptacle. A power surge protector is recommended. Press the down arrow until the worksurface reaches its lowest position and the control box clicks several times. The NewHeights workstation is ready for use.

Reset Procedure: Unplug the power for 30 seconds and plug back in. Hold the down arrow until the worksurface stops at the bottom and the control box clicks several times.

The workstation is now ready for use.

Troubleshooting: If you are having any problems with the table operation, contact RightAngle™ service at 800-298-4351 or orders@raproducts.com.

Note: If the leg assemblies are at uneven heights, it is usually caused by an improperly installed hex rod. Disassemble one of the leg assemblies from the worksurface and make sure both ends of the hex rod are properly engaged in the hex drives near the top of the leg assemblies.



K&A Manufacturing
6703 Zinser Street Schofield, WI 54476
Phone: 800.298.4351
Fax: 866.882.9475
www.raproducts.com

Step 12: Raise the leg assemblies high enough to fully tighten the motor screws 6 . Fully tighten the screws and return the leg assemblies to their lowest position. With the help of an assistant, set the workstation upright in its final position. Level the workstation if required by turning the leveling glides clockwise (from the top) on the low

corners of the unit. If your workstation has casters, level it by turning the bolts at the top of the casters.

Instructions to Install a Track on a Series 4 LT Workstation:

Step 1: Place the front of the track A against the bottom of the worksurface and place the back of the track on the angled part of the U-Channel E .

Step 2: Align the holes in the track A with one set of pilot holes in the u-channel E keeping the front of the track 1/8"-5/8" from the front of the worksurface. Place (2) washers B on (2) self drilling screws C . Drive them through the track and into the u-channel.

Step 3: Attach the front of the track A to the worksurface using (2) wood screws D . Do not over-tighten the wood screws. Use a low torque setting on the power driver.

Step 4: Complete the installation using the instructions that came with the product you are installing.

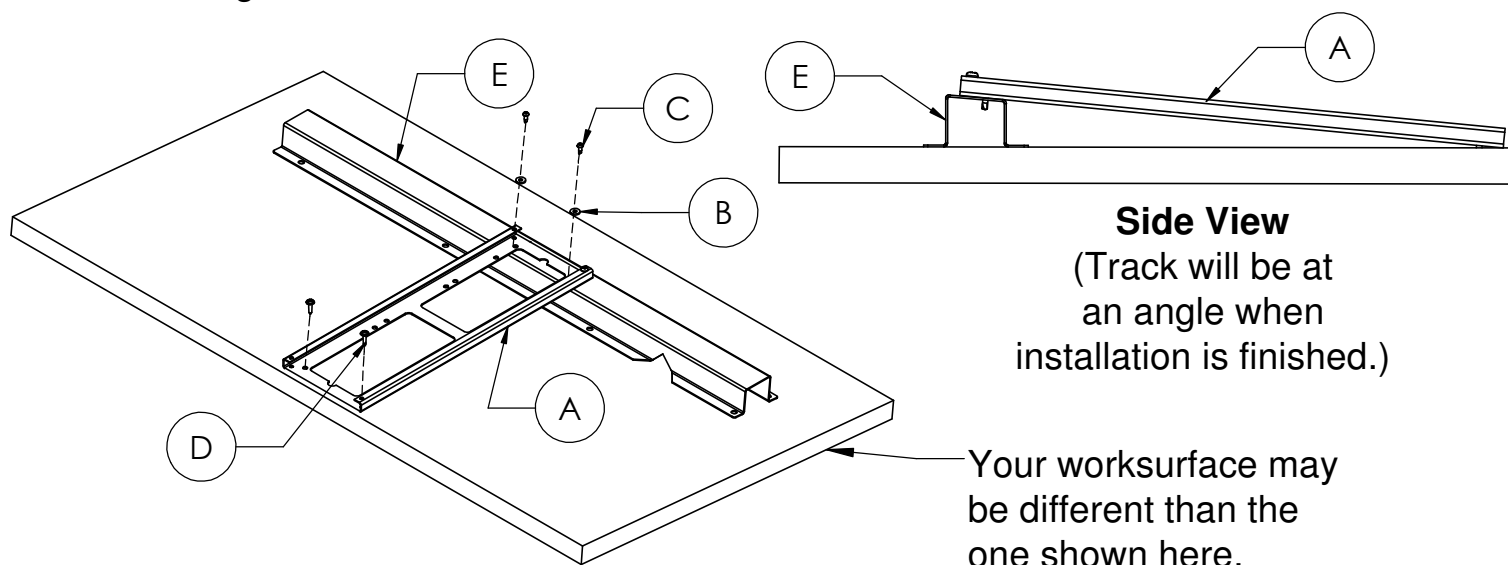

ITEM #	PART #	DESCRIPTION	QTY.
A	Varies	Track Assembly	1
B	52336	3/16" Aluminum Rivet Washer .198 x .510 x .067	2
C	52678	8-18X1/2 Phillips Pan Self Drill Screw	2
D	51708	M5 x 18mm (7/8") Sq/Ph/Wshr Head Wood Screw	2
E	Varies	LT U-channel	1