

TC53/TC58 Wrist Mount Installation Guide





Installation

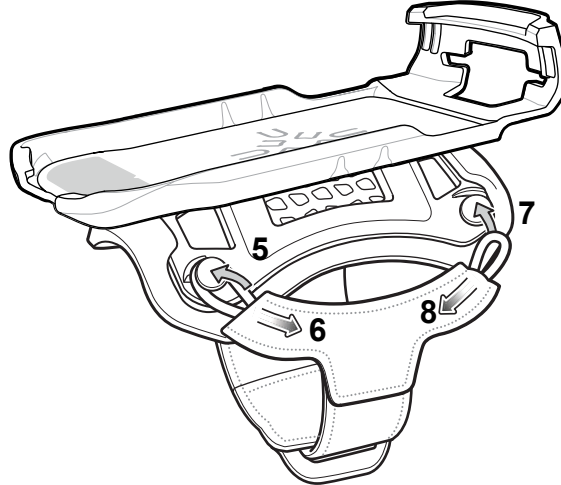
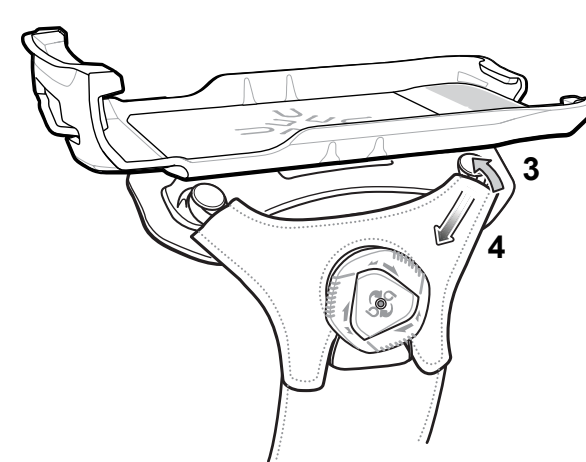
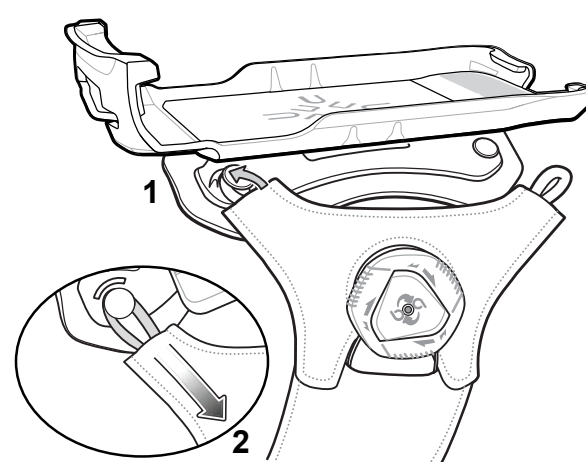

Zebra Technologies | 3 Overlook Point | Lincolnshire, IL 60069 USA
www.zebra.com

ZEBRA and the stylized Zebra head are trademarks of Zebra Technologies Corporation, registered in many jurisdictions worldwide. All other trademarks are the property of their respective owners. © 2022 Zebra Technologies Corporation and/or its affiliates. All rights reserved.



 **NOTE:** Expand strap if required.
See Removal, steps 3 and 4.

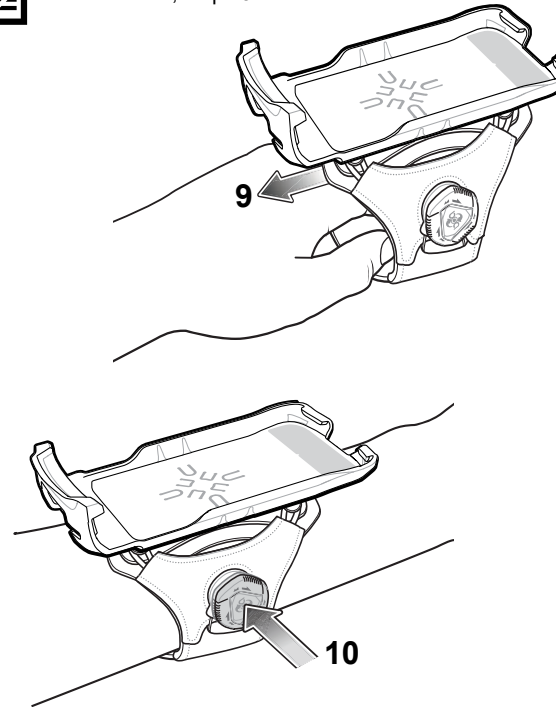

Rotate to tighten until comfortable.

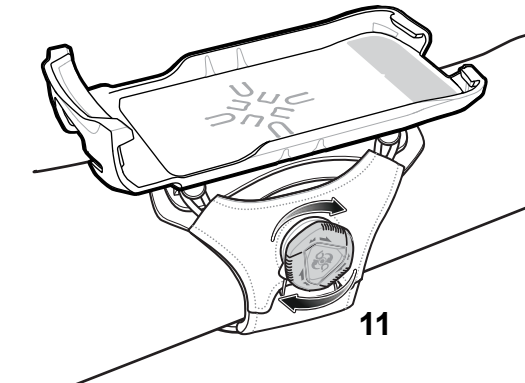

 **NOTE:** To loosen the strap, pull out the adjustment knob and pull on the strap. Push the adjustment knob in when finished with strap adjustment.

To remove see Removal on page 2.

 **NOTE:** Only use with the Rugged Boot.

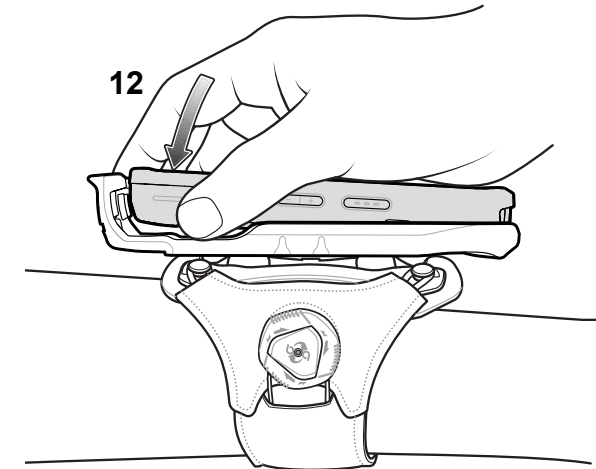

Removal

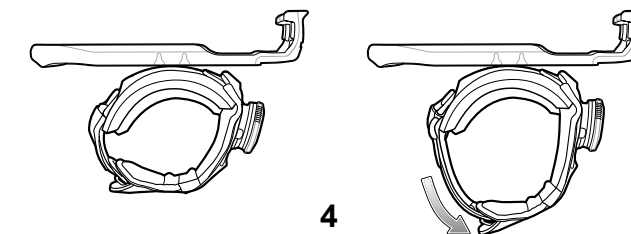
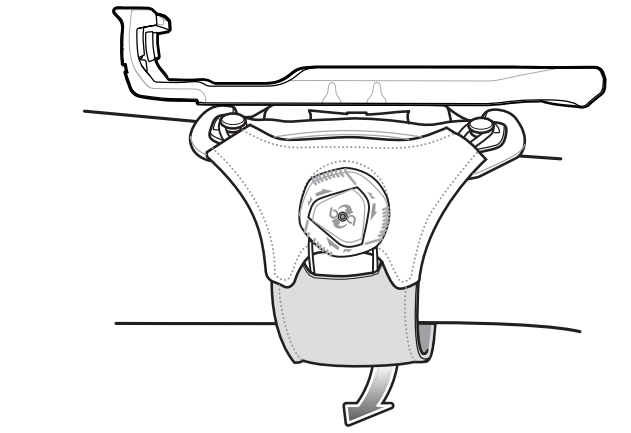
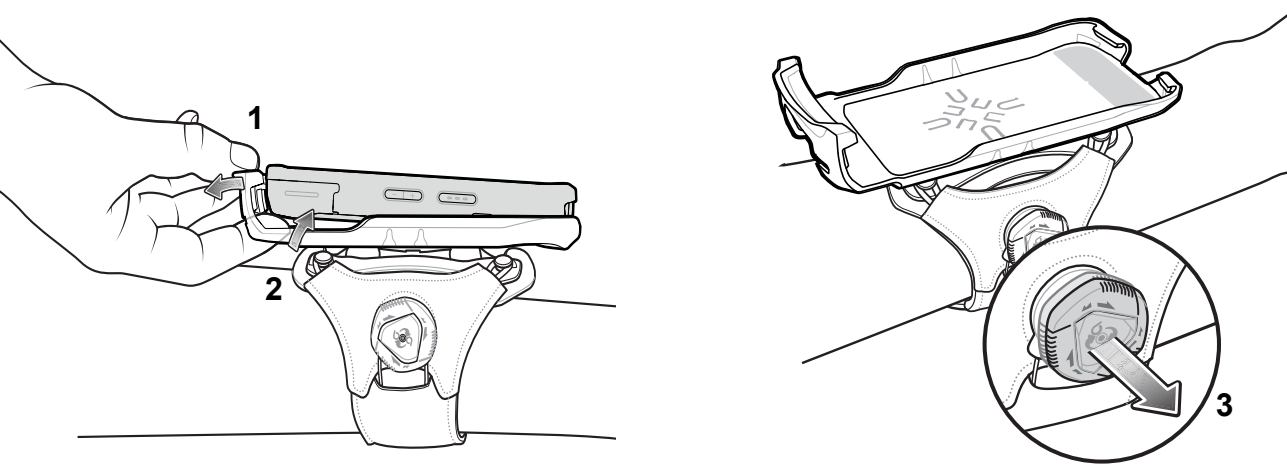

Comfort Pad Replacement

Comfort Pad Removal

Rotate the sled for easy access.

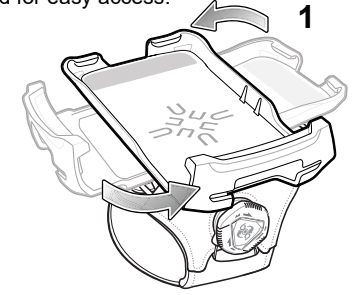

Remove comfort pad from both sides of the wrist strap.

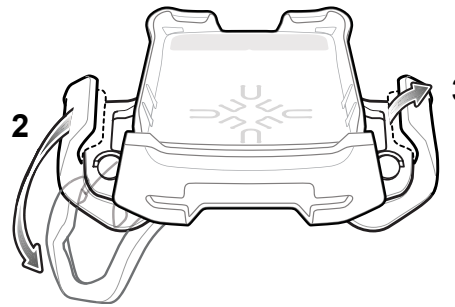

Comfort Pad Installation

Place the comfort pad under the wrist strap and align with the cut outs on the plastic piece of the wrist strap.

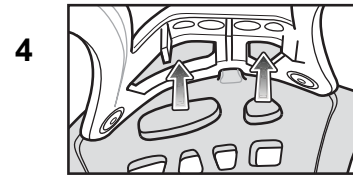

Bend the comfort pad rubber tabs over the wrist strap.

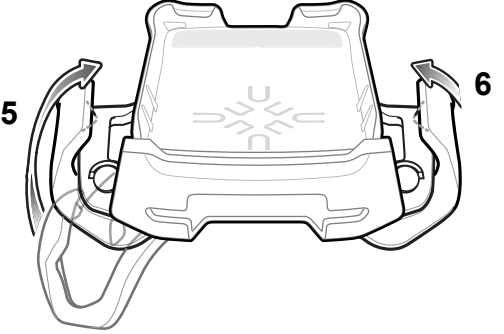

Cleaning

See the TC53/TC58 Product Reference Guide for cleaning instructions.

Warranty

For the complete hardware product warranty statement, go to: zebra.com/warranty.

Patents

For a list of Zebra patents, go to: ip.zebra.com

Service Information

If you have a problem using the equipment, contact your facility's Technical or Systems Support. If there is a problem with the equipment, they will contact the Customer Support at: zebra.com/support.

For the latest version of this guide go to: zebra.com/support.